

READ AND FOLLOW ALL SAFETY INSTRUCTIONS!
SAVE THESE INSTRUCTIONS AND DELIVER TO OWNER AFTER INSTALLATION

- To reduce the risk of death, personal injury or property damage from fire, electric shock, falling parts, cuts/abrasions, and other hazards please read all warnings and instructions included with and on the fixture box and all fixture labels.
- Before installing, servicing, or performing routine maintenance upon this equipment, follow these general precautions.
- Installation and service of luminaires should be performed by a **qualified licensed electrician**.
- Maintenance of the luminaires should be performed by person(s) familiar with the luminaires' construction and operation and any hazards involved. Regular fixture maintenance programs are recommended.
- It will occasionally be necessary to clean the outside of the refractor/lens. Frequency of cleaning will depend on ambient dirt level and minimum light output which is acceptable to user. Refractor/lens should be washed in a solution of warm water and any mild, non-abrasive household detergent, rinsed with clean water and wiped dry. Should optical assembly become dirty on the inside, wipe refractor/lens and clean in above manner, replacing damaged gaskets as necessary.
- **DO NOT INSTALL DAMAGED PRODUCT!** This luminaire has been properly packed so that no parts should have been damaged during transit. Inspect to confirm. Any part damaged or broken during or after assembly should be replaced.
- Recycle: For information on how to recycle LED electronic products, please visit www.epa.gov.
- These instructions do not purport to cover all details or variations in equipment nor to provide every possible contingency to meet in connection with installation, operation, or maintenance. Should further information be desired or should particular problems arise which are not covered sufficiently for the purchaser's or owner's purposes, this matter should be referred to Acuity Brands Lighting, Inc.



WARNING
RISK OF ELECTRIC SHOCK

- ✓ Disconnect or turn off power before installation or servicing.
- ✓ Verify that supply voltage is correct by comparing it with the luminaire label information.
- ✓ Make all electrical and grounded connections in accordance with the National Electrical Code (NEC) and any applicable local code requirements.
- ✓ All wiring connections should be capped with UL approved recognized wire connectors.



WARNING
RISK OF BURN

- ✓ Allow lamp/fixture to cool before handling. Do not touch enclosure or light source.
- ✓ Do not exceed maximum wattage marked on luminaire label.
- ✓ Follow all manufacturer's warnings, recommendations and restrictions for: driver type, burning position, mounting locations/methods, replacement and recycling.



CAUTION
RISK OF INJURY

- ✓ Wear gloves and safety glasses at all times when removing luminaire from carton, installing, servicing or performing maintenance.
- ✓ Avoid direct eye exposure to the light source while it is on.



CAUTION
RISK OF FIRE

- ✓ Keep combustible and other materials that can burn, away from lamp/lens.
- ✓ Do not operate in close proximity to persons, combustible materials or substibg
- ✓ Acnes affected by heat or drying.



CAUTION: RISK OF PRODUCT DAMAGE

- ✓ Never connect components under load.
- ✓ Do not mount or support these fixtures in a manner that can cut the outer jacket or damage wire insulation.
- ✓ Controls for dimming, auto-sensing, or remote control of a luminaire that are not factory-wired to the luminaire must be checked for compatibility with the luminaire prior to installation. LED fixtures must be powered directly off a switched circuit.
- ✓ Unless individual product specifications deem otherwise: Do not restrict fixture ventilation. Allow for some volume of airspace around fixture. Avoid covering LED fixtures with insulation, foam, or other material that will prevent convection or conduction cooling.
- ✓ Unless individual product specifications deem otherwise: Do not exceed fixtures maximum ambient temperature.
- ✓ Only use fixture in its intended location.
- ✓ LED products are Polarity Sensitive. Ensure proper Polarity before installation.
- ✓ Electrostatic Discharge (ESD): ESD can damage LED fixtures. Personal grounding equipment must be worn during all installation or servicing of the unit.
- ✓ Do not touch individual electrical components as this can cause ESD, shorten lamp life, or alter performance.
- ✓ Some components inside the fixture may not be serviceable. In the unlikely event your unit may require service, stop using the unit immediately and contact an ABL representative for assistance.
- ✓ Always read the fixtures complete installation instructions prior to installation for any additional fixture specific warnings.
- ✓ Always ensure that the electrical distribution system is up to NEC (and any applicable local code) requirements.
- ✓ Verify that power distribution system has proper grounding. Lack of proper earth ground can lead to fixture failure and may void warranty.

All luminaires that contain electronic devices that generate frequencies above 9kHz from any component within the luminaire comply with Part 15 of the FCC Rules. Operation is subject to the following two conditions:

- (1) This device may not cause harmful interference
- (2) This device must accept any interference received, including interference that may cause undesired operation

Failure to follow any of these instructions could void product warranties. For a complete listing of product Terms and Conditions, please visit www.acuitybrands.com.

Our Brands	Indoor/Outdoor Lithonia Lighting Carandini Holophane RELOC Light Concepts	Indoor Lighting Gotham Mark Architectural Lighting Peerless Renaissance Lighting Winona Lighting	Outdoor Lighting American Electric Lighting Antique Street Lamps Hydrel Tersen	Controls DARK TO LIGHT LC&D ROAM Sensor Switch Synergy	Daylighting SunOptics
-------------------	--	---	--	---	--------------------------

Acuity Brands Lighting, Inc. assumes no responsibility for claims arising out of improper or careless installation or handling of its products.

ABL LED General Warnings, Form No. 503.203

© 2010, 2016 Acuity Brands Lighting, Inc. All rights reserved. 12/01/10

XIB LED HIGHBAY

INSTALLATION INSTRUCTIONS

WARNING: Please read all LED important safety instructions on pages 1-2 prior to installation of this product.

A) Identification of XIB Luminaire- Pages 4

1. XIB 2FT LUMINAIRE
2. XIB 4FT LUMINAIRE
3. BPK OPTION (2FT ONLY)
4. WGX OPTION
5. SURFACE MOUNT OPTION
6. YOKE MOUNT OPTION

*Refer to page 8 for pendant mount

B) PRE-INSTALLATION FOR ALL MOUNTING- PAGE 5

C) INSTALLATION- SUSPENDED/INVERTED FIXTURE- PAGES 5-6

D) INSTALLATION- 2FT SURFACE MOUNT- PAGE 7

E) INSTALLATION- 4FT SURFACE MOUNT- PAGE 7

F) INSTALLATION- PENDANT MOUNT - PAGE 8

G) INSTALLATION- YOKE MOUNT – PAGE 9

H) INSTALLATION- EXTERNAL SENSOR - PAGE 10

I) WIRING- Battery Backup – PAGEs 10-11

J) SERVICING - PAGES 11-12

For additional assistance, please contact Industrial Tech Support by phone at 1-800-705-SERV (7378) or by email at techsupport-Industrial@acuitybrands.com

SECTION A: Identification of XIB Luminaire

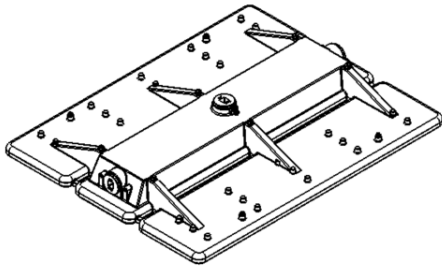

XIB 2FT LUMINAIRE

Figure A.1: L24 Fixture

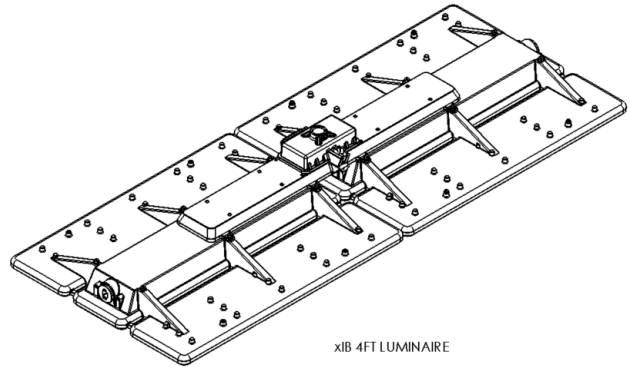

XIB 4FT LUMINAIRE

Figure A.2: L48 Fixture

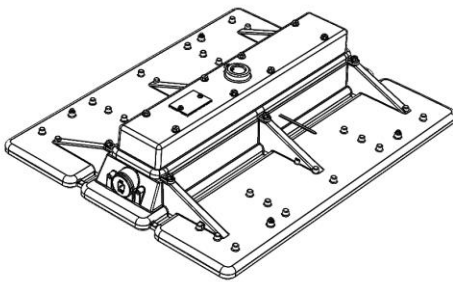

Figure A.3: BPK OPTION

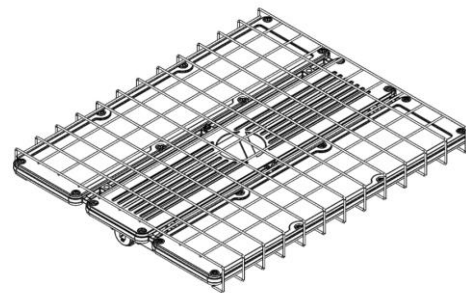

Figure A.4: WGX OPTION

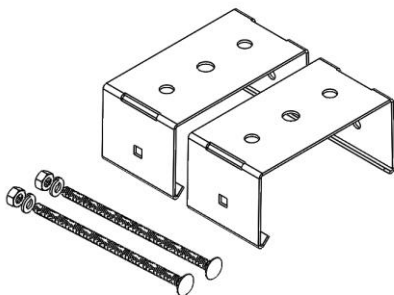

Figure A.5: Surface Mount Accessories

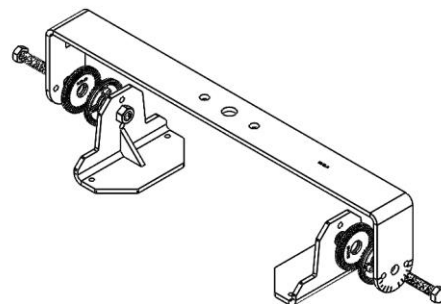



Figure A.6 Yoke Mount Accessories

SECTION B: PRE-INSTALLATION FOR ALL MOUNTING

- 1) Ensure power is OFF.
- 2) Disconnect all power to the existing luminaire and remove the existing luminaire from the ceiling. Inspect the existing mounting location for damage before installing the new XIB LED high bay in this location. Ensure mounting structure is properly sized to support the weight of the fixture.
- 3) Remove the new XIB LED from packaging and inspect for any damages. Handle new LED fixture with care. If damaged do not use; call your local rep for replacement.
- 4) Customer provided cable glands may be installed between the luminaire and conduit to reduce condensation inside of conduit from entering luminaire. Use cable glands suitable for your end use application
- 5) After installation ensure no wires are pinched or caught outside the electrical door.

SECTION C: INSTALLATION – SUSPENDED/INVERTED FIXTURE

- 1) If using the IBAC120 M100 or IBAC240 M75, hook the latch around the suspended mounting feature on driver channel housing as shown in figure C.1, C.2, and C.3 (inverted mounting options connects the same way as suspended) below.
- 2) Secure the other end of the aircraft cable to a structure using hardware rated for the load. Contact factory or agency for areas that have vibration, overhead cranes and/or high velocity

 Make sure the latches are fully engaged around the mounting feature located on the driver channel housing.

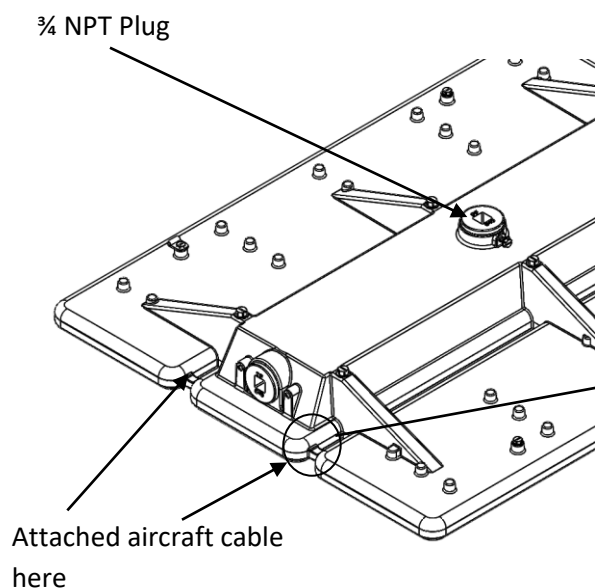

Figure C.1: Suspended Mounting Option

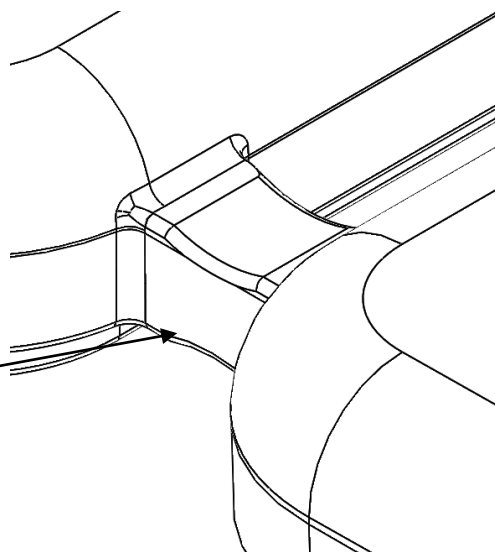

Figure C.2: Detail View of Suspended Mounting Feature

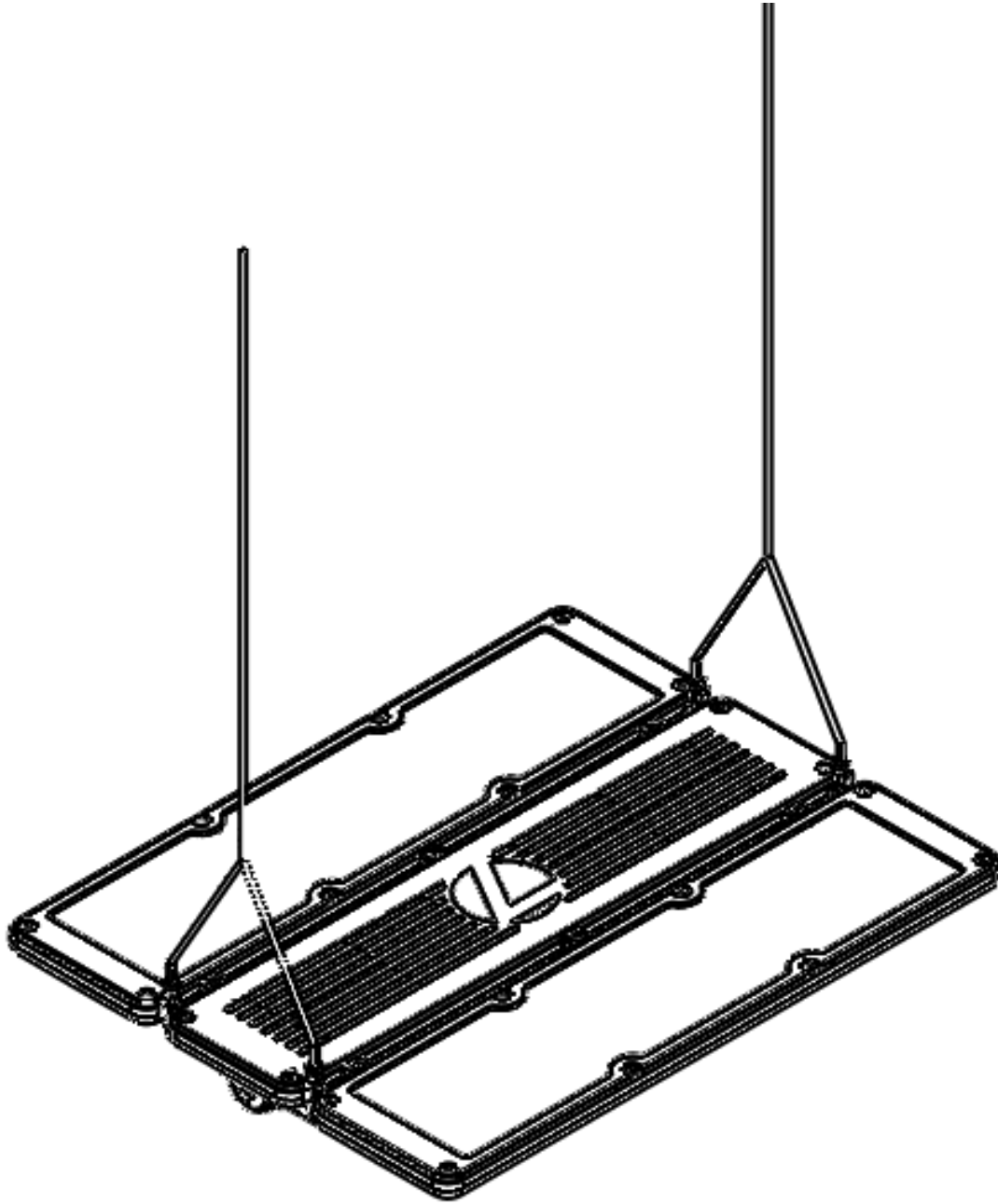

Figure C.3: Inverted Mounting Option

- 1) Remove $\frac{3}{8}$ " plug on threaded entry as shown (if provided). Pull Input wires through pendant entry and connect input wires black to black, white to white and green to green. Use only UL listed connectors rated 90C or greater. Purple and Pink (or Gray) wires are low voltage dimming leads.
- 2) Make any necessary electrical connections. Supply wire must meet applicable electrical codes and be rated for a minimum of 90°C. Purple and pink (or gray) leads are 0-10V (low voltage) dimming leads.

SECTION D.1: INSTALLATION – 2FT SURFACE MOUNT
(NOT AVAILABLE WITH UPLIGHT OPTION)

- 1) Follow Steps 3-4 from Section C
- 2) Attach surface mount brackets to structure; hardware needed to mount brackets is not supplied. Two surface mount brackets **MUST** be used on all configurations.
- 3) Support fixture while attaching fixture into surface mount brackets. Ensure fixture is balanced.
- 4) Use supplied hardware to tighten surface mount brackets around center channel as shown below. Tighten bolts to 13 in/lbs.

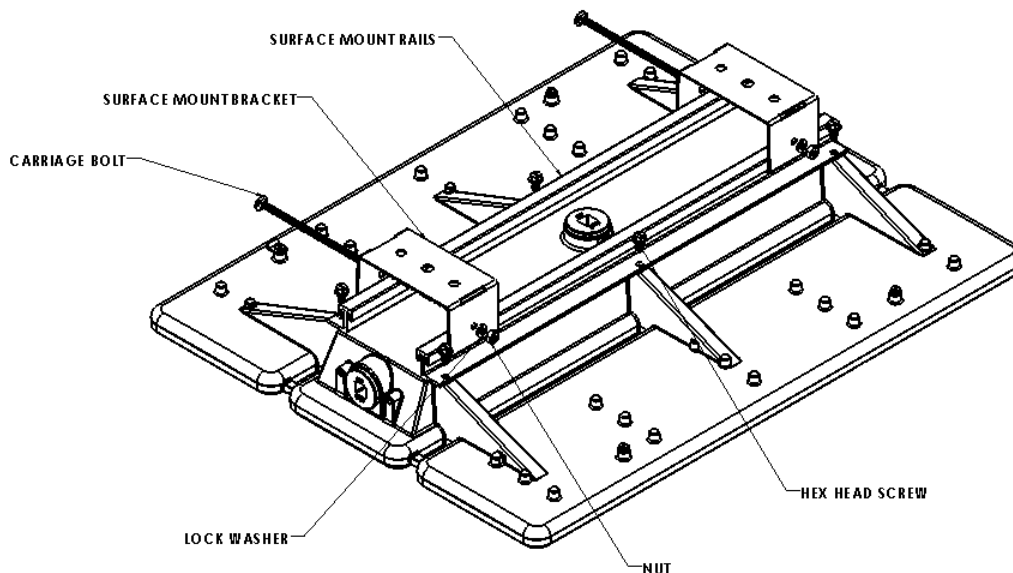

Figure D.1: 24L Surface Mount Option

SECTION E: INSTALLATION – 4FT SURFACE MOUNT
(NOT AVAILABLE WITH THE UPLIGHT OPTION)

- 1) Follow Steps 3-4 from Section C
- 2) Attach surface mount brackets to structure; hardware needed to mount brackets is not supplied. Two surface mount brackets **MUST** be used on all configurations.
- 3) Support fixture while attaching fixture into surface mount brackets. Ensure fixture is balanced.
- 4) Use supplied hardware to tighten surface mount brackets around center channel as shown below. Tighten bolts to 13 in/lbs.

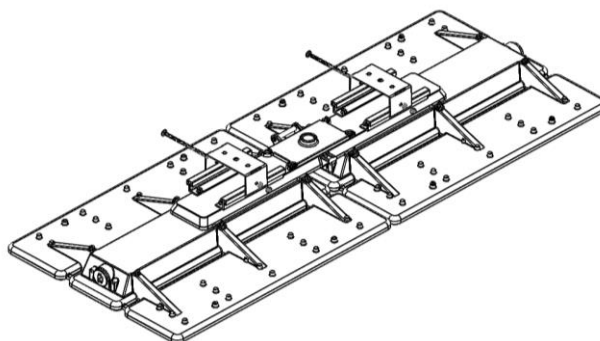

Figure E.1: 48L Surface Mount Option

SECTION F: INSTALLATION – PENDANT MOUNT

- 1) Back out the pendant set screw far enough to ensure that it will not interfere with the pipe threads.
- 2) Remove top 3/4" plug on threaded entry if present
- 3) On used entries, apply thread sealant to entry threads, then install conduit and wipe off any excess thread sealant.
- 4) Pull Input wires through pendant entry and connect input wires black to black, white to white and green to green. Use only UL listed connectors rated 90°C or greater. Supply Wire must meet applicable electrical codes and be rated for a minimum of 90°C Purple and Pink (or Gray) wires are low voltage dimming leads (0-10V).
- 5) Thread fixture onto pipe at least (5) full turns until secure. Mounting structure shall support the full weight of the luminaire in accordance with local codes.
- 6) Tighten pendant set screw to 25-35 in/lbs.

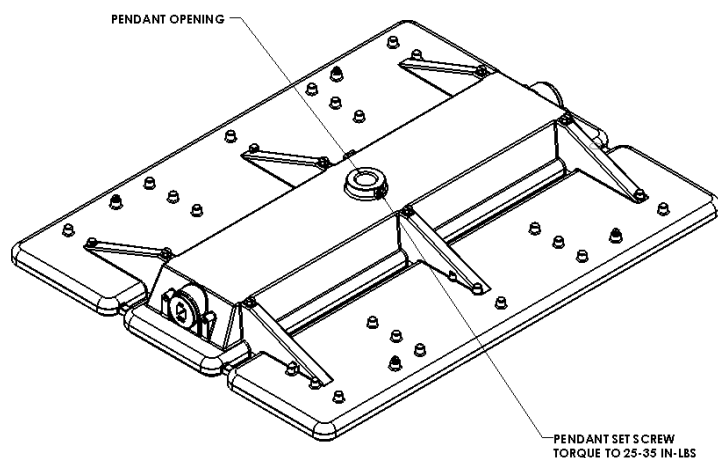

Figure F.1: 24L Pendant Mount Location

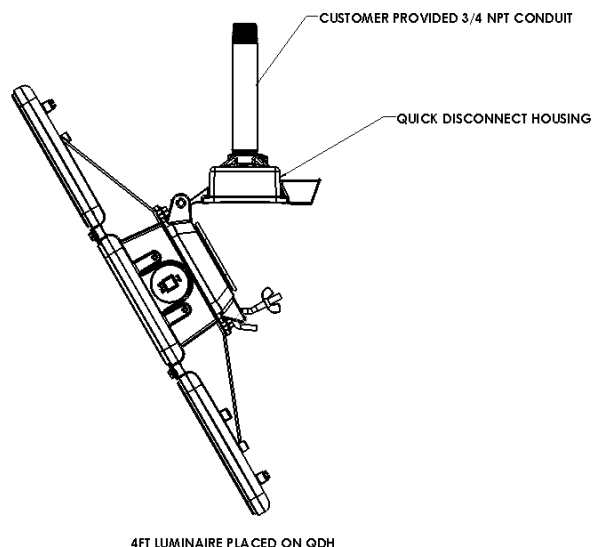

Figure F.2: 48L Pendant Mount

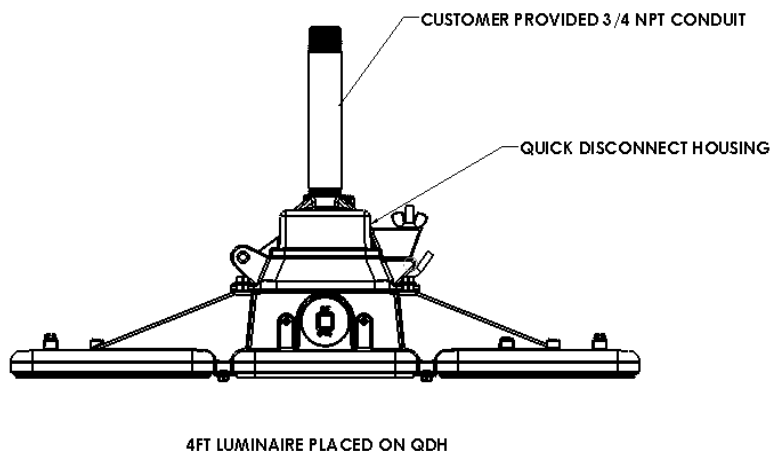

Figure F.3: 48L Pendant Mount

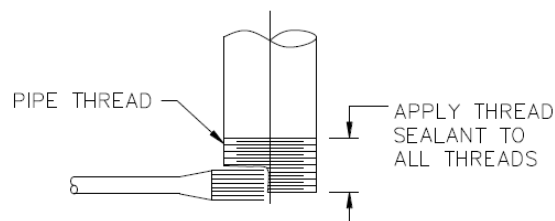

Figure F.4: Detail View of Application of Thread Sealant

SECTION G.1: INSTALLATION – YOKE MOUNT
(NOT AVAILABLE WITH THE UPLIGHT OPTION)

- 1) Loosen the set screw located on the electrical housing. (See Figure G.1)
- 2) Provide 2X 3/8" diameter fasteners suitable for supporting the luminaire and install the top cover with yoke mount to the structure via the yoke arm bracket.
- 3) Using a 3/4" socket, loosen the angle adjustment bolts until the yoke arm bracket can be rotated. Rotate the arm to the desired angle and tighten both angle adjustment bolts 45-50 FT-LBS
- 4) Route supply wires through pendant entry and thread conduit into top cover (5) full turns until secure. Mounting structure shall support the full weight of the luminaire in accordance with local codes.
- 5) Tighten pendant set screw to 25-35 in/lbs.
- 6) Yoke Mount maximum rotation range: 0-30°

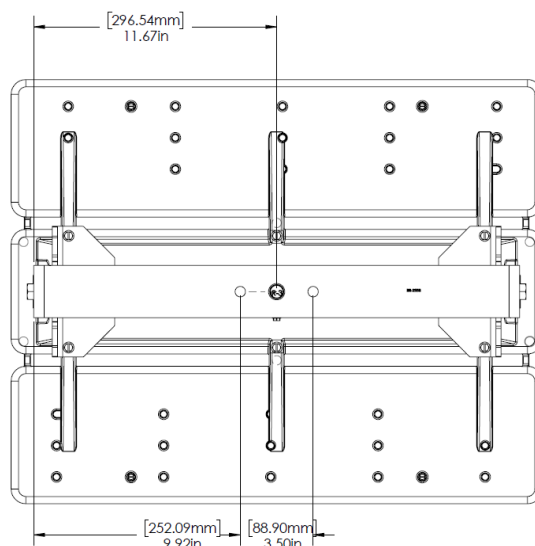
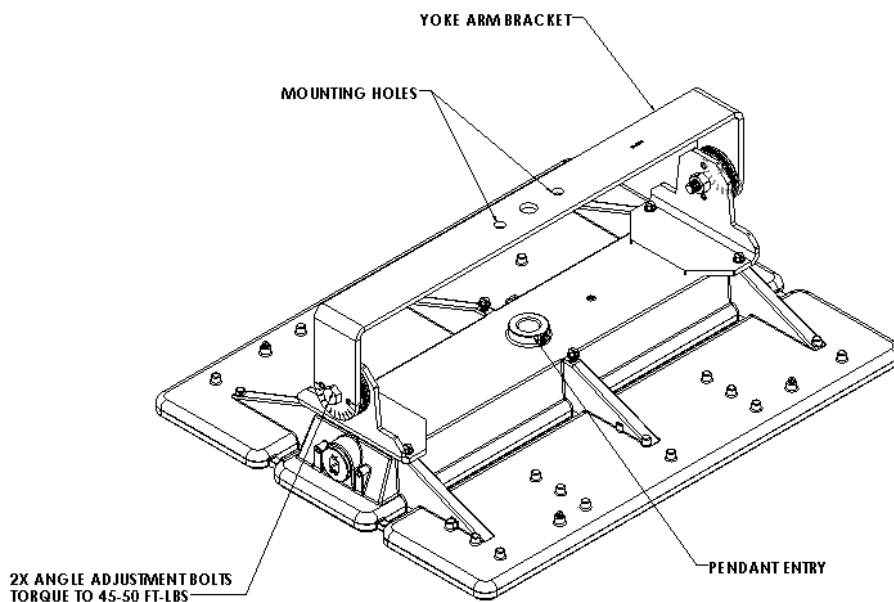

Figure G.1: Yoke Mount Option

Section H: Installation – External Occupancy Sensor

Snap-In Sensors:

- 1) External Occupancy sensor will be pre-wired to the fixture.
- 2) Install external occupancy sensor to fixture by snapping into sensor housing as shown in the figure H.1 below.
- 3) Rotate/Align the sensor head such that the sensor lens is parallel to the floor.
- 4) Install fixture based on specified mounting instructions.

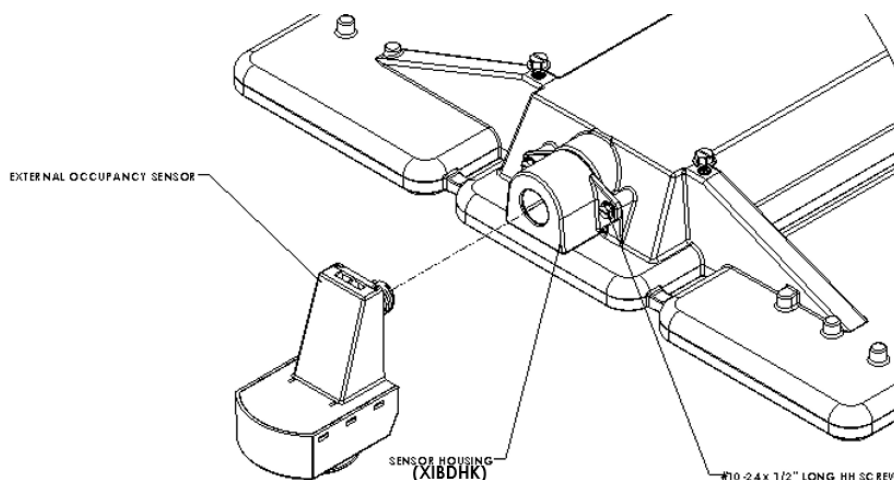

Figure H.1: Snap-In Sensor

Section I: Wiring – Backup Battery Option (E15WMCP, IE18WCPHECW)

- 1) Install fixture based on specified mounting instructions.
- 2) Input Wires will be located outside of the pendant mount feature. Connect un-switched power to fixture wires labeled un-switched. Connect switched power to white, black, and green wires. Supply wire must meet applicable electrical codes and be rated for a minimum of 90°C. Purple and pink (or gray) leads are 0-10V (low voltage) dimming leads.
- 3) If using the E15WMCP or IE18WCPHECW, press the indicator light for testing.

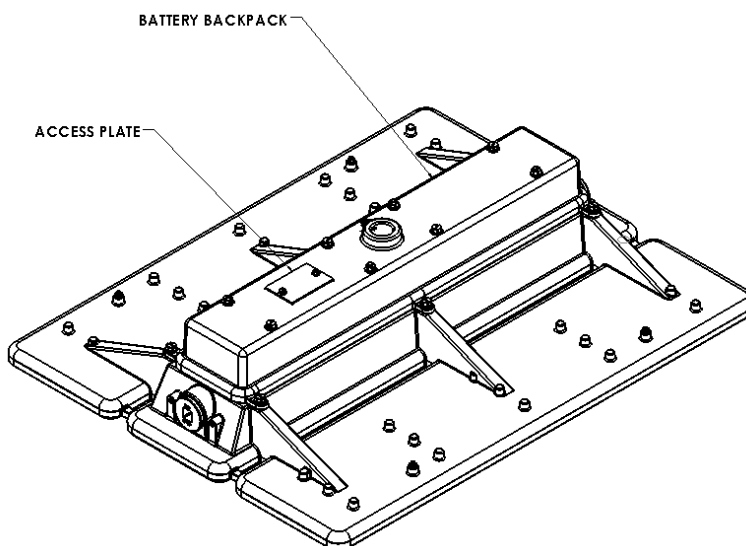

Figure I.1: Battery Backup Backpack

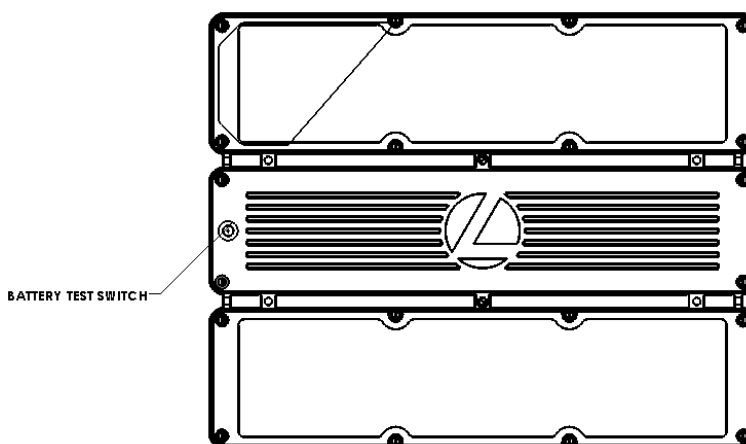

Figure I.2: Emergency Indicator Light

SECTION J: SERVICING

- 1) Clean fixture as needed. Double check all mounting hardware.
- 2) After installation, wear protective gloves if the lens needs to be removed.
- 3) If replacing driver, ensure to disconnect all power to the LED high bay being service. Read LED safety instructions on page 1
- 4) To access the driver, remove the six screws securing the driver channel door to the driver housing/
- 5) Tag wiring before removing the bad driver. Install new driver in the same location. Follow wiring diagram on driver. Use only UL listed 90°C (or greater) wiring and connectors. Make sure to push all wiring back into the driver housing before rotating the driver housing to closed position. Do not let wiring get caught outside the two assemblies.
- 6) The driver and surge protector are the two components that are field replaceable.

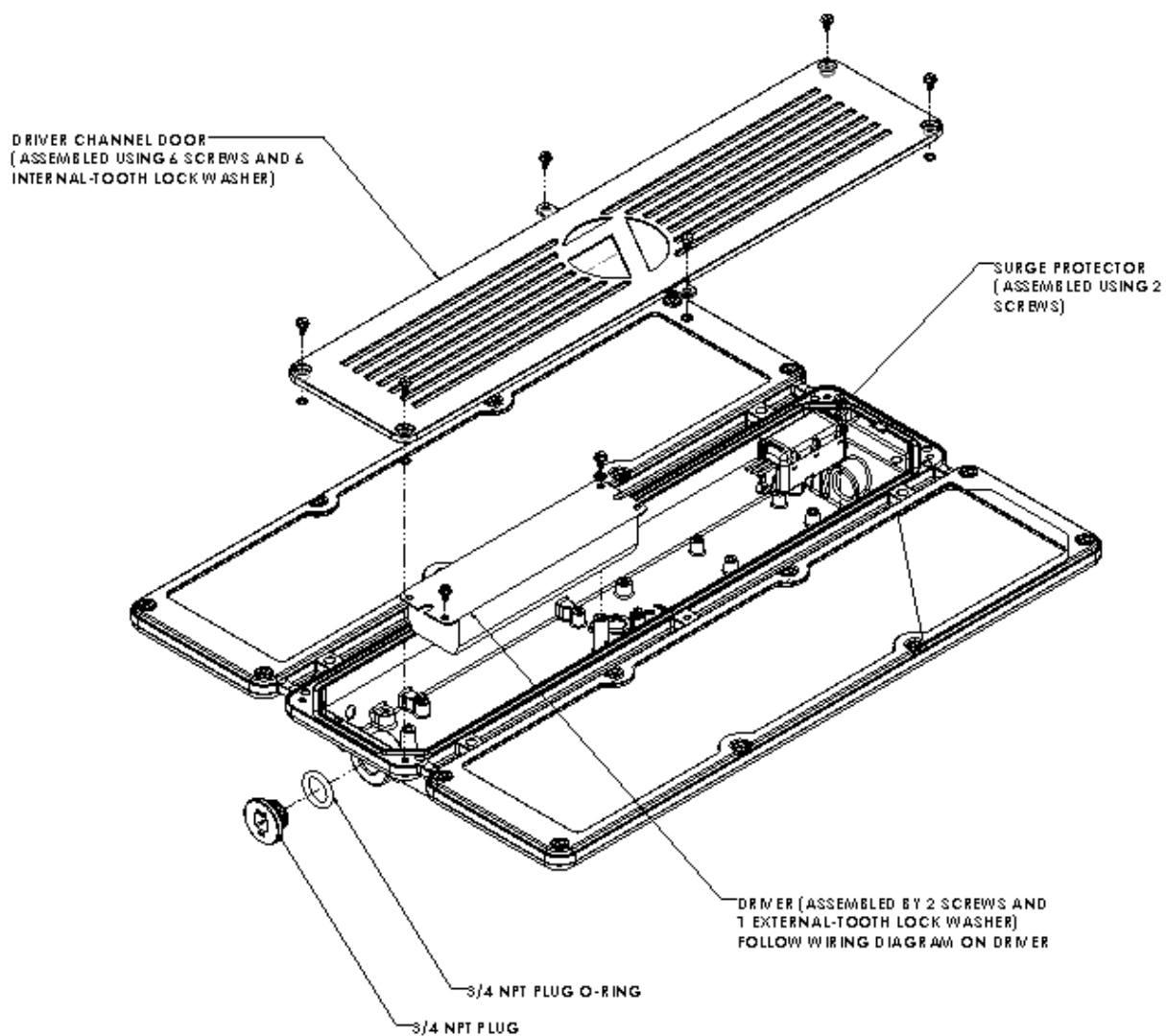

Figure J.1: Driver Channel Exploded View