

FEATURES & SPECIFICATIONS

INTENDED USE — Recessed airtight housing rated IC or Non-IC. For new construction (2x8) only. Utilizes GU24 line-voltage lamp base, offering affordable way to meet local energy codes and/or rebate requirements. The GU24 lamps are self-ballasted, allowing the end user to choose a lamp up to 26 watts without having to install a ballast.

Approved for all ceiling and wiring types.

Approved for direct burial in insulation.

CONSTRUCTION — Air-tight standard. Tested to meet current energy codes.

Aluminum housing with galvanized steel pan that includes gasket to meet California Title 24 Code.

Galvanized bar hangers span up to 24" o.c. and feature built-in nailer and integral T-bar clips. Two locking screws hold fixture in position.

Galvanized steel junction box with four built-in Romex clamps; five ½" and two ¾" nominal knockouts with slots for pryout. Rated for through-branch wiring.

Maximum 4 (2 in, 2 out) No 12 AWG conductors. Rated for 90° C.

Ground wire provided.

Removable J-box doors for easy access.

Trim retention (TOR): Two side-mounted torsion springs on the trim and 2 receiving brackets in the can ensure a consistently tight fit with the ceiling.

ELECTRICAL — Floating GU24 socket attaches to the top of the trim to ensure proper and consistent lamp position. For use with GU24 compact fluorescent lamps (max. 26W).

Socket clips to top of housing to prevent paint overspray in socket screw shell.

120 volts only.

INSTALLATION — Airtight housing suitable for airtight installations. Refer to energy codes for proper installations.

2 x 8 wood joist or T-bar installation. Expandable bar hangers allow for off-center mounting in wood joist or T-bar ceilings.

Length of 25¼" maximum 13¼" minimum or cut to fit 9" on center joist construction.

Vertical adjustment of housing allows for flush mounting with ceiling face.

Suitable for ceilings up to 1-1/2" thick.

LISTINGS — CSA certified to U.S. and Canadian safety standards. California Title 24 compliant.

Damp location listing.

WARRANTY — 1-year limited warranty. Complete warranty terms located at www.acuitybrands.com/CustomerResources/Terms_and_conditions.aspx

Actual performance may differ as a result of end-user environment and application.

Note: Specifications subject to change without notice.

| |
|----------------|
| Catalog Number |
| Notes |
| Type |

6" GU24-Socket Housing

L7X GU24

LINE VOLTAGE
IC/Non-IC
New Construction

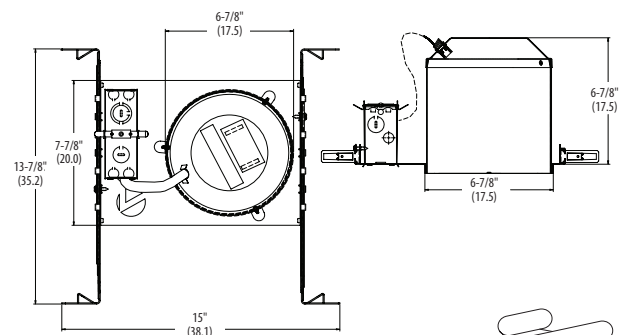

Specifications

Height: 6-7/8 (17.48)

Length: 15 (38.1)

Width: 13-7/8 (35.24)

Ceiling opening: 7 (17.8)

All dimensions are inches (centimeters).

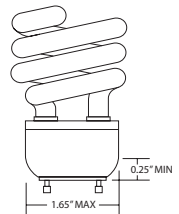

Lamp base diameter must not exceed 1.65" for the first 0.25" from the bottom.

ORDERING INFORMATION

For shortest lead times, configure product using standard options (shown in **bold**).

Example: L7X GU24 R6

| L7X GU24 | | | |
|-----------------|----------------------|--|---|
| Series | Voltage | Options | Packaging |
| L7X GU24 | (blank) 120 | (blank) Foam gasketing, aids in airtight installation | R6 Resale pack of six U Unit (non-stock) |

| Accessories: Order as separate catalog number. | |
|--|----------------------|
| ATK6 R6 | 6" Airtight trim kit |
| HS6875 | 6-7/8" Hole saw |

Note

See trim summary on reverse side for maximum wattages.

L7X GU24 6" Airtight IC Housing with GU24 Lamp Base

| Description Catalog number | Maximum wattage Sheet number | Description Catalog number | Maximum wattage Sheet number |
|-------------------------------|---------------------------------|-------------------------------|---------------------------------|
|-------------------------------|---------------------------------|-------------------------------|---------------------------------|

General/Task

Open Wide Flange - Shallow

C01 TOR White
C01BN TOR Brushed nickel
C01ORB TOR Oil-rubbed bronze



13-Watt
GU24 CFL

IC/Non-IC

Open Narrow Flange

702 TOR White
702MW TOR Matte white
702BN TOR Brushed nickel
702ORB TOR Oil-rubbed bronze



26-Watt
GU24 CFL

IC/Non-IC

Open Wide Flange

703 TOR White



26-Watt
GU24 CFL

IC/Non-IC

Baffle Wide Flange - Shallow

CB1 TOR Black
CB1W TOR White



15-Watt
GU24 CFL

IC/Non-IC

Baffle Narrow Flange

7B2 TOR Black
7B2W TOR White
7B2MW TOR Matte white
7B2BN TOR Brushed nickel
7B2ORB TOR Oil-rubbed bronze



26-Watt
GU24 CFL

IC/Non-IC

Baffle Wide Flange

7B3 TOR Black
7B3W TOR White



26-Watt
GU24 CFL

IC/Non-IC

Accent/Adjustable

Eyeball Wide Flange

7E1 TOR White
7E1MW TOR Matte white
7E1BN TOR Brushed nickel
7E1ORB TOR Oil-rubbed bronze



26-Watt
GU24 CFL

IC/Non-IC