

THE STAIR LIGHTER TSL9

Vandal Resistant

TSL9 Series LED



Fixture Type	Date
Job Name	Approved By
Catalog Number	

SPECIFICATIONS

ADA
ADA Compliant



Description	The Stair Lighter TSL9 series is highly optimized for use in unattended stairwells by combining rugged vandal resistant construction with state-of-the-art sensor control. The purpose-built shape of the Stair Lighter provides optimal photometric distribution for stairway lighting while the optical pattern punched into the housing allows for protection of the occupancy sensor without reducing its effectiveness. Available with multiple battery back-up options, the Stair Lighter will perform in the wall or ceiling mount position.
Housing	Die formed 18 gauge cold rolled zinc coated steel. Finished with electrostatically applied polyester powder coat.
Lens	Extruded UV stabilized polycarbonate with integral prisms. Maximum wall thickness 0.160". Secured to housing with injection molded end caps and 2 captive stainless steel TORX® head screws.
End Caps	Injection molded UV stabilized polycarbonate with a minimum wall thickness of 0.140". Secured to housing with 2 captive stainless steel TORX® head screws per side. Provisions for surface conduit entry.
Sensor	Ultrasonic zoneless activated sensor technology uses Doppler Effect to monitor volumetric space. Factory default of 15 minute time out. For ceiling heights above 20', sensitivity of occupancy sensor may be reduced.
Drivers	0-10V integral driver.
LED	Samsung LM561B+ series @ 2700K, 3000K, 3500K or 4000K, 5000K and 82 CRI wired in parallel-series. L ₇₀ projected life of over 130,000 hours at 50°C.
Listings	U.L., C.UL. Damp Location Listing standard.
Government Procurement	BAA – Buy America(n) Act: Product qualifies as a domestic end product under the Buy American Act as implemented in the FAR and DFARS. Product also qualifies as manufactured in the United States under DOT Buy America regulations. BABA – Build America Buy America: Product qualifies as produced in the United States under the definitions of the Build America, Buy America Act. Please refer to www.acuitybrands.com/buy-american for additional information.
Warranty	Lifetime warranty against vandalism. Luminaire LED will repair or replace any fixture damaged due to vandalism for the lifetime of the installation. 10-year warranty on LED boards against operational defects. Tested in accordance with LM-80.
Note	Actual performance may differ as a result of end-user environment and application. All values are design or typical values, measured under laboratory conditions at 25 °C. Specifications subject to change without notice.

DIMENSIONAL DATA

	A	B	C
TSL9 15IN	16.49	9.40	3.46
TSL9 24IN	25.10	9.40	3.46
TSL9 34IN	37.10	9.40	3.46
TSL9 46IN	48.45	9.40	3.46

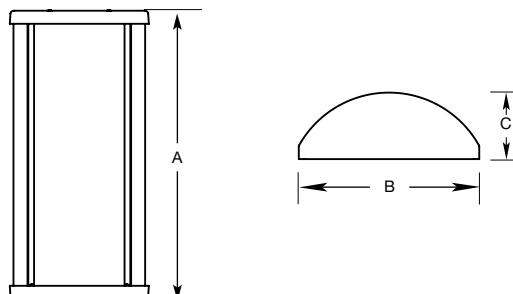

ORDERING INFORMATION

Example: TSL9 15N 25W 27K 120 CLP WHT

Series*	Size (Nominal)* ¹	Dual Drivers (Optional)	Wattage (Nominal)* ¹	CCT*	Voltage*
TSL9 Linear Vandal Resistant Stairwell Fixture with Occupancy Sensor	15IN	2DRV ² Two LED drivers for independent LED board operations	15W 50W	27K 2700K	120 120 Volt
	24IN		25W 80W	30K 3000K	277 277 Volt
	34IN		40W 100W	35K 3500K	MVOLT 120-277 Volt
	46IN		40K 4000K		
			50K 5000K		
			<i>To specify wattage, see size and wattage chart</i>		

Lens*	Finish*
CLP Clear Prismatic	BLK Black
OP Opal	WHT White
	BRZ Bronze
	GRY Gray
	CUST Custom Color, Consult Factory
	RALTB Ral Paint finishes
RALTB for pricing only. Replace with applicable RAL call out when ready to order. See the RAL BROCHURE for available options	

Emergency			
EMB310 ³	Self contained, 90 minute emergency battery pack. 0°C (32°F) to 55°C (131°F). 1200 lumens	EMB125R ⁵	Remote inverter that will operate a maximum 125W load for 90 minutes. 20°C (68°F) to 30°C (86°F)
EMB310T20 ³	Self contained, 90 minute emergency battery pack. 0°C (32°F) to 55°C (131°F). Meets CA Title 20 standards. 1200 lumens	EMB250R ⁵	Remote inverter that will operate a 250W maximum load for 90 minutes. 20°C (68°F) to 30°C (86°F)
EMB722 ^{3,4}	Self contained, 90 minute emergency battery pack for 25W operation only. 0°C (32°F) to 60°C (140°F). 2600 lumens	EMB375R ⁵	Remote inverter that will operate a 375W maximum load for 90 minutes. 20°C (68°F) to 30°C (86°F)

Fusing	Photocell	Sensors*	Hardware
GLR ⁵ Fuse and Fuse Holder	PC ⁵ Photoelectric Switch	FAM7 ⁶ Field Adjustable; low dimming levels of 50%, 35%, 20% 10%. NOCC No occupancy sensor ONOFF50 ⁷ 50% LED Sensored on/off ONOFF All boards sensed on/off	PHSC Phillips Head screws instead of TORX® head

*Required

Ordering Notes

- See Size and Wattage Chart.
- 2DRV not available in 15IN with 25W.
- Not available in 15IN.
- Not available in 24IN.
- Not available with MVOLT.
- FAM7 not available in 15IN with 2DRV.
- ONOFF50 not available in 15IN with 25W.

Accessories: Order as separate catalog number

TXSD TORX® Screwdriver Bit
Initial shipment includes one (1) TXSD per fixture.

SIZE & WATTAGE CHART

Size	Wattage
TSL9 15IN	15W 25W
TSL9 24IN	25W 50W
TSL9 34IN	40W 80W
TSL9 46IN	50W 100W

THE STAIR LIGHTER TSL9

Vandal Resistant

TSL9 Series LED

PHOTOMETRIC DATA

Model	Watts	Input Watts	Delivered Lumens		Delivered Lumens		Delivered Lumens		Delivered Lumens		Delivered Lumens	
			Clear	Opal	Clear	Opal	Clear	Opal	Clear	Opal	Clear	Opal
			2700K		3000K		3500K		4000K		5000K	
TSL9 15IN	15W	13.2	1379	1279	1322	1225	1349	1251	1468	1361	1511	1401
TSL9 15IN	25W	26.4	2565	2378	2899	2278	2509	2325	2729	2530	2810	2606
TSL9 24IN	25W	27.8	3023	2803	3997	2687	2958	2742	3216	2982	3312	3070
TSL9 24IN	50W	55.6	5623	5213	5797	4997	5502	5100	5982	5546	6161	5712
TSL9 34IN	40W	39.9	4171	3867	3997	3704	4079	3781	4438	4114	4571	4237
TSL9 34IN	80W	80.3	7758	7192	7435	6890	7587	7032	8253	7651	8501	7880
TSL9 46IN	50W	57.1	6049	5608	5797	5374	5916	5484	6435	5966	6627	6144
TSL9 46IN	100W	114.6	11249	10430	10784	9996	11004	10201	11967	11096	12326	11429

PHOTOMETRIC DATA

MODEL TSL9 24IN 25W 40K OP

Delivered Lumens: 2,742 Lumens

Total Power: 26.3W

Testing was performed in accordance with IES LM-79-08

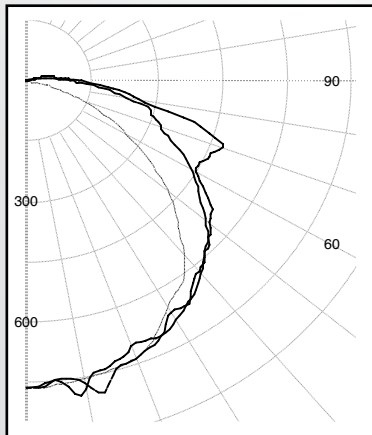

Zone	Lumens	% Lamps
0 - 30	612	22.3
0 - 40	1016	37.1
0 - 60	1863	67.9
60 - 90	773	28.2
0 - 90	2636	96.1
90 - 180	106	3.9
0 - 180	2742	100.0

MODEL TSL9 24IN 25W 40K OP

Delivered Lumens: 184 Lumens

Total Power: 2.62W

Testing was performed in accordance with IES LM-79-08

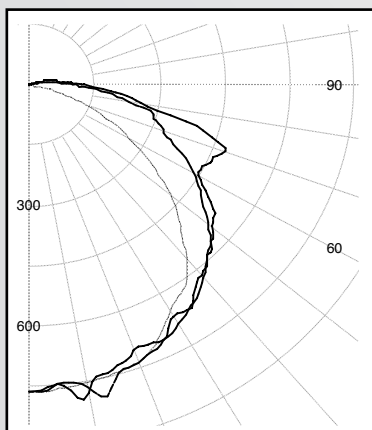

Zone	Lumens	% Lamps
0 - 30	41	22.3
0 - 40	61	37.0
0 - 60	125	67.8
60 - 90	52	28.2
0 - 90	177	96.0
90 - 180	7	4.0
0 - 180	184	100.0

PHOTOMETRIC DATA

MODEL TSL9 46IN 50W 40K CP

Delivered Lumens: 5,958 Lumens

Total Power: 57.1W

Testing was performed in accordance with IES LM-79-08

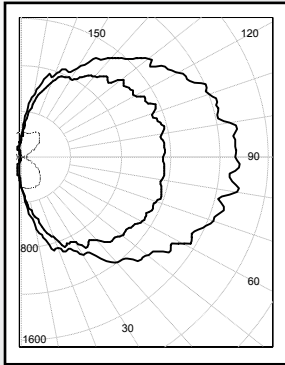

Zone	Lumens	% Lamps
0 - 30	328	5.5
0 - 40	613	10.3
0 - 60	1435	24.1
60 - 90	1600	26.8
0 - 90	3035	50.9
90 - 180	2924	49.1
0 - 180	5958	100.0

MODEL TSL9 46IN 50W 40K CP

Delivered Lumens: 842 Lumens

Total Power: 10.0W

Testing was performed in accordance with IES LM-79-08

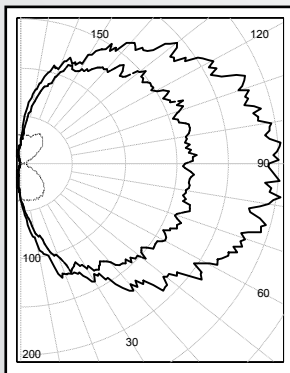

Zone	Lumens	% Lamps
0 - 30	46	5.5
0 - 40	87	10.3
0 - 60	203	24.1
60 - 90	226	26.8
0 - 90	429	50.9
90 - 180	413	49.1
0 - 180	842	100.0

MODEL TSL9 46IN 50W 40K OP

Delivered Lumens: 5,524 Lumens

Total Power: 57.1W

Testing was performed in accordance with IES LM-79-08

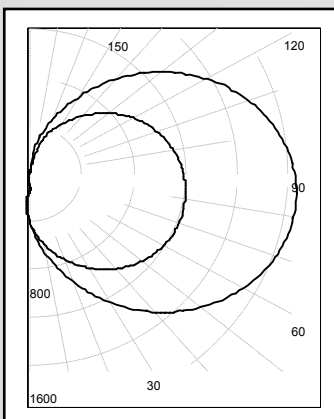

Zone	Lumens	% Lamps
0 - 30	270	4.9
0 - 40	510	9.2
0 - 60	1250	22.6
60 - 90	1577	28.6
0 - 90	2827	51.2
90 - 180	2697	48.8
0 - 180	5524	100.0

MOUNTING PLATE DETAILS

TSL9 15IN

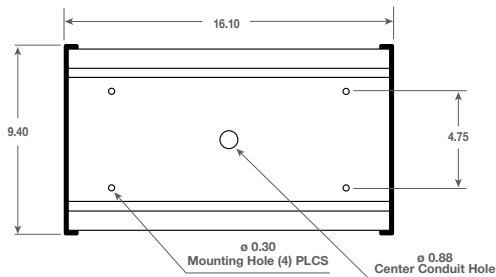

TSL9 24IN

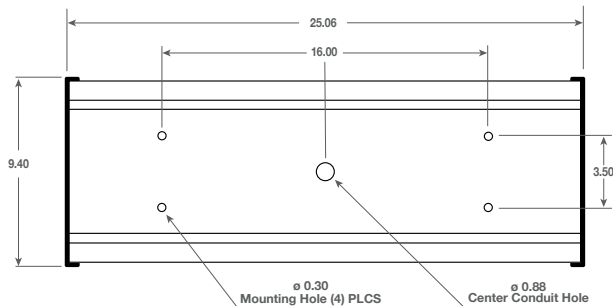

TSL9 34IN

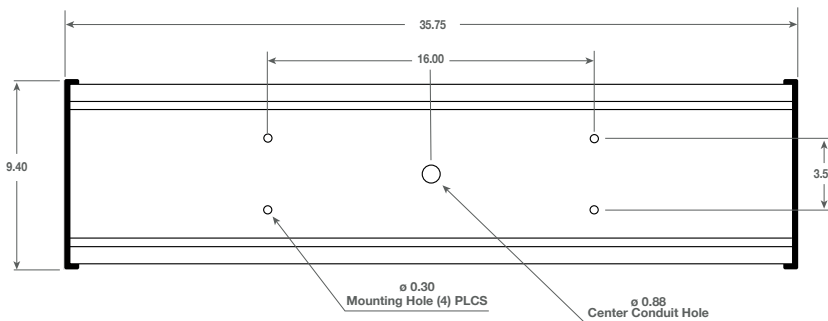

TSL9 46IN

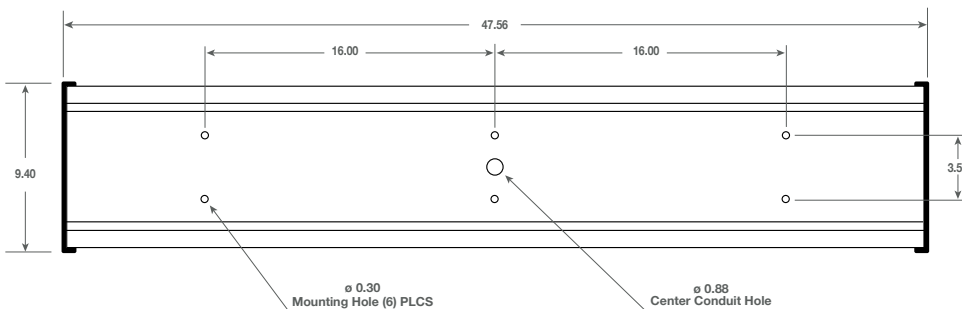

MOUNTING PLATE DETAILS

Knockout Detail

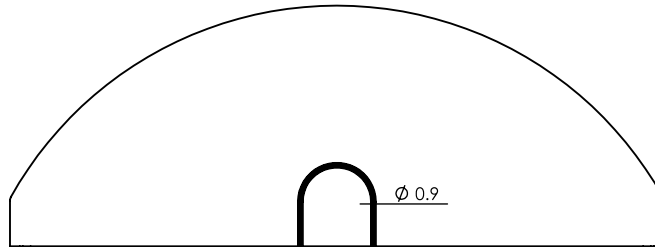

PRODUCT PHOTO

