

# VISION VPF12L Linear Vandal Resistant

VPF12L Series    LED



WALL / CEILING/  
PENDANT MOUNT  
Linear LED

Fixture Type	Date
Job Name	Approved By
Catalog Number	

## SPECIFICATIONS

**ADA**  
ADA Compliant



<b>Description</b>	The Vision VPF12L linear series features an all aluminum, ligature resistant construction which allows it to be used in nearly any environmental condition. Designed in conjunction with an ophthalmologist, the polycarbonate lens provides complete control of glare and LED image while maintaining the high efficiency of clear optical material. The Vision VPF12L linear series can be row mounted to any length. Natatorium finish is standard for all versions of this fixture.
<b>Housing</b>	Marine grade heat treated extruded aluminum. Finished with Super Durable Corrosion Resistant powder coat (SDCR) that meets AAMA 2605 high performance specification, providing superior UV durability and corrosion resistance. Salt spray test: 4,000 hours.
<b>Lens</b>	Extruded UV stabilized polycarbonate with integral prisms. Maximum wall thickness 0.160". Secured to housing with die cast aluminum clamps and stainless steel TORX® head screws.
<b>End Caps</b>	Die cast marine grade aluminum with conduit knockouts that are visible from interior of end cap.
<b>Drivers</b>	Dimming to 1%, 10% or Non-Dimming Driver is also available.
<b>LED</b>	Samsung LM561B+ series @ 2700K, 3000K, 3500K, 4000K, or 5000K and 82 CRI wired in parallel-series. L <sub>70</sub> projected life of over 130,000 hours at 50°C.
<b>UL Listing</b>	U.L., C.U.L. Damp Location Listing standard, Wet Location Listing optional.
<b>Government Procurement</b>	<b>BAA – Buy America(n) Act:</b> Product qualifies as a domestic end product under the Buy American Act as implemented in the FAR and DFARS. Product also qualifies as manufactured in the United States under DOT Buy America regulations. <b>BABA – Build America Buy America:</b> Product qualifies as produced in the United States under the definitions of the Build America, Buy America Act. Please refer to <a href="http://www.acuitybrands.com/buy-american">www.acuitybrands.com/buy-american</a> for additional information.
<b>Warranty</b>	<b>Lifetime</b> warranty against vandalism. Luminaire LED will repair or replace any fixture damaged due to vandalism for the lifetime of the installation. <b>10-year</b> warranty on LED boards against operational defects. Tested in accordance with LM-80.
<b>Note</b>	Actual performance may differ as a result of end-user environment and application. All values are design or typical values, measured under laboratory conditions at 25 °C. Specifications subject to change without notice.

## DIMENSIONAL DATA

	A	B	C
VPF12L 2FT	27.62	12.40	3.97
VPF12L 3FT	37.72	12.40	3.97
VPF12L 4FT	49.72	12.40	3.97

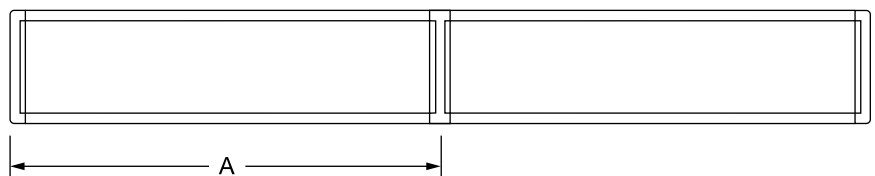
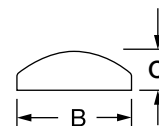

## ORDERING INFORMATION

Example: VPF12L LSL 8FT MSL2 NODIM 40W 27K 120 CLP WHT

Series*	Linear Plan*	Total Run Length*	Max Section Length* <sup>1</sup>	Drivers*
VPF12L Vandal Resistant Surface Mount 12" wide ADA Compliant Luminaire, joined for Linear Run	LSL Linear Same Length	_FT Total Run Length in Feet MAX. 100FT <i>Total Length of the Linear Run. Cannot Combine Different Fixture Lengths per run. See chart on page. 3</i>	MSL2 2FT MSL3 3FT MSL4 4FT <i>Choose only ONE length per linear run.</i>	MIN10 <sup>2</sup> Dimming to 10% MIN1 Dimming to 1% NODIM Non-Dimming Driver

Dual Drivers	Wattage* <sup>1</sup>	CCT	Voltage*	Lens*	Finish*
2DRV Two LED drivers for Independent LED Board Operations	40W 80W 160W 50W 100W 60W 125W <i>See Chart on Page 3 for Available Wattage per Fixture Length</i>	27K 2700K 30K 3000K 35K 3500K 40K 4000K 50K 5000K	120 120 Volt 277 277 Volt MVOLT 120-277 Volt 347 347 Volt	CLP Clear Prismatic OP Opal	BLK Black WHT White BRZ Bronze GRY Gray SIL Silver CUST Custom Color, Consult Factory RALTBD Ral Paint finishes <i>RALTBD for pricing only. Replace with applicable RAL call out when ready to order. See the RAL BROCHURE for available options</i>

\*Required

## OPTIONS

Emergency <sup>2</sup>	
#EMB310 <sup>3</sup> Self contained, 90 minute emergency battery pack. 0°C (32°F) to 55°C (131°F). 1200 lumens	#EMB125R <sup>5</sup> Remote inverter that will operate a maximum 125W load for 90 min. 20°C (68°F) to 30°C (86°F)
#EMB310ST <sup>3,4</sup> Self-testing, self contained, 90 minute emergency battery pack. 0°C (32°F) to 55°C (131°F). Meets CA Title 20 Standards. 1000 lumens	#EMB250R <sup>5</sup> Remote inverter that will operate a 250W maximum load for 90 min. 20°C (68°F) to 30°C (86°F)
#EMB310T20 <sup>3,6</sup> Self contained, 90 minute emergency battery pack. 0°C (32°F) to 55°C (131°F). Meets CA Title 20 standards. 1200 lumens	#EMB375R <sup>5</sup> Remote inverter that will operate a 375W maximum load for 90 min. 20°C (68°F) to 30°C (86°F)
#EMB722 <sup>3,6,7</sup> Self contained, 90 minute emergency battery pack for 25W operation only. 0°C (32°F) to 60°C (140°F). 2600 lumens	<i>Location of battery pack defaults to the right side of the final fixture in the run, for other locations please consult factory.</i>

Pendant Type/Length	Back Box	Environment	Fusing	Photocell	Sensors <sup>11,12</sup>
<b>Rigid Stems</b> RG__ <sup>8,9</sup> (12" - 96") <i>Order in 12" increments up to 96".</i>	COR Corner mounted back box	WL <sup>8,9</sup> Wet Location	GLR <sup>10</sup> Fuse and Fuse Holder	PC <sup>10</sup> Photoelectric Switch	OCC <sup>14</sup> Microwave occupancy sensor mounted behind the lens. On/Off operation only. OCC50 <sup>13,14</sup> Microwave occupancy sensor. 50% of LED's constantly on and 50% sensed on/off. OCCBT Bluetooth connected microwave occupancy sensor mounted behind the lens. All LED board sensed to dim to 50%, 40%, 30%, 20%, or 10%, field selectable low levels. OCCFA <sup>14</sup> Microwave occupancy sensor mounted behind the lens. All LED board sensed to dim to 50%, 30%, 20%, or 10%, field selectable low levels. Factory standard preset of 50% dimming level and 20 minute time out

Nightlight (Consult Factory)	Mounting Hardware	Hardware
AMBNL Amber LED Night Light with peak wavelengths at 593nm. Requires separately controlled circuit	DRPCP <sup>8,9</sup> Aluminum drip cap finished with white polyester powder coat to be used when pendant mounted	PHSC Phillips Head instead of TORX® head
LEDNL LED Night Light with field adjustable levels matched to CCT of main source. Requires separately controlled circuit		
REDNL Red LED Night Light with field adjustable levels with peak wavelength at 621 nm. Requires separately controlled circuit. Consult factory for availability		

### Ordering Notes

- See Linear Run Chart.
- Not available with 347V.
- Not available with 160W.
- Not available MSL2.
- Not available with MVOLT.
- Not available in MSL2 with OCC, OCC50, OCCFA.
- Not available in MSL2 with 80W or 2DRV.
- Not available with COR.
- WL and DRPCP is required with Rigid Stems (RG\_).
- Not available with MVOLT or 347.
- Not available in 160W or 125W with 347V.
- Not available with EMB125R, EMB250R, EMB375R.
- Not available with 2DRV.
- Not available in 125W with EMB722.

**Accessories:** Order as separate catalog number.

TXSD TORX® Screwdriver Bit

*Initial shipment includes one (1) TXSD per fixture*

## LINEAR RUN CHART

Run Length (FT)	Max Section Length	Fixture Qty/Length	Available Wattages
4	MSL2	(2) 2FT	40W   50W   80W
6	MSL2	(3) 2FT	40W   50W   80W
	MSL3	(2) 3FT	60W   80W   125W
8	MSL2	(4) 2FT	40W   50W   80W
	MSL4	(2) 4FT	50W   80W   100W   160W
9	MSL3	(3) 3FT	60W   80W   125W
10	MSL2	(5) 2FT	40W   50W   80W
12	MSL2	(6) 2FT	40W   50W   80W
	MSL3	(4) 3FT	60W   80W   125W
	MSL4	(3) 4FT	50W   80W   100W   160W
14	MSL2	(7) 2FT	40W   50W   80W
15	MSL3	(5) 3FT	60W   80W   125W
16	MSL2	(9) 2FT	40W   50W   80W
	MSL4	(4) 4FT	50W   80W   100W   160W
18	MSL2	(9) 2FT	40W   50W   80W
	MSL3	(6) 3FT	60W   80W   125W
20	MSL2	(10) 2FT	40W   50W   80W
	MSL4	(5) 4FT	50W   80W   100W   160W
21	MSL3	(7) 3FT	60W   80W   125W
22	MSL2	(11) 2FT	40W   50W   80W
24	MSL2	(12) 2FT	40W   50W   80W
	MSL3	(8) 3FT	60W   80W   125W
	MSL4	(6) 4FT	50W   80W   100W   160W

## PHOTOMETRIC DATA

Model	Watts	Input Watts	Delivered Lumens		Delivered Lumens		Delivered Lumens		Delivered Lumens		Delivered Lumens	
			Clear	Opal	Clear	Opal	Clear	Opal	Clear	Opal	Clear	Opal
			2700K		3000K		3500K		4000K		5000K	
VPF12L 2FT	40W	41.0W	3999	3707	3835	3554	3913	3627	4255	3944	4382	4061
VPF12L 2FT	50W	54.7W	5335	4945	5117	4743	5221	4840	5676	5261	5846	5419
VPF12L 2FT	80W	82.0W	7999	7414	7672	7110	7828	7256	8510	7888	8765	8124
VPF12L 3FT	60W	61.5W	5999	5561	5754	5334	5871	5443	6382	5916	6573	6093
VPF12L 3FT	80W	82.0W	7999	7414	7672	7110	7828	7256	8510	7888	8765	8124
VPF12L 3FT	125W	123.0W	11999	11123	11508	10668	11743	10886	12765	11833	13147	12187
VPF12L 4FT	50W	54.7W	5335	4945	5117	4743	5221	4840	5676	5261	5846	5419
VPF12L 4FT	80W	82.0W	7999	7414	7672	7110	7828	7256	8510	7888	8765	8124
VPF12L 4FT	100W	109.0W	10632	9856	10198	9453	10406	9646	11311	10485	11651	10800
VPF12L 4FT	160W	164.0W	15997	9856	15343	14222	15656	14513	17018	15775	17528	16428

### MODEL VPF12L 4FT DCT 160W 40K CLP

Delivered Lumens: 15,758 Lumens

Total Power: 164.0W

Testing was performed in accordance with IES LM-79-08

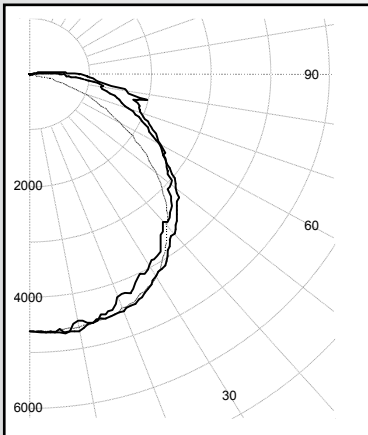

Zone	Lumens	% Lamps
0 - 30	3725	23.6
0 - 40	6163	39.1
0 - 60	11126	70.6
60 - 90	4141	26.3
0 - 90	15267	93.9
90 - 180	491	3.1
0 - 180	15758	100.0

## LINEAR RUN INFORMATION

	Left	Intermediate	Right	Single
MSL2	27.82	26.09	25.89	27.62
MSL3	38.03	36.30	36.10	37.83
MSL4	49.92	48.19	47.99	49.72

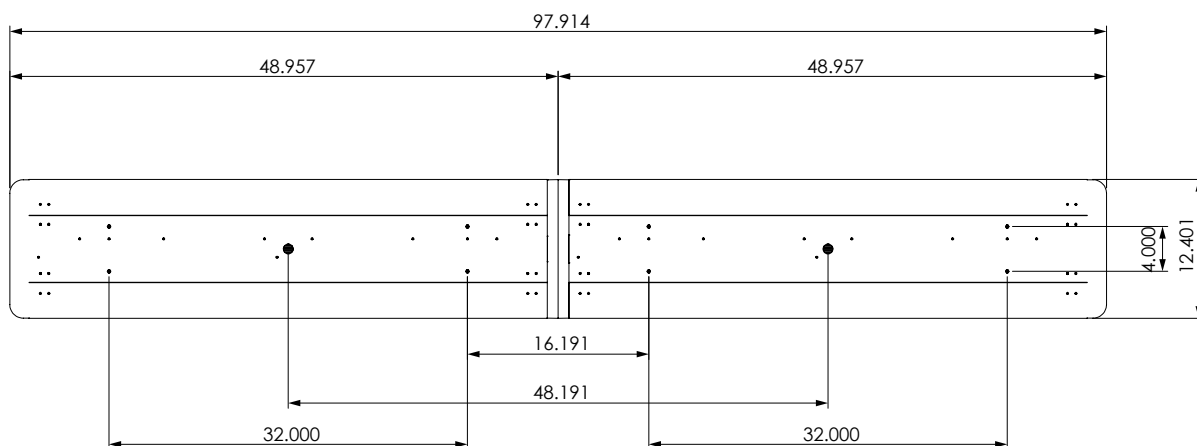

# VISION VPF12L Linear

Vandal Resistant

VPF12L Series LED

FIXTURE IMAGE

