

Type:

Project:

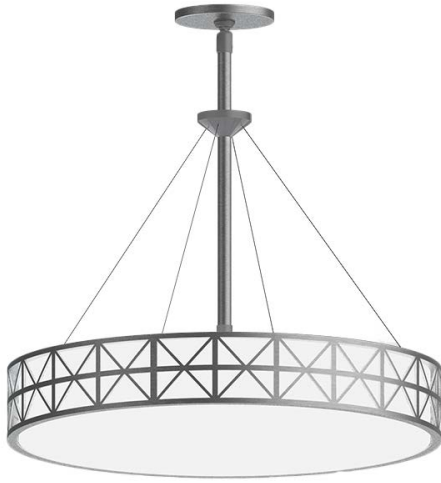

HIGHLIGHTS

- 12", 18", 24", 36", and 48" diameter sizes
- Up to 1800/1800 lumens direct/indirect in 18" diameter and 10500/11000 lumens direct/indirect in 48" diameter size
- Five distinct trim patterns
- Two stem support options
- Four static white color temperatures in two CRI options
- nLight® enabled system networking
- 0-10v dimming or Lutron® dimming option
- Remote emergency battery pack
- Available in (13) standard powder paint colors, (1) metal finish, and RAL or custom color possibilities
- Total System Integration features a 5-year limited warranty by Acuity Brands covering all components and construction

CONFIGURATION

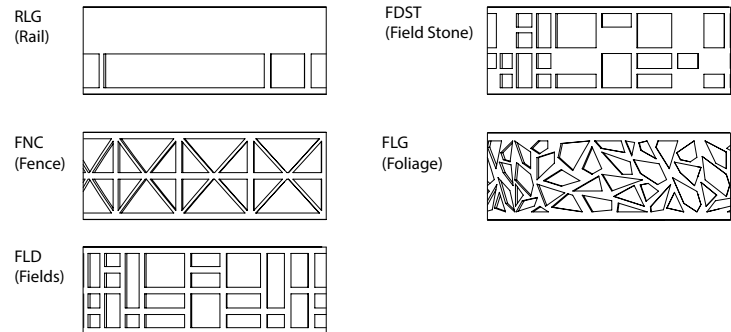

eldoLED



DIMENSIONS

*Reference Drawing Detail section for additional information

HPPS2 FLSH (FLUSH LENS)

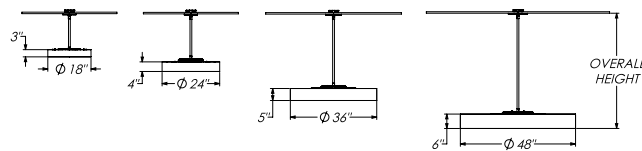

LUMEN OUTPUT

** Performance data based upon FLSH (Flush Lens) / FNC (Fence Pattern) / 35K/ 80CRI

DIRECT	18DIA	24DIA	36DIA	48DIA
Nominal Lumens	1800LM	3400LM	6000LM	10500LM
Delivered Lumens	2073	3329	6993	11588
Input Watts	20.90	34.19	72.41	110.67
Lumens/Watt	99.19	97.37	96.58	104.71

(Reference Performance Data section for additional lumen outputs.)

INDIRECT	18DIA	24DIA	36DIA	48DIA
Nominal Lumens	1800LM	3800LM	7000LM	11000LM
Delivered Lumens	1746	3506	6727	10333
Input Watts	15.54	32.65	66.81	97.92
Lumens/Watt	112.36	107.38	100.39	105.52

(Reference Performance Data section for additional lumen outputs.)

COMPANION LUMINAIRE(S)



HPSS4 RLG
Silhouette LED Pattern
Round Sconce



HPSS2 FLD
Silhouette LED Pattern
Vertical Sconce



HPCS2 FDST
Silhouette LED Pattern
Ceiling Mount



HPSS3 FLG
Silhouette LED Pattern
Horizontal Sconce

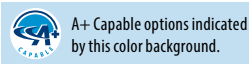

CATALOG NUMBER

Example: HPPS2 48DIA CBL 72HIGH 277 FLSH 10500LM 35K 80CRI I11000LM I35K I80CRI FDST ZT MIN1 DCT BGP

Series	Size	Stem Option	Overall Height	Voltage	Lens	Lumen Output
HPPS2 Silhouette Decorative Pattern Pendant	18DIA* 18" Diameter 24DIA 24" Diameter 36DIA 36" Diameter 48DIA 48" Diameter <i>*Remote driver always required</i> <i>*Not available with CBL stem option</i>	CBL* Cable Suspension Mount SGL Single Stem Mount <i>*Not available with 12, 18, 24, or 30HIGH in any diameter or in 48DIA with 36 or 42HIGH or with 18DIA size</i>	Available from 12HIGH thru 144HIGH in 6" increments 12HIGH* 12" Overall Height 30HIGH* 30" Overall Height 36HIGH** 36" Overall Height 48HIGH 48" Overall Height 54HIGH 54" Overall Height 60HIGH 60" Overall Height 78HIGH 78" Overall Height 144HIGH 144" Overall Height <i>* 12, 18, 24, & 30HIGH not available with CBL option</i> <i>** 36 & 42HIGH not available with CBL option in 48DIA only</i> <i>(Measured from bottom of ceiling to bottom of luminaire.)</i>	MVOLT 120-277 Volt 120* 120V 277* 277V 347** 347V <i>*Reference Remote Driver section for when voltage must be specified</i> <i>**Available with MIN1 and ZT only</i> <i>**Not available in 48DIA</i>	FLSH Flush Lens	<i>(Values shown represent the min and max range. Reference Performance Data section for full listing.)</i> For 18DIA use: 1100LM 1800LM For 24DIA use: 2000LM 3400LM For 36DIA use: 3500LM 6000LM For 48DIA use: 6000LM 10500LM

LED Color Temperature	LED Color Rendering	Indirect Lumen Output	Indirect LED Color Temperature	Indirect LED Color Rendering	Configuration
27K 2700K 30K 3000K 35K 3500K 40K 4000K	80CRI 80CRI 90CRI 90CRI	<i>(Values shown represent the min and max range. Reference Performance Data section for full listing.)</i> (blank) No Indirect Light Required For 18DIA use: 11200LM 11800LM For 24DIA use: 12200LM 13800LM For 36DIA use: 14000LM 17000LM For 48DIA use: 17500LM 111000LM	(blank) No Indirect Light Required 127K 2700K Indirect 130K 3000K Indirect 135K 3500K Indirect 140K 4000K Indirect	(blank) No Indirect Light Required 180CRI 80CRI Indirect 190CRI 90CRI Indirect	RLG Rail FNC Fence FLD Fields FDST Field Stones FLG Foliage

Control Input	Minimum Dimming Level	Circuits	Emergency	Finish
ZT 0-10V NLIGHT* nLight Enabled ECOD Lutron Hi-Lume EcoSystem Digital LED Driver, 1% dimming <i>*Requires remote driver(s)</i>	DARK Constant Current, Dimming to <1% MIN1 Constant Current, Dimming to 1%	DCT Dual Circuit SCT Single Circuit	E10WLCP* 10w Battery Pack, Constant Power with Self Diagnostic. T20 Compliant (remote) EMG** Emergency nLight Device for Use w Generator Supply EM Power <i>*Not available w/ 347</i> <i>**Available w/ NLIGHT only</i>	BA Brushed Aluminum ALP Aluminum Paint (Matte) BGP Black Gloss Paint BKT Black Textured Paint GGP Green Gloss Paint GW Gloss Paint White LBGP Light Blue Gloss Paint MBGP Medium Blue Gloss Paint MBP Medium Bronze Metallic Gloss Paint MGG Medium Green Gloss Paint OGP Orange Gloss Paint RGP Red Gloss Paint WHT White Textured Paint YGP Yellow Gloss Paint SGB Semi-Gloss Black GWAM Gloss White Antimicrobial MWAM Matte White Antimicrobial BZAM Bronze Antimicrobial

SPECIFICATIONS

Housing

Rolled and welded smooth aluminum extruded housing with hydro cut pattern trim detail.

Lens

Matte opal acrylic fabricated drum shape flush lens.

Stem

Available in a single stem support or a single stem support with angled stainless steel cables.

Finish

Color for housing, canopy, and stem assembly. Available in thirteen polyester powder paint solid colors and one metal finish. Consult factory for custom colors or specify RAL colors from Architectural brochure.

Mounting

Mount directly to a standard junction box (by others). For fixtures over 40 lbs, additional support to structure (by others) required.

Source

Multiple LED lumen packages provided with four available color temperature options (2700K, 3000K, 3500K, and 4000K) all within 2.5 MacAdam ellipses.

Circuiting

Offered in single (all on) or dual (indirect and direct) circuit with emergency circuits or nLight options.

Emergency Battery

Remote battery enclosure for battery operation of 90 minutes. Remote test switch and indicator light provided with wall/ceiling plate. Reference chart in the Remote Drivers section for calculating delivered lumens in emergency mode.

Controls and System Networking Options

Wired networking via Cat-5e (by others).

Dimming Driver

eldoLED® driver provides smooth, continuous and flicker-free dimming to dark <1%. THD: < 20%. Insignificant inrush current at 120 and 277VAC. FCC Class A and B tested for EMI and RFI. Driver will be set for Linear dimming curve. Lutron high-performance drivers options also available.

LED Life

LED light engine — consisting of modular LED boards — is rated for 60,000 hours (L80) at 25° C ambient temperature.

Environment

Suitable for dry or damp location.

Certification

CSA Certified to meet U.S. and Canadian standards conforming to UL 1598 and CAN/CSA C22.2 No. 250.0

Compliance

Buy American Act compliant

Government Procurement

BAA — Buy America(n) Act: Product qualifies as a domestic end product under the Buy American Act as implemented in the FAR and DFARS. Product also qualifies as manufactured in the United States under DOT Buy America regulations.

BABA — Build America Buy America: Product qualifies as produced in the United States under the definitions of the Build America, Buy America Act.

Please refer to www.acuitybrands.com/resources/buy-american for additional information.

Warranty

5-year limited warranty. This is the only warranty provided and no other statements in this specification sheet create any warranty of any kind. All other express and implied warranties are disclaimed. Complete warranty terms located at: www.acuitybrands.com/support/warranty/terms-and-conditions

Note: Actual performance may differ as a result of end-user environment and application.

All values are design or typical values, measured under laboratory conditions at 25°C.

Specifications subject to change without notice.

A+ Capable Luminaire

This item is an A+ capable luminaire, which has been designed and tested to provide consistent color appearance and out-of-the-box control compatibility with simple commissioning.

- All configurations of this luminaire meet the Acuity Brands' specification for chromatic consistency
- This luminaire is part of an A+ Certified solution for nLight® control networks when ordered with drivers marked by a shaded background*
- This luminaire is part of an A+ Certified solution for nLight control networks, providing advanced control functionality at the luminaire level, when selection includes driver and control options marked by a shaded background*

To learn more about A+, visit www.acuitybrands.com/aplus.

*See ordering tree for details

DIMENSIONS

FLSH (Flush Lens) with SGL (Single Stem Mount) Options

*OAH: Available 12HIGH thru 144HIGH in 6" increments

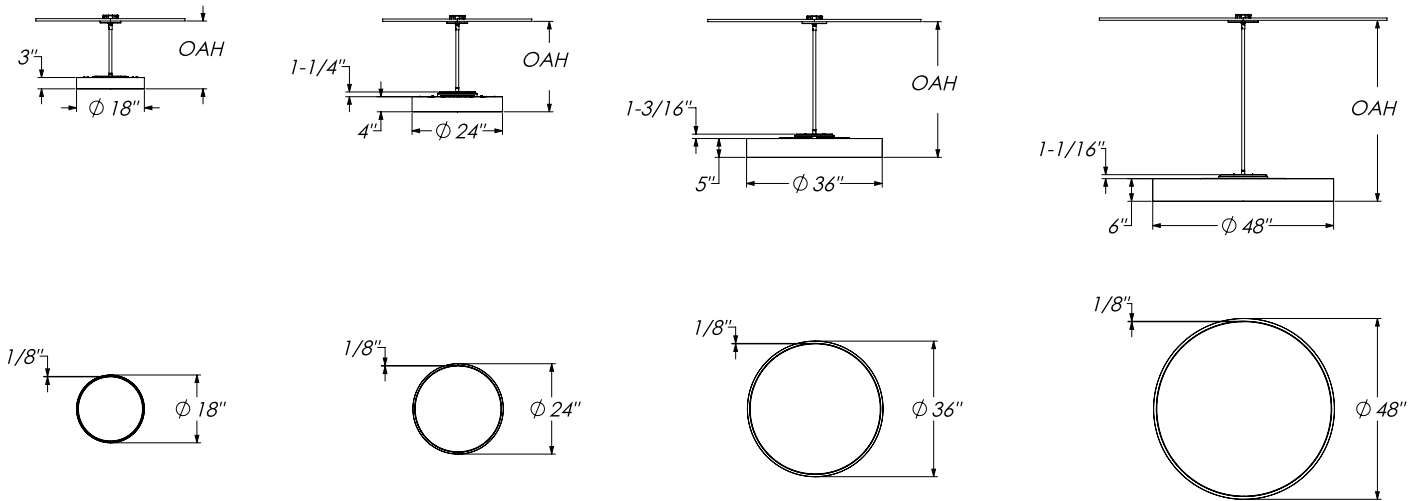

FLSH (Flush Lens) with CBL (Single Stem w/ Cable Accessory) Options

*OAH (For 24DIA and 36DIA): Available 36HIGH thru 144HIGH in 6" increments

*OAH (For 48DIA): Available 48HIGH thru 144HIGH in 6" increments

*CBL option not available on 18DIA

*Collar height is at set dimension noted. Only dimension above collar changes with different overall height selection.

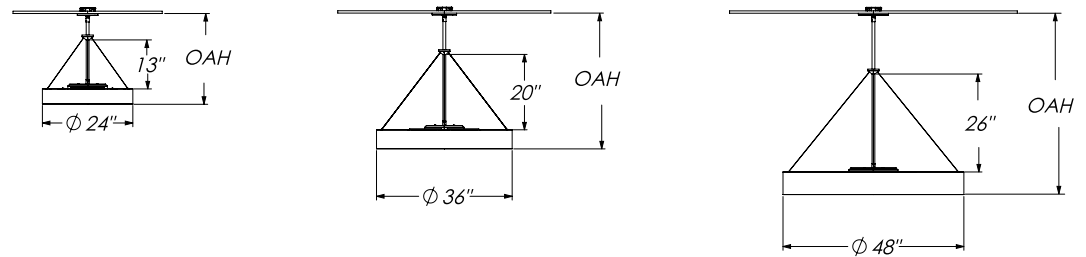

DIMENSIONS

Maximum Canopy Swivel Slope Angle

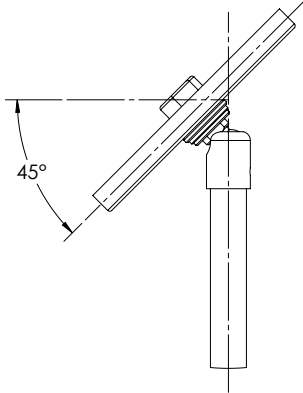

CBL Collar Detail

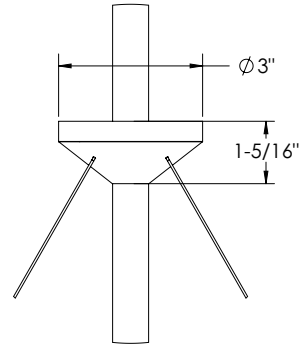

Canopy Dimension
(For 18DIA and 24DIA Configurations)

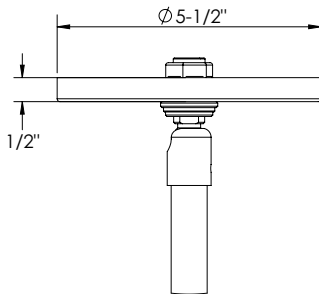

Canopy Dimension
(For 36DIA Configurations)

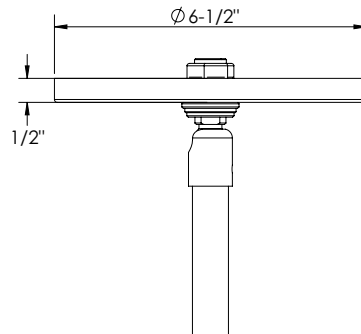

Canopy Dimension
(For 48DIA Configurations)

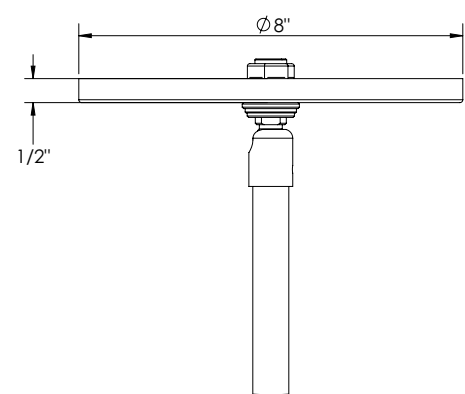

Isometric View of Indirect 24DIA

**Half-Batwing optic over indirect LED for spreading light*

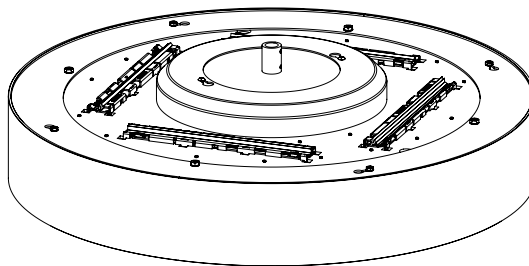

PERFORMANCE DATA

** Performance data based upon FLSH (Flush Lens) / FNC (Fence Pattern) / 35K/ 80CRI

Diameter	Direct Nominal Lumens	Delivered Lumens	Input Watts	Lumen/Watt
18DIA	1100LM	1265	11.89	106.39
	1450LM	1669	16.40	101.77
	1800LM	2073	20.90	99.19
24DIA	2000LM	1896	17.73	106.94
	2200LM	2101	20.09	104.58
	2400LM	2306	22.44	102.76
	2600LM	2510	24.79	101.25
	2800LM	2715	27.14	100.04
	3000LM	2920	29.49	99.02
	3200LM	3124	31.84	98.12
36DIA	3400LM	3329	34.19	97.37
	3500LM	3720	33.71	110.35
	4000LM	4374	41.45	105.52
	4500LM	5029	49.19	102.24
	5000LM	5684	56.93	99.84
48DIA	5500LM	6339	64.67	98.02
	6000LM	6993	72.41	96.58
	6500LM	7727	70.09	110.24
	7000LM	8370	76.86	108.90
	7500LM	9014	83.62	107.80
	8000LM	9657	90.38	106.85
	8500LM	10301	97.15	106.03
	9000LM	10945	103.91	105.33
	9500LM	11588	110.67	104.71
	10000LM			
	10500LM			

Diameter	Indirect Nominal Lumens	Delivered Lumens	Input Watts	Lumen/Watt
18DIA	1200LM	1162	9.98	116.43
	1500LM	1454	12.76	113.95
	1800LM	1746	15.54	112.36
24DIA	2200LM	1986	16.30	121.84
	2400LM	2176	18.35	118.58
	2600LM	2366	20.39	116.04
	2800LM	2556	22.44	113.90
	3000LM	2746	24.48	112.17
	3200LM	2936	26.52	110.71
	3400LM	3126	28.57	109.42
36DIA	3600LM	3316	30.61	108.33
	3800LM	3506	32.65	107.38
	4000LM	3743	31.32	119.51
	4500LM	4241	37.24	113.88
	5000LM	4738	43.15	109.80
48DIA	5500LM	5235	49.07	106.68
	6000LM	5733	54.99	104.26
	6500LM	6230	60.90	102.30
	7000LM	6727	66.81	100.69
	7500LM	7077	68.86	116.28
	8000LM	7543	66.15	114.03
	8500LM	8008	71.45	112.08
	9000LM	8472	76.74	110.40
	9500LM	8938	82.04	108.95
	10000LM	9403	87.33	107.67
	10500LM	9868	92.63	106.53
	11000LM	10333	97.92	105.52

Lumen Multiplier Table for CCT and CRI - DIRECT

Data table baseline is 3500K 80CRI photometry. This table can be used to approximate the lumen values at different Kelvin temperatures and Color Rendering Index. Power consumption would stay the same.

CCT	CRI	Multiplier
27K	80	0.941
30K	80	1.000
35K	80	1.000
40K	80	1.029
27K	90	0.794
30K	90	0.853
35K	90	0.853
40K	90	0.882

Lumen Multiplier Table for Trim

Data table baseline is FNC 3500K 80CRI photometry. This table can be used to approximate the lumen values at different housing trim. Power consumption would stay the same.

Trim	Lens	Multiplier
FNC	FLSH	1.000
RLG	FLSH	0.894
FLD	FLSH	0.967
FDST	FLSH	0.919
FLG	FLSH	0.916

Lumen Multiplier Table for CCT and CRI - INDIRECT

Data table baseline is 3500K 80CRI photometry. This table can be used to approximate the lumen values at different Kelvin temperatures and Color Rendering Index. Power consumption would stay the same.

CCT	CRI	Multiplier
27K	80	0.960
30K	80	0.991
35K	80	1.000
40K	80	1.000
27K	90	0.815
30K	90	0.833
35K	90	0.854
40K	90	0.869

REMOTE DRIVERS

*Always required for 18DIA pendant

Remote (S)	Remote Single Driver Box (1 box w/ 1 driver)
Remote (D)	Remote Double Driver Box (1 box w/ 2 drivers)

Driver Matrix				Direct Nominal Lumens	1100LM				1450LM				1800LM			
Diameter	Min Dim Level	Control Input	Voltage	Indirect Nominal Lumens	None	1200LM	1500LM	1800LM	None	1200LM	1500LM	1800LM	None	1200LM	1500LM	1800LM
18DIA	MIN1	ZT	MVOLT		Remote (S)	Remote (D)	Remote (D)	Remote (D)	Remote (S)	Remote (D)	Remote (D)	Remote (D)	Remote (S)	Remote (D)	Remote (D)	Remote (D)
			347		Remote (S)	Remote (D)	Remote (D)	Remote (D)	Remote (S)	Remote (D)	Remote (D)	Remote (D)	Remote (S)	Remote (D)	Remote (D)	Remote (D)
		ECOD	MVOLT		Remote (S)	Remote (D)	Remote (D)	Remote (D)	Remote (S)	Remote (D)	Remote (D)	Remote (D)	Remote (S)	Remote (D)	Remote (D)	Remote (D)
					Remote (S)	Remote (D)	Remote (D)	Remote (D)	Remote (S)	Remote (D)	Remote (D)	Remote (D)	Remote (S)	Remote (D)	Remote (D)	Remote (D)
	DARK	ZT	MVOLT		Remote (S)	Remote (D)	Remote (D)	Remote (D)	Remote (S)	Remote (D)	Remote (D)	Remote (D)	Remote (S)	Remote (D)	Remote (D)	Remote (D)
					Remote (S)	Remote (D)	Remote (D)	Remote (D)	Remote (S)	Remote (D)	Remote (D)	Remote (D)	Remote (S)	Remote (D)	Remote (D)	Remote (D)
		NLIGHT			Remote (S)	Remote (D)	Remote (D)	Remote (D)	Remote (S)	Remote (D)	Remote (D)	Remote (D)	Remote (S)	Remote (D)	Remote (D)	Remote (D)
					Remote (S)	Remote (D)	Remote (D)	Remote (D)	Remote (S)	Remote (D)	Remote (D)	Remote (D)	Remote (S)	Remote (D)	Remote (D)	Remote (D)

NLIGHT REMOTE DRIVER MATRIX

*Remote driver required when Control Input is NLIGHT

Remote	Non-IC Rated (MVOLT no longer applicable. Specific Voltage 120 or 277 must be specified)
Remote (S)	Remote Single Driver Box (1 box w/ 1 driver)
Remote (D)	Remote Double Driver Box (1 box w/ 2 drivers)
Remote (SD)	Remote Single + Double Driver Box Combination
Remote (DD)	Remote Double + Double Driver Box Combination

Diameter	18DIA		
Direct Nominal Lumens	1100LM	1450LM	1800LM
Indirect Nominal Lumens			
None	Remote (S)	Remote (S)	Remote (S)
1200LM	Remote (D)	Remote (D)	Remote (D)
1500LM	Remote (D)	Remote (D)	Remote (D)
1800LM	Remote (D)	Remote (D)	Remote (D)

Diameter	24DIA							
Direct Nominal Lumens	2000LM	2200LM	2400LM	2600LM	2800LM	3000LM	3200LM	3400LM
Indirect Nominal Lumens								
None	Remote (S)	Remote (S)	Remote (S)	Remote (S)	Remote (S)	Remote (S)	Remote (S)	Remote (S)
2200LM	Remote (D)	Remote (D)	Remote (D)	Remote (D)	Remote (D)	Remote (D)	Remote (D)	Remote (D)
2400LM	Remote (D)	Remote (D)	Remote (D)	Remote (D)	Remote (D)	Remote (D)	Remote (D)	Remote (D)
2600LM	Remote (D)	Remote (D)	Remote (D)	Remote (D)	Remote (D)	Remote (D)	Remote (D)	Remote (D)
2800LM	Remote (D)	Remote (D)	Remote (D)	Remote (D)	Remote (D)	Remote (D)	Remote (D)	Remote (D)
3000LM	Remote (D)	Remote (D)	Remote (D)	Remote (D)	Remote (D)	Remote (D)	Remote (D)	Remote (D)
3200LM	Remote (D)	Remote (D)	Remote (D)	Remote (D)	Remote (D)	Remote (D)	Remote (D)	Remote (D)
3400LM	Remote (D)	Remote (D)	Remote (D)	Remote (D)	Remote (D)	Remote (D)	Remote (D)	Remote (D)
3600LM	Remote (D)	Remote (D)	Remote (D)	Remote (D)	Remote (D)	Remote (D)	Remote (D)	Remote (D)
3800LM	Remote (D)	Remote (D)	Remote (D)	Remote (D)	Remote (D)	Remote (D)	Remote (D)	Remote (D)

Diameter	36DIA					
Direct Nominal Lumens	3500LM	4000LM	4500LM	5000LM	5500LM	6000LM
Indirect Nominal Lumens						
None	Remote (S)	Remote (S)	Remote (S)	Remote (S)	Remote (S)	Remote (S)
4000LM	Remote (D)	Remote (D)	Remote (D)	Remote (D)	Remote (SD)	Remote (SD)
4500LM	Remote (D)	Remote (D)	Remote (D)	Remote (D)	Remote (SD)	Remote (SD)
5000LM	Remote (D)	Remote (D)	Remote (D)	Remote (D)	Remote (SD)	Remote (SD)
5500LM	Remote (D)	Remote (D)	Remote (D)	Remote (D)	Remote (SD)	Remote (SD)
6000LM	Remote (D)	Remote (D)	Remote (D)	Remote (D)	Remote (SD)	Remote (SD)
6500LM	Remote (D)	Remote (D)	Remote (D)	Remote (D)	Remote (SD)	Remote (SD)
7000LM	Remote (SD)	Remote (SD)	Remote (SD)	Remote (SD)	Remote (DD)	Remote (DD)

Diameter	48DIA									
Direct Nominal Lumens	6000LM	6500LM	7000LM	7500LM	8000LM	8500LM	9000LM	10000LM	10500LM	11000LM
Indirect Nominal Lumens										
None	Remote (S)	Remote (S)	Remote (D)	Remote (D)	Remote (D)	Remote (D)	Remote (D)	Remote (D)	Remote (D)	Remote (D)
7500LM	Remote (SD)	Remote (SD)	Remote (DD)	Remote (DD)	Remote (DD)	Remote (DD)	Remote (DD)	Remote (DD)	Remote (DD)	Remote (DD)
8000LM	Remote (SD)	Remote (SD)	Remote (DD)	Remote (DD)	Remote (DD)	Remote (DD)	Remote (DD)	Remote (DD)	Remote (DD)	Remote (DD)
8500LM	Remote (SD)	Remote (SD)	Remote (DD)	Remote (DD)	Remote (DD)	Remote (DD)	Remote (DD)	Remote (DD)	Remote (DD)	Remote (DD)
9000LM	Remote (SD)	Remote (SD)	Remote (DD)	Remote (DD)	Remote (DD)	Remote (DD)	Remote (DD)	Remote (DD)	Remote (DD)	Remote (DD)
9500LM	Remote (SD)	Remote (SD)	Remote (DD)	Remote (DD)	Remote (DD)	Remote (DD)	Remote (DD)	Remote (DD)	Remote (DD)	Remote (DD)
10000LM	Remote (SD)	Remote (SD)	Remote (DD)	Remote (DD)	Remote (DD)	Remote (DD)	Remote (DD)	Remote (DD)	Remote (DD)	Remote (DD)
10500LM	Remote (SD)	Remote (SD)	Remote (DD)	Remote (DD)	Remote (DD)	Remote (DD)	Remote (DD)	Remote (DD)	Remote (DD)	Remote (DD)
11000LM	Remote (SD)	Remote (SD)	Remote (DD)	Remote (DD)	Remote (DD)	Remote (DD)	Remote (DD)	Remote (DD)	Remote (DD)	Remote (DD)

REMOTE DRIVERS

Remote Single Driver Box

* Reference Installation Instructions for additional details

* Maximum remote distance from fixture junction box to driver box is 100-feet

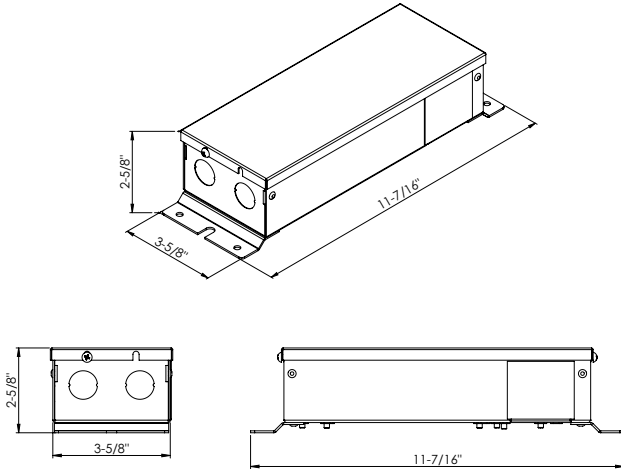

Remote E10WLCP Emergency Box

* Reference Installation Instructions for additional details

* Maximum remote distance from fixture junction box to driver box is 50-feet
(Half distance of driver)

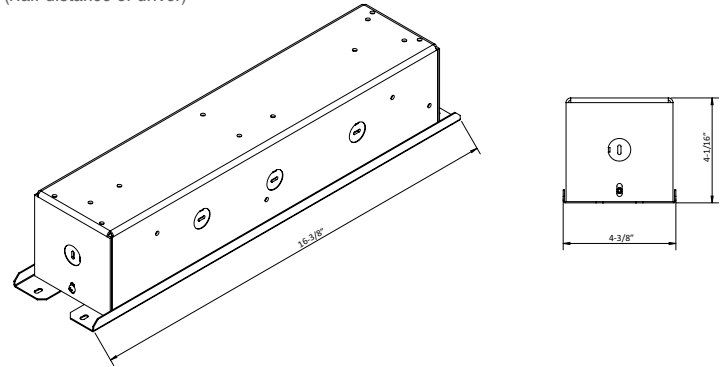

Remote Double Driver Box

* Reference Installation Instructions for additional details

* Maximum remote distance from fixture junction box to driver box is 100-feet

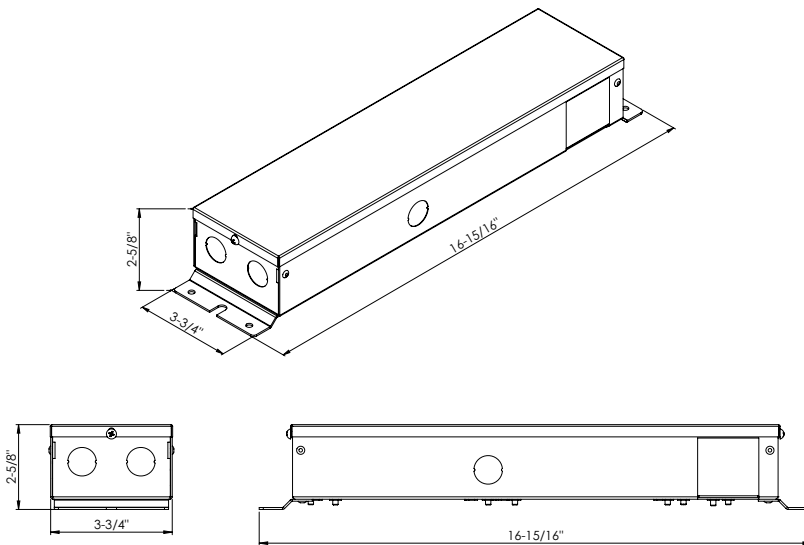

How to Calculate Delivered Lumens in Emergency Mode

Use the formula below to determine the delivered lumens in emergency mode

$$\text{Delivered Lumens} = 1.25 \times P \times \text{LPW}$$

P = Output power of emergency driver. P = 10W for E10WLCP option.

LPW = Lumen per watt rating of the luminaire. (LPW information available in Performance Data section.)