



OPERATIONAL SETTINGS

2 = Occupancy Time Delay

The length of time an occupancy sensor will keep the lights on after it last detects occupancy.

1- 30 sec	5 - 10.0 min*	9 - 20.0 min	13 - 30.0 min
2 - 2.5 min	6 - 12.5 min	10 - 22.5 min	
3 - 5.0 min	7 - 15.0 min	11 - 25.0 min	
4 - 7.5 min	8 - 17.5 min	12 - 27.5 min	

3 = On Mode

Not applicable with Vacancy (VA) Option

Automatic On

Sensor automatically turns the lights on when it detects occupancy.

Manual On

Sensor requires pressing the button to turn the lights on.

Reduced Turn-On

Sensor is set to initially only detect large motions, effectively ignoring any reflected Passive Infrared (PIR) signals. Occupants will still be detected immediately when they enter the room as their PIR signal is large. Once lights are on, the sensor returns to maximum sensitivity.

- 1 - Automatic On*
- 2 - Manual On
- 3 - Reduced Turn-On

4 = Switch Modes

Not applicable with Vacancy (VA) Option

Switch Enable (Override Off)

Button will turn lights off and keep them off until pressed again. The lights will remain off until the button is pressed again, restoring the sensor to Automatic On mode.

Switch Disable

User is prevented from turning off the lights via the push-button.

Predictive Mode

Pressing the push-button switch overrides the lights off and temporarily disables the occupancy detection. After 10 seconds, the occupancy detection reactivates and monitors for an additional 30 seconds. If no occupancy is detected during this period, the sensor will revert to Automatic On operation. If occupancy is detected, the sensor will remain in Override Off mode and requires the switch to be pressed again in order to restore the sensor to Automatic On.

Predictive Mode with Expiration

Pressing the push-button switch overrides the lights off and temporarily disables the occupancy detection. After 10 seconds, the occupancy detection reactivates and monitors for an additional 30 seconds. If no occupancy is detected during this period, the sensor will revert to Automatic On operation.

- 1 - Switch Enable
- 2 - Manual On
- 3 - Predictive Mode
- 4 - Predictive Mode with Expiration*

5 = Darkness Set-Point / Inhibit Set-Point

The ambient light level at which the sensor sets the lights to the High Trim setting.

1 - Set Now**	5 - 8 fc	9 - 48 fc	13 - 128 fc
2 - 0.1 fc	6 - 16 fc	10 - 64 fc	14 - 192 fc
3 - 1 fc	7 - 24 fc*	11 - 80 fc	15 - 256 fc
4 - 4 fc	8 - 32 fc	12 - 96 fc	

**Set Now will automatically select the Darkness Set-Point based on the current conditions in the room. Lights will go to full bright and sensor will rapid flash for 15 seconds allowing occupant to move out of direct view of sensor. Once the set-point selection is completed, the sensor will double-blink in confirmation.

7 = Photocell Mode

Inhibit Only

Prevents lights from automatically coming on when light level is above the Inhibit Set-Point

- 1 - Disabled*
- 2 - Inhibit Only

9 = Restore Defaults

Returns all functions to original settings.

- 1 - Maintain Current*
- 2 - Restore Defaults

11 = LED Operation

Indicates behavior of device's LED.

- 1 - Occupancy Indication*
- 2 - Disabled

14 = Manual On Grace Period

Time period after lights automatically turn off that they can be reactivated by motion. Applicable only when sensor is in Manual On (Semi Auto) mode.

- 1 - 0 sec
- 3 - 15 sec*

17 = Predictive Exit Time

Time period after manually switching lights off for occupant to leave the space. Applicable only when sensor is in Predictive Off mode.

- 1 - 5 sec
- 2 - 6 sec
- 3 - 7 sec
- 4 - 8 sec
- 5 - 9 sec
- 6 - 10 sec*
- 7 - 15 sec
- 8 - 20 sec
- 9 - 30 sec

18 = Predictive Grace Time

Time period after Predictive Exit Time that sensor rescans the room for remaining occupants. Applicable only when sensor is in Predictive Off mode.

- 1 - 0 sec
- 2 - 5 sec
- 3 - 10 sec
- 4 - 20 sec
- 5 - 30 sec*
- 6 - 40 sec
- 7 - 50 sec
- 8 - 60 sec

19 = Fade On Rate

Time required for light to reach preset level.

- 1 - 0.75 sec*
- 2 - 2.5 sec
- 3 - 5 sec
- 4 - 15 sec

20 = Fade Off Rate

Time required for light to turn Off.

- 1 - 0.75 sec
- 2 - 2.5 sec*
- 3 - 5 sec
- 4 - 15 sec

* DEFAULT SETTING

OPERATIONAL SETTING INSTRUCTIONS

PLEASE READ ALL 7 STEPS BEFORE PROGRAMMING

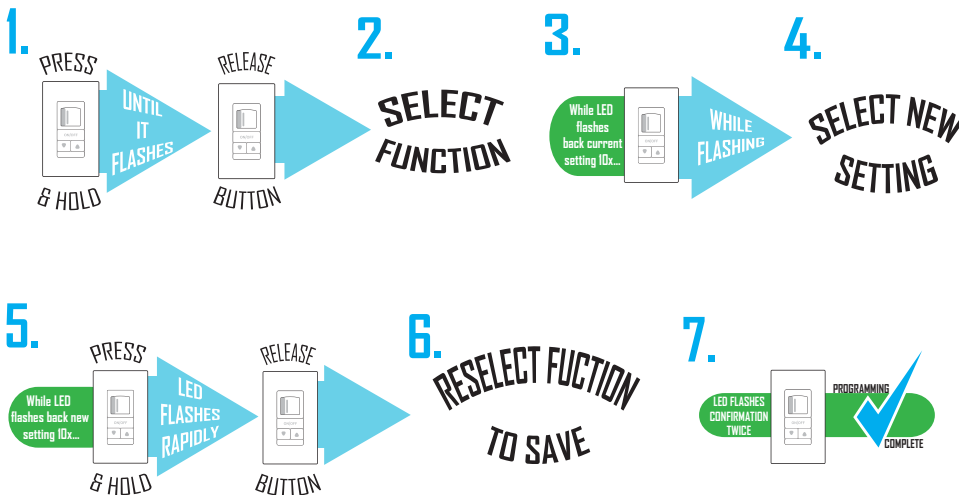

- Enter programming mode by pressing & holding button until LED flashes rapidly. Release button.
- Enter a specific programming function by pressing button the number of times as the desired function number from the tables on the following pages (e.g., press twice for function 2, *Occupancy Time Delay*).
- The selected function's current setting will then be read out in a sequence of LED flashes (e.g., five flashes for 10 min). To change setting, proceed to step 4 before sequence repeats 10 times.
- While the sensor is flashing back current setting, interrupt it by pressing button the number of times for the new desired setting as indicated in the particular function's detailed table (e.g., press seven times for 15 min). Sensor will begin to flash new setting as confirmation.
- Next, while the sensor is flashing back new setting, interrupt it by pressing and holding button until LED flashes rapidly. Release button.
- As final confirmation and activation of the new setting, re-enter the programming function number that was changed (e.g., press twice for function 2, *Occupancy Time Delay*).
- LED will flash twice indicating acceptance of new setting. If two flashes are not seen, repeat 7 step process.

Note: To exit programming mode without saving or to change to a different function, wait for blink back sequence to repeat 10 times then return to step 1.



Expanding the boundaries of lighting™



WARRANTY

5-year limited warranty. Complete warranty terms located at www.acuitybrands.com/CustomerResourcesTerms_and_conditions.aspx

**READ AND FOLLOW ALL SAFETY INSTRUCTIONS!
SAVE THESE INSTRUCTIONS AND DELIVER TO OWNER AFTER INSTALLATION**