

General Illumination Pendant Cord Cylinder

6"

Feature Set

- Batwing distribution with feathered edges provides even illumination on horizontal and vertical surfaces
- Bounding Ray™ optical design
- 45° cutoff to source and source image
- Fully serviceable lensed LED light engine
- 70% lumen maintenance at 60,000 hours
- 2.5 MacAdam Ellipse; 85 CRI typical, 90+ CRI optional
- Fixtures are damp location standard; wet location option (WL)
- ENERGY STAR® Certified product*
- Have the cleanest of installations with a 0.29" diameter color coordinated cord. Multi-conductor ultra-pliable cord with embedded aircraft cable ensures no chance of kinks, crooked mounting, or need to tether power cord to suspension cable (patent pending).
- Multiple recessed or surface j-box mounting configurations available with cords
- 20 standard colors in textured and gloss finish; custom or RAL colors also available
- UGR of zero for fixtures aimed at nadir with a cut-off equal to or less than 60deg per CIE 117-1995 Discomfort Glare in Interior Lighting. [UGR FAQ](#)

Distribution

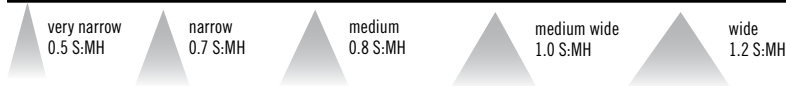

Superior Performance

Nominal Lumens	250	500	750	1000	1500	2000	2500	3000	3500	4000	4500	5000	6000	8000	10,000	12,000
Delivered Lumens	297	519	776	994	1471	2006	2537	3077	3542	4027	4533	5256	6371	8247	10637	12332
Wattage	3.4	6.2	8.2	9.6	14.7	19.7	24.7	29.5	33.8	39.0	47.3	48.7	57.6	74.9	97.1	115
Lumens per Watt	87.4	83.7	94.6	103.5	100.1	101.8	102.7	104.3	104.8	103.3	95.8	107.9	110.6	110.1	109.5	107.2

Coordinated Apertures | Multiple Layers of Light

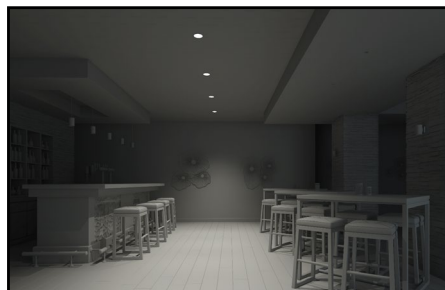

General Illumination Layer | EVO



High Center Beam Layer | Incito

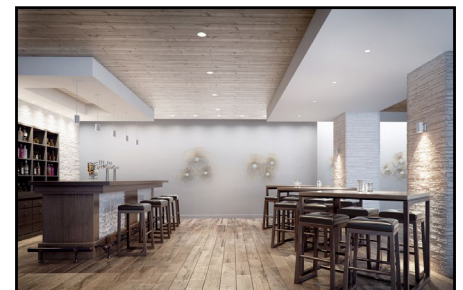

EVO + Incito — Multiple Layers of Light

Core



Downlight



Adjustable



Open Wallwash



Lensed Wallwash



Cylinder



Pinhole



Bevel



Hyperbolic

Healthcare



MRI



Surgical Suite



Patient Room

Special Applications



Dynamic



Food Service



Vandal/Tamper



Clean Room



Shower



Steam Room

Luminaire Type:
Catalog Number:

EXAMPLE: EV06CC 35/15 AR MWD LSS MVOLT EZ1 JBXCC CCAN C120 DWHG

Series		Color Temperature		Lumens		Trim Color		Reflector Finish		Distribution		Voltage	
EV06CC	EVO 6in Pendant Cord Round Cylinder Open Downlight	27/	2700 K	02	250 lumens	AR	Clear	LSS	Semi-specular	VND	Very narrow (0.5 s/mh)	MVOLT	120V - 277V
		30/	3000 K	05	500 lumens	PR	Pewter	LD	Matte diffuse			120	120V
		35/	3500 K	07	750 lumens	WTR	Wheat	LS	Specular	ND	Narrow (0.7 s/mh)	277	277V
		40/	4000 K	10	1000 lumens	GR	Gold			MD	Medium (0.9 s/mh)	347 ⁴	347V
		50/	5000 K	15	1500 lumens	WR ²	White painted						
				20	2000 lumens	BR ²	Black			MWD	Medium wide (1.0 s/mh)		
				25	2500 lumens	WRAMF ²	White Anti-microbial			WD	Wide (1.2 s/mh)		
				30	3000 lumens	BZR ²	Dark Bronze painted						
				35	3500 lumens	TRALTB ^{2,3}	Trim RAL # TBD (TBD for pricing only)						
				40	4000 lumens								
				45	4500 lumens								
				50	5000 lumens	TCPC ^{2,3}	Trim Custom Paint Color TBD (TBD for pricing only)						
				60	6000 lumens								
				80	8000 lumens								
				100 ¹	10,000 lumens								
				120 ¹	12,000 lumens								

Driver ⁵	Mounting	Canopy Type	Cord Length ^{12,13}
GZ10 0-10V driver dims to 10%	JBX Integral driver, Recessed or Surface J-box	CCAN 5° Cord canopy with "hang straight" swivel	C120 10' Mounting Cord
GZ1 0-10V driver dims to 1%	JBXCC Integral driver, Surface J-box with Conduit Covers	CCAN45 ¹¹ 45° Cord canopy with "hang straight" swivel	C180 15' Mounting Cord
EZ10 eldoLED 0-10V ECOdrive. Linear dimming to 10% min.	SGB ⁹ Surface gear box (for driver at ceiling), Recessed or surface J-box (not wall or surface ceiling)		C240 20' Mounting Cord
EZ1 eldoLED 0-10V ECOdrive. Linear dimming to 1% min.			
EZB eldoLED 0-10V SOLOdrive. Logarithmic dimming to <1%.			
EDAB ⁶ eldoLED SOLOdrive DALI. Logarithmic dimming to <1%.			
EDXB ^{6,7,8} eldoLED POWERdrive DMX with RDM (remote device management). Square Law dimming to <1%. Min: 1000LM; Max: 8000LM. Not available with Emergency Options.	SGBCC ⁹ Surface gear box (for driver at ceiling), surface J-box with Conduit Covers (not wall or surface ceiling)		
ECOD ⁶ Lutron® EcoSystem® digital Hi-Lume 1% soft-on, fade to black. Max: 8000LM except 4500LM.	RGH ¹⁰ Recessed Gear Housing		
ELV ⁶ Electronic line voltage/Forward phase/Triac dimming. 120V only.			

Emergency Option		Control Interface ¹⁴		Options		Architectural Colors - Powder Paint ³			
(blank)	No emergency options	(blank)	No controls	90CRI	High CRI (90+)	DWHAMF	Gloss White with Anti-microbial finish	DDBT	Textured Dark Bronze
E7WCP	IOTA® 7W Constant Power emergency battery (sidecar). Only for use with 750-8000 lumen options.	NLT	nLight® dimming pack. Specify 120V or 277V.	CP ¹⁶	Chicago Plenum. Specify 120V or 277V (requires RGH)	DDB	Gloss Dark Bronze	DBLB	Textured Black
E10WCP	IOTA® 10W Constant Power, CA Title 20 compliant emergency battery pack with integral test switch. Only for use with 1000-8000 lumen options. (sidecar or RGH)	NLTER ¹⁵	nLight® dimming pack for fixtures on emergency circuit. Specify 120V or 277V.	HAO ¹⁷	High Ambient Option (40°C)	DBL	Matte Black	DWHG	Textured White
E10WCPR	IOTA® 10W Constant Power, CA Title 20 compliant emergency battery pack with remote test switch. Only for use with 1000-8000 lumen options. (requires RGH)	NLTAIR2	nLight® AIR dimming pack. Specify 120V or 277V.	N80 ¹⁸	nLight Lumen Compensation	DWH	Gloss White	DBNH	Textured Bronze
E15WCP	IOTA® 15W Constant Power, CA Title 20 compliant emergency battery. Only for use with 1500-8000 lumen options. (sidecar)	NLTAIRER2 ¹⁵	nLight® AIR dimming pack for fixtures on emergency circuit. Specify 120V or 277V.	SF	Single fuse. Specify 120V or 277V.	DMB	Matte Medium Bronze	DNAT	Textured Natural Aluminum
GTD	IOTA® Generator Transfer Device. Specify 120V or 277V (requires RGH)			WL ¹⁹	Wet Location	DNA	Gloss Natural Aluminum	DSST	Textured Sandstone
						DSS	Gloss Sandstone	DSPD	Textured Dark Grey
						DGC	Gloss Charcoal Grey	DSPE	Textured Green
						DTG	Gloss Tennis Green	DSPH	Textured Light Red
						DBR	Gloss Bright Red	RALTBD	Cylinder RAL # TBD (TBD for pricing only)
						DSB	Gloss Steel Blue	CPC	Cylinder Custom Paint Color TBD (TBD for pricing only)

ACCESSORIES — order as separate catalog numbers (shipped separately)

GCOLORS KIT	Architectural colors chip kit, consisting of powder-coat and plated finishes
CYLJBXADPT 4SQ20CT	4in Square J-box to 4in Octagonal J-box adaptor. Replace ___ with Architectural Color or PRM for primed ready for field painting

ORDERING NOTES

1. 10,000 & 12,000 lumens not available with 347, EDXB, Lutron, SGB, SGBCC, RGH, Emergency Options, HAO, WL & CP.

2. Not Available with Reflector Finishes.

3. Replace with applicable RAL number and finish when ready to order. See [RAL BROCHURE](#) for available color options. For details on all Acuity Architectural paint colors, RAL and Custom colors, please see [Architectural colors](#).

4. Integral 347V drivers available with GZ10 and GZ1 driver options only - 3500LM max. All other drivers (and GZ1 & GZ10 above 3000LM) will come with a step-down transformer - factory installed with RGH mounting, and field installed with JBX and JBXCC mounting (remote mount location and access to device required). Not available with SGB, SGBCC or Emergency Options. Max 5000LM.

5. Refer to [Tech 240](#) for compatible dimmers.

6. Not Available with Control Interfaces.

7. Requires SGB or SGBCC mounting option.

8. Includes terminator resistor. Not available with 250-750 lumen packages.

9. Only available with DMX driver (EDXB).
10. Not available with E7W or E15WCP Emergency Options.

11. Not available with SGB or SGBCC; those mountings require a flat ceiling.

12. Cord can be cut in field to achieve non-uniform lengths (i.e. for a field cut 8' length, order 10' cord). Cord length is nominal: actual length is about 2" shorter.

13. Cord color is determined by cylinder color: DWHG, DWH, and DWHAMF will have white cord; DBL and DBLB will have black cord; all others will have gray cord.

14. Factory installed with RGH option otherwise field installed. Access required to location of remote mounted device.

15. ER for use as UL924 Emergency Operation via power sense lead. Will require an emergency hot feed and normal hot feed. EM for use as UL924 Emergency Operation via power interrupt detection.

16. CP not valid with NLTAIR2, NLTAIRER2 or Emergency Options.

17. Only available up to 3500 lumens; not available with wet location.

18. Fixture begins at 80% light level. Must be specified with NLT or NLTER. Only available with EZ10 and EZ1 drivers.

19. Not available with JBXCC, SGB, SGBCC or Sidecar Emergency Options. Max 3500LM.

Optical Assembly

Fully serviceable and upgradeable lensed LED light engine suitable for field maintenance or service from below the ceiling. Optical design is a Bounding Ray™ design with 45° cutoff to source and source image. Top down flash characteristic for superior glare control.

Electrical

The luminaire shall operate from a 50 or 60 Hz ± 3 Hz AC line over a voltage ranging from 120 VAC to 277 VAC. Support 347V via remote-mounted stepdown transformer. The fluctuations of line voltage shall have no visible effect on the luminous output.

The luminaire shall have a power factor of 90% or greater at all standard operating voltages and full luminaire output.

Sound Rated A+. Driver shall be >80% efficient at full load across all input voltages.

Input wires shall be 18AWG, 300V minimum solid copper.

All drivers are ROHS compliant.

Controls

Luminaire shall be equipped with interface for nLight wired or nLight AIR networks with integral power supply as per specification.

Emergency

Luminaires supplied with a battery pack comply with NFPA 101 (Life Safety code) and deliver constant light output throughout the 90 minutes of code required emergency operation period when there is a normal AC power loss.

Luminaires equipped with a generator transfer device work in conjunction with an auxiliary generator or a central inverter system to power fixtures for safe egress lighting.

Dimming

The luminaire shall be capable of continuous dimming without perceivable stroboscopic flicker as measured by flicker index (ANSI/IES RP-16-10) over a range of 100 – 10%, 100 – 1.0% or 100 – 0.1% of rated lumen output with a smooth shut off function to step to 0%.

LED drivers shall conform to IEEE P1789 standards. Alternatively, manufacturers must demonstrate conformance with product literature and testing which demonstrates this performance. Systems that do not meet IEEE P1789 will not be considered.

Driver is inaudible in 24dB environment, and stable when input voltage conditions fluctuate over what is typically experienced in a commercial environment.

Construction

Heavy-gauge aluminum construction.

Extruded body with flangeless reflector allows flow-through passive thermal management.

Pendant cord mount for installation to 4" recessed or surface octagonal junction box.

Optional field configurable conduit covers available. Conduit covers match cylinder in finish and diameter.

Surface gear box available for driver at ceiling installation.

Recessed gear box available for driver above ceiling, nLight, CP, GTD or battery pack options.

Listings

Fixtures are CSA Certified to meet US and Canadian Standards: All fixtures manufactured in strict accordance with the appropriate and current requirements of the "Standards for Safety" to UL, damp location standard; wet location options available open under covered ceiling (WL).

Luminaire configurations are Energy Star certified through testing in EPA-recognized laboratories, with the results reviewed by an independent, accredited certification organization. Visit www.energystar.gov for specific configurations listed. *Not all configurations are Energy Star listed.

Photometrics

LEDs tested to LM-80 standards. Measured by IESNA Standard LM-79-08 in an accredited lab. Lumen output shall not decrease by more than 30% over the minimum operational life of 60,000 hours.

Color appearance from luminaire to luminaire of the same type and in all configurations, shall be consistent both initially and at 60,000 hours and operate within a tolerance of <2.5 MacAdam ellipse as defined by the center of the quadrangles defined in ANSI C78.377-2015.

BUY AMERICAN ACT

This product is assembled in the USA and meets the Buy America(n) government procurement requirements under FAR, DFARS and DOT regulations. Please refer to www.acuitybrands.com/buy-american for additional information.

Warranty

5-year limited warranty. This is the only warranty provided and no other statements in this specification sheet create any warranty of any kind. All other express and implied warranties are disclaimed. Complete warranty terms located at: www.acuitybrands.com/support/warranty/terms-and-conditions

Note:

Actual performance may differ as a result of end user environment and application. All values are design or typical values, measured under laboratory conditions at 25 °C.

A+ Capable Luminaire

This item is an A+ capable luminaire, which has been designed and tested to provide consistent color appearance and out-of-the-box control capability with simple commissioning when used with Acuity Brands controls products.

All configurations of this luminaire are calibrated and tested to meet the Acuity Brands' specification for chromatic consistency - including color rendering, color fidelity and color temperature tolerance around standard CIE chromaticity coordinates.

To learn more about A+, visit www.acuitybrands.com/aplus.

EVO - eldoLED Driver Default Dimming Curve			
Nomenclature	Min Dimming	Driver Dim Curve	Control Dim Curve
EZ10	10%	Linear	Linear/Logarithmic
EZ1	1%	Linear	Linear/Logarithmic
EZB	<1%	Logarithmic	Linear
EDAB	<1%	Logarithmic*	Linear
EDXB	<1%	Square	Linear

*Changeable through DALI controller

Driver		Control Provided (note: 347V/UVOLT versions provided with 347 option selected)			
Nomenclature	Description	NLT	NLTER	NLTAIR2	NLTAIRER2
GZ10	0-10V driver dims to 10%	nPP16 D EFP	nPP16 D ER EFP	RPP20 D 24V G2	RPP20 D 24V ER G2
GZ1	0-10V driver dims to 1%	nPP16 D EFP	nPP16 D ER EFP	RPP20 D 24V G2	RPP20 D 24V ER G2
EZ10	eldoLED 0-10V ECOdrive	nPS 80 EZ	nPS 80 EZ ER	RPP20 D 24V G2	RPP20 D 24V ER G2
EZ1	eldoLED 0-10V ECOdrive	nPS 80 EZ	nPS 80 EZ ER	RPP20 D 24V G2	RPP20 D 24V ER G2
EZB	eldoLED 0-10V SOLOdrive	nPS 80 EZ	nPS 80 EZ ER	RPP20 D 24V G2	RPP20 D 24V ER G2

J-box Compatibility Matrix		Cylinder Configurations					
		6" Pend CYL	6" Pend CYL Surf Gear Box	6" Pend CYL Surf Gear Box w/ Conduit Cover	6" Pend CYL DMX Surf Gear Box	6" Pend CYL DMX Surf Gear Box w/ Conduit Cover	6" Pend CYL w/ Conduit Cover
Recommended J-box (by others)	4" Octagonal 4x4x1.5 deep"	✓	✓	✓	✓	✓	✓
	4" Octagonal 4x4x2.125 deep	✓	✓	✗	✓	✗	✗
	4" Square 4x4x1.5 deep	*with adaptor plate accessory	*with adaptor plate accessory	✗	*with adaptor plate accessory	✗	✗

Standard Architectural Color Options for Cylinder Bodies

 DSS LITHONIA P12 Sandstone	 DSST TEXTURED P90 Sandstone	 DBR LITHONIA P34 Bright Red	 DSPH TEXTURED P80 Light Red	 DMB LITHONIA P11 Medium Bronze	 DBNH TEXTURED P74 Bronze	 DTG LITHONIA P33 Tennis Green	 DSPE TEXTURED P78 Green
 DSB LITHONIA P49 Steel Blue	 DNA LITHONIA P07 Natural Aluminum	 DNAT TEXTURED P89 Natural Aluminum	 DGC LITHONIA P32 Charcoal Gray	 DSPD TEXTURED P77 Dark Grey	 DDB LITHONIA P50 Dark Bronze	 DDBT TEXTURED P88 Dark Bronze	 DBL LITHONIA P13 Black
 DBLB TEXTURED P75 Black	 DWH LITHONIA P21 White	 DWHG TEXTURED P86 White					

NOTE: These colors were carefully reproduced to give as true a depiction as possible of finished product color. Some colors, however, may vary slightly from actual appearance due to display/printing variations and limitations. Please order the GCOLORS KIT listed in the 'Accessories' section of the spec sheet for an accurate paint chip sample.

JBX Recessed J-Box

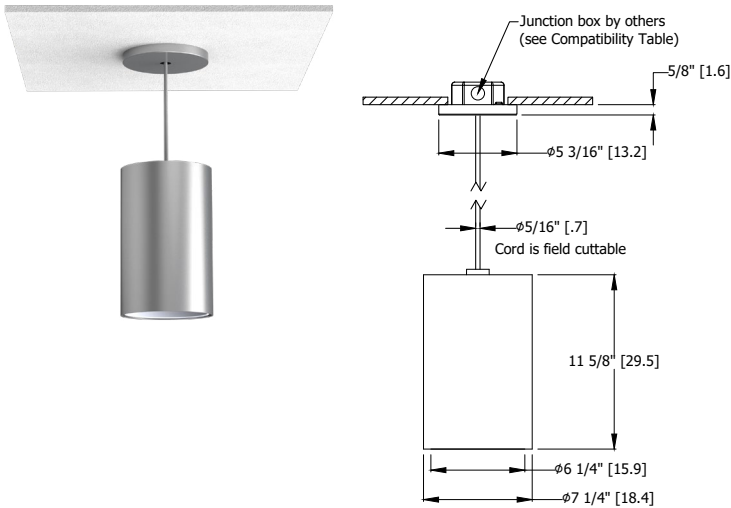

10,000LM- 12,000LM JBX Recessed

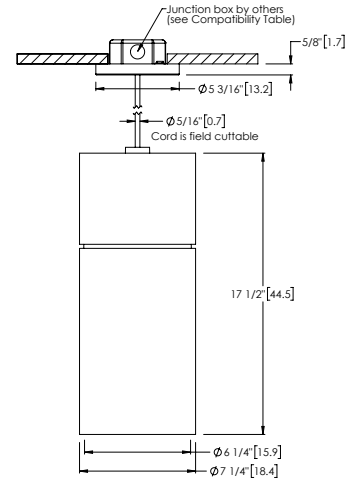

JBX Surface J-Box

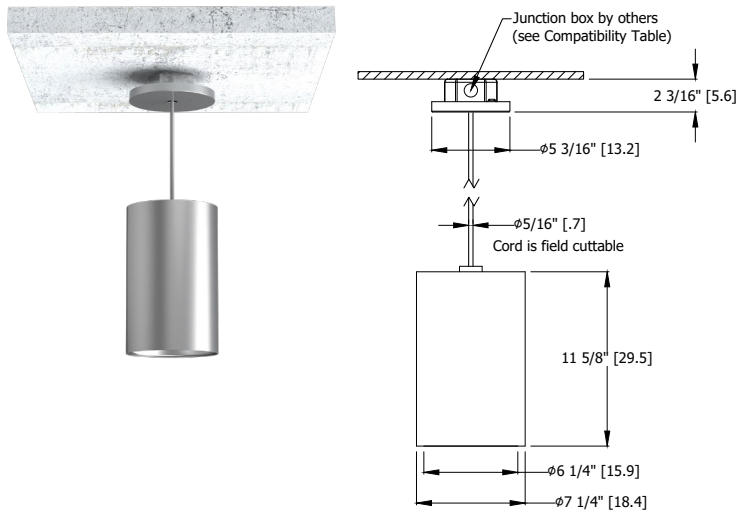

10,000LM- 12,000LM JBX Surface

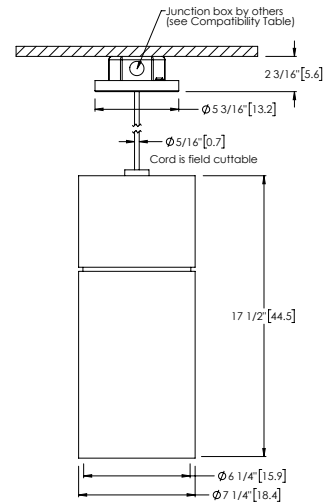

JBXCC Surface J-Box with Conduit Covers

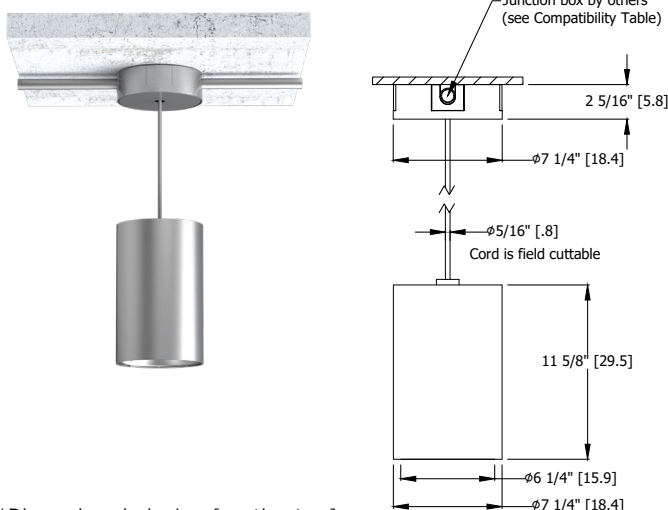

10,000LM- 12,000LM JBXCC

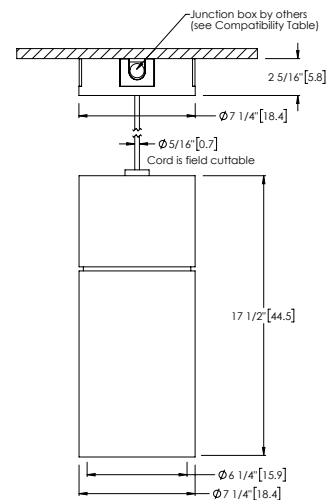

*Dimensions in inches [centimeters]

Canopy Covers for Flat or Sloped Ceilings

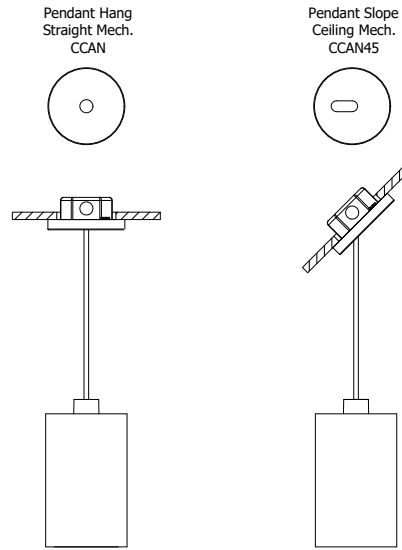

Cutting Formulas for JBX

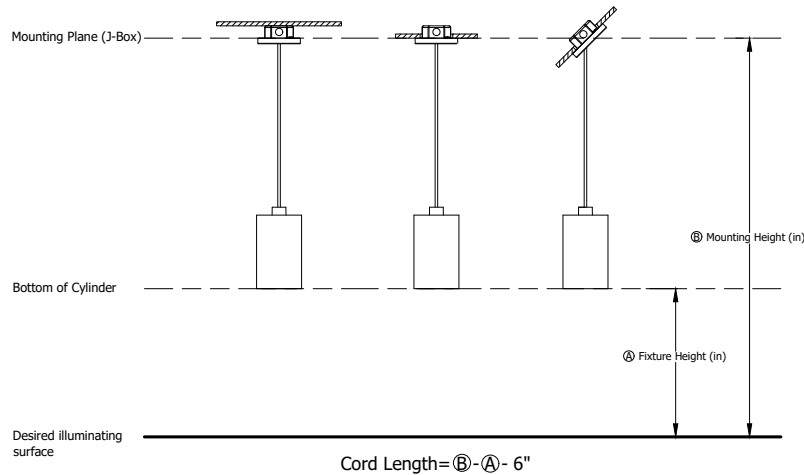

Conduit Feed Examples and Keys

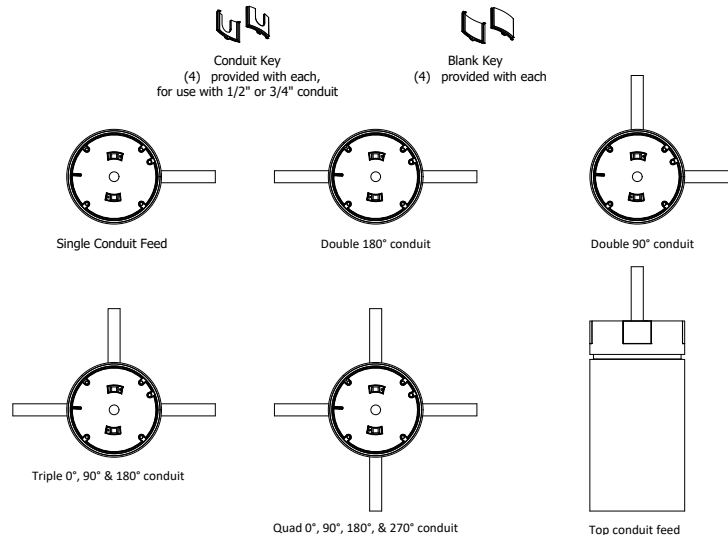

SGB Surface Gear Box for EDXB Recessed

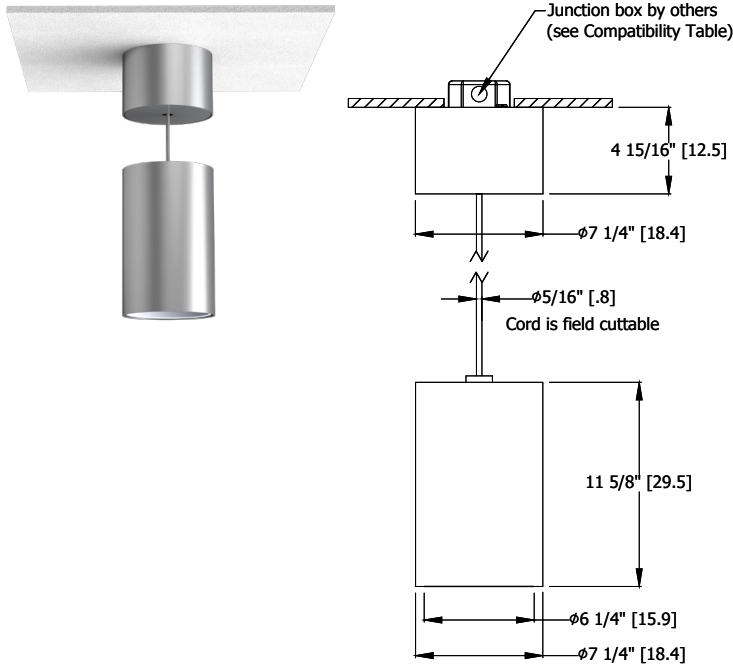

SGB Surface Gear Box for EDXB Surface

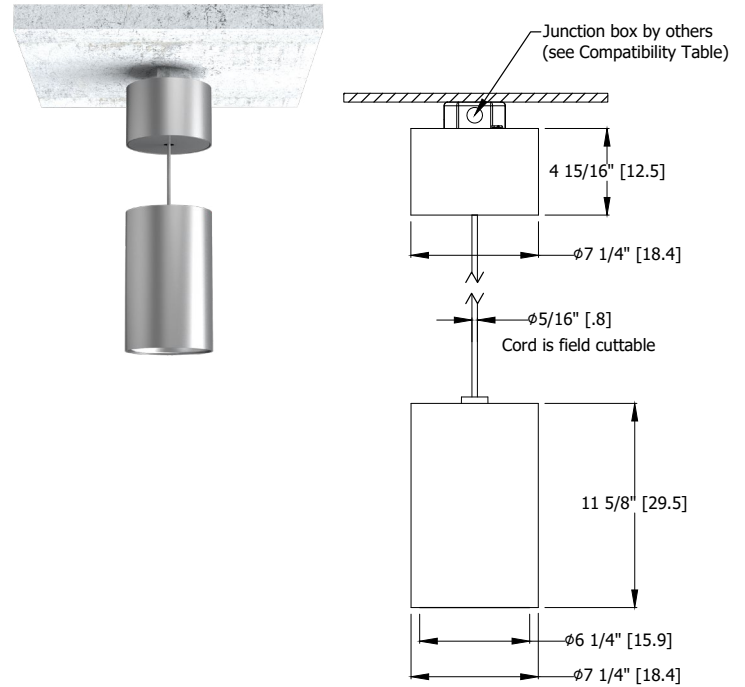

SGBCC Surface Gear Box for EDXB with Conduit Covers

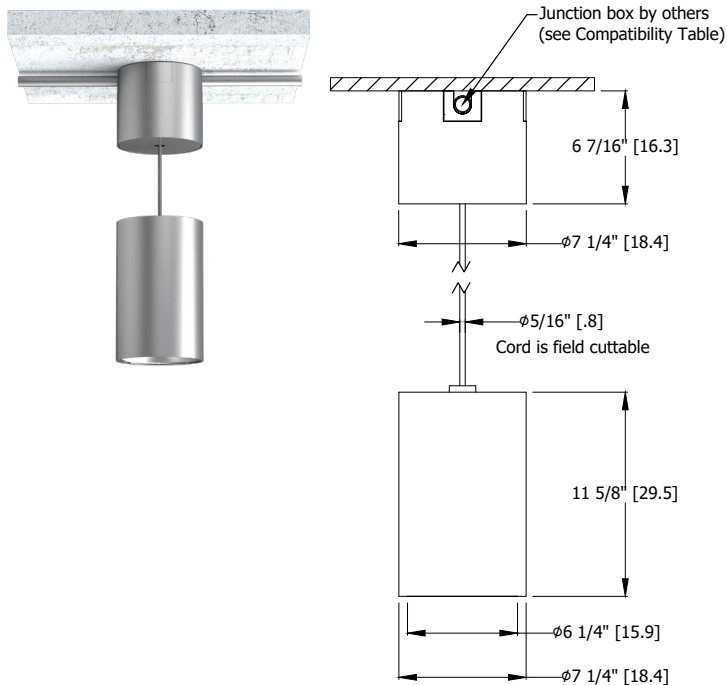

Cutting Formulas for SGB

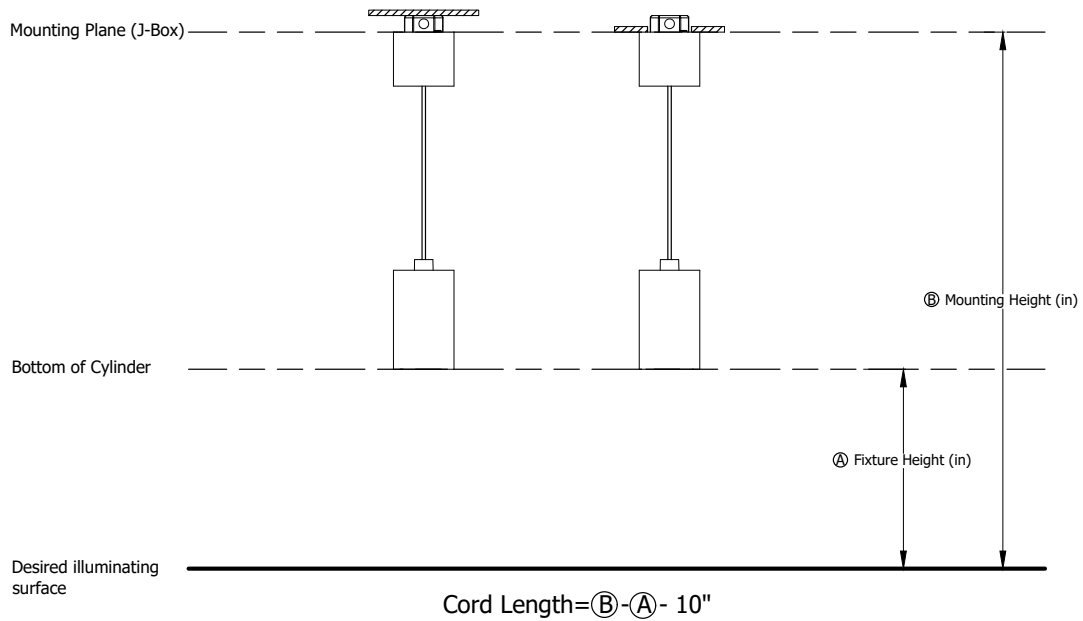

Cylinder Adaptor Plate

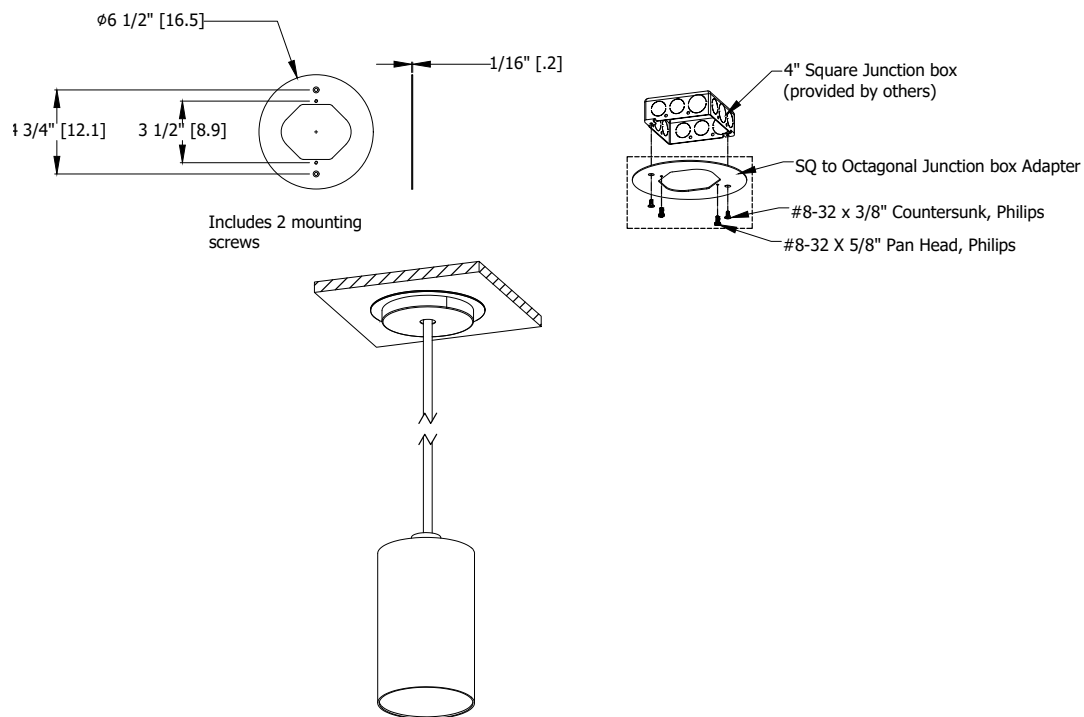

Junction Box Dimensions (by others)

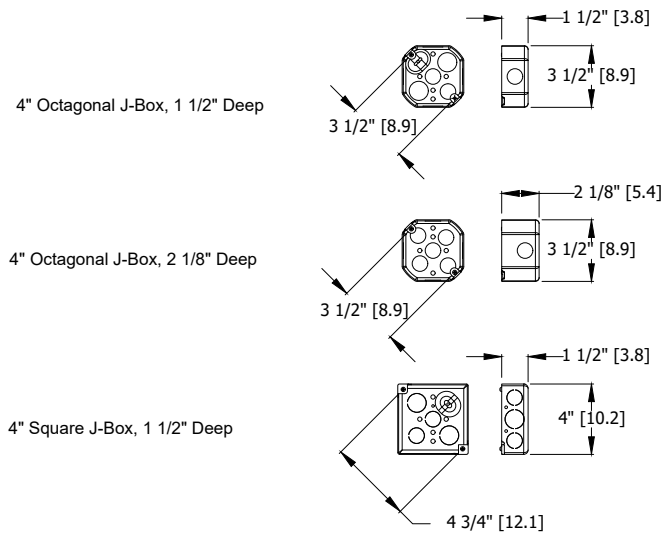

347V Stepdown Transformer

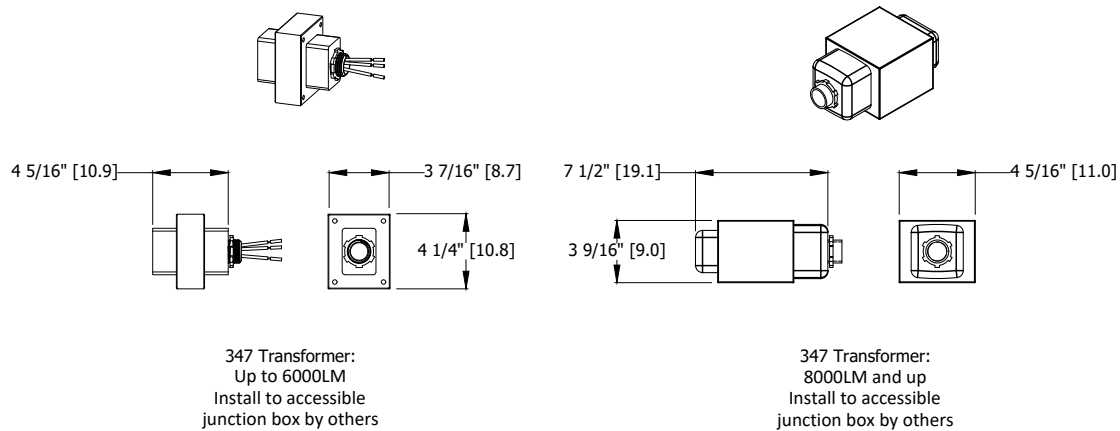

DIMENSIONAL DATA

Emergency Battery Sidecar Dimensions

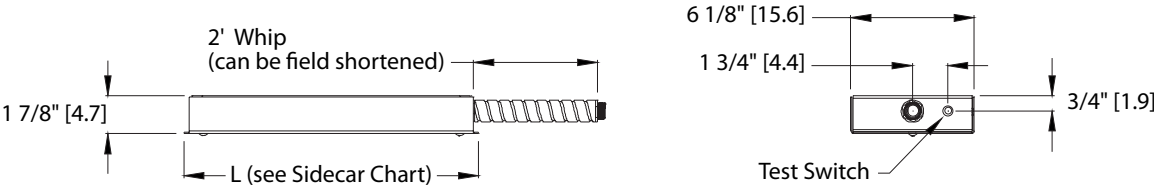

SIDECAR BATTERY OPTION	LUMEN PACKAGES AVAILABLE	L (SIDECAR LENGTH)
E7WCP	750LM AND GREATER EXCEPT AS NOTED BELOW	14"
	6000-8000LM	16"
	5000-8000LM WITH ECOD DRIVER	
E10WCP	1000LM AND GREATER EXCEPT AS NOTED BELOW	14"
	6000-8000LM	16"
	5000-8000LM WITH ECOD DRIVER	
E15WCP	1500LM AND GREATER	16"

E7WCP/E10WCP/E15WCP Sidecar Emergency Battery

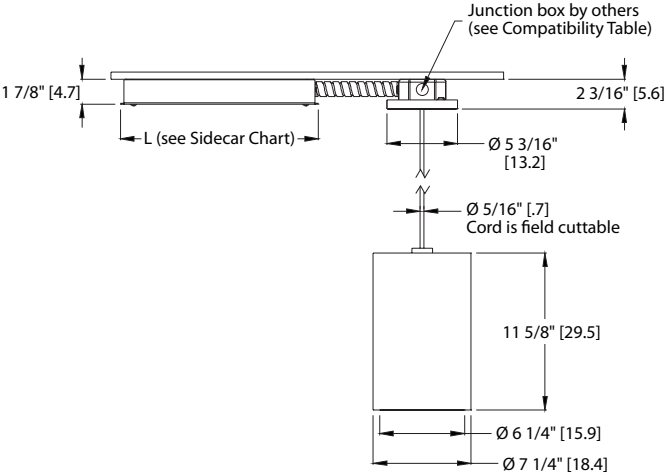

*Dimensions in inches [centimeters]

RGH 2500LM-5000LM and with EDXB up to 4500LM & ECOD up to 4000LM Standard

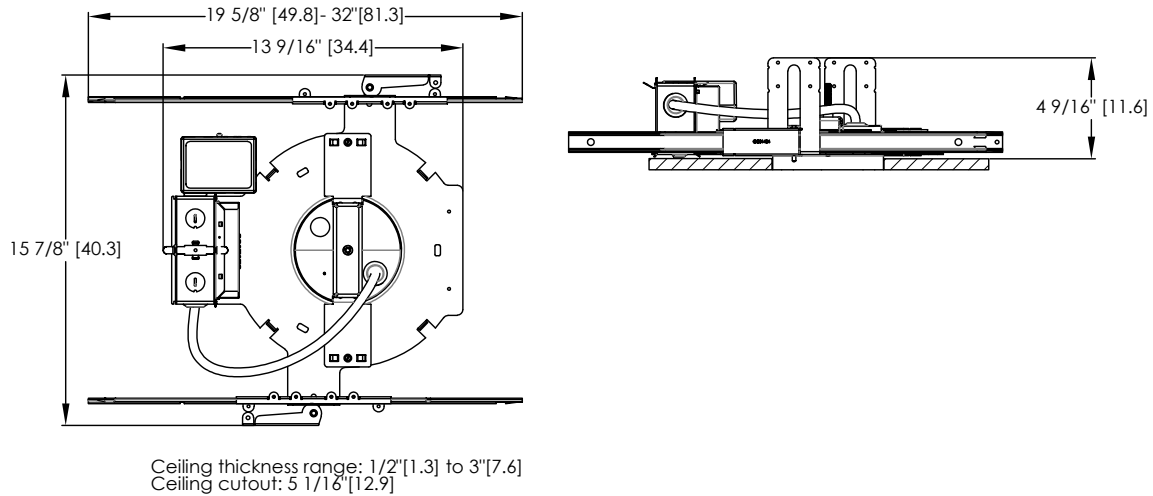

RGH with Battery Backup (E10WCPR) 2500LM-5000LM and with EDXB up to 4500LM & ECOD up to 4000LM Standard

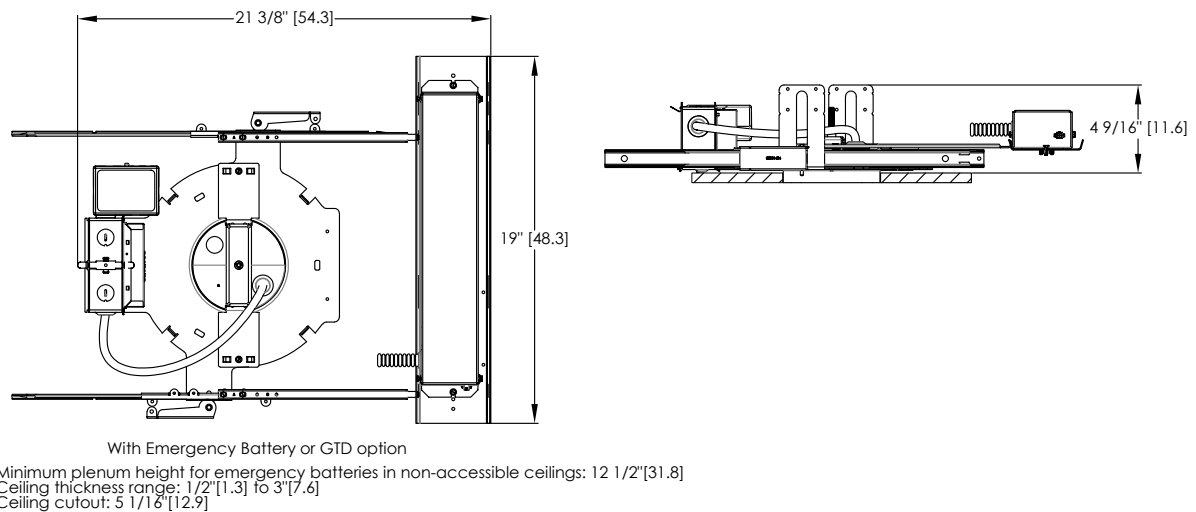

RGH with CP 2500LM-5000LM and for use with EDXB up to 4500LM & ECOD up to 4000LM Standard

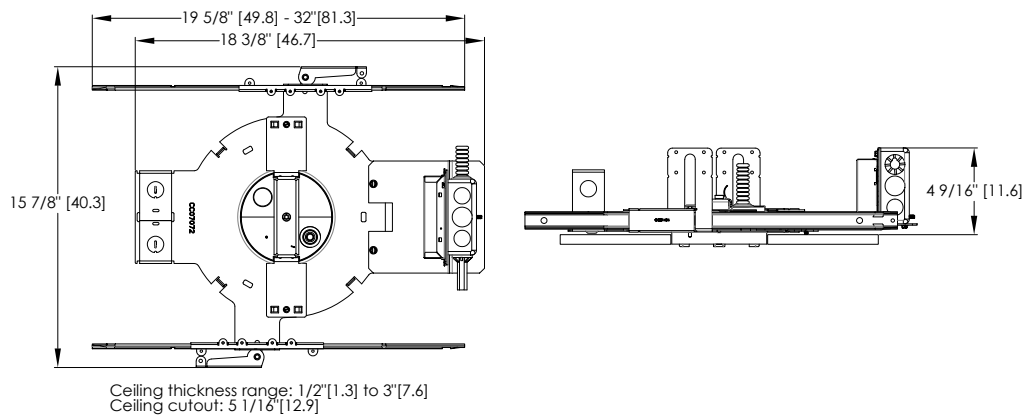

*Dimensions in inches [centimeters]

RGH with Chicago Plenum (CP) for use with nLight Enclosed

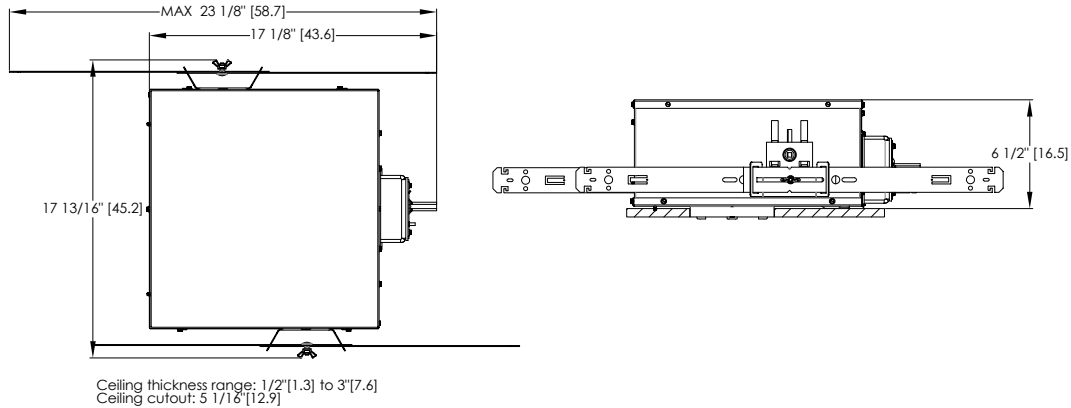

Ceiling thickness range: 1/2\"[1.3] to 3\"[7.6]
Ceiling cutout: 5 1/16\"[12.9]

RGH Double Driver 5000LM+ EDXB & EC0D, 6000LM & 8000LM Standard

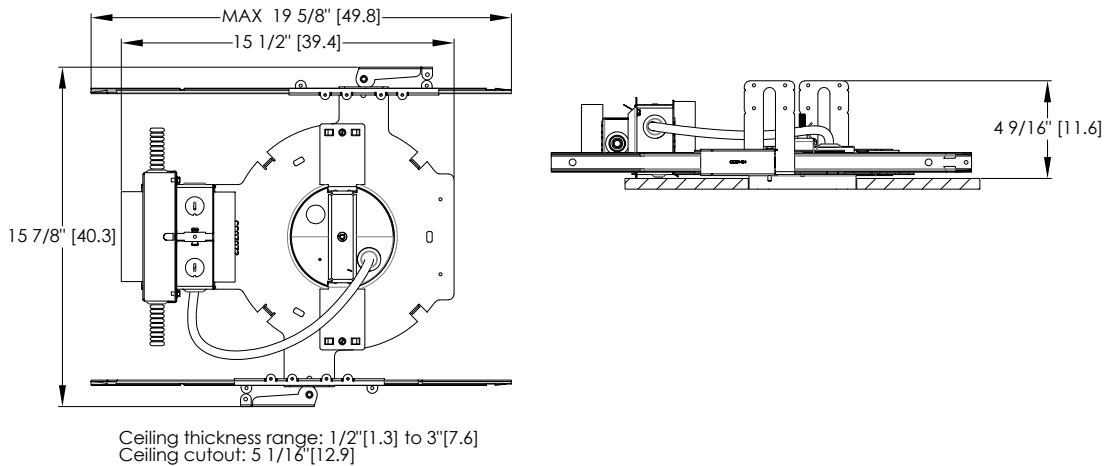

Ceiling thickness range: 1/2\"[1.3] to 3\"[7.6]
Ceiling cutout: 5 1/16\"[12.9]

RGH Double Driver with Battery Backup (E10WCPR or E10WCP) for use with 5000LM+ EDXB & EC0D, 6000LM & 8000LM Standard

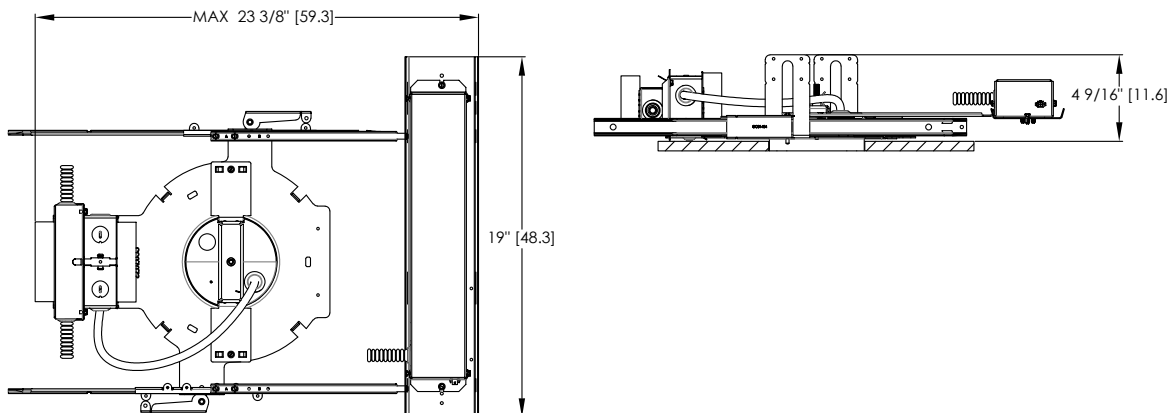

With Emergency Battery or GTD option
Minimum plenum height for emergency batteries in non-accessible ceilings: 12 1/2\"[31.8]
Ceiling thickness range: 1/2\"[1.3] to 3\"[7.6]
Ceiling cutout: 5 1/16\"[12.9]

*Dimensions in inches [centimeters]

RGH Double Driver CP Standard

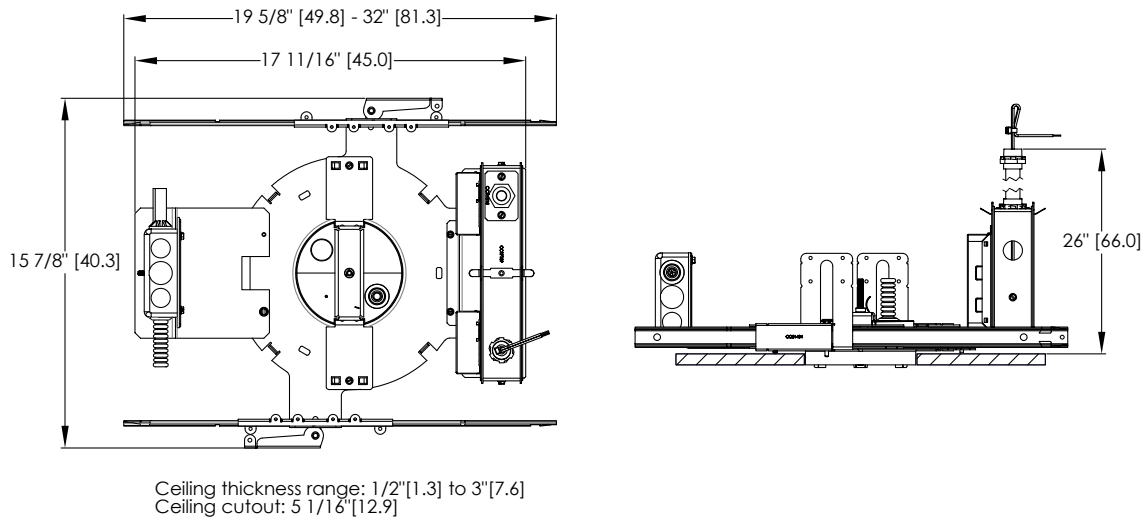

RGH Double Driver with CP for use with 5000LM+ EDXB & ECOD, 6000LM & 8000LM Enclosed

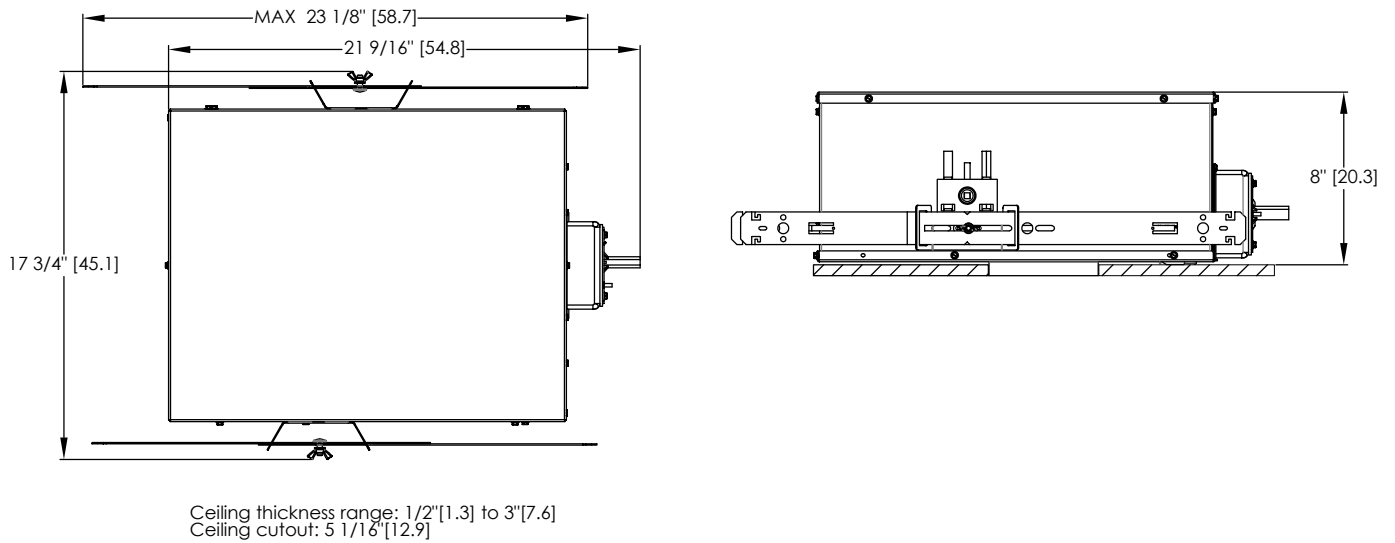

*Dimensions in inches [centimeters]

CONSULT WWW.GOTHAMLIGHTING.COM FOR ADDITIONAL PHOTOMETRY.

EV06CC 35/15 AR MWD LS INPUT WATTS: 14.7, DELIVERED LUMENS: 1471LM, LPW= 100, 1.03 S/MH, TEST NO. LTL27783P1505

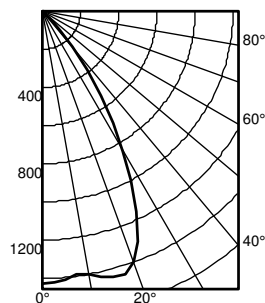

Ave	Lumens	Zone	Lumens	% Lamp
0	1431	0° - 30°	1061.4	72.2
5	1410	0° - 40°	1393.5	94.7
15	1442	0° - 60°	1469.5	99.9
25	1161	0° - 90°	1470.9	100.0
35	540	90° - 180°	0.0	0.0
45	78	0° - 180°	1470.9	*100.0
55	3			
65	1			
75	0			
85	0			
90	0			

*Efficiency

		50% beam -		10% beam -	
		54.4°		77.9°	
Mounting Height	Initial FC Center Beam	Diameter		FC	
	Beam	Diameter	FC	Diameter	FC
8.0	47.3	5.7	23.7	8.9	4.7
10.0	25.4	7.7	12.7	12.1	2.5
12.0	15.9	9.8	7.9	15.3	1.6
14.0	10.8	11.8	5.4	18.6	1.1
16.0	7.9	13.9	3.9	21.8	0.8

EV06CC 35/45 AR MWD LS INPUT WATTS: 47.3, DELIVERED LUMENS: 4532.7LM, LPW= 95.8, 1.03 S/MH, TEST NO. LTL27783P1649

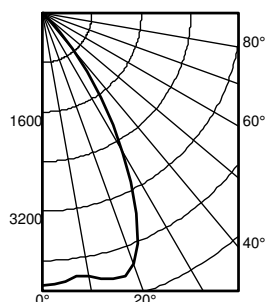

Ave	Lumens	Zone	Lumens	% Lamp
0	4411	0° - 30°	3270.7	72.2
5	4346	0° - 40°	4294.2	94.7
15	4443	0° - 60°	4528.3	99.9
25	3578	0° - 90°	4532.7	100.0
35	1665	90° - 180°	0.0	0.0
45	242	0° - 180°	4532.7	*100.0
55	8			
65	2			
75	1			
85	0			
90	0			

*Efficiency

		50% beam -		10% beam -	
		54.4°		77.9°	
Mounting Height	Initial FC Center Beam	Diameter		FC	
	Beam	Diameter	FC	Diameter	FC
8.0	145.8	5.7	72.9	8.9	14.6
10.0	78.4	7.7	39.2	12.1	7.8
12.0	48.9	9.8	24.4	15.3	4.9
14.0	33.4	11.8	16.7	18.6	3.3
16.0	24.2	13.9	12.1	21.8	2.4

Lumen Output Multiplier		
CRI	CCT	Multiplier
80	2700K	0.916
	3000K	0.948
	3500K	1
	4000K	1.032
	5000K	1.1
90	2700K	0.748
	3000K	0.8
	3500K	0.838
	4000K	0.845
	5000K	0.945

Reflector Finish Multiplier	
Reflector Finish	Multiplier
LS - Specular	1
LSS - Semi Specular	0.956
WR - White	0.87
LD - Matte Diffuse	0.85
BR - Black	0.73
BZR - Bronze	0.73

Distributions		
Nomenclature	Beam Angle	Field Angle
VND	30	64
ND	44	69
MD	54	82
MWD	67	89
WD	71	92

nLight® AIR is the ideal solution for retrofit or new construction spaces where adding communication wiring is cost prohibitive. The integrated nLight AIR rPP20 Power Pack is part of each EVO Luminaire ordered with the NLTAIR option. These individually addressable controls offer the ultimate in flexibility during initial setup and for space repurposing.

nLight® AIR Control Accessories

Order as separate catalog number. Visit [nLight AIR](#).

Wall Switches

	Model Number
On/Off single pole	rPODB (color) G2
On/Off two pole	rPODB 2P (color) G2
On/Off & raise/lower single pole	rPODB DX (color) G2
On/Off & raise/lower two pole	rPODB 2P DX (color) G2

nLight® AIR Control Accessories (cont.)

Occupancy Sensors (PIR/dual tech)

	Model Number
Small motion 360°, ceiling	rCMS 9 / rCMS PDT 9
Large motion 360°, ceiling	rCMS 10 / rCMS PDT 10

UL924 Sequence of Operation

The below information applies to all nLight AIR devices with an EM option.

- EM devices will remain at their high-end trim and ignore wireless lighting control commands, unless a normal-power-sensed (NPS) broadcast is received at least every 8 seconds.
- Using the CLAIRITY™ mobile app, EM devices must be associated with a group that includes a normal power sensing device to receive NPS broadcasts.
- Only non-emergency rPP20, rLSXR, rSBOR, rSDGR, and nLight AIR luminaires with version 3.4 or later firmware can provide normal power sensing for EM devices. See specification sheets for control devices and luminaires for more information on options that support normal power sensing.

nLight® Wired The nLight® solution is a digital networked lighting control system that provides both energy savings and increased user configurability by cost effectively integrating time-based, daylight-based, sensor-based and manual lighting control schemes.

nLight® Wired Control Accessories

Order as separate catalog number. Visit [nLight](#).

Wall Switches

	Model Number
On/Off single pole	nPODM (color)
On/Off two pole	nPODM 2P (color)
On/Off & raise/lower single pole	nPOD DX (color)
On/Off & raise/lower two pole	nPODM 2P DX (color)
Graphic touchscreen	nPOD GFX (color)

Photocell Controls

Dimming	nCM ADCX
---------	----------

nLight® Wired Control Accessories (cont.)

Occupancy Sensors (PIR/dual tech)

	Model Number
Small motion 360°, ceiling	nCM 9 / nCM PDT 9
Large motion 360°, ceiling	nCM 10 / nCM PDT 10
Wide View	nWV 16 / nWV PDT 16
Wall switch with raise/lower	nWSX LV DX / nWSX PDT LV DX

Cat-5 Cables (plenum rated)

10', CAT5	CAT5 10FT J1
15', CAT5	CAT5 15FT J1

Possibilities for nLight® AIR

Fixtures ordered *without* the NLTAIR option

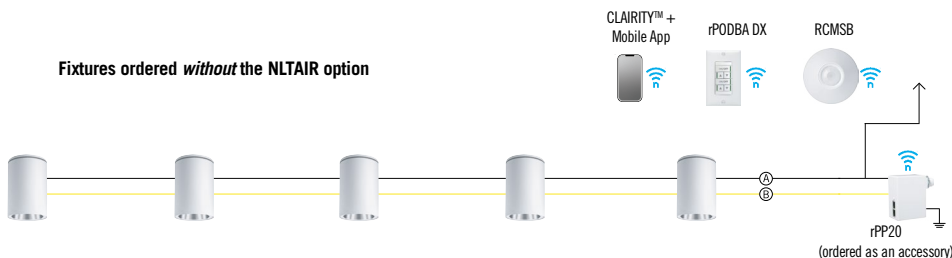

Fixtures ordered *with* the NLTAIR option

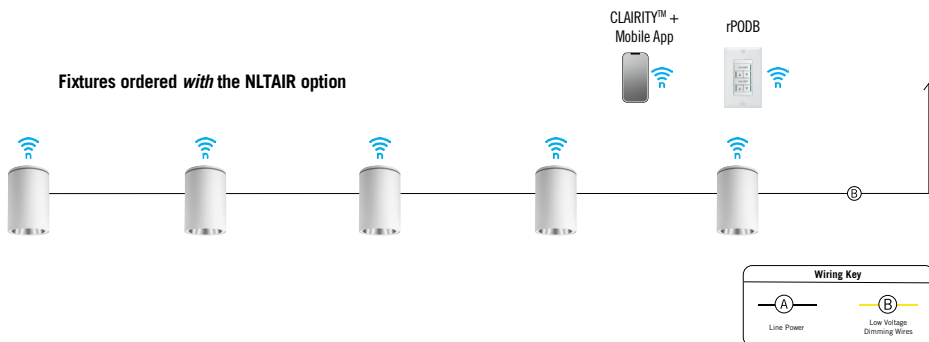

Possibilities for nLight® wired

Fixtures ordered *without* the NLT option

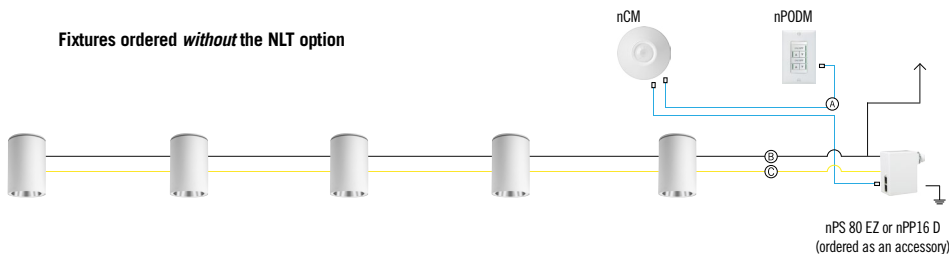

Fixtures ordered *with* the NLT option

