

High Center Beam Round Downlight

2"



Feature Set

- Thirteen optimized distribution patterns allow designers to achieve tailored objectives
  - Bounding Ray™ optical design
  - 50° Cutoff to source and source image
  - Field interchangeable optic
  - Driver and LED light engine fully serviceable from below ceiling
  - 70% lumen maintenance at 60,000 hours
  - 2.5 SDCM; 85 CRI typical, 90+ CRI optional
  - Fixtures are wet location, covered ceiling
  - ENERGY STAR® Certified product

Distribution

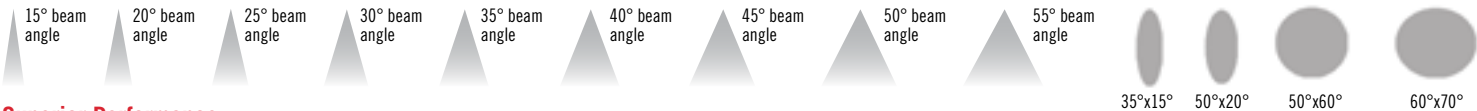

Superior Performance

Nominal lumens	250	500	750	1000	1500	2000
Delivered	263	560	859	1177	1764	2227
Wattage	3.1	5.6	8.7	12.0	19.8	28.6
Efficacy	85	100	99	98	89	78

\*Based on 3500K 80CRI 15D AR LSS



Items marked by a shaded background qualify for the Design Select program and ship in 15 days or less. To learn more about Design Select, visit [www.acuitybrands.com/designselect](http://www.acuitybrands.com/designselect).

\*See ordering tree for details

Coordinated Apertures | Multiple Layers of Light



General Illumination Layer | EVO



High Center Beam Layer | Incito



EVO + Incito — Multiple Layers of Light

Core



Healthcare



Special Applications



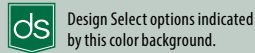

Luminaire Type:

Catalog Number:

EXAMPLE: IC02 35/10 AR LSS 20D MVOLT UGZ

Series	Color Temperature	Lumens	Reflector Color	Flange Type	Reflector Finish	Beam
IC02 Incito 2in Round Open Downlight	27/ 2700 K	02 250 lumens	AR Clear	(blank) Self-flanged	LSS Semi-specular	15D 15° beam angle
	30/ 3000 K	05 500 lumens	PR Pewter	FL Flangeless	LD Matte diffuse	20D 20° beam angle
	35/ 3500 K	07 750 lumens	WTR Wheat			25D 25° beam angle
	40/ 4000 K	10 1000 lumens	GR Gold			30D 30° beam angle
	50/1 5000 K	15 1500 lumens	WR <sup>2</sup> White painted			35D 35° beam angle
		20 2000 lumens	BR <sup>2</sup> Black			40D 40° beam angle
			BZR <sup>2</sup> Dark Bronze painted			45D 45° beam angle
						50D 50° beam angle
						55D 55° beam angle
						3515D Elliptical 35° x 15° beam angle
						5020D Elliptical 50° x 20° beam angle
						5060D Elliptical 50° x 60° beam angle
						6070D Elliptical 60° x 70° beam angle

Voltage	Driver	Control Interface <sup>4</sup>	Options
MVOLT 120V - 277V	UGZ <sup>3</sup> Universal dimming to 1% (0-10V, 120V TRIAC or ELV)	(blank)	90CRI <sup>1</sup> High CRI (90+)
120 120V		NLT nLight® dimming pack.	NCH <sup>6</sup> Structural reinforcement pan
277 277V		NLTER <sup>5</sup> nLight® dimming pack for fixtures on emergency circuit	ICAT <sup>7</sup> IC/Airtight housing construction
		NLTAIR2 nLight® AIR dimming pack.	CP <sup>7</sup> Chicago Plenum
		NLTAIRER2 <sup>9</sup> nLight® AIR dimming pack for fixtures on emergency circuit	HA0 <sup>8</sup> High ambient (40°C)
		NLTAIREM2 nLight® AIR dimming pack for fixtures on emergency circuit	N80 <sup>9</sup> nLight Lumen Compensation
			TRW <sup>10</sup> White painted flange
			TRBL <sup>11</sup> Black painted flange

ACCESSORIES — order as separate catalog numbers (shipped separately)

IC020PTC XXD	Additional optics for field installation. Replace "XX" with beam angle.
IC020PTC KIT	Kit including a field interchangeable optic for each of the 13 preset beam distribution patterns
HS258	2-5/8" Hole saw
HS234FL	Hole saw for flangeless trim option
SDT 347/120 75VA	347V/120V, 75VA step down transformer. Must be remote mounted.

ORDERING NOTES

- 5000K CCT not available with 90CRI.
- Not available with Reflector Finish.
- Refer to [Tech 240](#) for compatible dimmers.
- Field installed. Access required to location of remote mounted device.
- ER for use with generator supply power. Will require an emergency hot feed and normal hot feed.
- NCH is required for T-grid ceilings or where code requires.
- Not available with 1500lm or 2000lm.
- Not available with 2000lm.
- Requires NLT or NLTER.
- For use with different reflector finish only (i.e. AR, PR, WTR, GR options). Not available with WR (White Reflector). Not available with FL.
- For use with different reflector finish only (i.e. AR, PR, WTR, GR options). Not available with BR (Black Reflector). Not available with FL.

### Optical and Trim Assembly

Fully serviceable and upgradeable lensed LED light engine suitable for field maintenance or service from above or below the ceiling. Optical design is a Bounding Ray™ design with 50° cutoff to source and source image. Top down flash characteristic for superior glare control. Flangeless trim option includes proprietary Gotham mud ring enabling seamless integration into drywall applications. Mud ring ships separately. Superior 100% Virgin-silicone refractive optic, enables maximum dimensional stability and optical transmission with no discoloration over life. Field inter-changeable optics.

### Electrical

The luminaire shall operate from a 50 or 60 Hz  $\pm 3$  Hz AC line over a voltage ranging from 120 VAC to 277 VAC. Support 347V via remote-mounted stepdown transformer. The fluctuations of line voltage shall have no visible effect on the luminous output.

The luminaire shall have a power factor of 90% or greater at all standard operating voltages and full luminaire output.

Sound Rated A+. Driver shall be >80% efficient at full load across all input voltages.

### Controls

Luminaire shall be equipped with interface for nLight wired or nLight AIR networks with integral power supply as per specification.

### Dimming

The luminaire shall be capable of continuous dimming without perceivable stroboscopic flicker as measured by flicker index (ANSI/IES RP-16-10) over a range of 100 – 1.0% of rated lumen output with a smooth shut off function to step to 0%.

Driver is inaudible in 24dB environment, and stable when input voltage conditions fluctuate over what is typically experienced in a commercial environment.

### Construction

Light engine and driver are accessible from below ceiling.

Several additional mounting options available including a structural reinforcement pan, Chicago plenum, and Type IC.

Anodized extruded aluminum wiring compartment with hinged access. With two 1/2" trade-sized knockouts rated for 90°C.

Accommodates between 3/8" to 2-3/4"-thick ceilings.

### Listings

Fixtures are UL Certified to meet US and Canadian Standards: All fixtures manufactured in strict accordance with the appropriate and current requirements of the "Standards for Safety" to UL, wet location covered ceiling. ENERGY STAR® Certified product.

IC rated with ICAT option. Fixtures with ICAT option are compatible with spray foam insulation with an R-value of 4.3 per inch or less.

Luminaire configurations are Energy Star certified through testing in EPA-recognized laboratories, with the results reviewed by an independent, accredited certification organization. Visit [www.energystar.gov](http://www.energystar.gov) for specific configurations listed

### Photometrics

LEDs tested to LM-80 standards. Measured by IESNA Standard LM-79-08 in an accredited lab. Lumen output shall not decrease by more than 30% over the minimum operational life of 60,000 hours.

Color appearance from luminaire to luminaire of the same type and in all configurations, shall be consistent both initially and at 60,000 hours and operate within a tolerance of <2.5 MacAdam ellipse as defined by the center of the quadrangles defined in ANSI C78.377-2015.

### Buy American Act

This product is assembled in the USA and meets the Buy America(n) government procurement requirements under FAR, DFARS and DOT regulations.

Please refer to [www.acuitybrands.com/buy-american](http://www.acuitybrands.com/buy-american) for additional information.

### Warranty

5-year limited warranty. This is the only warranty provided and no other statements in this specification sheet create any warranty of any kind. All other express and implied warranties are disclaimed. Complete warranty terms located at: [www.acuitybrands.com/support/warranty/terms-and-conditions](http://www.acuitybrands.com/support/warranty/terms-and-conditions)

### Note:

Actual performance may differ as a result of end user environment and application.  
All values are design or typical values, measured under laboratory conditions at 25 °C.

### A+ Capable Luminaire

This item is an A+ capable luminaire, which has been designed and tested to provide consistent color appearance and out-of-the-box control capability with simple commissioning when used with Acuity Brands controls products.

All configurations of this luminaire are calibrated and tested to meet the Acuity Brands' specification for chromatic consistency - including color rendering, color fidelity and color temperature tolerance around standard CIE chromaticity coordinates.

To learn more about A+, visit [www.acuitybrands.com/aplus](http://www.acuitybrands.com/aplus).

Tables of Use

Lumen Output Multiplier		
CRI	CCT	Multiplier
80	2700K	0.910
	3000K	0.946
	3500K	1.000
	4000K	1.027
	5000K	1.054
90	2700K	0.784
	3000K	0.847
	3500K	0.874
	4000K	0.946

Reflector Finish Multiplier	
Reflector Finish	Multiplier
LSS - Semi Specular	1.00
LD - Matte Diffuse	0.98
Reflector Color	Multiplier
WR - White	0.98
BR - Black	0.92
BZR - Bronze	0.91
AR - Clear	1.00
GR - Gold	0.99
PR - Pewter	0.99
WTR - Wheat	0.98

Driver		Control Provided				
Nomenclature	Description	NLT	NLTER	NLTAIR2	NLTAIREM2	NLTAIRER2
UGZ	0-10V driver dims to 1%	nPP16 D EFP	nPP16 D ER EFP	RPP20 D 24V G2	RPP20 D 24V EM G2	RPP20 D 24V ER G2

Marked Spacing in Inches 25°C Ambient			
Lumen Package	Fixed Center to Center MIN	Fixture Center to Building Member MIN	Space Above Fixture
2000	18	9	3
1500 (HA0)	18	9	3

Flangeless

Flangeless Installation

Gotham's flangeless option utilizes a micro-thin polymer mud ring that minimizes the amount of drywall compound required to finish the ceiling. The end result is a virtually undetectable flangeless downlight installation.

The polymer mud ring is installed independent of the of the recessed frame, therefore floating with the ceiling. This innovation minimizes any surface cracks during reflector installation, ceiling movement and any future service to the recessed frame, wiring, electronics, etc.



Partially finished mud ring, showing cross-section detail.



An EVO downlight requires only approximately 3" of plaster to finish.



EVO with flangeless trim

\*Dimensions in inches [centimeters]

Aperture: 2-1/4" [5.7]

Ceiling Opening: 2-5/8" [6.7] self-flanged

Overlap Trim: 3" [7.6]

2-3/4" [7] flangeless

### Recessed Application - Minimum Clearance Requirements

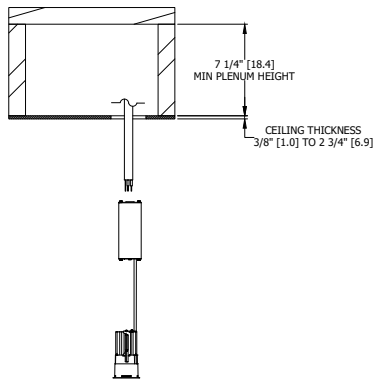

### Structural Reinforcement Pan

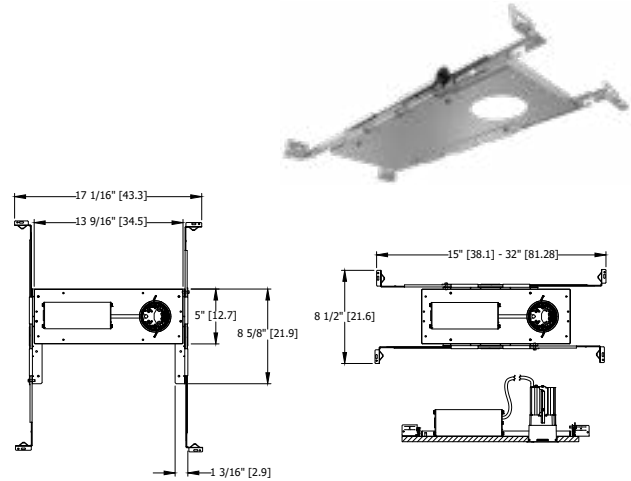

### 1000 Lumen and Below Install-from-Below Construction

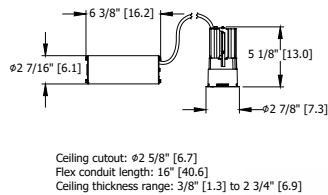

### IC / Airtight Housing / Chicago Plenum Construction

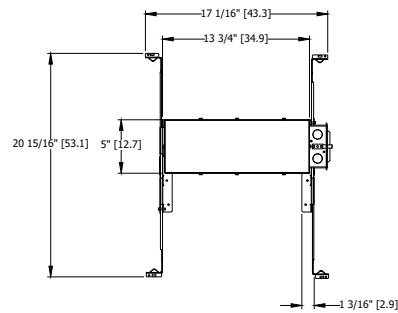

### 1500 and 2000 Lumen or High Ambient Option Install-from-Below Construction

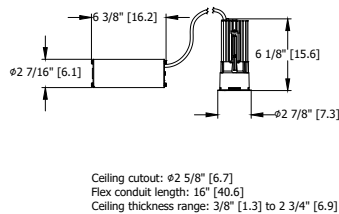

### 347V Transformer

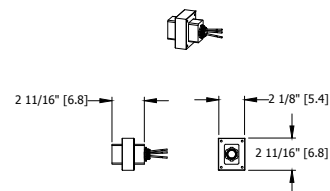

347 Transformer:  
Install to accessible  
junction box by others

**CONSULT [WWW.GOTHAMLIGHTING.COM](http://WWW.GOTHAMLIGHTING.COM) FOR ADDITIONAL PHOTOMETRY**

**ICO2 35/15 AR LSS 15D** Input Watts: 19.8, Delivered Lumens: 1764, LPW: 89.1, S/MH: 0.28, Test No: 19-383-01P65

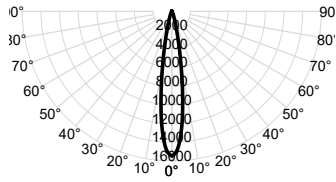

CP Summary	Zonal Lumen Summary				Coefficients of Utilization										Cone of Light			Luminance (cd/sq.m)	
	0°	Zone	Lumens	% Fixture	pf pc	80%		70%		50%		Mounting Height	Initial FC Center Beam	Beam Diameter	Average Luminance				
						50%	30%	50%	30%	50%	30%								
						10%	50%	30%	10%										
0° 15,477	0° - 30°	1,650	94%	0	119	119	119	116	116	111	111	111	6.0	429.9	1.7	0° 5,875,626			
5° 12,289	0° - 40°	1,721	98%	1	113	112	110	111	110	108	107	106	105	8.0	241.8	2.3	45° 22,013		
15° 1,769	0° - 60°	1,761	100%	2	109	106	104	107	105	103	104	102	100	10.0	154.8	2.9	55° 4,964		
25° 320	0° - 90°	1,764	100%	3	105	101	99	103	100	98	101	99	97	12.0	107.5	3.5	65° 1,886		
35° 113	90° - 180°	0	0%	4	101	98	95	100	97	94	98	96	93	14.0	79.0	4.1	75° 1,027		
45° 41	0° - 180°	1,764	100%	5	98	94	92	97	94	91	91	96	93	Beam Angle: 16.6° Field Angle: 31.5°			85° 871		
55° 8				6	95	92	89	95	91	89	94	91	88						
65° 2				7	93	89	87	92	89	87	91	88	86						
75° 1				8	91	87	85	90	87	85	90	86	84						
85° 0				9	89	85	83	88	85	83	88	85	83						
90° 0				10	87	84	81	87	83	81	86	83	81						

**ICO2 35/15 AR LSS 30D** Input Watts: 19.8, Delivered Lumens: 1679, LPW: 84.8, S/MH: 0.51, Test No: 19-383-04P65

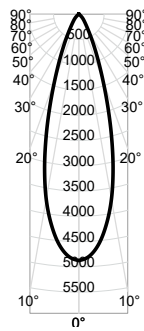

CP Summary	Zonal Lumen Summary				Coefficients of Utilization										Cone of Light			Luminance (cd/sq.m)			
	0°	Zone	Lumens	% Fixture	pf	80%					20%					Mounting Height	Initial FC Center Beam	Beam Diameter	Average Luminance		
					pc	50%		30%		10%		50%		30%						10%	
					pw	50%	30%	10%	50%	30%	10%	50%	30%	10%							
0°	4,876	0° - 30°	1,439	86%	0	119	119	119	116	116	116	111	111	111	6.0	135.4	3.3	0°	1,850,977		
5°	4,562	0° - 40°	1,588	95%	1	112	110	108	110	108	106	106	104	103	8.0	76.2	4.4	45°	48,643		
15°	2,498	0° - 60°	1,674	100%	2	106	102	99	104	101	98	101	98	96	10.0	48.8	5.5	55°	9,862		
25°	742	0° - 90°	1,679	100%	3	100	96	93	99	95	92	96	93	90	12.0	33.9	6.5	65°	3,234		
35°	228	90° - 180°	0	0%	4	95	91	87	94	90	87	92	88	86	14.0	24.9	7.6	75°	1,614		
45°	91	0° - 180°	1,679	100%	5	91	86	82	90	85	82	88	84	81	Beam Angle: 30.5° Field Angle: 56.8°				85°	871	
55°	15				6	87	82	78	86	81	78	85	80	77							
65°	4				7	83	78	75	82	78	74	81	77	74							
75°	1				8	80	75	71	79	74	71	78	74	71							
85°	0				9	77	72	68	76	72	68	75	71	68							
90°	0				10	74	69	66	73	69	66	73	68	66							

**ICO2 35/15 AR LSS 45D** Input Watts: 19.8, Delivered Lumens: 1662, LPW: 83.9, S/MH: 0.72, Test No: 19-383-07P65

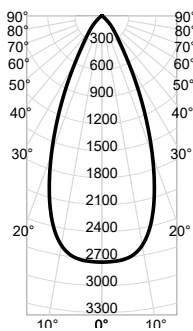

CP Summary	Zonal Lumen Summary				Coefficients of Utilization										Cone of Light			Luminance (cd/sq.m)			
	0°	Zone	Lumens	% Fixture	pf pc	50%		80%		10%		50%		30%		50%		Mounting Height	Initial FC Center Beam	Beam Diameter	Average Luminance
						50%	30%	10%	50%	30%	10%	50%	30%	10%							
						50%	30%	10%	50%	30%	10%	50%	30%	10%							
0°	2,739	0° - 30°	1,337	80%	0	119	119	119	116	116	116	111	111	111	111	6.0	76.1	4.9	0°	1,039,647	
5°	2,721	0° - 40°	1,548	93%	1	111	109	107	109	107	105	105	105	104	102	8.0	42.8	6.5	45°	62,226	
15°	2,216	0° - 60°	1,657	100%	2	104	101	98	103	99	96	99	97	94	102	10.0	27.4	8.2	55°	10,789	
25°	1,047	0° - 90°	1,662	100%	3	98	94	90	97	93	89	94	91	88	102	12.0	19.0	9.8	65°	3,414	
35°	322	90° - 180°	0	0%	4	92	87	83	91	87	83	89	85	82	102	14.0	14.0	11.4	75°	1,760	
45°	116	0° - 180°	1,662	100%	5	87	82	78	86	81	78	85	80	77	102				85°	1,307	
55°	16				6	83	77	73	82	77	73	80	76	73	102	Beam Angle: 44.4°					
65°	4				7	78	73	69	78	73	69	77	72	69	102	Field Angle: 73.4°					
75°	1				8	75	69	65	74	69	65	73	68	65	102						
85°	0				9	71	66	62	71	65	62	70	65	62	102						
90°	0				10	68	63	59	67	62	59	67	62	59	102						

**ICO2 35/15 AR LSS 55D** Input Watts: 19.8, Delivered Lumens: 1697, LPW: 85.7, S/MH: 0.90, Test No: 19-383-09P65

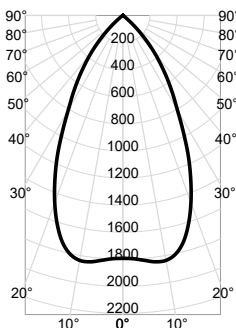

CP Summary	Zonal Lumen Summary				Coefficients of Utilization										Cone of Light			Luminance (cd/sq.m)					
	0°	Zone	Lumens	% Fixture	pf pc	50%		80%		10%		50%		70%		30%		50%	10%	Mounting Height	Initial FC Center Beam	Beam Diameter	Average Luminance
						pw	50%	30%	10%	50%	30%	10%	50%	30%	10%								
0°	1,793	0° - 30°	1,168	69%	0	119	119	119	116	116	116	111	111	111	111	6.0	49.8	6.4	0°	680,772			
5°	1,815	0° - 40°	1,526	90%	1	111	108	106	109	106	104	104	103	101	8.0	28.0	8.6	45°	102,010				
15°	1,730	0° - 60°	1,692	100%	2	103	99	95	101	97	94	98	95	92	10.0	17.9	10.7	55°	8,803				
25°	1,144	0° - 90°	1,697	100%	3	96	91	87	94	90	86	92	88	85	12.0	12.5	12.9	65°	3,144				
35°	574	90° - 180°	0	0%	4	89	84	80	88	83	79	86	82	78	14.0	9.1	15.0	75°	1,760				
45°	190	0° - 180°	1,697	100%	5	84	78	73	83	77	73	81	76	72	Beam Angle: 56.5° Field Angle: 90.4°			85°	1,307				
55°	13				6	78	72	68	78	72	68	76	71	67									
65°	4				7	74	67	63	73	67	63	72	66	63									
75°	1				8	69	63	59	69	63	59	68	62	59									
85°	0				9	65	59	55	65	59	55	64	59	55									
90°	0				10	62	56	52	61	56	52	60	55	52									

nLight® AIR is the ideal solution for retrofit or new construction spaces where adding communication wiring is cost prohibitive. The integrated nLight AIR rPP20 Power Pack is part of each EVO Luminaire ordered with the NLTAIR option. These individually addressable controls offer the ultimate in flexibility during initial setup and for space repurposing.

#### nLight® AIR Control Accessories

Order as separate catalog number. Visit [nLight AIR](#).

##### Wall Switches

Model Number	
On/Off single pole	rPODB (color) G2
On/Off two pole	rPODB 2P (color) G2
On/Off & raise/lower single pole	rPODB DX (color) G2
On/Off & raise/lower two pole	rPODB 2P DX (color) G2

#### nLight® AIR Control Accessories (cont.)

##### Occupancy Sensors (PIR/dual tech)

Model Number	
Small motion 360°, ceiling	rCMS 9 / rCMS PDT 9
Large motion 360°, ceiling	rCMS 10 / rCMS PDT 10

#### Possibilities for nLight® AIR

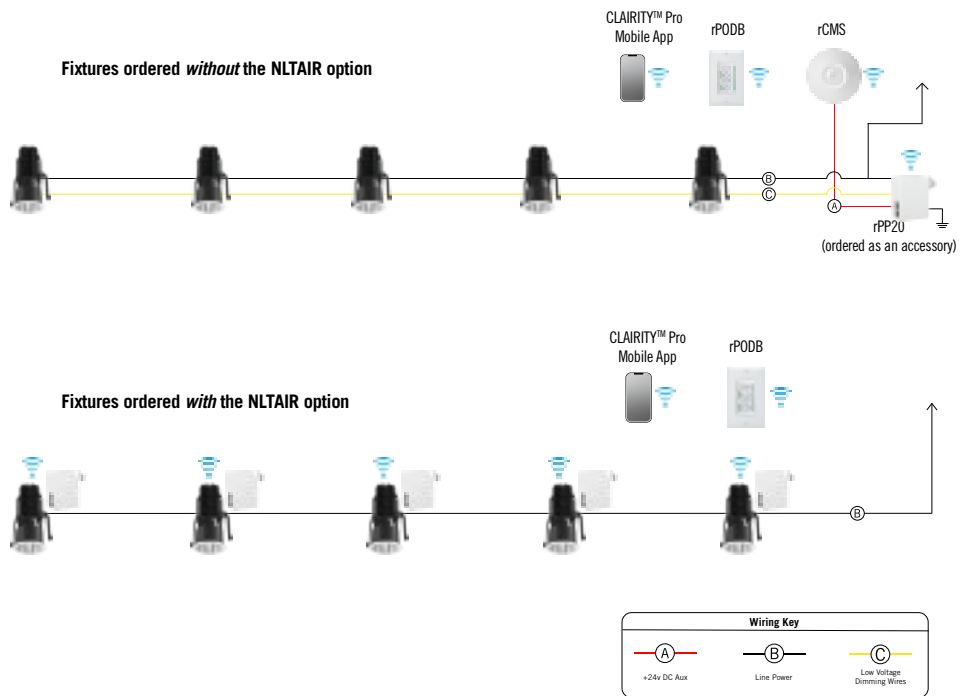

nLight® Wired The nLight® solution is a digital networked lighting control system that provides both energy savings and increased user configurability by cost effectively integrating time-based, daylight-based, sensor-based and manual lighting control schemes.

#### nLight® Wired Control Accessories

Order as separate catalog number. Visit [nLight](#).

##### Wall Switches

Model Number	
On/Off single pole	nPODM (XX)
On/Off two pole	nPODM 2P (XX)
On/Off & raise/lower single pole	nPOD DX (XX)
On/Off & raise/lower two pole	nPODM 2P DX (XX)
Graphic touchscreen	nPOD GFX (XX)

##### Photocell Controls

Dimming	nCM ADCX
---------	----------

#### nLight® Wired Control Accessories (cont.)

##### Occupancy Sensors (PIR/dual tech)

Model Number	
Small motion 360°, ceiling	nCM 9 / nCM PDT 9
Large motion 360°, ceiling	nCM 10 / nCM PDT 10
Wide View	nWV 16 / nWV PDT 16
Wall switch with raise/lower	nWSX LV DX / nWSX PDT LV DX

##### Cat-5 Cables (plenum rated)

10', CAT5	CAT5 10FT J1
15', CAT5	CAT5 15FT J1

#### Possibilities for nLight® wired

