

Juno®

Podz™ LED Downlight Series

6" Canless Round and Square LED Downlight
New Construction or Remodel

JPDZ6 Series



Complete remodel fixture shown



Complete new construction fixture shown



WarmDim®

Dimensions

6" Round

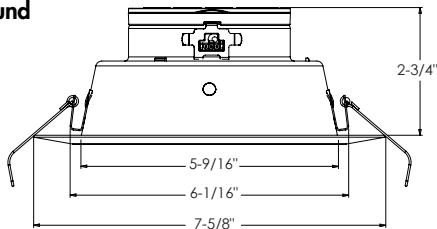

6" Square

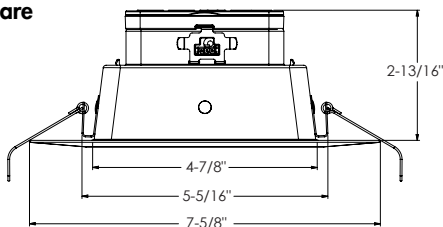

Application Flexibility - Remodel



Project:

Fixture Type:

Location:

Contact/Phone:

Product Features

Canless low profile 6" LED recessed downlight with deeply regressed light source and technology rich features offers performance up to 1200L and installation solutions for both new construction and remodel applications.

Patented color temperature and intensity configurable lighting fixture (US Patent No. 11,259,377 B2)

- Integrated light engine offers switchable LED color temperature and adjustable lumen output directly on module for easy switching
- Advanced color mixing technology provides consistent performance on the black body curve at all LED color temperatures while maintaining a high 90+ CRI
- Warmdim™ setting provides performance similar to incandescent light sources and warms the LED color temperature over the dimming range from 2850K to 1900K

Installation flexibility and ease

- Low profile integrated LED downlight less than 3" in height fits virtually anywhere
- Installs directly into the plenum - eliminates need for typical recessed housing
- Installs into new construction or remodel applications

Applications

- Ideal for a breadth of residential and commercial applications
- Shallow plenum installations
- IC rated - for direct contact with insulation
- Wet location listed - for use in shower and outdoor covered ceiling applications

Performance

| | |
|----------------------------------|--|
| Switchable Delivered Lumens | 700L, 1000L, 1200L |
| Switchable LED Color Temperature | 27K, 30K, 35K, 40K, 50K |
| WarmDim Included as standard | 2850K - 1900K over dimming range |
| CRI | 90+ |
| Voltage | Dedicated 120V or MVOLT (120-277V) |
| Dimming | Forward/Reverse Phase or 0-10V Dimming range from 100% to 5% |

Specifications

| | Round | Square |
|------------------|----------------|----------------|
| Aperture: | 5.56" (14.13) | 4.88" (12.39) |
| Ceiling Opening: | 6.87" (17.46) | 6.87" (17.46) |
| Overlap Trim: | 7.625" (19.37) | 7.625" (19.37) |
| Height: | 2.75" (6.99) | 2.81" (7.14) |

All dimensions are in Inches (centimeters unless otherwise indicated).

Application Flexibility - New Construction





Podz™ LED Downlight Series

6" Canless Round and Square LED Downlight
New Construction or Remodel

ORDERING INFORMATION

Two ways to
order Podz:

1. Ship separate trim module and mounting

Trim Module



Mounting Option

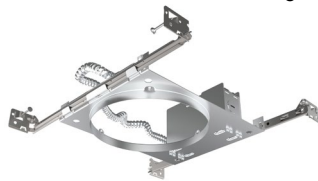

or



Example: JPDZ6 DC ALO10 SWW5WD 90CRI JPDZRMJBX 120 FRPC WWH, Ships as example: Trim module: JPDZ6 DC ALO10 SWW5WD 90CRI 120 FRPC WWH M6, Mounting: JPDZRMJBX 120 FRPC M6

| Series | Trim Type | Lumens | Color Temperature | CRI |
|-----------------------------------|---|---|---|--------------|
| JPDZ6 Juno Podz 6" LED Downlights | DB Round Downlight Baffle DC Round Downlight Cone SQDB Square Downlight Baffle SQDC Square Downlight Reflector | ALO10 Adjustable Lumen Output 700L, 1000L, and 1200L | SWW5WD Switchable White 2700K, 3000K, 3500K, 4000K, 5000K, + WarmDim (2850K-1900K) | 90CRI 90+CRI |

| Mounting (Required for complete fixture) | Voltage/Driver | Finish |
|---|--|---|
| REMODEL: JPDZRMJBX ⁴ Juno Podz universal remodel junction box (for 4", 5", 6") | 120 FRPC 120V Forward/Reverse Phase Cut, 5% dim MVOLT ZT10 Multi-Volt (120-277), 0-10V, 10% dim | WWH ¹ White, White Trim Ring BWH ^{2,5} Black, White Trim Ring CWH ³ Clear, White Trim Ring HZWH ³ Haze, White Trim Ring WHZWH ³ Wheat Haze, White Trim Ring |
| NEW CONSTRUCTION: JPDZ6NCMF Juno Podz 6IN New Construction Mounting Frame (For use with Round and Square Trim Modules) | | |

NOTES

- 1 WWH is available with DB, SQDB, DC and SQDC.
- 2 BWH only available with DB and SQDB.
- 3 CWH, HZWH and WHZWH only available with DC and SQDC.
- 4 Not for use in an existing housing.
- 5 Square black baffle not ENERGY STAR® and T24 certified.



2. All-in-one box remodel downlight

| Series | Trim Type/Voltage | Finish |
|--|--|----------------------------|
| JPDZ6JB Juno Podz 6" Trim and Remodel Junction Box | RDB1 Round Downlight Baffle 120V RDC1 Round Downlight Cone 120V | WWH White, White Trim Ring |

EMERGENCY OPERATION OPTION

For use in Non-IC applications where insulation is spaced at least 3" away
If installing from below the ceiling, minimum plenum depths required:
IIS 25 = 9 1/2"
IIS 50 = 12 1/8"

| | |
|---------------|------------------------------|
| Iota IIS 25 I | 25W Emergency Micro-Inverter |
| Iota IIS 50 I | 50W Emergency Micro-Inverter |

ACCESSORIES

Trim inserts are interchangeable and field installable to easily change the aesthetic of the Podz luminaire

| | |
|-------------------------|---------------------------------------|
| RK3JPDZ6 DB BWH BFL | 6" Round Baffle Black Trim Insert |
| RK3JPDZ6 DB WWH BFL | 6" Round Baffle White Trim Insert |
| RK3JPDZ6 DC CWH RFL | 6" Round Cone Clear Trim Insert |
| RK3JPDZ6 DC HZWH RFL | 6" Round Cone Haze Trim Insert |
| RK3JPDZ6 DC WHZWH RFL | 6" Round Cone Wheat Haze Trim Insert |
| RK3JPDZ6 DC WWH RFL | 6" Round Cone White Trim Insert |
| RK3JPDZ6 SQDB BWH BFL | 6" Square Baffle Black Trim Insert |
| RK3JPDZ6 SQDB WWH BFL | 6" Square Baffle White Trim Insert |
| RK3JPDZ6 SQDC CWH RFL | 6" Square Cone Clear Trim Insert |
| RK3JPDZ6 SQDC HZWH RFL | 6" Square Cone Haze Trim Insert |
| RK3JPDZ6 SQDC WHZWH RFL | 6" Square Cone Wheat Haze Trim Insert |
| RK3JPDZ6 SQDC WWH RFL | 6" Square Cone White Trim Insert |



Podz™ LED Downlight Series

6" Canless Round and Square LED Downlight
New Construction or Remodel

Specifications

LED Light Engine

Patented color temperature and intensity configurable lighting fixture (US Patent No. 11,259,377 B2) with integrated light engine that mounts directly to aluminum housing providing superior heat transfer to ensure long life of the electronics • Switchable LED color temperature and adjustable lumen output directly on module for easy switching • Advanced color mixing technology provides consistent color rendering on the black body curve at all LED color temperatures • LED color temperature settings include 2700K, 3000K, 3500K, 4000K and 5000K; factory set at 3000K • Three lumen switching options include 700L, 1000L and 1200L; factory set at 1000L • Dedicated WarmDim setting provides performance similar to incandescent light sources and warms the LED color temperature over the dimming range from 2850K to 1900K • 90CRI minimum

LED Driver

Choice of dedicated 120 volt (120) driver or universal voltage (MVOLT) drivers that accommodate input voltages from 120-277 volts AC at 50/60Hz • Power factor > 0.9 at 120V input • 120 volt only driver is dimmable with the use of most incandescent, magnetic low voltage and electronic low voltage wall box dimmers • Universal voltage drivers are dimmable with the use of most 0-10V wall box dimmers • For a list of compatible dimmers, see [JUNOICLED-DIM](#)

Optical System

Computer-optimized reflector design with high reflectance white finish coupled with a high transmission diffusing lens conceals the LEDS and produces uniform aperture luminance • Deep regression of lens produces a low glare, efficient system typical of a standard 4" downlight medium flood distribution providing even illumination for general downlighting applications.

Certifications

ENERGY STAR® Certified • Can be used to comply with 2019 Title 24, Part 6, JA8 high efficacy LED light source requirements • UL listed for U.S. and Canada through-branch wiring, damp locations and for wet location (indoor and outdoor covered ceiling) • UL and cUL • NOM Certified.

Testing All reports are based on published industry procedures; field performance may differ from laboratory performance.

Trim Module Construction

Low profile, < 3" aluminum housing with integral white flange • Designed for installation directly into the plenum in IC (insulated ceiling) or non-IC construction • Provided with spring clips for ease of installation • Accommodates up to a 1 1/2" ceiling thickness

Trim Finishes

Choice of baffle or cone trims in a selection of finishes ship installed in trim • Optional field installable trim inserts available.

Remodel Junction Box Construction

22-gauge die-formed galvanized steel junction box • Conduit cable with quick connect electrical plug pre-wired on junction box and allows for easy electrical connection with the trim module • Junction box provided with (5) 1/2" and (1) 3/4" knockouts, (4) integrated wire traps for 12/2 or 12/3 NM cable UL listed and cUL listed for through-branch wiring, maximum of 4 #12 branch circuit

New Construction Mounting Frame

22-gauge die-formed galvanized steel mounting frame • Rough-in section (junction box, mounting frame and bar hangers) fully assembled for ease of installation • Pre-installed Air-Loc gasket applied to frame • Conduit cable with quick connect electrical plug pre-wired on junction box and allows for easy electrical connection with the trim module • Junction box provided with (5) 1/2" and (1) 3/4" knockouts, (4) knockouts for 12/2 or 12/3 NM cable and ground wire • UL listed and cUL listed for through-branch wiring, maximum of 6 #12 branch circuit conductors • Junction box provided with removable access plates • Knock-outs equipped with pryout slots

Includes Patented (US Patent D552,969) Real Nail® 3 bar hangers: telescoping system permits quick placement of housing any where within 24" O.C. joists or suspended ceilings • Includes removable nail for repositioning of fixture in wood joist construction • Integral T-bar notch and clip for suspended ceilings.

LED housing is designed to provide 33,000 hours of life at 70% lumen maintenance • 5 year limited warranty on LED components.

Note: Actual performance may differ as a result of end-user environment and application.

All values are design or typical values, measured under laboratory conditions at 25 °C.

Specifications subject to change without notice.



Control the LED color temperature and lumen output in your space with the switchable LED color temperature and adjustable lumen output switches accessible directly on the Podz trim.



Podz™ LED Downlight Series

6" Canless Round and Square LED Downlight
New Construction or Remodel

TECHNICAL DATA

Dimensional Data and Electrical Data

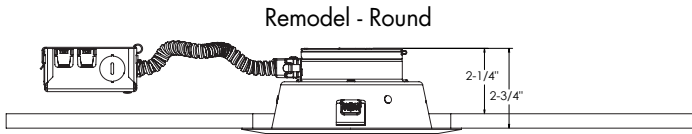

6 7/8" CEILING CUTOUT

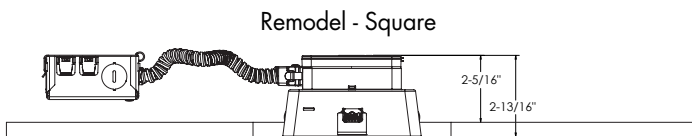

6 7/8" CEILING CUTOUT

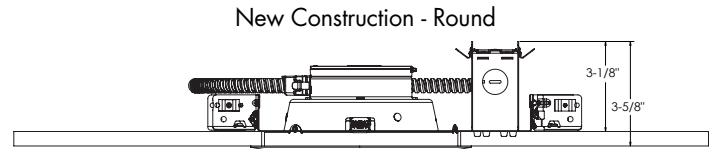
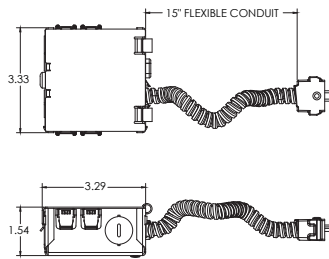

6 7/8" CEILING CUTOUT

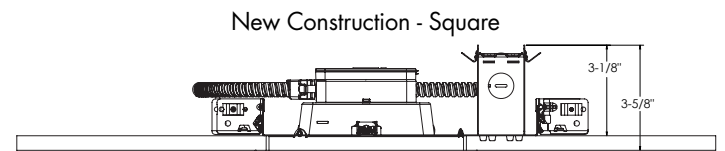

6 7/8" CEILING CUTOUT

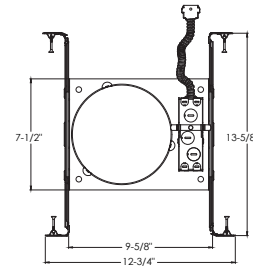

ELECTRICAL DATA

Dedicated 120V Only Driver Option (120 FRPC)

| | 700L | 1000L | 1200L |
|-----------------------|--|--|--|
| Input Power | 8.2W (+/-5%) | 13.7W (+/-5%) | 15.2W (+/-5%) |
| Input Current | 0.07A | 0.11A | 0.13A |
| Frequency | 50/60Hz | 50/60Hz | 50/60Hz |
| EMI/RFI | FCC Title 47 CFR, Part 15, Class B (residential) | FCC Title 47 CFR, Part 15, Class B (residential) | FCC Title 47 CFR, Part 15, Class B (residential) |
| Minimum starting temp | -20°C | -20°C | -20°C |

ELECTRICAL DATA

Universal Voltage

MVOLT ZT10

| 700L | | 1000L | | 1200L | |
|-----------------------|--|--|--|--|--|
| 120V | 277V | 120V | 277V | 120V | 277V |
| Input Power | 8.2W (+/-5%) | 8.2W (+/-5%) | 13.7W (+/-5%) | 15.2W (+/-5%) | 15.2W (+/-5%) |
| Input Current | 0.07A | 0.03A | 0.11A | 0.05A | 0.06A |
| Frequency | 50/60Hz | 50/60Hz | 50/60Hz | 50/60Hz | 50/60Hz |
| EMI/RFI | FCC Title 47 CFR, Part 15, Class B (residential) | FCC Title 47 CFR, Part 15, Class B (residential) | FCC Title 47 CFR, Part 15, Class B (residential) | FCC Title 47 CFR, Part 15, Class B (residential) | FCC Title 47 CFR, Part 15, Class B (residential) |
| Minimum starting temp | -20°C | -20°C | -20°C | -20°C | -20°C |



Podz™ LED Downlight Series

6" Canless Round and Square LED Downlight
New Construction or Remodel

PHOTOMETRICS

Distribution Curve

Distribution Data

Output Data

Coefficient of Utilization

Illuminance Data at 30" Above
Floor for a Single Luminaire

JPDZ6 DB 07LM 30K 90CRI WWH, Input Watts: 8.2, Delivered Lumens: 743, LPW: 90.6, S/MH: 1.12, Test No: 20-971-1

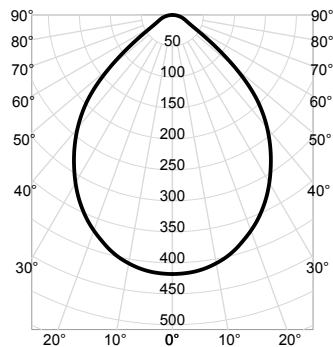

| CP Summary | | Zonal Lumen Summary | | | | Coefficients of Utilization | | | | | | | | | | Cone of Light | | | Luminance (cd/sq.m) | |
|------------|------|---------------------|-----------|------|-----|-----------------------------|-----|-----|-----|-----|-----|-----|-----|-----|--|---------------|-----------------|------------------------|---------------------|-------------------|
| | | | | | | pf | | | | | | | | | | | Mounting Height | Initial FC Center Beam | Beam Diameter | Average Luminance |
| 0° | Zone | Lumens | % Fixture | pc | 50% | 30% | 10% | 50% | 30% | 10% | 50% | 30% | 10% | 50% | 30% | 10% | | | | |
| 0° | 418 | 0° - 30° | 308 | 41% | 0 | 119 | 119 | 119 | 116 | 116 | 116 | 111 | 111 | 111 | 6.0 | 11.6 | 11.3 | 0° | 29,605 | |
| 5° | 416 | 0° - 40° | 480 | 65% | 1 | 108 | 104 | 101 | 105 | 102 | 100 | 101 | 99 | 97 | 8.0 | 6.5 | 15.0 | 45° | 19,262 | |
| 15° | 392 | 0° - 60° | 694 | 93% | 2 | 97 | 92 | 87 | 95 | 90 | 86 | 92 | 88 | 84 | 10.0 | 4.2 | 18.8 | 55° | 8,936 | |
| 25° | 345 | 0° - 90° | 743 | 100% | 3 | 88 | 81 | 76 | 86 | 80 | 75 | 83 | 78 | 74 | 12.0 | 2.9 | 22.6 | 65° | 4,472 | |
| 35° | 277 | 90° - 180° | 0 | 0% | 4 | 80 | 72 | 67 | 78 | 72 | 66 | 76 | 70 | 65 | 14.0 | 2.1 | 26.3 | 75° | 4,239 | |
| 45° | 192 | 0° - 180° | 743 | 100% | 5 | 72 | 65 | 59 | 71 | 64 | 59 | 69 | 63 | 58 | Beam Angle: 86.5° Field Angle: 119.0° | | | 85° | 3,493 | |
| 55° | 72 | | | | 6 | 66 | 59 | 53 | 65 | 58 | 53 | 64 | 57 | 52 | | | | | | |
| 65° | 27 | | | | 7 | 61 | 53 | 48 | 60 | 53 | 48 | 59 | 52 | 47 | | | | | | |
| 75° | 16 | | | | 8 | 56 | 49 | 43 | 55 | 48 | 43 | 54 | 48 | 43 | | | | | | |
| 85° | 4 | | | | 9 | 52 | 45 | 40 | 51 | 44 | 40 | 50 | 44 | 39 | | | | | | |
| 90° | 0 | | | | 10 | 48 | 41 | 36 | 48 | 41 | 36 | 47 | 41 | 36 | | | | | | |

JPDZ6 DB 10LM 30K 90CRI WWH, Input Watts: 13.7, Delivered Lumens: 1153, LPW: 84.2, S/MH: 1.13, Test No: 20-971-2

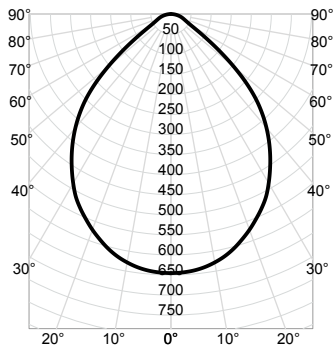

| CP Summary | | Zonal Lumen Summary | | | | Coefficients of Utilization | | | | | | | | | | Cone of Light | | | Luminance (cd/sq.m) | | |
|------------|-----|---------------------|--------|-----------|----|-----------------------------|-----|-----|-----|-----|-----|-----|-----|-----|-------------------|---------------------|-----------------|------------------------|---------------------|--|--|
| | | | | | | pf | | | | | | | | | | | Mounting Height | Initial FC Center Beam | Beam Diameter | | |
| 0° | | Zone | Lumens | % Fixture | pc | 50% | 30% | 10% | 50% | 30% | 10% | 50% | 30% | 10% | Average Luminance | | | | | | |
| 0° | 645 | 0° - 30° | 477 | 41% | 0 | 119 | 119 | 119 | 116 | 116 | 116 | 111 | 111 | 111 | 6.0 | 17.9 | 11.4 | 0° | 45,688 | | |
| 5° | 642 | 0° - 40° | 745 | 65% | 1 | 108 | 104 | 101 | 105 | 102 | 100 | 101 | 99 | 97 | 8.0 | 10.1 | 15.1 | 45° | 29,944 | | |
| 15° | 605 | 0° - 60° | 1,078 | 93% | 2 | 97 | 92 | 87 | 95 | 90 | 86 | 92 | 88 | 84 | 10.0 | 6.5 | 18.9 | 55° | 13,971 | | |
| 25° | 534 | 0° - 90° | 1,153 | 100% | 3 | 88 | 81 | 76 | 86 | 80 | 75 | 83 | 78 | 74 | 12.0 | 4.5 | 22.7 | 65° | 6,968 | | |
| 35° | 431 | 90° - 180° | 0 | 0% | 4 | 80 | 72 | 67 | 78 | 72 | 66 | 76 | 70 | 65 | 14.0 | 3.3 | 26.5 | 75° | 6,564 | | |
| 45° | 299 | 0° - 180° | 1,153 | 100% | 5 | 72 | 65 | 59 | 71 | 64 | 59 | 69 | 63 | 58 | Beam Angle: 86.8° | | | 85° | 5,361 | | |
| 55° | 113 | | | | | 6 | 66 | 59 | 53 | 65 | 58 | 53 | 64 | 57 | 52 | Field Angle: 119.1° | | | | | |
| 65° | 42 | | | | | 7 | 61 | 53 | 48 | 60 | 53 | 48 | 59 | 52 | 47 | | | | | | |
| 75° | 24 | | | | | 8 | 56 | 49 | 43 | 55 | 48 | 43 | 54 | 48 | 43 | | | | | | |
| 85° | 7 | | | | | 9 | 52 | 45 | 40 | 51 | 44 | 40 | 50 | 44 | 39 | | | | | | |
| 90° | 0 | | | | | 10 | 48 | 41 | 36 | 48 | 41 | 36 | 47 | 40 | 36 | | | | | | |

JPDZ6 DB 12LM 30K 90CRI WWH, Input Watts: 15.2, Delivered Lumens: 1243, LPW: 81.8, S/MH: 1.13, Test No: 20-971-3

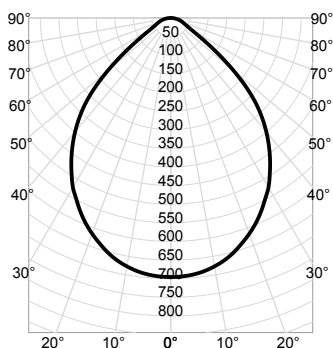

| CP Summary | | Zonal Lumen Summary | | | | Coefficients of Utilization | | | | | | | | | | Cone of Light | | | Luminance (cd/sq.m) | |
|------------|-----|---------------------|--------|-----------|----|-----------------------------|-----|-----|-----|-----|-----|-----|-----|-----|--|------------------------|---------------|-------------------|---------------------|--|
| | | | | | | pf | | | | | | | | | Mounting Height | Initial FC Center Beam | Beam Diameter | | | |
| 0° | | Zone | Lumens | % Fixture | pc | 50% | 30% | 10% | 50% | 30% | 10% | 50% | 30% | 10% | | | | Average Luminance | | |
| 0° | 696 | 0° - 30° | 513 | 41% | 0 | 119 | 119 | 119 | 116 | 116 | 116 | 111 | 111 | 111 | 6.0 | 19.3 | 11.4 | 0° | 49,242 | |
| 5° | 692 | 0° - 40° | 803 | 65% | 1 | 108 | 104 | 101 | 105 | 102 | 100 | 101 | 99 | 97 | 8.0 | 10.9 | 15.1 | 45° | 32,286 | |
| 15° | 652 | 0° - 60° | 1,161 | 93% | 2 | 97 | 92 | 87 | 95 | 90 | 86 | 92 | 88 | 84 | 10.0 | 7.0 | 18.9 | 55° | 15,057 | |
| 25° | 574 | 0° - 90° | 1,243 | 100% | 3 | 88 | 81 | 76 | 86 | 80 | 75 | 83 | 78 | 74 | 12.0 | 4.8 | 22.7 | 65° | 7,521 | |
| 35° | 465 | 90° - 180° | 0 | 0% | 4 | 80 | 72 | 67 | 78 | 72 | 66 | 76 | 70 | 65 | 14.0 | 3.5 | 26.5 | 75° | 7,084 | |
| 45° | 323 | 0° - 180° | 1,243 | 100% | 5 | 72 | 65 | 59 | 71 | 64 | 59 | 69 | 63 | 58 | Beam Angle: 86.9° Field Angle: 119.1° | | | 85° | 5,767 | |
| 55° | 122 | | | | 6 | 66 | 59 | 53 | 65 | 58 | 53 | 64 | 57 | 52 | | | | | | |
| 65° | 45 | | | | 7 | 61 | 53 | 48 | 60 | 53 | 48 | 59 | 52 | 47 | | | | | | |
| 75° | 26 | | | | 8 | 56 | 49 | 43 | 55 | 48 | 43 | 54 | 48 | 43 | | | | | | |
| 85° | 7 | | | | 9 | 52 | 45 | 40 | 51 | 44 | 40 | 50 | 44 | 39 | | | | | | |
| 90° | 0 | | | | 10 | 48 | 41 | 36 | 48 | 41 | 36 | 47 | 40 | 36 | | | | | | |



Podz™ LED Downlight Series

6" Canless Round and Square LED Downlight
New Construction or Remodel

PHOTOMETRICS

| Distribution Curve | Distribution Data | Output Data | Coefficient of Utilization | Illuminance Data at 30" Above Floor for a Single Luminaire |
|--------------------|-------------------|-------------|----------------------------|--|
|--------------------|-------------------|-------------|----------------------------|--|

JPDZ6 DC 07LM 30K 90CRI HZWH, Input Watts: 8.2, Delivered Lumens: 760, LPW: 92.7, S/MH: 0.75, Test No: 20-971-4

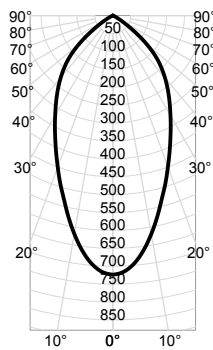

| CP Summary | | Zonal Lumen Summary | | | | Coefficients of Utilization | | | | | | | | | | Cone of Light | | | Luminance (cd/sq.m) | |
|------------|-----|---------------------|--------|-----------|----|-----------------------------|-----|-----|-----|-----|-----|-----|-----|-----------------|--|---------------|------|-------------------|---------------------|--|
| | | | | | | pf | | 80% | | 70% | | 50% | | Mounting Height | Initial FC Center Beam | Beam Diameter | | | | |
| 0° | | Zone | Lumens | % Fixture | pw | 50% | 30% | 10% | 50% | 30% | 10% | 50% | 30% | | | | 10% | Average Luminance | | |
| 0° | 724 | 0° - 30° | 387 | 51% | 0 | 119 | 119 | 119 | 116 | 116 | 116 | 111 | 111 | 111 | 6.0 | 20.1 | 6.0 | 0° | 51,231 | |
| 5° | 694 | 0° - 40° | 557 | 73% | 1 | 109 | 107 | 104 | 107 | 105 | 102 | 103 | 101 | 99 | 8.0 | 11.3 | 8.0 | 45° | 17,980 | |
| 15° | 529 | 0° - 60° | 750 | 99% | 2 | 100 | 95 | 91 | 98 | 94 | 90 | 95 | 91 | 88 | 10.0 | 7.2 | 10.0 | 55° | 7,393 | |
| 25° | 380 | 0° - 90° | 760 | 100% | 3 | 92 | 86 | 81 | 90 | 85 | 80 | 87 | 83 | 79 | 12.0 | 5.0 | 12.0 | 65° | 1,240 | |
| 35° | 272 | 90° - 180° | 0 | 0% | 4 | 84 | 78 | 73 | 83 | 77 | 72 | 81 | 75 | 71 | 14.0 | 3.7 | 14.0 | 75° | 191 | |
| 45° | 180 | 0° - 180° | 760 | 100% | 5 | 77 | 71 | 66 | 76 | 70 | 65 | 75 | 69 | 65 | Beam Angle: 53.1° Field Angle: 107.9° | | | 85° | 162 | |
| 55° | 60 | | | | 6 | 71 | 65 | 60 | 71 | 64 | 59 | 69 | 63 | 59 | | | | | | |
| 65° | 7 | | | | 7 | 66 | 59 | 54 | 66 | 59 | 54 | 64 | 58 | 54 | | | | | | |
| 75° | 1 | | | | 8 | 62 | 55 | 50 | 61 | 54 | 50 | 60 | 54 | 50 | | | | | | |
| 85° | 0 | | | | 9 | 57 | 51 | 46 | 57 | 50 | 46 | 56 | 50 | 46 | | | | | | |
| 90° | 0 | | | | 10 | 54 | 47 | 43 | 53 | 47 | 43 | 52 | 47 | 43 | | | | | | |

JPDZ6 DC 10LM 30K 90CRI HZWH, Input Watts: 13.7, Delivered Lumens: 1176, LPW: 85.8, S/MH: 0.74, Test No: 20-971-5

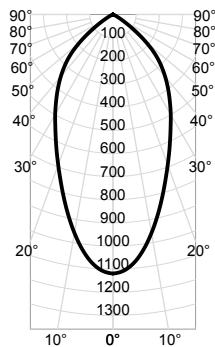

| CP Summary | Zonal Lumen Summary | | | | Coefficients of Utilization | | | | | | | | | | Cone of Light | | | Luminance (cd/sq.m) | | | |
|---------------|---------------------|------------|--------|-----------|-----------------------------|-----|-----|-----|-----|-----|-----|-----|-----|-----|--|--------------------|---------------------------------|------------------------|----------------------|--|--|
| | 0° | Zone | Lumens | % Fixture | pf | 80% | | | | | 20% | | | | | Mounting Height | Initial FC Center Beam | Beam Diameter | Average Luminance | | |
| | | | | | pc | 50% | 30% | 10% | 50% | 30% | 10% | 50% | 30% | 10% | | | | | | | |
| | | | | | | | | | | | | | | | | | | | | | |
| 0° | 1,119 | 0° - 30° | 598 | 51% | 0 | 119 | 119 | 119 | 116 | 116 | 116 | 111 | 111 | 111 | 6.0 | 31.1 | 6.0 | 0° | 79,243 | | |
| 5° | 1,074 | 0° - 40° | 861 | 73% | 1 | 109 | 107 | 104 | 107 | 105 | 102 | 103 | 101 | 99 | 8.0 | 17.5 | 7.9 | 45° | 27,841 | | |
| 15° | 820 | 0° - 60° | 1,160 | 99% | 2 | 100 | 95 | 91 | 98 | 94 | 90 | 95 | 91 | 88 | 10.0 | 11.2 | 9.9 | 55° | 11,490 | | |
| 25° | 585 | 0° - 90° | 1,176 | 100% | 3 | 92 | 86 | 81 | 90 | 85 | 80 | 87 | 83 | 79 | 12.0 | 7.8 | 11.9 | 65° | 1,926 | | |
| 35° | 422 | 90° - 180° | 0 | 0% | 4 | 84 | 78 | 73 | 83 | 77 | 72 | 81 | 75 | 71 | 14.0 | 5.7 | 13.9 | 75° | 301 | | |
| 45° | 278 | 0° - 180° | 1,176 | 100% | 5 | 77 | 71 | 65 | 76 | 70 | 65 | 74 | 69 | 65 | Beam Angle: 52.8° Field Angle: 107.9° | | | 85° | 244 | | |
| 55° | 93 | | | | 6 | 71 | 64 | 59 | 71 | 64 | 59 | 69 | 63 | 59 | | | | | | | |
| 65° | 12 | | | | 7 | 66 | 59 | 54 | 65 | 59 | 54 | 64 | 58 | 54 | | | | | | | |
| 75° | 1 | | | | 8 | 62 | 55 | 50 | 61 | 54 | 50 | 60 | 54 | 50 | | | | | | | |
| 85° | 0 | | | | 9 | 57 | 51 | 46 | 57 | 50 | 46 | 56 | 50 | 46 | | | | | | | |
| 90° | 0 | | | | 10 | 54 | 47 | 43 | 53 | 47 | 43 | 52 | 47 | 43 | | | | | | | |

JPDZ6 DC 12LM 30K 90CRI HZWH, Input Watts: 15.2, Delivered Lumens: 1267, LPW: 83.4, S/MH: 0.74, Test No: 20-971-6

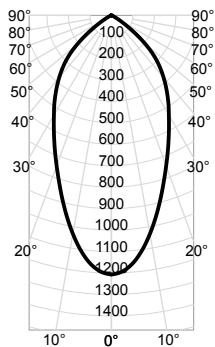

| CP Summary | | Zonal Lumen Summary | | | | Coefficients of Utilization | | | | | | | | | | Cone of Light | | | Luminance (cd/sq.m) | |
|------------|-------|---------------------|--------|-----------|--|-----------------------------|-----|-----|-----|-----|-----|-----|-----|-----|-----|--|-----------------|------------------------|---------------------|-------------------|
| | | | | | | pf | | | | | 20% | | | | | | Mounting Height | Initial FC Center Beam | Beam Diameter | Average Luminance |
| | | | | | | pc | 80% | | | | 70% | | 50% | | | | | | | |
| 0° | | Zone | Lumens | % Fixture | | pw | 50% | 30% | 10% | 50% | 30% | 10% | 50% | 30% | 10% | | | | | |
| 0° | 1,207 | 0° - 30° | 644 | 51% | | 0 | 119 | 119 | 119 | 116 | 116 | 116 | 111 | 111 | 111 | 6.0 | 33.5 | 6.0 | 0° | 85,437 |
| 5° | 1,158 | 0° - 40° | 928 | 73% | | 1 | 109 | 107 | 104 | 107 | 105 | 102 | 103 | 101 | 99 | 8.0 | 18.9 | 7.9 | 45° | 30,024 |
| 15° | 884 | 0° - 60° | 1,250 | 99% | | 2 | 100 | 95 | 91 | 98 | 94 | 90 | 95 | 91 | 88 | 10.0 | 12.1 | 9.9 | 55° | 12,391 |
| 25° | 631 | 0° - 90° | 1,267 | 100% | | 3 | 92 | 86 | 81 | 90 | 85 | 80 | 87 | 83 | 79 | 12.0 | 8.4 | 11.9 | 65° | 2,094 |
| 35° | 455 | 90° - 180° | 0 | 0% | | 4 | 84 | 78 | 73 | 83 | 77 | 72 | 81 | 75 | 71 | 14.0 | 6.2 | 13.9 | 75° | 301 |
| 45° | 300 | 0° - 180° | 1,267 | 100% | | 5 | 77 | 71 | 65 | 76 | 70 | 65 | 74 | 69 | 65 | | | | 85° | 244 |
| 55° | 100 | | | | | 6 | 71 | 64 | 59 | 71 | 64 | 59 | 69 | 63 | 59 | Beam Angle: 52.8° Field Angle: 107.9° | | | | |
| 65° | 13 | | | | | 7 | 66 | 59 | 54 | 65 | 59 | 54 | 64 | 58 | 54 | | | | | |
| 75° | 1 | | | | | 8 | 62 | 55 | 50 | 61 | 54 | 50 | 60 | 54 | 50 | | | | | |
| 85° | 0 | | | | | 9 | 57 | 51 | 46 | 57 | 50 | 46 | 56 | 50 | 46 | | | | | |
| 90° | 0 | | | | | 10 | 54 | 47 | 43 | 53 | 47 | 43 | 52 | 47 | 43 | | | | | |

6" LUMEN OUTPUT MULTIPLIERS

| CCT | DB WWH | DB BWH | DC WWH | DC CWH | DC WHZWH | DC HZWH |
|----------|--------|--------|--------|--------|----------|---------|
| 2700K | 1.01 | 0.82 | 1.04 | 1.04 | 0.97 | 1.01 |
| 3000K | 1.00 | 0.81 | 1.03 | 1.03 | 0.96 | 1.00 |
| 3500K | 1.00 | 0.82 | 1.03 | 1.03 | 0.96 | 1.00 |
| 4000K | 1.00 | 0.82 | 1.03 | 1.03 | 0.96 | 1.00 |
| 5000K | 0.98 | 0.80 | 1.01 | 1.01 | 0.94 | 0.98 |
| Warm Dim | 0.92 | 0.75 | 0.95 | 0.94 | 0.88 | 0.92 |