



## Smart Wafer Downlight

4" and 6" LED Tunable White  
Adjustable Smart Wafer Downlight

### WF4C/WF6C ADJ Series



### Dimensions

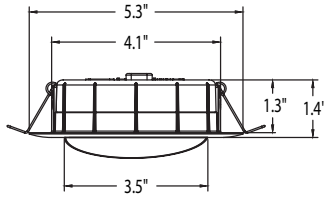

WF4C ADJ

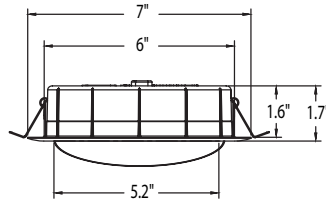

WF6C ADJ

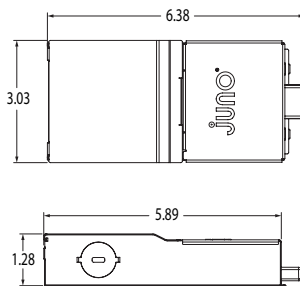

Project:
Fixture Type:
Location:
Contact/Phone:

### Product Features

The Smart Adjustable Wafer with Tunable White CCT's is the perfect way to get connected with a Smart Home Lighting solution. Once commissioned, it can be controlled through an app or voice commands.

Connect the Smart Adjustable Wafer directly to any Apple or Android phone using Bluetooth or Zigbee. Commission through the SmartThings app or Alexa and Google voice assistant apps.

Once installed, controlling the lighting from your mobile device is simple and easy to customize lighting from on/off, fine-tuning the color temperatures (2700K to 5000K), dimming to set the mood, and grouping to control an entire lighting application at once.

Easy installation and servicing

- Adjustable lens provides 110° directional beam, 20° tilt, and 180° rotation for accent lighting
- Canless - no can required; equals easy to install and less labor
- Installs into wood joists with new construction pan

### Applications

- Residential and commercial applications including multi-family, hospitality, assisted living, dormitories and other multi-level construction
- Shallow plenum, new construction
- IC rated - for direct contact with insulation

### Performance

Delivered Lumens	WF4C ADJ = 785L Nominal at 3000K WF6C ADJ = 1175L Nominal at 3000K
LED Color Temperature	Tunable White (2700K to 5000K)
CRI	90+
Voltage	Dedicated 120V
Dimming	Dimmable to 1% <i>Not for use with Wall Dimmers</i>

### Specifications

	WF4C ADJ	WF6C ADJ
Aperture:	3.5"	5.2"
Ceiling Opening:	4.25"	6.25"
Overlap Trim:	5.3"	7"
Height:	1.4"	1.7"

### ORDERING INFORMATION

#### Downlight

Example: WF4C ADJ TUWH MW

Series	Trim Style	Color Temperature	Finish
WF4C 4" Smart Adjustable Downlight	ADJ Round Adjustable	TUWH Tunable White (2700K-5000K)	MW Matte White
WF6C 6" Smart Adjustable Downlight			



# Smart Wafer Downlight

## 4" and 6" LED Tunable White Adjustable Smart Wafer Downlight



Accessories: Order as separate catalog number.

Series	
<b>WF8643 PAN R6</b>	Universal New Construction Pan, Retail Pack of 6
<b>WF8643 PAN U</b>	Universal New Construction Pan, Unit Pack
<b>WF4 PAN R12</b>	4" new construction pan, retail pack of 12
<b>WF6 PAN R12</b>	6" new construction pan, retail pack of 12
<b>WF4GR MW JZ</b>	4" round oversized trim ring
<b>WF6GR MW JZ</b>	6" round oversized trim ring
<b>WFJB U</b>	Remodel Joist Bar
<b>WFEXC6 SW3PIN FT4</b>	3-Pin 6ft Cable
<b>WFEXC10 SW3PIN FT4</b>	3-Pin 10ft Cable
<b>WFEXC20 SW3PIN FT4</b>	3-Pin 20ft Cable



WF8643 UNIVERSAL  
New Construction Pan



WF4 PAN  
4" New Construction Pan



WF6 PAN  
6" New Construction Pan



Remodel Joist Bar



WFEXCx  
3-Pin Extension Cable

### PERFORMANCE DATA

	WF4C ADJ	WF6C ADJ
Input Voltage	120V	120V
Input Power Typical	10.8W (+/-5%)	14.0W (+/-5%)
Frequency	50/60 Hz	50/60 Hz
EMI/RFI	FCC Title 47, Part 15 Class B (consumer)	FCC Title 47, Part 15 Class B (consumer)
Minimum Starting Temp	-25°C	-25°C
CRI	90 min.	90 min.
CCT	2700K-5000K	2700K-5000K

**Note:** Actual performance may differ as a result of end-user environment and application. All values are design or typical values, measured under laboratory conditions at 25°C.

#### LIGHTING PERFORMANCE DATA DONNÉES SUR LE RENDEMENT DE L'ÉCLAIRAGE

Light Appearance (CCT)  
Aspect de la lumière (CCT)

**2700K** soft white | blanc doux

770 lumens | 71 lumens per watt

**3000K** warm white | blanc chaud

785 lumens | 72 lumens per watt

**3500K** neutral white | blanc neutre

830 lumens | 73 lumens per watt

**4000K** cool white | blanc froid

840 lumens | 74 lumens per watt

**5000K** daylight | blanc neutre

825 lumens | 75 lumens per watt

Watts **10.8**

Color Accuracy (CRI) **90**

Précision des couleurs (CRI)

#### LIGHTING PERFORMANCE DATA DONNÉES SUR LE RENDEMENT DE L'ÉCLAIRAGE

Light Appearance (CCT)  
Aspect de la lumière (CCT)

**2700K** soft white | blanc doux

1085 lumens | 75 lumens per watt

**3000K** warm white | blanc chaud

1175 lumens | 84 lumens per watt

**3500K** neutral white | blanc neutre

1155 lumens | 83 lumens per watt

**4000K** cool white | blanc froid

1170 lumens | 84 lumens per watt

**5000K** daylight | blanc neutre

1170 lumens | 84 lumens per watt

Watts **14**

Color Accuracy (CRI) **90**

Précision des couleurs (CRI)



# Smart Wafer Downlight

## 4" and 6" LED Tunable White

### Adjustable Smart Wafer Downlight



## Specifications

### Housing

Aluminum die cast outer frame, durable, powder coat paint to prevent rust

- Polycarbonate lens provides even illumination throughout the space lens can be tilt up to 20 degrees and can be rotated up to 180 degrees
- FT4 3-pin plenum rated cable connector to connect from module to remote driver box
- Steel spring clip for easy installation. 4" or 6" cut out template is provided to ensure a correct sized hole is cut into ceiling for proper installation of the trim. Size of hole should not exceed 4 1/4 inches (WF4C) or 6 1/4 inches (WF6C) for this product
- Can be installed from 3/8" to 1 1/2" ceiling thickness
- Can be removed from below the ceiling for service or replacement.

### LED Light Engine

LEDs are integrated to one piece high purity aluminum, thermally conductive housing to provide uninterrupted heat transfer to ensure long life of the LED

- Tunable color temperature from 2700K to 5000K
- 90 CRI minimum
- Dimmable to 1%. Not for use with Wall Dimmers.

### Driver

Dedicated 120 volt replaceable driver

- Accommodates 120 volts AC at 50/60Hz
- Isolated driver integrated inside steel remote box with four 7/8" knockouts with slots for pryout
- Suitable for pulling wires with the 12 cubic-inch wiring compartment to accommodate up to (6) 14 gauge insulated conductor or (4) 12 gauge insulated conductors, making the Regressed Wafer much easier to wire in 2in/2out (plus ground) daisy-chain applications and contractor friendly
- Designed to provide 50,000 hours of life
- 3-year warranty on LED components.

### Optical System

Computer-optimized reflector design with high reflectance white finish coupled with a high transmission diffusing lens conceals the LEDs

- Efficient system that can produce over 785 lumens while using 10.8W (WF4C) or 1175 lumens while using 14.0W (WF6C)
- Replaces 65W or 75W incandescent.

### Life

Rated for 50,000 hours at 70% lumen maintenance.

### Labels

CSA certified to US and Canadian safety standards

- ENERGY STAR® certified product
- Suitable for wet location
- Air-Loc certified in accordance with ASTM E283-2004
- NOM Certified
- Can be used to comply with California Title 24 Part 6 High Efficacy LED light Source Requirements.

### Testing

All reports are based on published industry procedures; field performance may differ from laboratory performance.

**Warranty** 3-year warranty. This is the only warranty provided and no other statements in this specification sheet create any warranty of any kind. All other express and implied warranties are disclaimed. Complete warranty terms located at: [www.acuitybrands.com/support/warranty/terms-and-conditions](http://www.acuitybrands.com/support/warranty/terms-and-conditions)

**Note:** Actual performance may differ as a result of end-user environment and application.

All values are design or typical values, measured under laboratory conditions at 25 °C.

Specifications subject to change without notice.

## Smart Wafer Downlight

4" and 6" LED Tunable White  
Adjustable Smart Wafer Downlight



## PHOTOMETRICS

### Distribution Curve

### Distribution Data

### Output Data

### Coefficient of Utilization

### Illuminance Data at 30" Above Floor for a Single Luminaire

**WF4C ADJ TUWH MW\_27K** Input Watts: 10.8, Delivered Lumens: 771, LPW: 71.4, S/MH: 1.21, Test No: 80098010-003P1

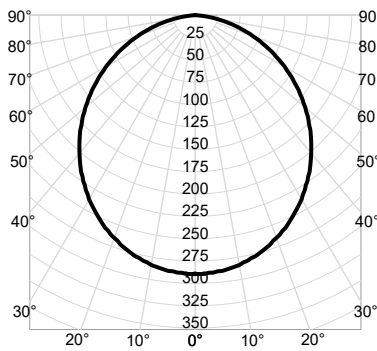

CP Summary	Zonal Lumen Summary				Coefficients of Utilization										Cone of Light			Luminance (cd/sq.m)		
	0°	Zone	Lumens	% Fixture	pf	80%				20%				Mounting Height	Initial FC Center Beam	Beam Diameter	Average Luminance			
					pc															
					pw	50%	30%	10%	50%	30%	10%	50%	30%					10%		
0°	290	0° - 30°	221	29%	0	119	119	119	116	116	116	111	111	111	6.0	8.0	16.2	0°	47,195	
5°	288	0° - 40°	359	47%	1	105	100	97	102	99	95	98	95	92	8.0	4.5	21.6	45°	41,940	
15°	276	0° - 60°	622	81%	2	91	85	79	90	83	78	86	81	76	10.0	2.9	27.0	55°	39,195	
25°	252	0° - 90°	771	100%	3	80	72	66	79	71	65	76	70	64	12.0	2.0	32.4	65°	35,463	
35°	220	90° - 180°	0	0%	4	71	63	56	70	62	56	68	61	55	14.0	1.5	37.8	75°	28,954	
45°	182	0° - 180°	771	100%	5	64	55	48	63	54	48	61	53	48	Beam Angle: 107.0° Field Angle: 157.8°				85°	9,147
55°	138				6	58	49	42	57	48	42	55	47	42						
65°	92				7	52	44	37	51	43	37	50	42	37						
75°	46				8	48	39	33	47	39	33	46	38	33						
85°	5				9	44	36	30	43	35	30	42	35	30						
90°	0				10	40	33	27	40	32	27	39	32	27						

**WF4C ADJ TUWH MW\_30K** Input Watts: 10.8, Delivered Lumens: 788, LPW: 73.0, S/MH: 1.21, Test No: 80098010-003P2

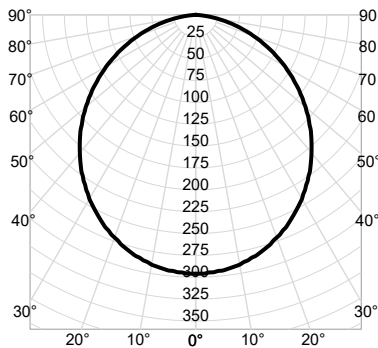

CP Summary		Zonal Lumen Summary				Coefficients of Utilization										Cone of Light			Luminance (cd/sq.m)	
						pf					20%						Mounting Height	Initial FC Center Beam	Beam Diameter	Average Luminance
						pc	80%		70%		50%									
	0°	Zone	Lumens	% Fixture		pw	50%	30%	10%	50%	30%	10%	50%	30%	10%					
0°	296	0° - 30°	226	29%		0	119	119	119	116	116	116	111	111	111	6.0	8.2	16.2	0° 48,237	
5°	294	0° - 40°	367	47%		1	105	100	97	102	99	95	98	95	92	8.0	4.6	21.6	45° 42,866	
15°	282	0° - 60°	636	81%		2	91	85	79	90	83	78	86	81	76	10.0	3.0	27.0	55° 40,060	
25°	258	0° - 90°	788	100%		3	80	72	66	79	71	65	76	70	64	12.0	2.1	32.4	65° 36,246	
35°	225	90° - 180°	0	0%		4	71	63	56	70	62	56	68	61	55	14.0	1.5	37.8	75° 29,593	
45°	186	0° - 180°	788	100%		5	64	55	48	63	54	48	61	53	48				85° 9,349	
55°	141					6	58	49	42	57	48	42	55	47	42	Beam Angle: 107.0° Field Angle: 157.8°				
65°	94					7	52	44	37	51	43	37	50	42	37					
75°	47					8	48	39	33	47	39	33	46	38	33					
85°	5					9	44	36	30	43	35	30	42	35	30					
90°	0					10	40	33	27	40	32	27	39	32	27					

**WF4C ADJ TUWH MW\_35K** Input Watts: 10.7, Delivered Lumens: 833, LPW: 77.9, S/MH: 1.21, Test No: 80098010-003P3

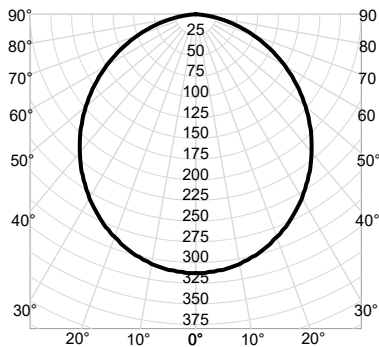

CP Summary	Zonal Lumen Summary				Coefficients of Utilization										Cone of Light			Luminance (cd/sq.m)		
	0°	Zone	Lumens	% Fixture	pf	80%				20%				Mounting Height	Initial FC Center Beam	Beam Diameter	Average Luminance			
					pc															
					50%	30%	10%	50%	30%	10%	50%	30%	10%							
0°	313	0° - 30°	239	29%	0	119	119	119	116	116	116	111	111	111	6.0	8.7	16.2	0°	50,995	
5°	311	0° - 40°	388	47%	1	105	100	97	102	99	95	98	95	92	8.0	4.9	21.6	45°	45,317	
15°	298	0° - 60°	673	81%	2	91	85	79	90	83	78	86	81	76	10.0	3.1	27.0	55°	42,351	
25°	273	0° - 90°	833	100%	3	80	72	66	79	71	65	76	70	64	12.0	2.2	32.4	65°	38,319	
35°	238	90° - 180°	0	0%	4	71	63	56	70	62	56	68	61	55	14.0	1.6	37.8	75°	31,285	
45°	197	0° - 180°	833	100%	5	64	55	48	63	54	48	61	53	48	Beam Angle: 107.0° Field Angle: 157.8°				85°	9,883
55°	149				6	58	49	42	57	48	42	55	47	42						
65°	99				7	52	44	37	51	43	37	50	42	37						
75°	50				8	48	39	33	47	39	33	46	38	33						
85°	5				9	44	36	30	43	35	30	42	35	30						
90°	0				10	40	33	27	40	32	27	39	32	27						



# Smart Wafer Downlight

## 4" and 6" LED Tunable White

### Adjustable Smart Wafer Downlight



## PHOTOMETRICS

### Distribution Curve

### Distribution Data

### Output Data

### Coefficient of Utilization

### Illuminance Data at 30" Above Floor for a Single Luminaire

WF4C ADJ TUWH MW\_40K Input Watts: 10.7, Delivered Lumens: 843, LPW: 78.8, S/MH: 1.21, Test No: 80098010-003P4

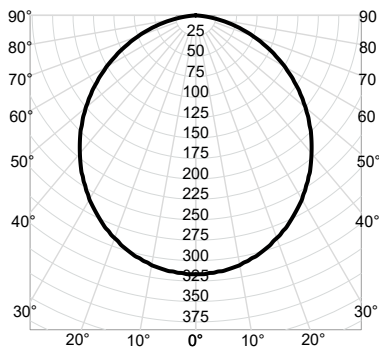

CP Summary		Zonal Lumen Summary				Coefficients of Utilization												Cone of Light			Luminance (cd/sq.m)	
						pf					20%				50%				Mounting Height	Initial FC Center Beam	Beam Diameter	Average Luminance
0°		Zone	Lumens	% Fixture	pw	50%	30%	10%	50%	30%	10%	50%	30%	10%	50%	30%	10%					
0°	317	0° - 30°	242	29%	0	119	119	119	116	116	116	111	111	111	111	6.0	8.8	16.2	0°	51,608		
5°	315	0° - 40°	393	47%	1	105	100	97	102	99	95	98	95	92	92	8.0	4.9	21.6	45°	45,862		
15°	302	0° - 60°	681	81%	2	91	85	79	90	83	78	86	81	76	76	10.0	3.2	27.0	55°	42,860		
25°	276	0° - 90°	843	100%	3	80	72	66	79	71	65	76	70	64	64	12.0	2.2	32.4	65°	38,779		
35°	241	90° - 180°	0	0%	4	71	63	56	70	62	56	68	61	55	55	14.0	1.6	37.8	75°	31,661		
45°	199	0° - 180°	843	100%	5	64	55	48	63	54	48	61	53	48	48	Beam Angle: 107.0° Field Angle: 157.8°			85°	10,002		
55°	151				6	58	49	42	57	48	42	55	47	42								
65°	101				7	52	44	37	51	43	37	50	42	37								
75°	50				8	48	39	33	47	39	33	46	38	33								
85°	5				9	44	36	30	43	35	30	42	35	30								
90°	0				10	40	33	27	40	32	27	39	32	27								

Beam Angle: 107.0°  
Field Angle: 157.8°

WF4C ADJ TUWH MW\_50K Input Watts: 10.9, Delivered Lumens: 825, LPW: 75.7, S/MH: 1.21, Test No: 80098010-003P5

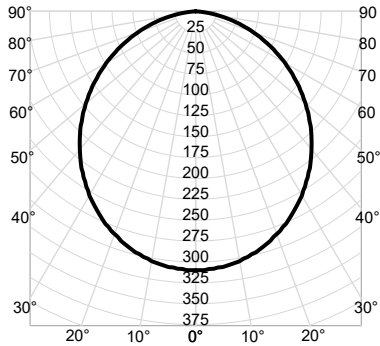

CP Summary		Zonal Lumen Summary				Coefficients of Utilization												Cone of Light			Luminance (cd/sq.m)	
						pf	80%			70%			50%			Mounting Height	Initial FC Center Beam	Beam Diameter	Average Luminance			
0°		Zone	Lumens	% Fixture	pw	50%	30%	10%	50%	30%	10%	50%	30%	10%								
0°	310	0° - 30°	237	29%	0	119	119	119	116	116	116	111	111	111	6.0	8.6	16.2	0°	50,504			
5°	308	0° - 40°	384	47%	1	105	100	97	102	99	95	98	95	92	8.0	4.8	21.6	45°	44,881			
15°	295	0° - 60°	666	81%	2	91	85	79	90	83	78	86	81	76	10.0	3.1	27.0	55°	41,943			
25°	270	0° - 90°	825	100%	3	80	72	66	79	71	65	76	70	64	12.0	2.2	32.4	65°	37,950			
35°	236	90° - 180°	0	0%	4	71	63	56	70	62	56	68	61	55	14.0	1.6	37.8	75°	30,984			
45°	195	0° - 180°	825	100%	5	64	55	48	63	54	48	61	53	48	Beam Angle: 107.0° Field Angle: 157.8°			85°	9,788			
55°	148				6	58	49	42	57	48	42	55	47	42								
65°	98				7	52	44	37	51	43	37	50	42	37								
75°	49				8	48	39	33	47	39	33	46	38	33								
85°	5				9	44	36	30	43	35	30	42	35	30								
90°	0				10	40	33	27	40	32	27	39	32	27								

Beam Angle: 107.0°  
Field Angle: 157.8°



# Smart Wafer Downlight

## 4" and 6" LED Tunable White

### Adjustable Smart Wafer Downlight



## PHOTOMETRICS

### Distribution Curve

### Distribution Data

### Output Data

### Coefficient of Utilization

### Illuminance Data at 30" Above Floor for a Single Luminaire

**WF6C ADJ TUWH MW\_27K** Input Watts: 13.8, Delivered Lumens: 1055, LPW: 76.4, S/MH: 1.21, Test No: 80098010-004P1

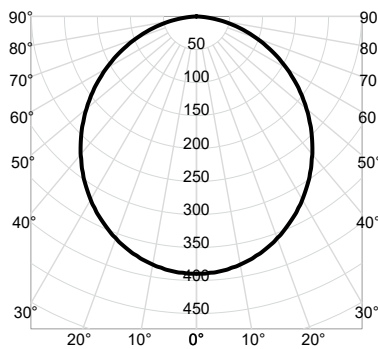

CP Summary		Zonal Lumen Summary				Coefficients of Utilization										Cone of Light			Luminance (cd/sq.m)			
						pf					20%						Mounting Height	Initial FC Center Beam	Beam Diameter			
						pc	80%				70%		50%							Average Luminance		
0°	Zone	Lumens	% Fixture			pw	50%	30%	10%	50%	30%	10%	50%	30%	10%							
0°	390	0° - 30°	298	28%		0	119	119	119	116	116	116	111	111	111		6.0	10.8	16.4	0°	28,883	
5°	388	0° - 40°	485	46%		1	104	100	96	102	98	95	98	95	92		8.0	6.1	21.9	45°	25,788	
15°	372	0° - 60°	842	80%		2	91	84	79	89	83	78	86	80	76		10.0	3.9	27.4	55°	24,366	
25°	340	0° - 90°	1,055	100%		3	80	72	65	78	71	65	75	69	64		12.0	2.7	32.9	65°	22,361	
35°	298	90° - 180°	0	0%		4	71	62	56	70	61	55	67	60	54		14.0	2.0	38.3	75°	19,285	
45°	246	0° - 180°	1,055	100%		5	63	54	48	62	54	48	60	53	47					85°	10,690	
55°	189					6	57	48	42	56	48	42	54	47	41		Beam Angle: 107.7°					
65°	127					7	52	43	37	51	43	37	49	42	37		Field Angle: 160.2°					
75°	67					8	47	39	33	47	39	33	45	38	33							
85°	13					9	43	35	30	43	35	30	42	35	30							
90°	0					10	40	32	27	40	32	27	39	32	27							

Beam Angle: 107.7°  
Field Angle: 160.2°

**WF6C ADJ TUWH MW\_30K** Input Watts: 13.9, Delivered Lumens: 1175, LPW: 84.5, S/MH: 1.21, Test No: 80098010-004P2

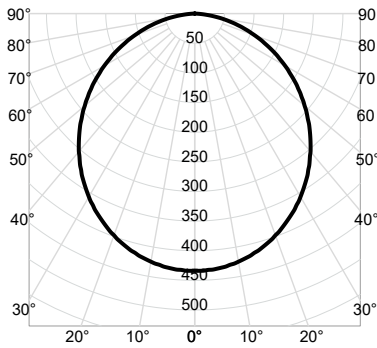

CP Summary		Zonal Lumen Summary				Coefficients of Utilization										Cone of Light			Luminance (cd/sq.m)		
						pf					20%						Mounting Height	Initial FC Center Beam	Beam Diameter		
						pc	80%				70%		50%							Average Luminance	
0°		Zone	Lumens	% Fixture	pw	50%	30%	10%	50%	30%	10%	50%	30%	10%							
0°	434	0° - 30°	332	28%	0	119	119	119	116	116	116	111	111	111	6.0	12.1	16.4	0°	32,169		
5°	432	0° - 40°	540	46%	1	104	100	96	102	98	95	98	95	92	8.0	6.8	21.9	45°	28,722		
15°	414	0° - 60°	938	80%	2	91	84	79	89	83	78	86	80	76	10.0	4.3	27.4	55°	27,138		
25°	379	0° - 90°	1,175	100%	3	80	72	65	78	71	65	75	69	64	12.0	3.0	32.9	65°	24,905		
35°	332	90° - 180°	0	0%	4	71	62	56	70	61	55	67	60	54	14.0	2.2	38.3	75°	21,479		
45°	274	0° - 180°	1,175	100%	5	63	54	48	62	54	48	60	53	47	Beam Angle: 107.7° Field Angle: 160.2°			85°	11,906		
55°	210				6	57	48	42	56	48	42	54	47	41							
65°	142				7	52	43	37	51	43	37	49	42	37							
75°	75				8	47	39	33	47	39	33	45	38	33							
85°	14				9	43	35	30	43	35	30	42	35	30							
90°	0				10	40	32	27	40	32	27	39	32	27							

Beam Angle: 107.7°  
Field Angle: 160.2°

**WF6C ADJ TUWH MW\_35K** Input Watts: 13.8, Delivered Lumens: 1155, LPW: 83.7, S/MH: 1.21, Test No: 80098010-004P3

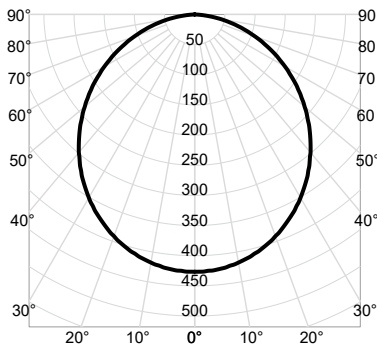

CP Summary		Zonal Lumen Summary				Coefficients of Utilization										Cone of Light			Luminance (cd/sq.m)			
						pf					20%						Mounting Height	Initial FC Center Beam	Beam Diameter	Average Luminance		
						pc	80%				70%		50%									
0°		Zone	Lumens	% Fixture		pw	50%	30%	10%	50%	30%	10%	50%	30%	10%							
0°	427	0° - 30°	327	28%		0	119	119	119	116	116	116	111	111	111	6.0	11.9	16.4	0°	31,621		
5°	425	0° - 40°	531	46%		1	104	100	96	102	98	95	98	95	92	8.0	6.7	21.9	45°	28,233		
15°	407	0° - 60°	922	80%		2	91	84	79	89	83	78	86	80	76	10.0	4.3	27.4	55°	26,676		
25°	373	0° - 90°	1,155	100%		3	80	72	65	78	71	65	75	69	64	12.0	3.0	32.9	65°	24,481		
35°	326	90° - 180°	0	0%		4	71	62	56	70	61	55	67	60	54	14.0	2.2	38.3	75°	21,113		
45°	269	0° - 180°	1,155	100%		5	63	54	48	62	54	48	60	53	47	Beam Angle: 107.7° Field Angle: 160.2°			85°	11,704		
55°	206					6	57	48	42	56	48	42	54	47	41							
65°	140					7	52	43	37	51	43	37	49	42	37							
75°	74					8	47	39	33	47	39	33	45	38	33							
85°	14					9	43	35	30	43	35	30	42	35	30							
90°	0					10	40	32	27	40	32	27	39	32	27							

Beam Angle: 107.7°  
Field Angle: 160.2°



# Smart Wafer Downlight

## 4" and 6" LED Tunable White

### Adjustable Smart Wafer Downlight



## PHOTOMETRICS

### Distribution Curve

### Distribution Data

### Output Data

### Coefficient of Utilization

### Illuminance Data at 30" Above Floor for a Single Luminaire

**WF6C ADJ TUWH MW\_40K** Input Watts: 14.0, Delivered Lumens: 1171, LPW: 83.6, S/MH: 1.21, Test No: 80098010-004P4

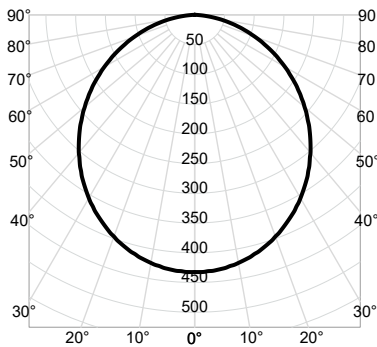

CP Summary		Zonal Lumen Summary				Coefficients of Utilization										Cone of Light			Luminance (cd/sq.m)	
						pf					20%						Mounting Height	Initial FC Center Beam	Beam Diameter	Average Luminance
						pc					70%		50%							
0°		Zone	Lumens	%	Fixture	pw	50%	30%	10%	50%	30%	10%	50%	30%	10%					
0°	433	0° - 30°	331	28%		0	119	119	119	116	116	116	111	111	111	6.0	12.0	16.4	0°	32,059
5°	431	0° - 40°	538	46%		1	104	100	96	102	98	95	98	95	92	8.0	6.8	21.9	45°	28,624
15°	413	0° - 60°	935	80%		2	91	84	79	89	83	78	86	80	76	10.0	4.3	27.4	55°	27,045
25°	378	0° - 90°	1,171	100%		3	80	72	65	78	71	65	75	69	64	12.0	3.0	32.9	65°	24,820
35°	331	90° - 180°	0	0%		4	71	62	56	70	61	55	67	60	54	14.0	2.2	38.3	75°	21,406
45°	273	0° - 180°	1,171	100%		5	63	54	48	62	54	48	60	53	47				85°	11,866
55°	209					6	57	48	42	56	48	42	54	47	41	Beam Angle: 107.7° Field Angle: 160.2°				
65°	142					7	52	43	37	51	43	37	49	42	37					
75°	75					8	47	39	33	47	39	33	45	38	33					
85°	14					9	43	35	30	43	35	30	42	35	30					
90°	0					10	40	32	27	40	32	27	39	32	27					