

DIGITAL NAVIGATION

[Ordering Tree](#) [nLight Platform](#) [Controls](#) [Dimensions](#) [Performance](#)

FEATURES & SPECIFICATIONS

INTENDED USE — Lithonia SIX has a nominal **6" wide housing with a 4" wide aperture, available in 2FT, 4FT, and 8FT discrete lengths**. LSIX provides performance, configurability, value and style. LSIX is the ideal choice for the majority of commercial applications where it aligns with modern design trends, easier to install, and is environmentally responsible. North American manufacturing allows for short lead-times. The slim profile of the luminaire, coupled with energy-saving LED technology make LSIX an ideal choice for renovation or new construction. The LSIX recessed linear lay-in offers a high-quality, cost-effective LED lighting solution for schools, offices, retail, healthcare facilities and other commercial spaces.

CONSTRUCTION — Built on a direct lit platform, the Lithonia SIX was designed for durability, depth and elegance. LSIX has a **nominal 6" wide housing with a 4" wide aperture, available in 2FT, 4FT and 8FT discrete lengths**. The beveled frame option features a **0.6" regress** to provide physical depth. LSIX has a low-profile design to provide increased installation flexibility in restricted plenum spaces. The **.66mm thick back-plate** includes integral T-bar clips for **installation into 9/16" and 15/16" T-grid ceilings** with no additional components. In a 9/16" T-grid ceiling, the bezel frame option allows the bottom of the luminaire to sit flush with tegular ceiling tiles. Antimicrobial paint finish available.

Integrated Sensor (nLight® Wired Networking): This sensor is nLight-enabled, meaning it has the ability to communicate over an nLight network. When wired, using CAT-5 cabling, with other nLight-enabled sensors, power packs, or WallPods, an nLight control zone is created. Once linked to a Gateway, directly or via a Bridge, the zone becomes capable of remote status monitoring and control via SensorView software.

Integrated Smart Sensor (nLight Air Wireless Platform): The RES7 sensor is nLight AIR enabled, meaning it has the ability to communicate over the wireless nLight control platform. It is available with an automatic dimming photocell, and either a digital PIR or a microphonics (PDT) dual technology occupancy sensor. It pairs to other luminaires and wall switches through our mobile app, CLAIRITY+, which allows for simple sensor adjustment

Integrated Wireless Sensor (single room control): Sensor Switch™ VERTEX JOT or JOTVIX15 luminaire-embedded occupancy and ambient light sensor allows the luminaire to power off when the space is unoccupied or when enough ambient light is entering the space. See page 7 for more details on the integrated wireless sensor.

INSTALLATION — With a **depth of only 2.1"**, LSIX makes for an easy installation, especially in restrictive plenum applications. LSIX fits into standard 15/16" and narrow 9/16" T-grid ceiling systems. Suitable for damp location.

ELECTRICAL — Long-life LED's, coupled with high-efficiency drivers provide superior quality of light and an extended service life. 80% LED lumen maintenance at 60,000 hours (L80/60,000). 0-10 volt dimming driver, dims to 1%.

LISTINGS — CSA certified to meet US and Canadian standards. Damp location listed. IC rated. **IP5X rated. Tested in accordance with ISO 14644-14; suitable for ISO Class 5 -9 positive and negative pressure clean rooms. Rated for NSF/ANSI Standard 2 – Light Fixture for Splash Zone and Non Food Zone.**

DesignLights Consortium® (DLC) qualified product. Not all versions of this product may be DLC qualified. Please check the DLC Qualified Products List at www.designlights.org/QPL to confirm which versions are qualified.

GOVERNMENT PROCUREMENT — BAA – Product with the BAA option qualifies as a domestic end product under the Buy American Act as implemented in the FAR and DFARS. Product with the BAA option also qualifies as manufactured in the United States under DOT Buy America regulations.

BABA – Build America Buy America: Product with the BAA option also qualifies as produced in the United States under the definitions of the Build America, Buy America Act. Please refer to www.acuitybrands.com/buy-american for additional information.

WARRANTY — 5-year limited warranty. This is the only warranty provided and no other statements in this specification sheet create any warranty of any kind. All other express and implied warranties are disclaimed. Complete warranty terms located at: www.acuitybrands.com/support/warranty/terms-and-conditions

Note: Actual performance may differ as a result of end-user environment and application. All values are design or typical values, measured under laboratory conditions at 25 °C. Specifications subject to change without notice

Catalog Number
Notes
Type



Lithonia® SIX
LSIX
2FT, 4FT, 8FT

Specifications	
Length:	23.82 (60.5), 47.80 (121.41), 95.81 (243.36)
Width:	5.81 (14.76)
Depth:	2.24 (5.69)
Weight:	2FT: 4lbs 4FT: 6.25 lbs 8FT: 11.7lbs

All dimensions are inches (centimeters)



Embed nLight controls today. Prepare for tomorrow.

Now	Tomorrow
User-friendly install	Scalability
Enhanced energy savings	Space configuration
Code compliance	Future-ready

 Items marked by a shaded background qualify for the Design Select program and ship in 15 days or less. To learn more about Design Select, visit www.acuitybrands.com/designselect. *See ordering tree for details

 **A+ Capable Luminaire**
This item is an A+ capable luminaire, which has been designed and tested to provide consistent color appearance and out-of-the-box control compatibility with simple commissioning when used with Acuity Brands controls products. All configurations of this luminaire are calibrated and tested to meet the Acuity Brands' specifications for chromatic consistency – including color rendering, color fidelity, and color temperature tolerance around standard CIE chromaticity coordinates. To learn more about Acuity A+ standards, specifications, and testing visit www.acuitybrands.com/aplus.

LSIX LED Luminaire



Design Select options indicated by this color background.

ORDERING INFORMATION

Lead times will vary depending on options selected.

Example: LSIX 4FT 4000LM 80CRI 40K FFR SWL MIN1 ZC MVOLT MW NLTAIR2

Series	Length	Lumens	CRI	Color Temperature	Frame Style	Optics	
LSIX Lithonia Six	2FT 2 Foot	1000LM 1,000 Lumens	80CRI 80 CRI	30K 3000K	FFR Extruded Flat Frame	SWL Satin White	
		1500LM 1,500 Lumens	90CRI 90 CRI	35K 3500K	BFR Bezel Frame		
		2000LM 2,000 Lumens		40K 4000K			
	4FT 4 Foot	2500LM 2,500 Lumens			50K 5000K		
		3000LM 3,000 Lumens					
		2000LM 2,000 Lumens					
	8FT 8 Foot	3000LM 3,000 Lumens					
		4000LM 4,000 Lumens					
		5000LM 5,000 Lumens					
6000LM 6,000 Lumens							
4000LM 4,000 Lumens							
		5000LM 5,000 Lumens					
		6000LM 6,000 Lumens					
		8000LM 8,000 Lumens					
		10000LM 10,000 Lumens ‡					

Minimum Dimming Level	Dimming ‡	Voltage	Emergency Option	Finish
MIN10 Dims to 10%	ZT Generic Driver 0-10V	MVOLT 120-277V	(blank) No emergency option	MW Matte White
MIN1 Dims to 1% ‡	EZT eldoLED® Driver 0-10V	347 347V ‡	E10WLCP EM Self-Diagnostic battery pack, 10W Constant Power, Certified in CA Title 20 MAEDBS ‡	MB Matte Black
	ZC Generic Driver compatible with Controls	120 120V	GTD Generator Transfer Device	DNA Natural Aluminum
	EZC eldoLED® Driver compatible with Controls	277 277V		WH Glossy White

NOTE: ‡ indicates option value has ordering restrictions. Please reference the Option Value Ordering Restrictions chart on the next page. Restriction notes are sorted in the sequence that they appear in the order tree.

Ordering continues on next page.

Controls			Options	
Control Input	Sensor			
(blank) No Control Input	(blank) No Sensor or Control Input function only, if selected.		GLR	Fast-blowing fuse ‡
SSE Sensor Switch Embedded	APIR Occ sensing with passive infrared - on/off functionality and auto dimming photocell APDT Occ sensor dual tech (passive infrared & microphonics) and auto dimming photocell VPIR8 Vertex low-profile on/off occupancy PIR occupancy sensor with VLP programming at 8ft mounting height ‡ VAPIR8 Vertex low-profile on/off occupancy sensor with auto dimming photocell with VLP programming at 8ft mounting height ‡ VPIR15 Vertex low-profile on/off occupancy PIR occupancy sensor with VLP programming at 15ft mounting height ‡ VAPIR15 Vertex low-profile on/off occupancy sensor with auto dimming photocell with VLP programming at 15ft mounting height ‡		GMF	Slow-blowing fuse ‡
NLIGHT nLight enabled NLIGHTER nLight enabled, for use with generator supply EM power NLIGHTLM nLight enabled with lumen management NLIGHTERLM nLight enabled with lumen management, for use with generator supply EM power	(blank) No sensor, Control Input function only PIR Occ sensing with passive infrared - on/off functionality PDT Occ sensor dual tech (passive infrared & microphonics) APIR Occ sensing with passive infrared - on/off functionality and auto dimming photocell APDT Occ sensor dual tech (passive infrared & microphonics) and auto dimming photocell VPIR8 Vertex low-profile on/off occupancy PIR occupancy sensor at 8ft mounting height ‡		PWS1836	6' pre-wire, 3/8" diameter, 18 gauge, 1 circuit
NLTAIR2 nLight AIR Generation 2 (wireless) enabled ‡ NLTAIREM2 nLight AIR Generation 2 (wireless) enabled and UL924 Emergency Operation, via power interrupt detection ‡	(blank) No sensor, Control Input function only APIR Occ sensing with passive infrared - on/off functionality and auto dimming photocell APDT Occ sensor dual tech (passive infrared & microphonics) and auto dimming photocell APIREM Occ sensing with passive infrared - on/off functionality and auto dimming photocell and UL924 Emergency Operation, via power interrupt detection APDTEM Occ sensor dual tech (passive infrared & microphonics) and auto dimming photocell and UL924 Emergency Operation, via power interrupt detection. VPIR8 Vertex low-profile on/off occupancy PIR occupancy sensor at 8ft mounting height ‡	Standby Mode	PWS1846	6' pre-wire, 3/8" diameter, 18 gauge, 2 circuit
JOT JOT, "Just One Touch" (wireless) enabled ‡	(blank) No sensor, Control Input function only VAPIR15 Vertex low-profile on/off occupancy sensor with auto dimming photocell at 15ft mounting height ‡	NOC Occupancy Sensor Disabled	PWS1846 PWSLV	Two cables: one 6' prewire, 3/8" diameter, 18 gauge, 2 circuits; one 6' pre-wire, 3/8" diameter, 18 gauge ‡
			PWS1856LV	6' pre-wire, 3/8" diameter, 18 gauge, 1 circuit w/low voltage wires ‡
			RRL_	RELOC®-ready luminaire
			DWAM	Anti-microbial paint
			BAA	Buy America(n) Act and/or Build America Buy America Qualified
			CP	Chicago plenum ‡
			NPLT	Narrow Pallet

NOTE: ‡ indicates option value has ordering restrictions. Please reference the Option Value Ordering Restrictions chart at the bottom of this page. Restriction notes are sorted in the sequence in which they appear on the order tree.

‡ Option Value Ordering Restrictions	
Option Value	Restriction
10000LM	Not available with JOT or with VPIR8, VAPIR8, VPIR15, VAPIR15.
MIN1	Required for all Control Input options, excluding JOT.
Dimming	ZC and EZC only available with Control Input option selections. ZT and EZT NOT available with Control Input options selections.
347	Not available with E10WLCP or GTD.
E10WLCP	Remote test switch if chosen with Sensor option group. If selecting a Prewire option, use PWS1846 or PWS1846 PWSLV.
NLTAIR2	See UL924 Sequence of Operation chart on page 4. Can be used as a normal power sensing device for nLight AIR devices and luminaires with EM emergency options. Not available with SMKSH Accessory.
NLTAIREM2	See UL924 Sequence of Operation Chart on page 4. Leave Sensor option group blank, not available with APIR, APDT, APIREM, APDTEM or VPIR8. Not available with SMKSH Accessory.
JOT	Only available with EZC.
VPIR8, VAPIR8, VPIR15, VAPIR15	Only available with EZC.
GLR, GMF	Must specify voltage, only available with 120 or 277.
PWS1846 PWSLV, PWS1856LV	Not available with any Control Input option.
CP	Not available with PWS1836, PWS1846, PWS1846 PWSLV or PWS1856LV.

Accessories are on next page.

Accessories

Accessories: Order as separate catalog number.	
DGA062	Drywall grid adapter for 6"x2FT recessed fixture
DGA064	Drywall grid adapter for 6"x4FT recessed fixture
DGA068	Drywall grid adapter for 6"x8FT recessed fixture
06x2SMKSHP PAF	6"X2' Surface Mount Troffer Kit ¹
06x4SMKSHP PAF	6"X4' Surface Mount Troffer Kit ¹
06x8SMKSHP PAF	6"X8' Surface Mount Troffer Kit ¹
RK8BDP 2P U	Disconnect Plug (BDP), 2 Pole, Package of 1
RK8BDP 3P U	Disconnect Plug (BDP), 3 Pole, Package of 1
RK8BDP 2P J10	Disconnect Plug (BDP), 2 Pole, Package of 10
RK8BDP 2P J40	Disconnect Plug (BDP), 2 Pole, Package of 40
DLTLATC J4	Earthquake Clip, 1 set of 4
DLTLATC J40	Earthquake Clip, 10 sets of 4
DLTLATC J80	Earthquake Clip, 20 sets of 4

Notes:

1. Cannot be installed with fixture with integrated NLTAIR2 Options.

Emergency Battery Estimated Lumens
Use the formula below to estimate the delivered lumens in emergency mode Estimated Lumens = 1.25 x P x LPW P = Output power of emergency driver (10W for E10WCP option.) LPW = Lumen per watt rating of the luminaire.

UL924 Sequence of Operation
The below information applies to all nLight AIR devices with an EM option. <ul style="list-style-type: none"> • EM devices will remain at their high-end trim and ignore wireless lighting control commands, unless a normal-power-sensed (NPS) broadcast is received at least every 8 seconds. • Using the CLAIRITY+ mobile app, EM devices must be associated with a group that includes a normal power sensing device to receive NPS broadcasts. • Only non-emergency rPP20, rLSXR, rSBOR, rSDGR, and nLight AIR luminaires with version 3.4 or later firmware can provide normal power sensing for EM devices. See specification sheets for control devices and luminaires for more information on options that support normal power sensing.

Emergency Battery Pack Options - Field Installable

Battery Model Number	Wattage	Runtime (Minutes)	Lumen Output* @ 120 Lumens/Watt	Other
ILB CP07 2H A	7W	120	840	Storm Shelter / 2 Hour Runtime
ILB CP10 A	10W	90	1200	
ILBLP CP10 HE SD A	10W	90	1200	Title 20, Self Diagnostic
ILBLP CP15 HE SD A	15W	90	1800	Title 20, Self Diagnostic
ILB CP20 HE A	20W	90	2400	Title 20
ILB CP20 HE SD A	20W	90	2400	Title 20, Self Diagnostic

All the above are UL Listed products that are certified for field install external/remote to the fixture.

*Minimum delivered lumen output to assist in product selection for increased fixture mounting height.

The CP10 delivered emergency illumination outperforms legacy 1400 lumen fluorescent emergency ballast.

Please contact us at techsupport@iotaengineering.com for any Emergency Battery related questions.

Bezel Frame Integrated into 9/16" Tegular Ceiling for Minimized Grid Appearance



Bezel Frame Integrated into 15/16" Ceiling

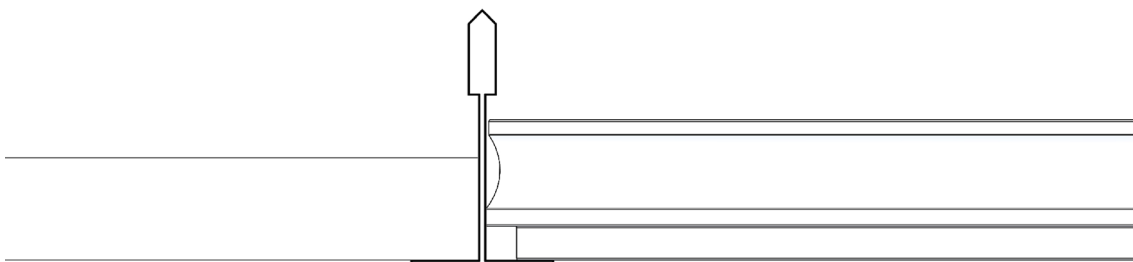

Intelligent Luminaire Technology Guide

Choose nomenclature from these columns

Control Input	Sensor	Sensor	Notes	Previous Nomenclature
SSE	+ APIR	= MSD 7 ADCX	Individual fixture control only. PIR integral occupancy sensor with automatic dimming control photocell.	MSD7ADCX
SSE	+ APDT	= MSD PDT 7 ADCX	Individual fixture control only. PDT integral occupancy sensor with automatic dimming control photocell.	MSDPDT7ADCX
SSE	+ VPIR8	= VERTEX 8F EZ OCC VLP	Vertex low-profile on/off occupancy PIR occupancy sensor with VLP programming at 8ft mounting height.	VTX8FOCC
SSE	+ VAPIR8	= VERTEX 8F EZ ADC VLP	Vertex low-profile on/off occupancy sensor with auto dimming photocell with VLP programming at 8ft mounting height.	VTX8FADC
SSE	+ VPIR15	= VERTEX 15F EZ OCC VLP	Vertex low-profile on/off occupancy PIR occupancy sensor with VLP programming at 15ft mounting height.	VTX15FOCC
SSE	+ VAPIR15	= VERTEX 15F EZ ADC VLP	Vertex low-profile on/off occupancy sensor with auto dimming photocell with VLP programming at 15ft mounting height.	VTX15FADC
JOT	+ (blank)	= BTRM JOT BTA	Wireless room control with "Just One Touch" pairing.	JOT
JOT	+ VAPIR15	= BTRM JOT BTA + VERTEX 15F EZ ADC VLP GSKT	Wireless room control with "Just One Touch" pairing.	JOTVTX15
NLIGHT	+ (blank)	= nIO EZ PH	nLight enabled only. No onboard sensor.	NLIGHT
NLIGHT	+ PIR	= nIO EZ PH + nES 7	nLight enabled with PIR integral occupancy sensor.	NLIGHT NES7
NLIGHT	+ PDT	= nIO EZ PH + nES PDT 7	nLight enabled with dual technology occupancy control sensor.	NLIGHT NESPDT7
NLIGHT	+ APIR	= nIO EZ PH + nES 7 ADCX	nLight enabled with PIR integral occupancy sensor with automatic dimming photocell.	NLIGHT NES7ADCX
NLIGHT	+ APDT	= nIO EZ PH + nES PDT 7 ADCX	nLight enabled with dual technology occupancy controls sensor with automatic dimming photocell.	NLIGHT NESPDT7ADCX
NLIGHT	+ VPIR8	= NIO EZ PH + VERTEX 8F EZ OCC VLP	nLight enabled with Vertex low-profile on/off occupancy PIR occupancy sensor at 8ft mounting height.	NLIGHT NVTX8FOCC
NLIGHTER	+ (blank)	= nIO EZ PH ER	Emergency nLight enabled only. No onboard sensor.	NLIGHT EMG
NLIGHTER	+ PIR	= nIO EZ PH ER + nES 7	Emergency nLight enabled with PIR integral occupancy sensor.	NLIGHT EMG NESPDT7
NLIGHTER	+ PDT	= nIO EZ PH ER + nES PDT 7	Emergency nLight enabled with dual technology occupancy control sensor.	NLIGHT EMG NES7ADC
NLIGHTER	+ APIR	= nIO EZ PH ER + nES 7 ADCX	Emergency nLight enabled with PIR integral occupancy sensor with automatic dimming photocell.	NLIGHT EMG NES7ADCX
NLIGHTER	+ APDT	= nIO EZ PH ER + nES PDT 7 ADCX	Emergency nLight enabled with dual technology occupancy controls sensor with automatic dimming photocell.	NLIGHT EMG NESPDT7ADCX
NLIGHTLM	+ (blank)	= nIO EZ PH N80	nLight enabled only with 80% constant lumen management. No onboard sensor.	NLIGHT CL80
NLIGHTLM	+ PIR	= nIO EZ PH N80 + nES 7	nLight enabled with 80% constant lumen management with PIR integral occupancy sensor.	NLIGHT CL80 NES7
NLIGHTLM	+ PDT	= nIO EZ PH N80 + nES PDT 7	nLight enabled with 80% constant lumen management with dual technology occupancy control sensor.	NLIGHT CL80 NESPDT7
NLIGHTLM	+ APIR	= nIO EZ PH N80 + nES 7 ADCX	nLight enabled with 80% constant lumen management with PIR integral occupancy sensor with automatic dimming photocell.	NLIGHT CL80 NES7ADCX
NLIGHTLM	+ APDT	= nIO EZ PH N80 + nES PDT 7 ADCX	nLight enabled with 80% constant lumen management with dual technology occupancy controls sensor with automatic dimming photocell.	NLIGHT CL80 NESPDT7ADCX
NLIGHTLMER	+ (blank)	= nIO EZ PH ER N80	Emergency nLight enabled only with 80% constant lumen management. No onboard sensor.	NLIGHT EMG CL80
NLIGHTLMER	+ PIR	= nIO EZ PH ER N80 + nES 7	Emergency nLight enabled with 80% constant lumen management with PIR integral occupancy sensor.	NLIGHT EMG CL80 NES7
NLIGHTLMER	+ PDT	= nIO EZ PH ER N80 + nES PDT 7	Emergency nLight enabled with 80% constant lumen management with dual technology occupancy control sensor.	NLIGHT EMG CL80 NESPDT7
NLIGHTLMER	+ APIR	= nIO EZ PH ER N80 + nES 7 ADCX	Emergency nLight enabled with 80% constant lumen management with PIR integral occupancy sensor with automatic dimming photocell.	NLIGHT EMG CL80 NES7ADCX
NLIGHTLMER	+ APDT	= nIO EZ PH ER N80 + nES PDT 7 ADCX	Emergency nLight enabled with 80% constant lumen management with dual technology occupancy controls sensor with automatic dimming photocell.	NLIGHT EMG CL80 NESPDT7ADCX
NLTAIR2	+ (blank)	= RIO EZ PH 180D G2	nLight AIR Generation 2 enabled.	NLTAIR2 RIO
NLTAIREM2	+ (blank)	= RIO EZ PH ER 180D G2	nLight AIR Generation 2 enabled	NLTAIR2 RIOEM
NLTAIR2	+ APIR	= RES7 G2	nLight AIR Generation 2 enabled.	NLTAIR2 RES7
NLTAIR2	+ APDT	= RES7 PDT 90D G2	nLight AIR Generation 2 enabled.	NLTAIR2 RES7PDT
NLTAIR2	+ APIREM	= RES7 EM 90D G2	nLight AIR Generation 2 enabled.	NLTAIR2 RES7EM
NLTAIR2	+ APDTEM	= RES7 PDT EM 90D G2	nLight AIR Generation 2 enabled.	NLTAIR2 RES7PDTEM
NLTAIR2	+ VPIR8	= RIO EZDL EXTDB ACWH 90D G2 + VERTEX 8F EZ OCC VLP	nLight AIR Generation 2 enabled. Vertex low-profile on/off occupancy PIR occupancy sensor at 8ft mounting height.	NLTAIR2 RVT8FOCC

Control / Sensor Configurations

nLight Platform

nLight AIR Wireless



Simple as 1,2,3

1. Install the nLight® AIR fixtures with embedded smart sensor
2. Install the wireless battery-powered wall switch
3. With the CLAIRITY+ Pro app, pair the fixtures with the wall switch and if desired, customize the sensor settings for the desired outcome



nLight Wired Networking

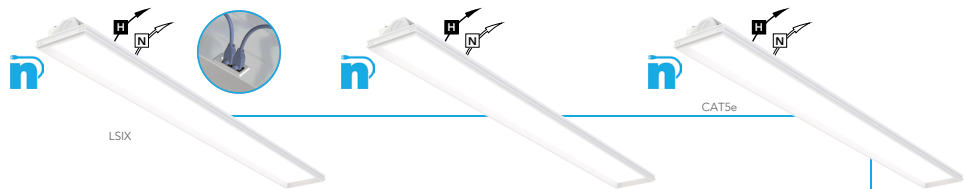

Simple as 1,2,3

1. Install the nLight® Wired fixtures with embedded control
2. Install the nLight Wired wall switch
3. Connect the fixtures using standard CAT5e cables and the devices will automatically discover each other and work (plug and play)



nLight embedded fixtures offer:	Customers get:
Manual Dimming	Convenience and visual comfort for occupants
Motion Sensing and/or Daylight Harvesting	Energy savings and code compliance
Fixture or Group Level Control	Ability to configure lighting to the space requirements
Flexibility	Ease of fixture moves, adds and changes
Wireless Wall Switch (nLight AIR Only)	Ease and flexibility of placement
Astronomical and Time of Day Scheduling	Energy savings and building security
Scalable Solution	nLight controls to grow with your business
Future-Ready	nLight platform to set foundation for future upgrades and capabilities

LSIX LED Luminaire

Controls Accessories

nLight® Wired Control Accessories:

Order as separate catalog number. Visit www.acuitybrands.com/products/controls/nlight.

WallPod stations	Model number	Occupancy sensors	Model number
On/Off	nPODMA [Color]	Small motion 360°, ceiling (PIR / dual tech)	nCM 9 RJB / nCM PDT 9 RJB
On/Off & raise/lower	nPODMA DX [Color]	Large motion 360°, ceiling (PIR / dual tech)	nCM10 RJB / nCM PDT 10 RJB
Graphic touchscreen	nPOD TOUCH [Color]	Wall switch with raise/lower	nWSX PDT LV DX [color]
Photocell controls	Model number	Cat-5 cable (plenum rated)	Model number
Full range dimming	nCM ADCX RJB	10' cable	CAT5 10FT J1
		30' cable	CAT5 30FT J1

nLight® AIR Control Accessories:

Order as separate catalog number. Visit www.acuitybrands.com/products/controls/nlightair.

Wall switches	Model number
On/Off single pole	rPODBA [color] G2
On/Off two pole	rPODB A2P [color] G2
On/Off & raise/lower single pole	rPODBA DX [color] G2
On/Off & raise/lower two pole	rPODBA 2P DX [color] G2



Sensor Switch
WSXA D



nLight WIRED
NPOD UNITOUCH



nLight WIRED
nPODMA DX



nLight AIR
rPODBA

Dimensions

LSIX

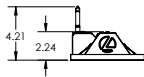

LSIX WITH E10WLCP OPTION

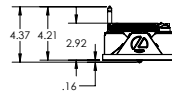

LSIX WITH MULTIPLE OPTIONS

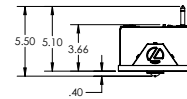

LSIX 2FT

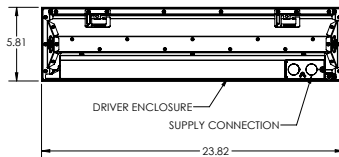

LSIX 2FT WITH E10WLCP

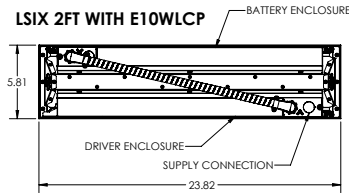

LSIX 2FT 347, GTD OR MULTIPLE OPTIONS

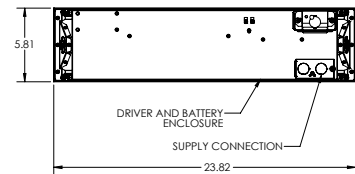

LSIX 4FT

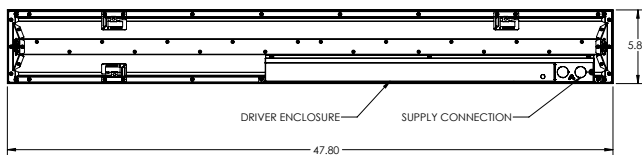

LSIX 4FT WITH E10WLCP

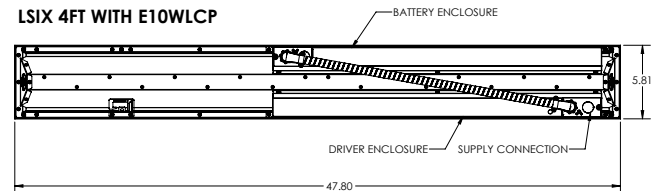

LSIX 4FT 347, GTD OR MULTIPLE OPTIONS

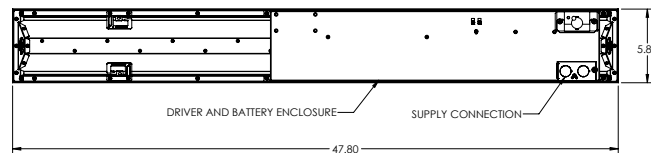

Dimensions

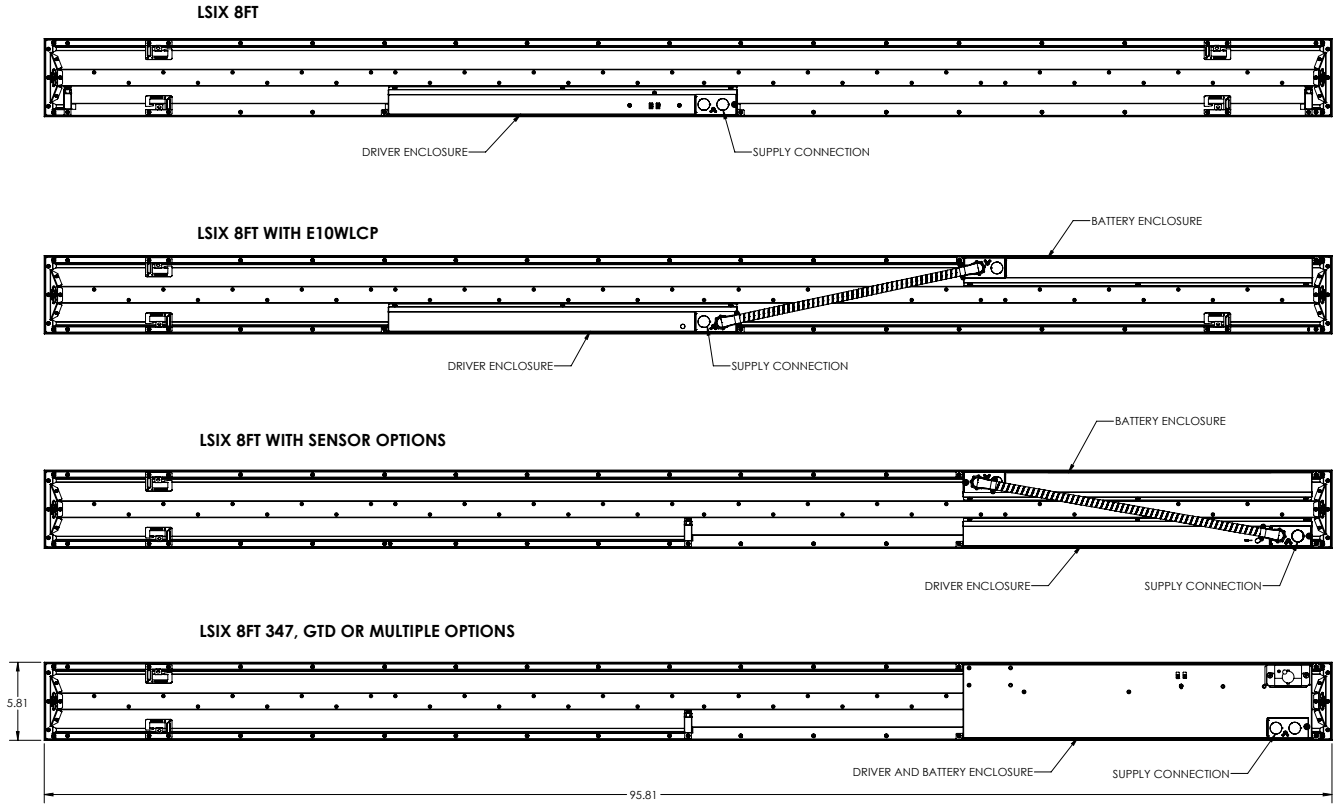

Performance Data

Length	CRI	CCT	Lumens	Actual		
				Lumens	Efficacy	Wattage
2ft	80CRI	30K	1000LM	997	118	8.4
			1500LM	1530	115	13.3
			2000LM	1920	113	17.0
			2500LM	2426	114	21.4
			3000LM	2921	110	26.5
2ft	80CRI	35K	1000LM	1028	122	8.4
			1500LM	1578	118	13.3
			2000LM	1981	117	17.0
			2500LM	2503	117	21.4
			3000LM	3013	114	26.5
2ft	80CRI	40K	1000LM	1082	128	8.4
			1500LM	1661	124	13.3
			2000LM	2084	123	17.0
			2500LM	2633	123	21.4
			3000LM	3170	120	26.5
2ft	80CRI	50K	1000LM	1082	128	8.4
			1500LM	1661	124	13.3
			2000LM	2084	123	17.0
			2500LM	2633	123	21.4
			3000LM	3170	120	26.5
2ft	90CRI	30K	1000LM	852	101	8.4
			1500LM	1308	98	13.3
			2000LM	1642	97	17.0
			2500LM	2075	97	21.4
			3000LM	2498	94	26.5
2ft	90CRI	35K	1000LM	879	104	8.4
			1500LM	1350	101	13.3
			2000LM	1694	100	17.0
			2500LM	2140	100	21.4
			3000LM	2576	97	26.5
2ft	90CRI	40K	1000LM	918	109	8.4
			1500LM	1409	106	13.3
			2000LM	1768	104	17.0
			2500LM	2234	105	21.4
			3000LM	2690	101	26.5
2ft	90CRI	50K	1000LM	927	110	8.4
			1500LM	1423	107	13.3
			2000LM	1785	105	17.0
			2500LM	2256	106	21.4
			3000LM	2716	102	26.5
4ft	80CRI	30K	2000LM	1986	119	16.7
			3000LM	2948	119	24.7
			4000LM	3940	118	33.3
			5000LM	4935	115	42.9
			6000LM	5862	115	51.1
4ft	80CRI	35K	2000LM	2048	123	16.7
			3000LM	3041	123	24.7
			4000LM	4064	122	33.3
			5000LM	5089	119	42.9
			6000LM	6046	118	51.1
4ft	80CRI	40K	2000LM	2155	129	16.7
			3000LM	3199	129	24.7
			4000LM	4276	128	33.3
			5000LM	5355	125	42.9
			6000LM	6362	124	51.1
4ft	80CRI	50K	2000LM	2155	129	16.7
			3000LM	3199	129	24.7
			4000LM	4276	128	33.3
			5000LM	5355	125	42.9
			6000LM	6362	124	51.1

Length	CRI	CCT	Lumens	Actual		
				Lumens	Efficacy	Wattage
4ft	90CRI	30K	2000LM	1698	102	16.7
			3000LM	2521	102	24.7
			4000LM	3369	101	33.3
			5000LM	4219	98	42.9
			6000LM	5012	98	51.1
4ft	90CRI	35K	2000LM	1751	105	16.7
			3000LM	2600	105	24.7
			4000LM	3475	104	33.3
			5000LM	4352	101	42.9
			6000LM	5170	101	51.1
4ft	90CRI	40K	2000LM	1829	109	16.7
			3000LM	2715	110	24.7
			4000LM	3628	109	33.3
			5000LM	4544	106	42.9
			6000LM	5398	106	51.1
4ft	90CRI	50K	2000LM	1846	111	16.7
			3000LM	2741	111	24.7
			4000LM	3663	110	33.3
			5000LM	4588	107	42.9
			6000LM	5450	107	51.1
8ft	80CRI	30K	4000LM	3877	130	29.8
			5000LM	4860	128	37.9
			6000LM	5692	129	44.3
			8000LM	7594	126	60.3
			10000LM	9595	120	80.2
8ft	80CRI	35K	4000LM	3999	134	29.8
			5000LM	5012	132	37.9
			6000LM	5870	133	44.3
			8000LM	7832	130	60.3
			10000LM	9897	123	80.2
8ft	80CRI	40K	4000LM	4208	141	29.8
			5000LM	5274	139	37.9
			6000LM	6177	140	44.3
			8000LM	8241	137	60.3
			10000LM	10413	130	80.2
8ft	80CRI	50K	4000LM	4208	141	29.8
			5000LM	5274	139	37.9
			6000LM	6177	140	44.3
			8000LM	8241	137	60.3
			10000LM	10413	130	80.2
8ft	90CRI	30K	4000LM	4208	141	29.8
			5000LM	5274	139	37.9
			6000LM	6177	140	44.3
			8000LM	8241	137	60.3
			10000LM	10413	130	80.2
8ft	90CRI	35K	4000LM	3419	115	29.8
			5000LM	4286	113	37.9
			6000LM	5020	113	44.3
			8000LM	6697	111	60.3
			10000LM	8462	105	80.2
8ft	90CRI	40K	4000LM	3570	120	29.8
			5000LM	4475	118	37.9
			6000LM	5241	118	44.3
			8000LM	6992	116	60.3
			10000LM	8835	110	80.2
8ft	90CRI	50K	4000LM	3605	121	29.8
			5000LM	4518	119	37.9
			6000LM	5292	120	44.3
			8000LM	7060	117	60.3
			10000LM	8921	111	80.2