

SIGNATURE SERIES EXITS INSTALLATION INSTRUCTIONS

MODELS LE AND LRE STANDARD AND EMERGENCY EXIT SIGNS

CAUTION: For safety and proper operation, read and follow instructions carefully before installation.

IMPORTANT

SAFEGUARDS

1. READ AND FOLLOW ALL

SAFETY INSTRUCTIONS

2. Before wiring to power supply, turn off electricity at fuse or circuit breaker.
3. Disconnect A.C. power and remove batteries before servicing.
4. All servicing should be performed by qualified personnel.
5. Consult your local building code for approved wiring and installation.
6. Do not use outdoors.
7. Do not mount near gas or electric heater.

8. Use caution when servicing batteries. Remove A.C. power before attempting to service battery.
9. Equipment should be mounted in locations and at heights where it will not readily be subjected to tampering by unauthorized personnel.
10. The use of accessory equipment not recommended by the manufacturer may cause an unsafe condition.
11. Do not use this equipment for other than intended use.
12. Fixture must be grounded to avoid potential electric shock.

SAVE THESE INSTRUCTIONS

LE Model Parts Description

- 1 Housing
- 2 Housing Front
- 3 Canopy
- 4 Canopy Mounting Plate
- 5 Sign Panel
- 6 Electronics Assembly
- 7 Threaded Nipple
- 8 Battery (Emergency Models only)
- 9 Battery Connector (Emergency Models only)
- 10 Hex Nut
- 11 Canopy Securing Screw
- 12 Star Washer
- 13 Green Ground Screw (not shown)
- 14 Cup Washer (not shown)
- 15 Electronics HV cover
- 16 Chevron Knockout
- 17 J-box (not provided)
- 18 WRS (FIDO) Radio Assembly (WRS models only)
- 19 Wire Management Clip (not shown)

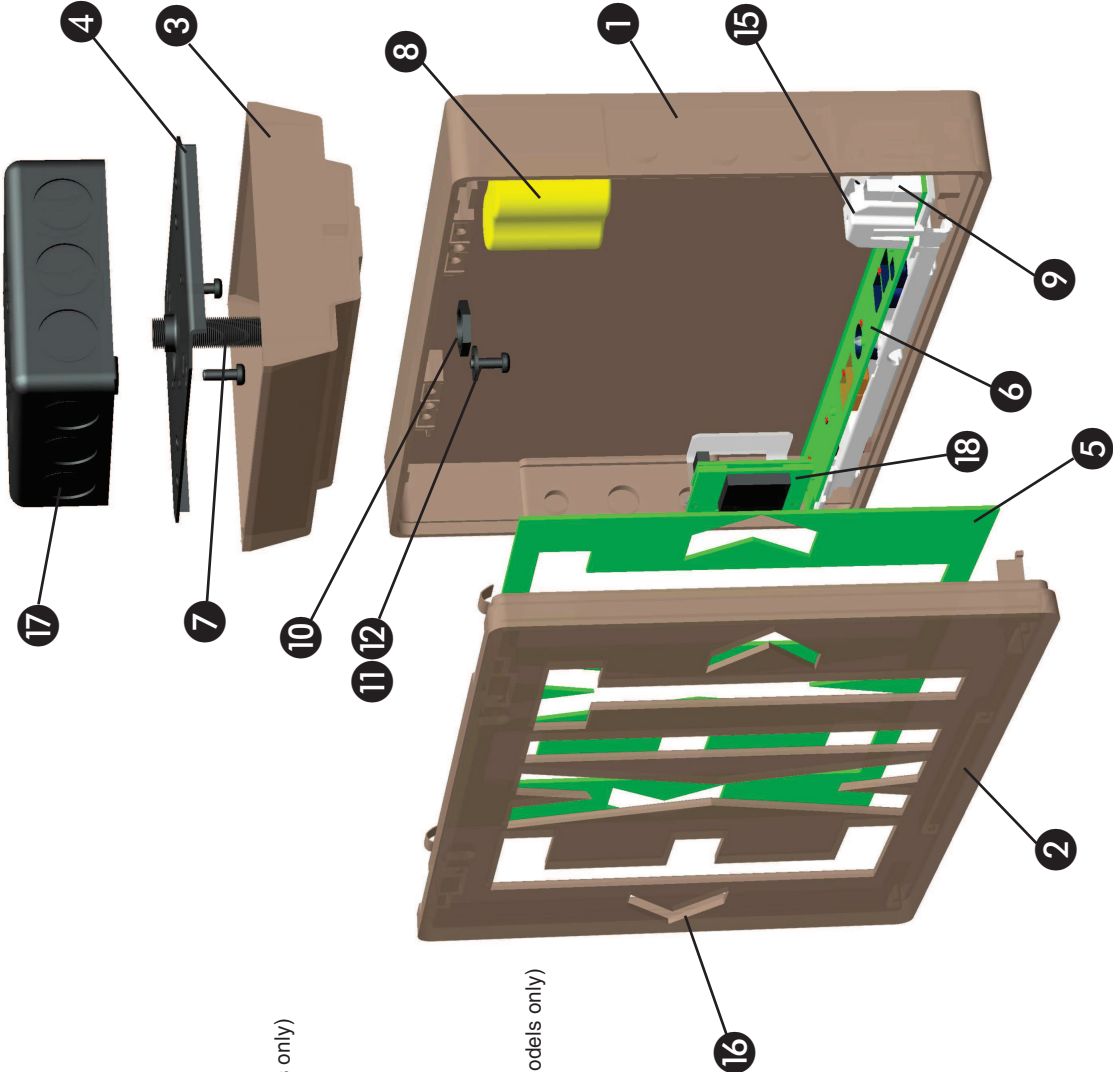

Figure A

LE Exit

Installation



**Step 1 - Top, Side, or Back mounting:** Remove sign panel to expose chevron knockouts. From the inside tap out desired knockout. Remove paper backing from tape and replace sign panel (white side facing inside).

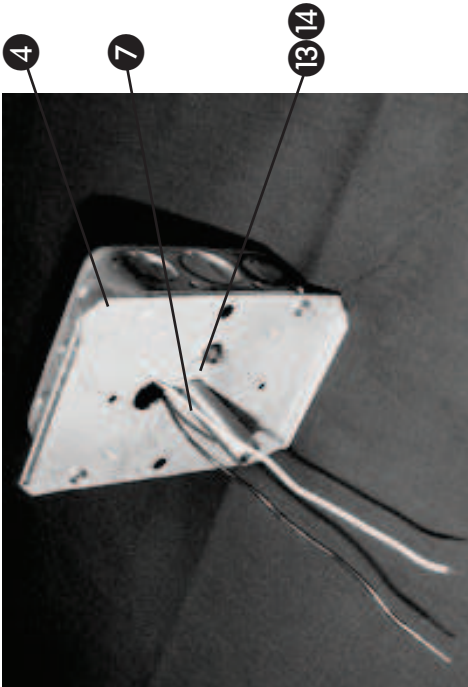

**Step 2 - Top or Side Canopy Mounting:** Select and remove appropriate knockouts on mounting plate for attachment to J-box. Screw threaded nipple through center threaded hole on mounting plate leaving approximately 2 1/8" exposed on outer surface. Using installation supply leads (provided) make connections to AC supply. Pull leads through wire passage hole and attach mounting plate to J-box using J-box screws (not provided). Attach ground wire to mounting plate using green ground screw and cup washer.

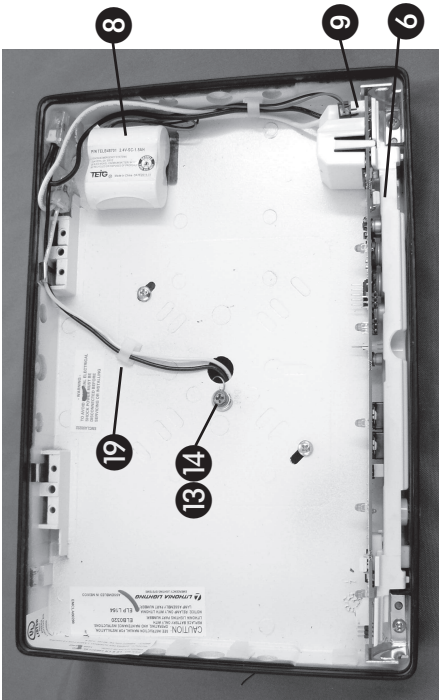

Step 3a - Back Mounting:

Make appropriate wiring connections to A.C. input using installation supply leads (provided). Remove appropriate knockouts from housing back for J-box mounting configuration. Remove center 9/16" knockout, pull through supply leads and ground wire. Secure housing to J-box using J-box screws (not provided). Connect A.C. supply leads to appropriate push -nut connectors (ref. Wiring Diagram, page 4). Wires should be dressed into housing using wire management clamp and adhesive wire management clips. Connect ground wire to housing using green ground screw and cup washer. Connect battery to battery connector located on electronics assembly.

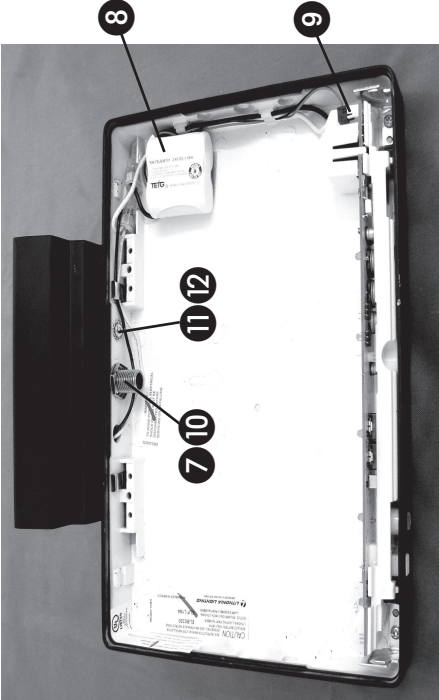

Step 3b - Top or Side Canopy Mounting:

Select location on housing for canopy mounting and remove knockouts. Attach canopy to housing using canopy mounting screw and star washer. Pull supply leads through wire passage hole and feed threaded nipple through center hole. Secure using lock washer and hex nut. Make supply lead connections to push-nut connectors. Wires should be dressed into housing using wire management clips. For emergency models, connect battery to battery connector on located on electronics assembly.

Caution: Please take care not to damage internal electronics or battery when removing the knock-outs for top or side canopy mounting.



LRES Model (Recessed Exit) Parts Description

- 1

Housing
- 2

Housing Front
- 3

Sign Panel
- 4

Trim Ring
- 5

Trim Ring Brackets
- 6

Electronics/Lamp Assembly
- 7

Electronics HV Cover
- 8

Test Switch/Indicator light assembly (Emergency Models Only)
- 9

Battery (Emergency Models only)
- 10

Trim Ring Bracket Screws
- 11

Green Ground Screw (not shown)
- 12

Cup Washer (not shown)
- 13

Wire retention clip (not shown)
- 14

J-Box (not supplied)
- 15

Wire clamp (not shown)
- 16

WRS (FIDO) Radio assembly (WRS units only)
- 17

Chevron knockout
- 18

Battery connector

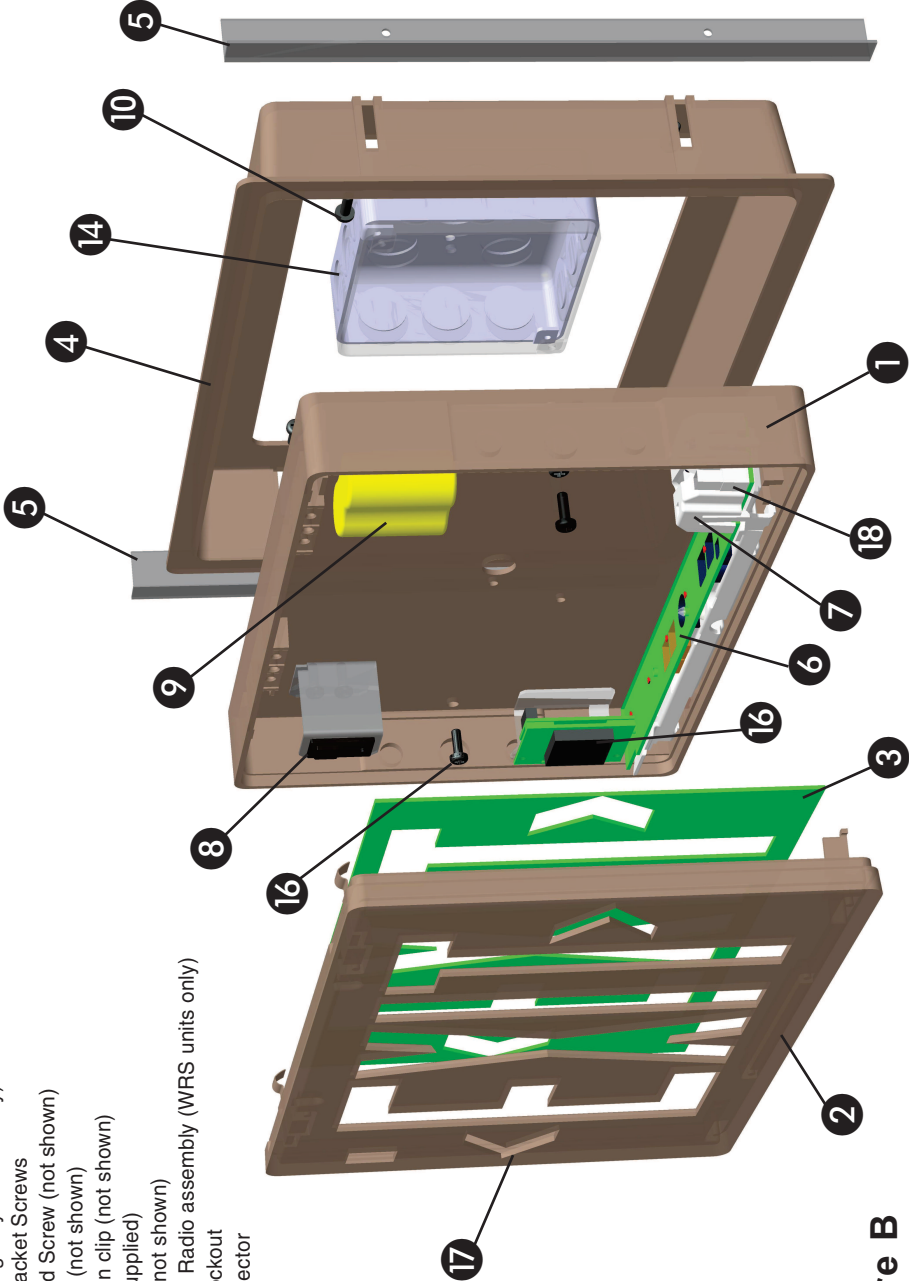

Figure B

LRE (Recessed Exit) Assembly

Installation Recessed (LRE) Units

Trim Ring Mounting

1. In desired location, make cutout in wall 8 3/4" x 12 3/8" long.
2. Center standard metal junction box (not included) in cutout.

**Note:** This installation requires that the face of junction box be recessed 1 3/4" from outside face of wall. Junction box should be mounted securely to a pre-cut and fitted brace.

**Optional Method:** Junction box may be fitted to a length of flexible cable sufficient to allow attachment of box to back of housing assembly.

3. Partially thread two (2) trim ring bracket screws through trim ring and thread into trim ring bracket approximately three threads deep, attaching trim ring to bracket to the trim ring as shown in Fig. B.
4. Insert the trim ring into the cutout. Adjust the attached trim ring against wall face by sliding trim ring bracket against wall interior. Reaching through trim ring position second trim ring bracket and partially thread two (2) trim ring bracket screws through trim ring and thread into trim ring bracket approximately three (3) threads deep.

Self-Diagnostic Testing

**Important Note:** Emergency Lighting Systems should be tested as often as local codes require, or at least monthly to ascertain that all components are operational. Allow battery to charge for 24 hours before initial testing. Allow 168 hours for battery to fully charge.

**Note:** The self-diagnostics option performs tests to satisfy test requirements as well as local code testing requirements for most areas.

1. **Normal Operation:** When unit is functioning properly with A.C. power supplied the status indicator will be green and the exit lamp will be on. If the indicator is steady red the unit is in Hi-Charge mode.
2. **Testing:** When the status indicator is flashing green with the exit lamp on a test is in progress. The exit performs 3 types of tests. Every 30 days it performs a 5 minute diagnostics test of the batteries, lamp and charging circuit. Upon completion of the testing, the status indicator will return to either green (steady) indicating a properly functioning unit that is trickle charging, or red (steady) indicating a properly functioning unit that is fast charging. Every 6 months self-diagnostics performs a 30 minute diagnostics test of the batteries, lamp and charging circuit. After the 30 minute test, the status indicator should return to red (steady) to indicate High-Charge mode. Once a year the self-diagnostics performs a 90 minute test of the batteries, lamp and charging circuit. After the 90 minute test the unit will return to red (steady) to indicate Hi-Charge mode. For other status indication refer to the table below.

Status Indicator:

Indicator State	Indication
Off	Exit in Emergency Mode
Green	Exit in Normal Mode
Green Flashing	Exit in Self-test Mode
Red	Exit in Normal High-Charge Mode
Red Flashing	Battery Failure
Red Flashing Double Pulse	Lamp Failure
Red Flashing Triple Pulse	Electronics Failure
Red/Green Flashing	Temporary Inadequate charge

**Clearing a failure Indication: Important Note:** Always replace the source of the failure before clearing the failure repair with the test switch. A failure indication may be cleared manually by pressing the manual test switch. This will clear the failure provided the failed component has been corrected.

**Manual Test Initiation: Important Note:** The self-diagnostics option performs tests to satisfy local codes. A 30 second test of the batteries, lamp and charger circuit may be manually initiated with a sufficiently charged battery by pressing the manual test switch.

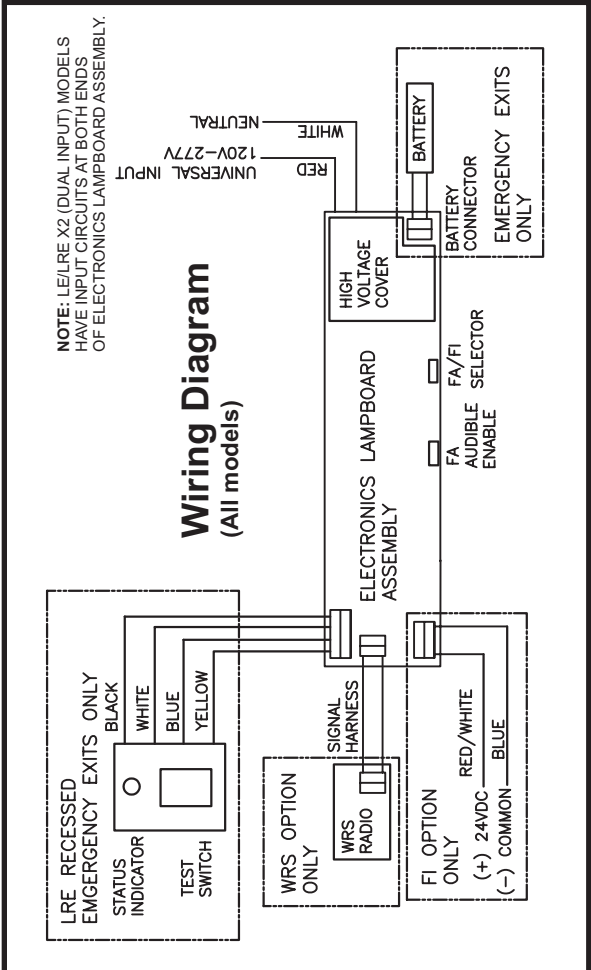

**FA option:** (If Installed): **Note:** If exit fixture is provided with FA (Flashing-Audible) option the exit will flash with audible tone anytime the power is interrupted from the product. The product is intended for installations where permitted by local codes. See **Jumper Position Diagrams 1 and 2** below for desired option settings.  
**Flash Rate: 66 CPM**  
**Duty Cycle: 50/50**

**FI option:** **Note:** If the exit is provided with FI (Fire Alarm Interface) option it will be cycled on and off by an external fire alarm control panel and is intended for installations where permitted by local codes. See **Jumper Position Diagram 3** below for FI setting.

**Flash Rate: 66 CPM**  
**Duty cycle: 50/50**  
**input Rating: 24 VDC @ 10mA max.**

Maintenance (All Models)

**Important Note:** Always turn off A.C. power and disconnect batteries before servicing the unit.

**Caution: Removal of the Electronics HV cover will create a potential shock hazard.**

Battery Replacement:

1. Unplug battery connector from electronic assembly. Un-snap battery from battery mounting clip, or pry battery loose from attached surface.

**Note:** See UL product label for appropriate Lithonia Lighting replacement part number. Battery replacement is reverse sequence of above.

Electronics Assembly Replacement:

**Note:** See label inside of unit for appropriate ELP---- part number for correct replacement assembly.

1. Disconnect the battery connector and input leads.
2. Remove the electronics assembly by pulling it forward to remove the assembly from the exit housing.
3. Assemble the new assembly by positioning the assembly at the bottom center and sliding all the way to the rear position as shown in Fig. A or B.

WRS (Fido) Radio Assembly Replacement:

**Note:** Please contact Lithonia Lighting for WRS radio replacement kit. Follow instructions provided with replacement kit.

FA and FI option Jumper Diagrams

