



MODEL NO: \_\_\_\_\_

TYPE: \_\_\_\_\_

PROJECT: \_\_\_\_\_

COMMENTS: \_\_\_\_\_

## DESCRIPTION

As part of the emergency lighting solution with Self Testing Automated Reporting (STAR), the STAR Gateway by IOTA® enables the deployment of Connected STAR. The STAR Gateway wirelessly receives data from exit signs, emergency unit equipment, and luminaires enabled with STAR and stores and makes the monthly and annual automated test results available via email, web-browser or API to aid in life safety compliance. For more information on emergency lighting solutions with STAR, visit [www.iotaengineering.com](http://www.iotaengineering.com).

## FEATURES

- IP-based device with Ethernet connection and wireless Bluetooth® communication
- Each STAR Gateway supports up to 500 devices enabled with STAR. Add Gateways where more than 500 devices are required. Consult factory for more information.
- Available with embedded web-based interface to view and manage device data
- Enhanced security through toggleable HTTP or HTTPS connections, a FIPS 140-2, Level 1 compliant security interface, SSO or Radius Server capabilities, and more
- No additional service plan required
- Includes Bluetooth® communication adapter and NEMA Type 1 Plenum-Rated Enclosure with surface mount screw cover.
- **5-Year Limited Warranty**



### Patents:

- US9819544B2 - US10073423B2
- EP3250970B1 - US9608538B2
- EP3139697B1 - CA2971061A1
- US9924243B2

## SPECIFICATIONS

### Gateway Module

Ports	Ethernet: (2) switched RJ-45 Ethernet ports USB Connections: 2 x USB 2.0 ports RS-485 Serial Communications: Screw terminals Used for MS/TP, Subnet: RJ-45
Real Time Clock	Real Time Clock with rechargeable battery. Supports SNTP network time synchronization
RTC Battery	20 hours charge time, 20 days discharge time. Up to 500 charge / discharge cycles
Enclosure	FR/ABS UL94-V0 flammability rating
Environmental	Operating Temp: 32°F to 122°F (0 to 50°C) Storage Temp: -22°F to 158°F (-30 to 70°C) Relative Humidity: 0 to 90% non-condensing Ingress Protection Rating: IP20
Security	FIPS Publication 140-2, Level 1 Compliant. Complies with California Civil Code Title 1.81.26, Security of Connected Devices, approved under Senate Bill No. 327 (2018)

### Power Supply Module

Operating Voltage	24V: 24VAC/DC; ±15%; Class 2
Output Voltage, Rated Current, Power	24V: 18VDC regulated, 0-1.6A, 50W max
Input Voltage	120-277VAC, 50/60Hz, 1.0A max

### (Optional) CLAIRITY Link Router (Service Plan Required)

Power Consumption	< 6.5W
Input Voltage Range	9-30VDC
Mobile	4G LTE: up to 150Mbps / 3G: up to 42Mbps / 2G: up to 236.8kbps United States - ATT, T-Mobile/Sprint, US Cellular, Alaska Wireless Mexico - Telefonica Canada - Tellus, Bell, SaskTel <sup>1</sup>
Ethernet	WAN - 10/100Mbps; connects to an owner-provided, Internet-connected network. LAN-10/100Mbps; used for discovery of controllers connected to a network without Internet connectivity Wireless Mode - IEEE 802.11b/g/n Security - WPA2-Enterprise Wi-Fi Hotspot - used for modem and SIM diagnostics Wi-Fi Client - not supported
Environmental	Operating Temp: -40°C to 75°C Operating Humidity: 10% to 90% non-condensing Storage Temp: -45°C to 75°C
Security	Firewall - pre-configured firewall Attack Prevention - DDOS prevention, port scan prevention WEB filter - whitelist for specifying allowed sites only Access control - control of TCP, UDP, ICMP packets, MAC address filter Complies with California Civil Code Title 1.81.26, Security of Connected Devices, approved under Senate Bill No. 327 (2018)
Ingress Protection	IP30
Regulatory	FCC, IC/ISED, EAC, RCM, PTCRB, RoHS, CE/RED, WEEE, Wi-Fi Certified, CCC, Anatel, GCF, REACH, Thailand NBTC, Ukraine UCRF, SDPPI (POSTEL)
Antennas	Mobile - 698-960/1710-2690 MHz, SMA male connector Wi-Fi - 2400-2483.5 MHz, SMA male connector
Input/Output	Input - 1x digital, non-isolated input (on 4 pin power connector) Output - 1 x digital, open collector output (30 V, 300 mA, on 4 pin power connector)
SIM	1 x SIM slot (Mini SIM – 2FF), 1.8V/3V, external SIM holder



<sup>1</sup>The Bluetooth® word mark and logos are registered trademarks owned by Bluetooth SIG, Inc. and any use of such marks by Acuity Brands is under license. Other trademarks and trade names are those of their respective owners.

# STAR Gateway

## ORDERING GUIDE

- ISCG
- MVOLT
- 
- ENC

**Understanding Your IOTA Model:**

- ISCG** = STAR Gateway by IOTA  
**MVOLT** = 120-277VAC Input Voltage  
**ENC** = NEMA Type 1 metal enclosure

**REM** - Pre-wired Link Router with cellular SIM<sup>1</sup> (optional)

<sup>1</sup>Cellular connectivity performance may be affected by carrier coverage and antenna placement. Coverage by supported carriers should be verified prior to purchase. See the Specifications section for a list of all supported carriers per country.

## SYSTEM ARCHITECTURE

The STAR Gateway wireless receives test data from Emergency Lighting devices enabled with STAR to provide access via the GUI interface. See the ISCG Installation Guide and/or the ISCG User Manual for additional information.

**NOTE:** An additional 10m (Part#: BLE DONGLE ECY USB EXT 10M M1) or 20m (Part#: BLE DONGLE ECY USB EXT 20M M1) extension cable is available for purchase, for a combined maximum of 30m total.

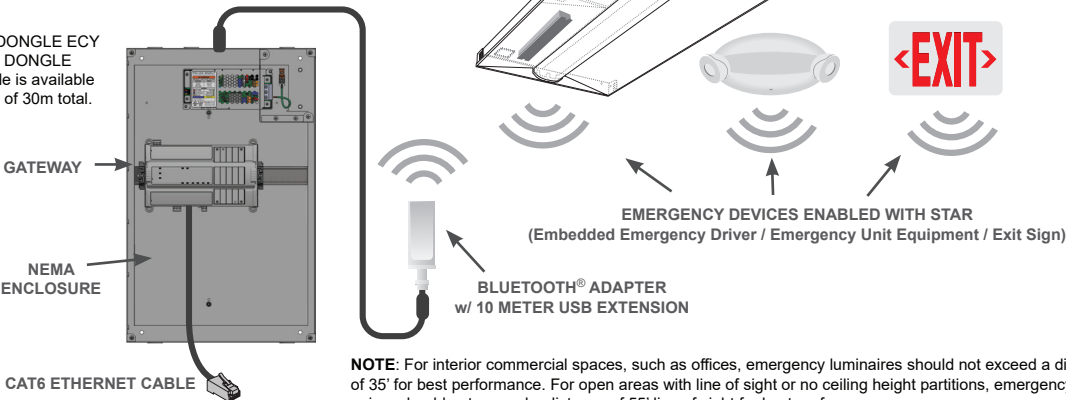

## DIMENSIONS

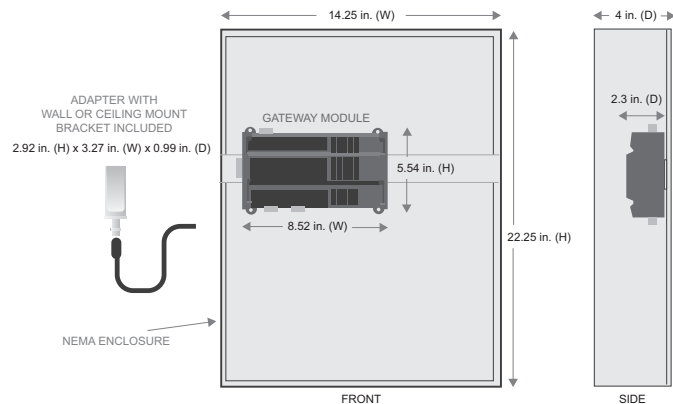

## COMMUNICATION

- Ethernet Connection Speed: 10/100 Mbps
- Internet Protocol: IPv4
- Web Server Protocol: HTML5
- Web Server Application Interface: REST API

**Supported Wireless Connectivity**

- Wireless Adapter: USB Port Connection
- Wi-Fi Communication Protocol - IEEE 802.11b/g/n
- Wi-Fi Network Types - Client, Access Point, Hotspot
- Bluetooth® Low Energy Adapter: USB Port Connection, 2.4 GHz

## REM OPTION CONNECTIVITY PLANS

Remote support via the CLAIRITY Link solution is enabled through a connectivity plan (REMCONN). Purchase of a CLAIRITY Link router includes an initial 12-month Ethernet connectivity plan that begins upon shipment of hardware from the factory. For extended periods of connectivity, or for cellular connectivity, supplementary plans can be purchased. Flexible plans are offered in 3-month to 24-month durations and can be purchased at any time with no hidden fees and no continuous costs. On premise systems continue to operate when a connectivity plan is inactive.

Series	Connection Type	Service Length	Supported Countries
<b>REMCONN</b>			<b>CAR1</b>
Connectivity plan to enable remote access by factory representatives	<b>ETH</b> - Uses Ethernet connection to a customer-provided network with Internet access for communication with the CLAIRITY Link portal <b>CELL<sup>2</sup></b> - Includes a cellular plan to supplement or replace Ethernet connectivity for communication with the CLAIRITY Link portal	<b>3MO</b> 3-month length <b>6MO</b> 6-month length <b>9MO</b> 9-month length <b>12MO</b> 12-month length <b>18MO</b> 18-month length <b>24MO</b> 24-month length	US, Mexico, and Canada  <sup>2</sup> Cellular connectivity performance may be affected by carrier coverage and antenna placement. Coverage by supported carriers should be verified prior to purchase. See the Specifications section for a list of all supported carriers per country. Use of default SIM included with hardware is required for REMCONN CELL connectivity plan. REMCONN ETH does not require use of a cellular SIM but is required for connectivity with the portal using a non-standard, third-party SIM, provided by, paid for, and maintained by others. Compatibility with non-default, third party SIMs is not guaranteed or warranted.

**Warranty:** 5-Year Limited Warranty. This is the only warranty provided and no other statements in this specification sheet create any warranty of any kind. All other express and implied warranties are disclaimed. Complete warranty terms located at: [www.acuitybrands.com/CustomerResources/Terms\\_and\\_conditions.aspx](http://www.acuitybrands.com/CustomerResources/Terms_and_conditions.aspx)

**Note:** Actual performance may differ as a result of end-user environment and application. Specifications subject to change without notice.

SS111-0108-000-01 0424