

FEATURES & SPECIFICATIONS

INTENDED USE — The T Series LED surface mount combines digital lighting and control technologies with a high-performance optical system to deliver general ambient lighting for many applications such as schools, offices and hospitals. High-efficacy light engine delivers long life and excellent color, ensuring a superior quality light installation that is highly efficient and sustainable. **Certain airborne contaminants can diminish integrity of acrylic.** [Click here for Acrylic-Polycarbonate Compatibility table for suitable uses.](#)

CONSTRUCTION — Housing formed from cold-rolled steel. Polyester powder-paint after fabrication option available.

Smooth hemmed sides and smooth inward-formed end flanges, for easy handling.

Standard extruded aluminum door frame has superior structural integrity with premium appearance and mitered corners. Powder-painted rotary cam latches provide easy, secure door closure. Integral T-bar clips are standard. Acrylic shielding material is 100% UV stabilized.

OPTICS — Standard pattern #19 lens, 0.156" thick with highly transmissive overlay, is standard for superior brightness control. Overlay is 0.040" thick. Other lenses are available.

ELECTRICAL — Long-life LEDs, coupled with high-efficiency drivers, provide superior quantity and quality of illumination for extended service life. 90% LED lumen maintenance at 60,000 hours (L90/60,000).

nLight® embedded controls make each luminaire addressable - allowing it to digitally communicate with other nLight enabled controls such as dimmers, switches, occupancy sensors and photocontrols. Simply connect all the nLight enabled control devices and the luminaires using standard Cat-5 cabling. Unique plug-and-play convenience as devices and luminaires automatically discover each other and self-commission.

Lumen Management: Unique lumen management system (option N80) provides onboard intelligence that actively manages the LED light source so that constant lumen output is maintained over the system life, preventing the energy waste created by the traditional practice of over-lighting.

Step-level dimming option allows system to be switched to 50% power for compliance with common energy codes while maintaining fixture appearance.

eldoLED driver options deliver choice of dimming range, and choices for control, while assuring flicker-free, low-current inrush, 89% efficiency and low EMI.

Driver disconnect provided where required to comply with US and Canadian codes.

INSTALLATION — Surface mount. Drivers and internal components are accessible from floor. LED boards include plug-in connectors for easy replacement or servicing. Suitable for damp location.

LISTINGS — CSA certified to US and Canadian standards.

GOVERNMENT PROCUREMENT — BAA – Product with the BAA option qualifies as a domestic end product under the Buy American Act as implemented in the FAR and DFARS. Product with the BAA option also qualifies as manufactured in the United States under DOT Buy America regulations.

BABA – Build America Buy America: Product with the BAA option also qualifies as produced in the United States under the definitions of the Build America, Buy America Act.

Please refer to www.acuitybrands.com/buy-american for additional information.

WARRANTY — 5-year limited warranty. This is the only warranty provided and no other statements in this specification sheet create any warranty of any kind. All other express and implied warranties are disclaimed. Complete warranty terms located at: www.acuitybrands.com/support/warranty/terms-and-conditions

Note: Actual performance may differ as a result of end-user environment and application.

All values are design or typical values, measured under laboratory conditions at 25 °C. Specifications subject to change without notice.

Catalog Number
Notes
Type

T SERIES SURFACE MOUNT

2TLX2

2' x 2' LED



Specifications

Length: 24-3/4 (62.9)

Width: 24-3/4 (62.9)

Depth: 4-3/4 (12.1)

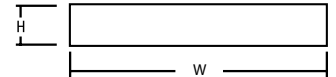

All dimensions are in inches (centimeters) unless otherwise indicated.

A+ Capable Luminaire

This item is an A+ capable luminaire, which has been designed and tested to provide consistent color appearance and out-of-the-box control compatibility with simple commissioning.

- All configurations of this luminaire meet the Acuity Brands' specification for chromatic consistency
- This luminaire is part of an A+ Certified solution for nLight® control networks when ordered with drivers marked by a shaded background*
- This luminaire is part of an A+ Certified solution for nLight control networks, providing advanced control functionality at the luminaire level, when selection includes driver and control options marked by a shaded background*

To learn more about A+, visit www.acuitybrands.com/aplus.

*See ordering tree for details

2TLX2 Surface Mount LED Lighting 2' x 2'



A+ Capable options indicated by this color background.

ORDERING INFORMATION

Lead times will vary depending on options selected. Consult with your sales representative.

Example: 2TLX2 33L RW A19 EZ1 LP835 N80

2TLX2					
Series	Lumens ¹	Door	Lens	Voltage	Driver
2TLX2 Surface LED 2x2	20L 2000 lumens	FW Flush aluminum, white	A12 #12 pattern acrylic	(blank) MVOLT (120-277)	EZ1 eldoLED dims to 1% (0-10 volt dimming) EZB eldoLED dims to 0.1% (0-10 volt dimming) GZ1 Dims to 1% (0-10V dimming) ³ GZ10 Dims to 10% (0-10V dimming) ³ EDB eldoLED DALI ⁴ SLD Step-level dimming ⁴
	33L 3300 lumens		A19 #19 pattern acrylic, 0.156" thick		
	40L 4000 lumens	RW Regressed aluminum, white	MWS Matte white .040" thick	347 347 ²	
			MPL Micro prism		
			SWL Satin white		

Color temperature	Control ⁵	Options
LP830 3000 K	(blank) No controls	EL7L 700 nominal lumen battery pack
LP835 3500 K	N80 nLight with 80% (L80) lumen management	EL14L 1400 nominal lumen battery pack
LP840 4000 K	N80EMG nLight with 80% (L80) lumen management for use with generator supply EM power	E10WLCP EM Self-Diagnostic battery pack, 10W Constant Power, Certified in CA Title 20 MAEDBS
LP850 5000 K	N100 nLight without lumen management	PAF Paint after fabrication
	N100EMG nLight without lumen management for use with generator supply EM power	BAA Buy America(n) Act and/or Build America Buy America Qualified

Notes

- 1 Approximate lumen output.
- 2 Not available with EL7L or EL14L battery packs or SLD driver.
- 3 GZ1, GZ10 drivers not available with any Controls options.
- 4 Not available with N80, N80EMG, N100, or N100EMG.
- 5 Not available with EZB driver due to space issue.

Performance Data

Lumen	Package	Lumens	Input Watts	LPW
20L	LP830	2,034.7	18	113.0
20L	LP835	2,078.3	18	115.5
20L	LP840	2,092.9	18	116.3
20L	LP850	2,165.6	18	120.3
33L	LP830	3,246.3	29	111.9
33L	LP835	3,317.0	29	114.4
33L	LP840	3,339.8	29	115.2
33L	LP850	3,458.3	29	119.3
40L	LP830	3,811.6	35	108.9
40L	LP835	3,892.7	35	111.2
40L	LP840	3,921.8	35	112.1
40L	LP850	4,058.9	35	116.0

2TLX2 Surface Mount LED Lighting 2' x 2'

MOUNTING DATA

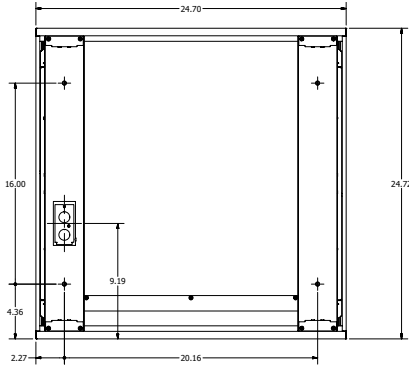

PHOTOMETRICS

2TL2 33L FW A12 EZ1 LP840, 3339.8 delivered lumens, test no. LTL26923P18, tested in accordance to IESNA LM-79.

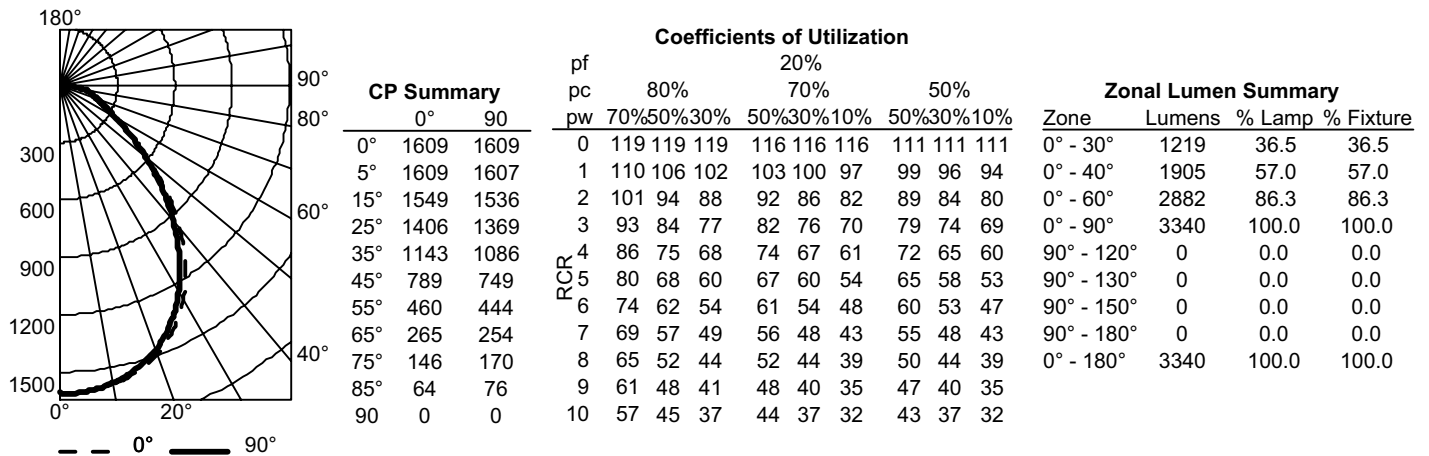

Constant Lumen Management

Enabled by the embedded nLight control, the TLX actively tracks its run-time and manages its light source such that constant lumen output is maintained over the system life. Referred to as lumen management, this feature eliminates the energy waste created by the traditional practice of over-lighting.

