

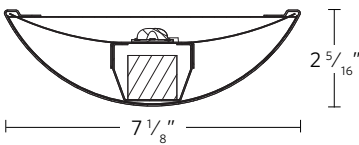

DIMENSIONS

7CRM7L



DETAILS

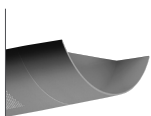

Sculptured end cap

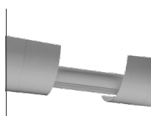

Tenon



Corner

COMPANION LUMINAIRE(S)

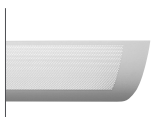

CRW7L Cerra Wall
LED Partial Perforation

CUSTOMIZATION

Ask us about the following possibilities: Higher lumen outputs up to 6100 lumens, section lengths in 1' increments, alternate distributions, alternate voltages, additional mounting options, custom colors, higher CRI and R9 values and other modifications.

HIGHLIGHTS

- Total System Integration features 5-year limited warranty by Acuity Brands covering all components and construction
- 4', 8' and 12' sections
- Up to 105 lm/W
- Two lumen packages
- High performance batwing distribution using injection molded optic
- Flicker-free dimming to dark (0.1%) powered by eldoLED® driver
- Integrated nLight®
- Integrated sensor for daylight dimming and/or occupancy detection (optional)
- Flat or sculptured end caps
- White, black, aluminum or custom color
- QuickShip option available



eldoLED



Declare.

LUMEN PACKAGES

Indirect LED Output	I700LMF	I700LMF	I700LMF	I1300LMF	I1300LMF	I1300LMF
Color Temperature	3000K	3500K	4000K	3000K	3500K	4000K
Delivered Lumens Per Foot	722	755	788	1113	1163	1214
Input Watts Per Foot	7.8	7.5	7.5	12.8	13	13
Lumens Per Watt	93	101	105	87	90	93

DISTRIBUTION

97% Up | 3% Down

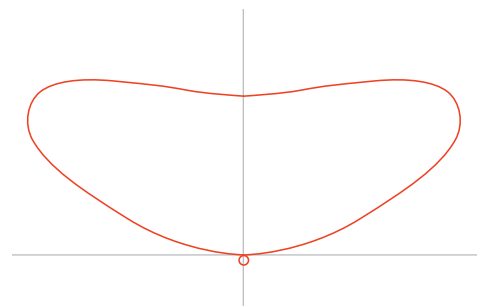

SPECIFICATIONS

Housing

Nominal 7" x 2" crescent housing is formed from one-piece cold-rolled steel.

End Caps

Flat end cap standard. For sculptured die-cast aluminum end caps, choose option SCEP.

Color

Color for housing and end caps is white, black or painted aluminum. Consult factory for custom colors.

Luminaire Length

4', 8', and 12' lengths in a single section for exact suspension spacing of 4', 8', and 12'. For total length, add $\frac{1}{16}$ " for each flat end cap or 3" for each sculptured end cap. Using internal joiners, 4', 8', and 12' sections can be joined to form longer rows.

Source

Two LED lumen packages and five available color temperature options (2700K, 3000K, 3500K, 4000K and 5000K) — all within 2.5 MacAdam ellipses.

Optics

Optical system consists of injection-molded primary optic, high performance film and highly reflective metal reflector.

Dimming Driver

eldoLED® driver provides "natural dimming" with smooth, continuous and flicker-free dimming to dark (0.1%). Syncing for controls: 2mA max. THD: < 20%. Insignificant inrush current at 120 and 277VAC. FCC Class A and B tested for EMI and RFI.

When control Input of 0-10V is specified driver will be set for linear dimming curve, if NLIGHT is specified driver will be set for logarithmic dimming curve

For 0-10V driver details go to: PeerlessLighting.com/566L

For DALI driver details go to: PeerlessLighting.com/560L

Controls and System Networking Options

For wired networking via Cat-5e, choose an integrated nLight® module For daylight dimming and/or dual technology occupancy detection. See Integrated Sensor Layout Page for more details.

Electrical

LED light engine — consisting of modular LED boards and 0-10V dimming driver — is rated for 60,000 hours (L80) at 25° C ambient temperature. Specify 120V or 277V. Pre-wired with 16AWG fixture wire. For special circuiting or wire gauge, consult factory. Plug-in electrical connectors included.

Environment

Suitable for Dam location.

Validation

CSA/CUS listed. CSA tested to UL 1598 standards. LM-79 tested. Individual sections meet FCC Part 15 requirements.

Packaging

Recycled cardboard box and inserts. Biodegradable protective luminaire bag. Recycled kraft paper tape.

Warranty

5-year limited warranty. Complete warranty terms located at www.acuitybrands.com/CustomerResources/Terms_and_conditions.aspx

Note: Actual performance may differ as a result of end-user environment and application.

All values are design or typical values, measured under laboratory conditions at 25°C.

A+ Capable Luminaire

This item is an A+ capable luminaire, which has been designed and tested to provide consistent color appearance and out-of-the-box control compatibility with simple commissioning.

- All configurations of this luminaire meet the Acuity Brands' specification for chromatic consistency
- This luminaire is part of an A+ Certified solution for nLight® control networks when ordered with drivers marked by a shaded background*
- This luminaire is part of an A+ Certified solution for nLight control networks, providing advanced control functionality at the luminaire level, when selection includes driver and control options marked by a shaded background*

To learn more about A+, visit www.acuitybrands.com/aplus.

*See ordering tree for details



A+ Capable options indicated by this color background.

MODEL NUMBER Example: 7CRM7L LLP 16FT MSL8 80 CRI 35K I700LMF DARK ZT 120 SCT F1/24A C110

Luminaire	Linear Length Plan	Total Run Length	Maximum Section Length	LED Color Rendering	LED Color Temperature	Indirect LED Output	Minimum Dimming Level
7CRM7L	LLP Linear longest possible LCB Linear center balanced LSL Longest same length	_FT <i>Indicate luminaire row length in 4" increments. Ex: 12FT</i>	MSL4 4' section(s) MSL8 8' section(s) MSL12 12' section(s)	80CRI 80+ CRI	27K 2700K 30K 3000K 35K 3500K 40K 4000K 50K 5000K	I700LMF 700 Nominal lumens per foot I1300LMF 1300 Nominal lumens per foot	DARK Constant current, dimming to < 1%

Control Input	Voltage	Wiring Option	Emergency Options	Primary Sensor	Secondary Sensor
ZT* 0-10V NLIGHT** nLight enabled DALI*** DALI enabled <i>*0-10V will use linear dimming curve</i> <i>**Will use logarithmic dimming curve</i> <i>***Not available with sensors</i> <i>***Will use logarithmic dimming curve</i>	120 120V 277 277V MVOLT 120V-277V	SCT Single circuit	(Blank) None 1EC (1) Emergency circuit module 2EC (2) Emergency circuit module _EC ____ Emergency circuit modules <i>*Emergency type is installed in last 4' of luminaire sections. Separate feed required.</i> <i>**4FT MSL4 Individual fixture with EC Consult factory</i>	(blank) No factory-installed, integrated sensor PDT_ Dual technology occupancy sensor. PIR & microphonics sensor ADC_ Daylight Dimming Sensor APD_ Dual technology PDT and ADC sensor <i>*Available with ZT or nLight only</i>	(blank) No factory-installed, integrated sensor SPDT_ Dual technology occupancy sensor. PIR & microphonics sensor SADC_ Daylight Dimming Sensor SAPD_ Dual technology PDT and ADC sensor <i>*Available with ZT or nLight only</i>

Mounting Type/	Overall Suspension	Color	Options
F1/ T-bar ceiling (universal mounting bracket) F1A/ T-bar ceiling (UMB with integrated J-box) F2/ Hard ceiling (horizontal J-box) <i>*F1 & F1A Mount uses standard 3 1/2" canopy on feed and 2" canopy on support</i> <i>**F2 Mount uses standard 5" canopy on feed and 2" canopy on support</i> <i>*** All feed cords, cord managers and canopies are standard white. They are not painted to match fixture color.</i>	12F 12" fixed 18F 18" fixed 24F 24" fixed 24A 24" adjustable 36A 36" adjustable 48A 48" adjustable 72A 72" adjustable 96A 96" adjustable 144A 144" adjustable 192A 192" adjustable 240A 240" adjustable <i>*Measured from ceiling to bottom of luminaire.</i>	C110 Painted aluminum (low gloss) C210 White white (fine textured) C202 Black (fine textured) C099 Custom color RALTBd* Ral Paint finishes <i>*RALTBd for pricing only. replace with applicable RAL call out when ready to order. See the RAL BROCHURE for available options</i>	BLK* Black cord, cord manager and canopy CSA*** Manufactured to Canadian Standards CP Chicago Plenum (available with F1A only) ELH** Emergency through wiring w/separate neutrals-single EM feed at opposite end of normal ELS2** Emergency through wiring w/separate neutrals-single EM feed at same end of normal GLR Fast Blow GMF Slow Blow MCS Matching canopy at support for aesthetics MCSJ Matching canopy for J-box mounting at non-power feed support locations SLP Sloped Ceiling SCEP Sculptured end caps <i>*Not available with nLight</i> <i>**Not available with CSA</i> <i>***When chosen with EC entire section must be EC.</i> <i>EX: MSL8 section would need to be 2EC for entire section</i>

PHOTOMETRICS Actual performance may differ as a result of end-user environment and application.

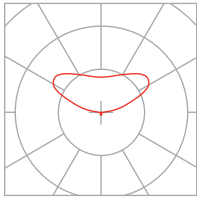

I700LMF 80 CRI 30K
93 lm/W
2889 delivered lumens
per 4' section

97% up / 3% down

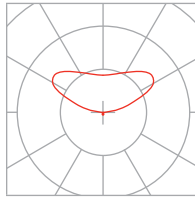

I700LMF 80 CRI 35K
101 lm/W
3018 delivered lumens
per 4' section

97% up / 3% down

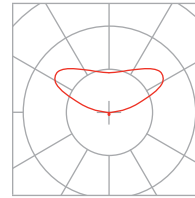

I700LMF 80 CRI 40K
105 lm/W
3152 delivered lumens
per 4' section

97% up / 3% down

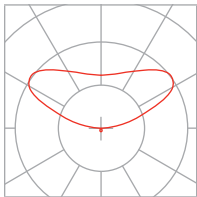

I1300LMF 80 CRI 30K
87 lm/W
4452 delivered lumens
per 4' section

97% up / 3% down

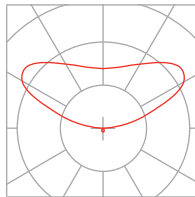

I1300LMF 80 CRI 35K
90 lm/W
4652 delivered lumens
per 4' section

97% up / 3% down

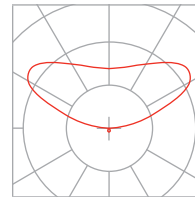

I1300LMF 80 CRI 40K
93 lm/W
4857 delivered lumens
per 4' section

97% up / 3% down

WEIGHTS & SUPPORT SPACING

Suspension spacing equals section length. Default location shown.

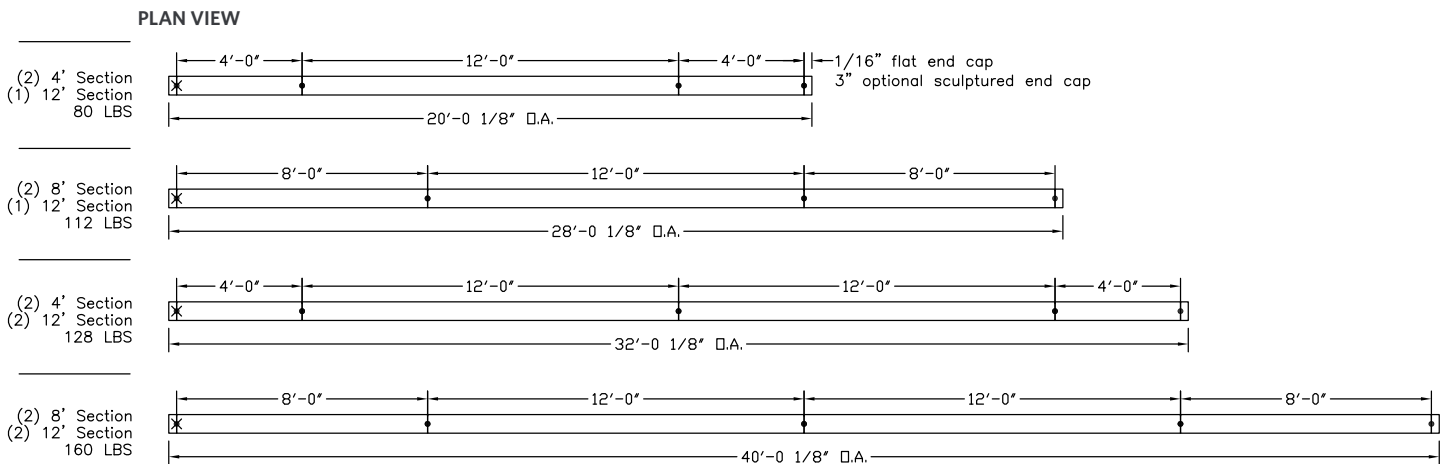
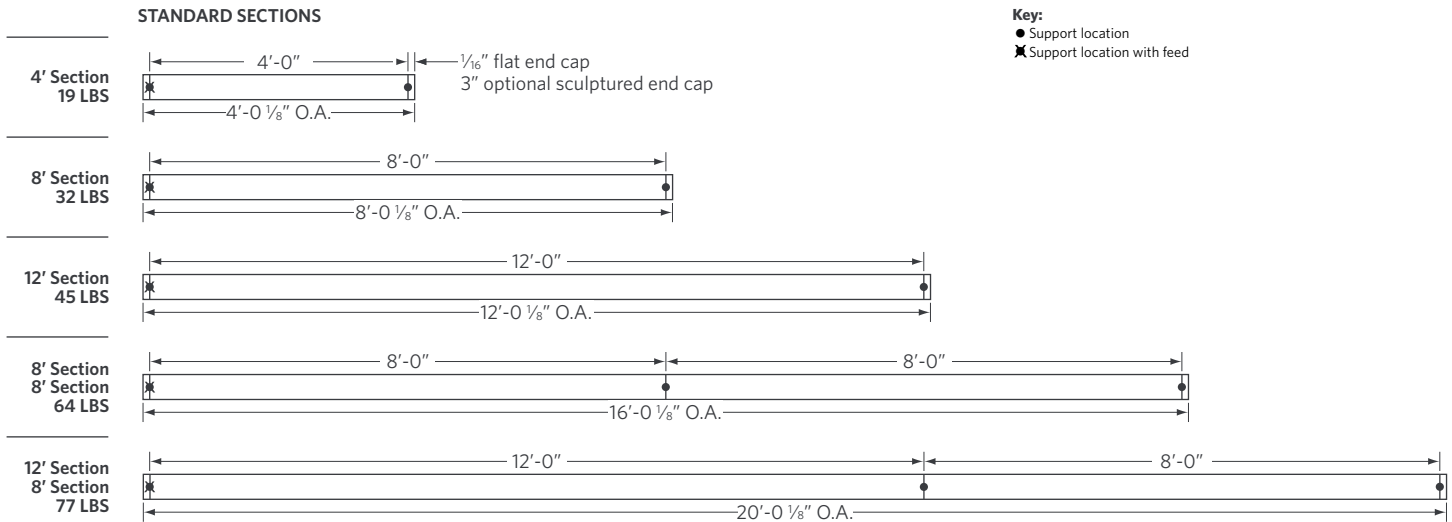

LCB — Linear Center Balanced layouts

LINEAR PLAN:

PEERLESS offers the ability to provide a continuous run plan to suit your requirements by optionally offering three different methods of configuration.

LSL- Linear Same Length:

In this configuration, each segment is the same length and is standardized based on the longest length available and is the only option provided. Because it is dependent on one segment length there are mathematical limitations on what overall row lengths can be achieved. Example: 20 FT row would be achieved with 5, 4 FT long segments equaling 20 FT (nominal).

LSL	4FT	4FT	4FT	4FT	4FT
------------	-----	-----	-----	-----	-----

LCB- Linear Center Balanced:

This configuration incorporates the longest center segment(s) along with any additional lengths required to fill the run length, added to the run ends. Example: 16 FT run would have 2, 4 FT segments (one at each end) and 1, 8 FT segment in the center.

LCB	4 FT	8 FT	4FT
------------	------	------	-----

LLP- Linear Longest Possible

In this configuration, the longest length available is optimized, resulting in the fewest segments and mounting locations. Caution, should be used where balanced appearance is a concern. Example: 20 FT run would have 2, 8 FT segment and 1, 4 FT segment at the end of the run.

LLP	8 FT	8 FT	4FT
------------	------	------	-----

MOST COMMON MOUNTING TYPES AND OPTIONS

Options available for this specific luminaire are checked in the boxes below.

Mounting Type

- F1/** For use with most T-Bar and screw slot grid ceilings. Designed for on-grid and off-grid applications.
- F2/** For use with recessed or surface mount horizontal J-box applications.
- F3/** Stem mounting for use with recessed or surface mount horizontal J-box applications. *Check with local jurisdiction regarding rigid stem code requirements.*
- F1A/** For use with most T-Bar and screw slot grid ceilings. Designed for on-grid and off-grid applications. *Comes complete with vertical J-box with built-in wire way. See also CP.*

Mounting Options

- MCS** Matching canopy at support for aesthetics.
- MCSJ** Matching canopy for J-box mounting at non-power feed support locations.
- OJB** Offset J-box at feed.
- SLP OJB** Sloped ceiling couplers and offset J-box option at feed.

For more detailed mounting drawings and information, see peerlesslighting.acuitybrands.com/resources

☒ Indicates mounting options available with this luminaire.

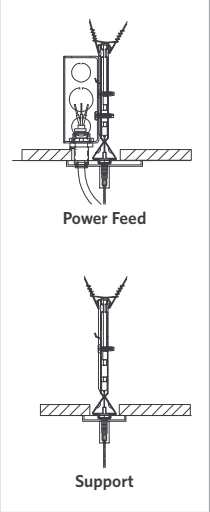
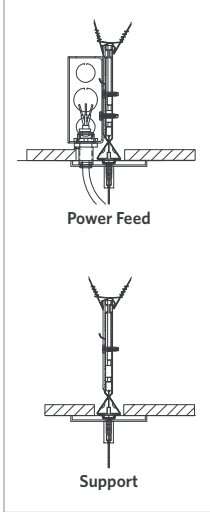
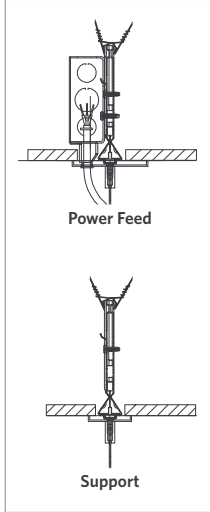
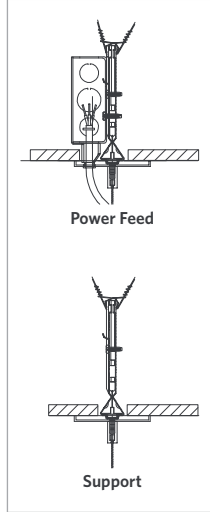
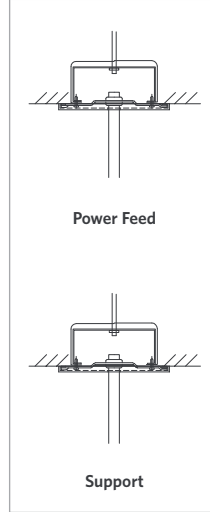
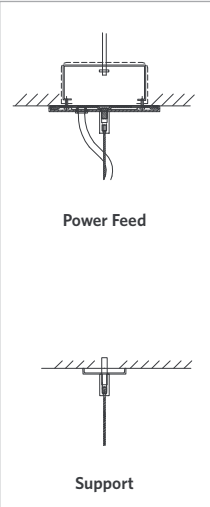
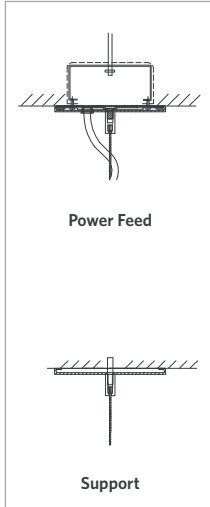
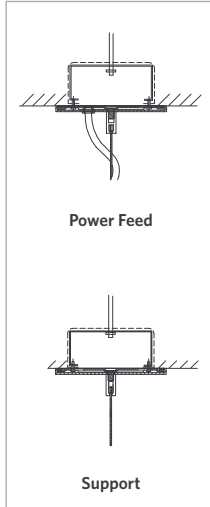
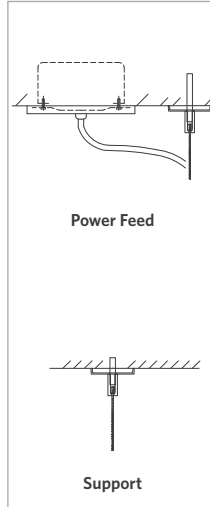
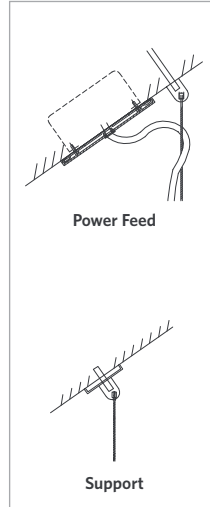
<input checked="" type="checkbox"/> F1/ 	<input checked="" type="checkbox"/> F1/MCS 	<input checked="" type="checkbox"/> F1A/ 	<input checked="" type="checkbox"/> F1A/MCS 	<input type="checkbox"/> F3/ 
<input checked="" type="checkbox"/> F2/ 	<input checked="" type="checkbox"/> F2/MCS 	<input checked="" type="checkbox"/> F2/MCSJ 	<input checked="" type="checkbox"/> F2/OJB 	<input checked="" type="checkbox"/> F2/SLP OJB 

For more information about sensor and networking options, download the controls guide at PeerlessLighting.com/ControlsGuide

INTEGRATED SENSOR OPTIONS

Control Input	Integrated Sensor	Daylight Dimming	Daylight Dimming and/or Occupancy Detection	nLight Wired Networking	Link to Spec Sheet
NLIGHT	ADC	X		X	nES-ADCX
NLIGHT	PDT		X	X	nES-7
ZT	ADC	X			nES-ADCX
ZT	PDT		X		nES-7

Daylight harvesting deactivated by default and field programmed per sequence of operations for PDT sensor options.

Luminaires specified with nLight system networking ship with one RJ-45 connector integrated into the luminaire, 10' of Cat-5e cable and a splitter to control the entire luminaire row (depending on wattage/voltage limitations). For multiple zones, please contact TechSupport@PeerlessLighting.com.



OCCUPANCY DETECTION COVERAGE

At the 7.5 ft (2.9 m) hanging height of a typical pendant mount fixture the sensor provides 10 ft (3.05 m) radial detection of small motion. At a 9 ft (2.74 m) hanging height the radius is 12 ft (3.66 m) for small motion.

Adequate for walking motion detection from mounting heights between 7.5 ft (2.29 m) and 20 ft (6.10 m).

Initial detection will occur earlier when walking across sensor's field of view than when walking directly at sensor.

Initial detection of walking motion into long coverage segment will occur at distances of 2x the mounting height up to 15 ft (4.57 m) and 1.75x up to 20 ft (6.10 m). Lens assembly rotates 15° to enable adjustment in order to line up long segments.

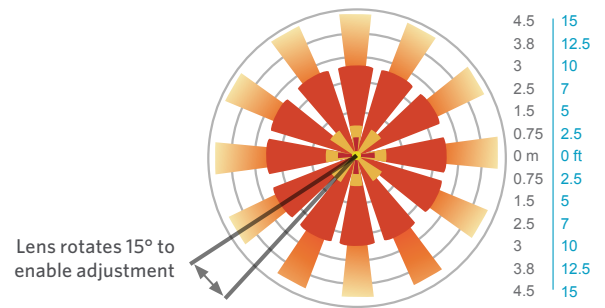

COMPATIBLE nLIGHT COMPONENTS WITH INTEGRATED CONTROLS



nPODM DX WH

nPODM 2P DX WH

nPODM 4P DX WH

SensorSwitch.com/DataSheets/nPODM.pdf



nPODM 2L WH

SensorSwitch.com/DataSheets/nPODM-xL.pdf



nPOD GFX WH

SensorSwitch.com/DataSheets/nPOD-GFX.pdf

eldoLED COMPATIBILITY Additional control options with eldoLED 0-10V driver(s).

PeerlessLighting.com/eldoLED-compatibility

INTEGRATED SENSOR LAYOUT

CORRECT:

32FT MSL8 RUN WITH 2 SENSORS WITH PRIMARY ZONE 24FT AND SECONDARY ZONE 8FT -- PDT24 SADC8

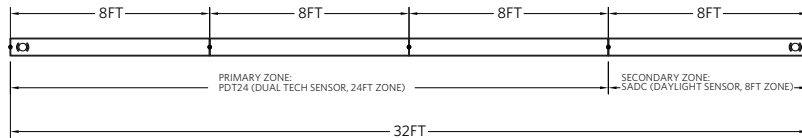

32FT MSL8 RUN WITH 1 SENSOR ALL ONE ZONE -- ADC

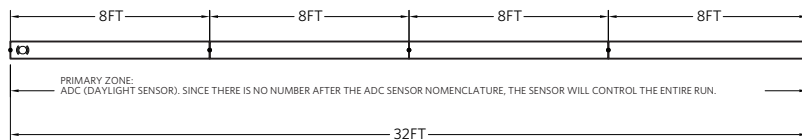

INCORRECT:

32FT MSL8 RUN WITH 1 SENSOR ALL ONE ZONE -- PDT16

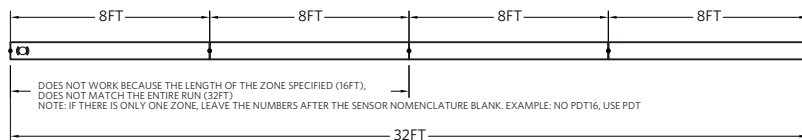

32FT MSL8 RUN WITH 2 SENSORS WITH PRIMARY ZONE 20FT AND SECONDARY ZONE 12FT -- PDT20 SADC12

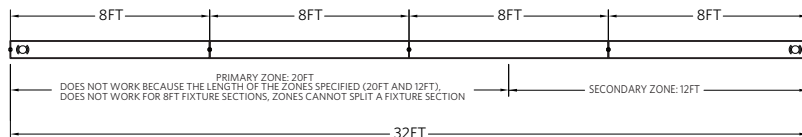

Notes:

- Only one sensor per zone
- At the most, the entire run can only have 2 sensors (thus 2 sensors zones at the most)
- Sensor zone can not split fixture sections
- No overlapping zones
- One nLight or NLTAIR2 device per zone or per sensor, for multiple zones without sensors contact factory