



## **Installation Instructions**

# **Healthcare Lighting – Under-Cabinet Task Lighting**

Installation and Maintenance

**Revision 02**

**I-HUC**

**Revision Date 10/18/2021**





Healthcare Lighting

3 Kilmer Rd, Edison, NJ 08817  
[www.healthcare-lighting.com](http://www.healthcare-lighting.com)

1-855-868-6980

**READ AND FOLLOW ALL SAFETY INSTRUCTIONS!**  
**SAVE THESE INSTRUCTIONS AND DELIVER TO OWNER AFTER INSTALLATION**

- To reduce the risk of death, personal injury or property damage from fire, electric shock, falling parts, cuts/abrasions, and other hazards please read all warnings and instructions included with and on the fixture box and all fixture labels.
- Before installing, servicing, or performing routine maintenance upon this equipment, follow these general precautions.
- Installation and service of luminaires should be performed by a **qualified licensed electrician**.
- Maintenance of the luminaires should be performed by person(s) familiar with the luminaires' construction and operation and any hazards involved. Regular fixture maintenance programs are recommended.
- It will occasionally be necessary to clean the outside of the refractor/lens. Frequency of cleaning will depend on ambient dirt level and minimum light output which is acceptable to user. Refractor/lens should be washed in a solution of warm water and any mild, non-abrasive household detergent, rinsed with clean water and wiped dry. Should optical assembly become dirty on the inside, wipe refractor/lens and clean in above manner, replacing damaged gaskets as necessary.
- **DO NOT INSTALL DAMAGED PRODUCT!** This luminaire has been properly packed so that no parts should have been damaged during transit. Inspect to confirm. Any part damaged or broken during or after assembly should be replaced.
- If the lamp is marked (Hg) it contains Mercury. Follow all disposal laws. See [www.lamprecycle.org](http://www.lamprecycle.org).
- These instructions do not purport to cover all details or variations in equipment nor to provide every possible contingency to meet in connection with installation, operation, or maintenance. Should further information be desired or should particular problems arise which are not covered sufficiently for the purchaser's or owner's purposes, this matter should be referred to Acuity Brands Lighting, Inc.

 <div style="border: 1px solid black; padding: 5px; text-align: center; margin: 10px 0;"> <b>WARNING</b>  <b>RISK OF ELECTRIC SHOCK</b> </div> <ul style="list-style-type: none"> <li>✓ Disconnect or turn off power before installation or servicing.</li> <li>✓ Verify that supply voltage is correct by comparing it with the luminaire label information.</li> <li>✓ Make all electrical and grounded connections in accordance with the National Electrical Code (NEC) and any applicable local code requirements.</li> <li>✓ All wiring connections should be capped with UL approved recognized wire connectors.</li> </ul>	 <div style="border: 1px solid black; padding: 5px; text-align: center; margin: 10px 0;"> <b>WARNING</b>  <b>RISK OF BURN</b> </div> <ul style="list-style-type: none"> <li>✓ Allow lamp/fixture to cool before handling. Do not touch hot lens, lamp, guard, or enclosure.</li> <li>✓ Do not exceed maximum wattage marked on luminaire label.</li> <li>✓ Follow all lamp manufacturer's warnings, recommendations and restrictions on lamp operation including but not limited to: ballast type, burning position, replacement, and recycling.</li> <li>✓ Use only lamps that comply with ANSI standards.</li> </ul>
 <div style="border: 1px solid black; padding: 5px; text-align: center; margin: 10px 0;"> <b>CAUTION</b>  <b>RISK OF INJURY</b> </div> <ul style="list-style-type: none"> <li>✓ Wear gloves and safety glasses at all times when removing luminaire from carton, installing, servicing or performing maintenance.</li> <li>✓ Avoid direct eye exposure to the light source while it is on.</li> </ul>	 <div style="border: 1px solid black; padding: 5px; text-align: center; margin: 10px 0;"> <b>CAUTION</b>  <b>RISK OF FIRE</b> </div> <ul style="list-style-type: none"> <li>✓ Keep combustible and other materials that can burn away from lamp/lens.</li> <li>✓ Do not operate in close proximity to persons, combustible materials or substances affected by heat or drying.</li> </ul>

**Please see product specific installation instructions for additional warnings or any applicable FCC or other regulatory statements.**

**Failure to follow any of these instructions could void product warranties.**

**For a complete listing of product Terms and Conditions, please visit [www.acuitybrands.com](http://www.acuitybrands.com).**

<b>Our Brands</b>	Indoor/Outdoor Lithonia Lighting Carandini Holophane RELOC Light Concepts	Indoor Lighting Gotham Mark Architectural Lighting Peerless Renaissance Lighting Winona Lighting	Outdoor Lighting American Electric Lighting Antique Street Lamps Hydrel Tersen	Controls DARK TO LIGHT LC&D ROAM Sensor Switch Synergy	Daylighting SunOptics
-------------------	--	---	--	---	--------------------------

Acuity Brands Lighting, Inc. assumes no responsibility for claims arising out of improper or careless installation or handling of its products.

© 2010 Acuity Brands Lighting, Inc. All rights reserved. 12/01/10 ABL General Warnings, Form No. 503.204

## READ AND FOLLOW ALL SAFETY INSTRUCTIONS! SAVE THESE INSTRUCTIONS AND DELIVER TO OWNER AFTER INSTALLATION

- To reduce the risk of death, personal injury or property damage from fire, electric shock, falling parts, cuts/abrasions, and other hazards please read all warnings and instructions included with and on the fixture box and all fixture labels.
- Before installing, servicing, or performing routine maintenance upon this equipment, follow these general precautions.
- Installation and service should be performed by a **qualified licensed electrician**.
- Maintenance should be performed by qualified person(s) familiar with the products' construction and operation and any hazards involved. Regular maintenance programs are recommended.
- **DO NOT INSTALL DAMAGED PRODUCT!** This product has been properly packed so that no parts should have been damaged during transit. Inspect to confirm. Any part damaged or broken during or after assembly should be replaced.
- These instructions do not purport to cover all details or variations in equipment nor to provide every possible contingency to meet in connection with installation, operation, or maintenance. Should further information be desired or should particular problems arise which are not covered sufficiently for the purchaser's or owner's purposes, this matter should be referred to Acuity Brands Lighting, Inc.



### WARNING RISK OF ELECTRIC SHOCK

- ✓ Disconnect or turn off power before installation or servicing.
- ✓ Verify that supply voltage is correct by comparing it with the product information.
- ✓ Make all electrical and grounded connections in accordance with the National Electrical Code (NEC) and any applicable local code requirements.
- ✓ All wiring connections should be capped with UL approved recognized wire connectors.
- ✓ All unused connector openings must be capped.



### WARNING RISK OF BURN or FIRE

- ✓ Do not exceed maximum wattage, ratings, or published operating conditions of product.
- ✓ Do not overload.
- ✓ Follow all manufacturer's warnings, recommendations and restrictions to ensure proper operation of product.



### CAUTION RISK OF INJURY

- ✓ Wear gloves and safety glasses at all times when installing, servicing or performing maintenance.

**Always read the fixtures complete installation instructions prior to installation for any additional fixture specific warnings.**

**Failure to follow any of these instructions could void product warranties. For a complete listing of product Terms and Conditions, please visit [www.acuitybrands.com](http://www.acuitybrands.com).**

#### Our Brands

Indoor/Outdoor  
Lithonia Lighting  
Carandini  
Holophane  
RELOC  
Light Concepts

Indoor Lighting  
Gotham  
Mark Architectural Lighting  
Peerless  
Renaissance Lighting  
Winona Lighting

Outdoor Lighting  
American Electric Lighting  
Antique Street Lamps  
Hydrel  
Tersen

Controls  
DARK TO LIGHT  
LC&D  
ROAM  
Sensor Switch  
Synergy

Daylighting  
SunOptics

**Acuity Brands Lighting, Inc. assumes no responsibility for claims arising out of improper or careless installation or handling of its products.**

ABL LED General Warnings, Form No. 503.203

© 2010 Acuity Brands Lighting, Inc. All rights reserved. 12/01/10



## CAUTION: RISK OF PRODUCT DAMAGE

- ✓ Electrostatic Discharge (ESD): ESD can damage product(s). Personal grounding equipment must be worn during all installation or servicing of the unit.
- ✓ Do not touch individual electrical components as this can cause ESD and affect product performance.
- ✓ Do not stretch or use cable sets that are too short or are of insufficient length.
- ✓ Do not tamper with contacts.
- ✓ Do not modify the product.
- ✓ Do not change or alter internal wiring or installation circuitry.
- ✓ Do not use product for anything other than its intended use.
- ✓ If installing latching springs: ensure that the springs are fully engaged prior to moving to next connection.
- ✓ If installing wiring systems: Materials and component parts of a manufacturing wiring system as described in Article 604 of the National Electric Code and Underwriters Laboratories Standard for Safety #183 **MUST BE** installed.

**Please see product specific installation instructions for additional warnings or any applicable FCC or other regulatory statements.**

**Failure to follow any of these instructions could void product warranties. For a complete listing of product Terms and Conditions, please visit [www.acuitybrands.com](http://www.acuitybrands.com).**

Our Brands	Indoor/Outdoor	Indoor Lighting	Outdoor Lighting	Controls	Daylighting
	Lithonia Lighting	Gotham	American Electric Lighting	DARK TO LIGHT	SunOptics
	Carandini	Mark Architectural Lighting	Antique Street Lamps	LC&D	
	Holophane	Peerless	Hydrel	ROAM	
	RELOC	Renaissance Lighting	Tersen	Sensor Switch	
	Light Concepts	Winona Lighting		SynergySwitch	

**Acuity Brands Lighting, Inc. assumes no responsibility for claims arising out of improper or careless installation or handling of its products.**

ABL LED General Warnings, Form No. 503.203

© 2010 Acuity Brands Lighting, Inc. All rights reserved. 12/01/1

**READ AND FOLLOW ALL SAFETY INSTRUCTIONS!**  
**SAVE THESE INSTRUCTIONS AND DELIVER TO OWNER AFTER INSTALLATION**

- To reduce the risk of death, personal injury or property damage from fire, electric shock, falling parts, cuts/abrasions, and other hazards please read all warnings and instructions included with and on the fixture box and all fixture labels.
- Before installing, servicing, or performing routine maintenance upon this equipment, follow these general precautions.
- Installation and service of luminaires should be performed by a **qualified licensed electrician**.
- Maintenance of the luminaires should be performed by person(s) familiar with the luminaires' construction and operation and any hazards involved. Regular fixture maintenance programs are recommended.
- It will occasionally be necessary to clean the outside of the refractor/lens. Frequency of cleaning will depend on ambient dirt level and minimum light output which is acceptable to user. Refractor/lens should be washed in a solution of warm water and any mild, non-abrasive household detergent, rinsed with clean water and wiped dry. Should optical assembly become dirty on the inside, wipe refractor/lens and clean in above manner, replacing damaged gaskets as necessary.
- **DO NOT INSTALL DAMAGED PRODUCT!** This luminaire has been properly packed so that no parts should have been damaged during transit. Inspect to confirm. Any part damaged or broken during or after assembly should be replaced.
- Recycle: For information on how to recycle LED electronic products, please visit [www.epa.gov](http://www.epa.gov).
- These instructions do not purport to cover all details or variations in equipment nor to provide every possible contingency to meet in connection with installation, operation, or maintenance. Should further information be desired or should particular problems arise which are not covered sufficiently for the purchaser's or owner's purposes, this matter should be referred to Acuity Brands Lighting, Inc.



**WARNING**  
**RISK OF ELECTRIC SHOCK**

- ✓ Disconnect or turn off power before installation or servicing.
- ✓ Verify that supply voltage is correct by comparing it with the luminaire label information.
- ✓ Make all electrical and grounded connections in accordance with the National Electrical Code (NEC) and any applicable local code requirements.
- ✓ All wiring connections should be capped with UL approved recognized wire connectors.



**WARNING**  
**RISK OF BURN**

- ✓ Allow lamp/fixture to cool before handling. Do not touch enclosure or light source.
- ✓ Do not exceed maximum wattage marked on luminaire label.
- ✓ Follow all manufacturer's warnings, recommendations and restrictions for: driver type, burning position, mounting locations/methods, replacement and recycling.



**CAUTION**  
**RISK OF INJURY**

- ✓ Wear gloves and safety glasses at all times when removing luminaire from carton, installing, servicing or performing maintenance.
- ✓ Avoid direct eye exposure to the light source while it is on.



**CAUTION**  
**RISK OF FIRE**

- ✓ Keep combustible and other materials that can burn, away from lamp/lens.
- ✓ Do not operate in close proximity to persons, combustible materials or substances affected by heat or drying.



### CAUTION: RISK OF PRODUCT DAMAGE

- ✓ Never connect components under load.
- ✓ Do not mount or support these fixtures in a manner that can cut the outer jacket or damage wire insulation.
- ✓ Unless individual product specifications deem otherwise: Never connect an LED product directly to a dimmer packs, occupancy sensors, timing devices, or other related control devices. LED fixtures must be powered directly off a switched circuit.
- ✓ Unless individual product specifications deem otherwise: Do not restrict fixture ventilation. Allow for some volume of airspace around fixture. Avoid covering LED fixtures with insulation, foam, or other material that will prevent convection or conduction cooling.
- ✓ Unless individual product specifications deem otherwise: Do not exceed fixtures maximum ambient temperature.
- ✓ Only use fixture in its intended location.
- ✓ LED products are Polarity Sensitive. Ensure proper Polarity before installation.
- ✓ Electrostatic Discharge (ESD): ESD can damage LED fixtures. Personal grounding equipment must be worn during all installation or servicing of the unit.
- ✓ Do not touch individual electrical components as this can cause ESD, shorten lamp life, or alter performance.
- ✓ Some components inside the fixture may not be serviceable. In the unlikely event your unit may require service, stop using the unit immediately and contact an ABL representative for assistance.
- ✓ Always read the fixtures complete installation instructions prior to installation for any additional fixture specific warnings.

Please see product specific installation instructions for additional warnings or any applicable FCC or other regulatory statements.

Failure to follow any of these instructions could void product warranties. For a complete listing of product Terms and Conditions, please visit [www.acuitybrands.com](http://www.acuitybrands.com).

Our Brands	Indoor/Outdoor	Indoor Lighting	Outdoor Lighting	Controls	Daylighting
	Lithonia Lighting	Gotham	American Electric Lighting	DARK TO LIGHT	SunOptics
	Carandini	Mark Architectural Lighting	Antique Street Lamps	LC&D	
	Holophane	Peerless	Hydrel	ROAM	
	RELOC	Renaissance Lighting	Tersen	Sensor Switch	
	Light Concepts	Winona Lighting		Synergy	

Acuity Brands Lighting, Inc. assumes no responsibility for claims arising out of improper or careless installation or handling of its products.

ABL LED General Warnings, Form No. 503.203

© 2010 Acuity Brands Lighting, Inc. All rights reserved. 12/01/1

## FIXTURE OPTIONS & PARTS:

(not all options are available on all lengths or families)

ON-OFF ROCKER  
SWITCH (S1)



CONVENIENCE OUTLET (CO)  
HUC5 (LED) 120V ONLY- 50W MAX LOAD

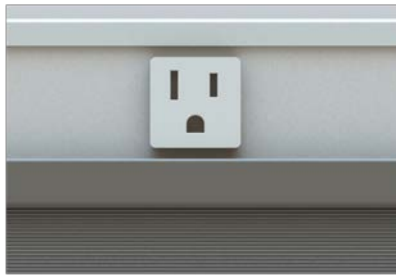

OCCUPANCY SENSOR (OS)  
SEE PAGE 10

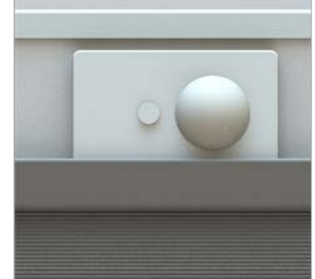

## LINKING CONNECTORS (LX, LX6, LX12, LX24):

- LX OPTION INCLUDES LINKING CONNECTORS AND 1 JUMPER PER FIXTURE.
- LX6, LX12, OR LX24 OPTION INCLUDE LINKING CONNECTORS & 1 LINKING CABLE ASSEMBLY OF APPROPRIATE LENGTH PER FIXTURE.
- ALL LINKING OPTIONS RATED 120V-277V.
- 5 POLE HUC5 (LED) VERSIONS SHOWN BELOW. FLUORESCENT FIXTURES USE 3 POLE CONNECTORS.
- LX WITH JUMPER DOES NOT USE LOCKING TABS. LX6, LX12, OR LX24 WITH CABLE ASSEMBLIES USE LOCKING TABS TO KEEP CABLES IN PLACE.
- LOCKING TABS ARE REPLACEABLE OR REMOVABLE BY OPENING THE FIXTURE. CONTACT FACTORY FOR DETAILS.
- **LINKING CONNECTOR OPTIONS ARE THE ONLY APPROVED WAY TO CREATE MULTI-FIXTURE RUNS. DO NOT ATTEMPT TO THRU WIRE.**
- **POWER MUST BE OFF TO ALL FIXTURES IN A RUN BEFORE CONNECTING OR DISCONNECTING LINKING CONNECTORS OF ANY TYPE.**
- **FLUORESCENT – 18 FIXTURES MAX IN A RUN.**
- **HUC5, LED - 25 FIXTURES MAX IN A RUN WHEN NO CONVENIENCE OUTLET SPECIFIED.**
- **HUC5, LED - 9 FIXTURES MAX IN A RUN WHEN CONVENIENCE OUTLET OPTION SPECIFIED.**
- **IF LINKING IS SPECIFIED WITH CONVENIENCE OUTLET (120V ONLY) - MAX LOAD ON ANY ONE OUTLET IS 50 WATTS.**

LEFT SIDE LINKING CONNECTOR



RIGHT SIDE LINKING CONNECTOR



JUMPER



LOCKING TAB  
(REMOVABLE & REPLACEABLE)

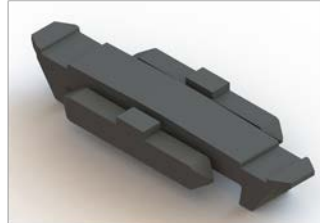

LINKING CABLE ASSEMBLY



## Installation of single fixture (no linking connector LX option)

### Step 1

Remove lens. See figure 1a and figure 1b.

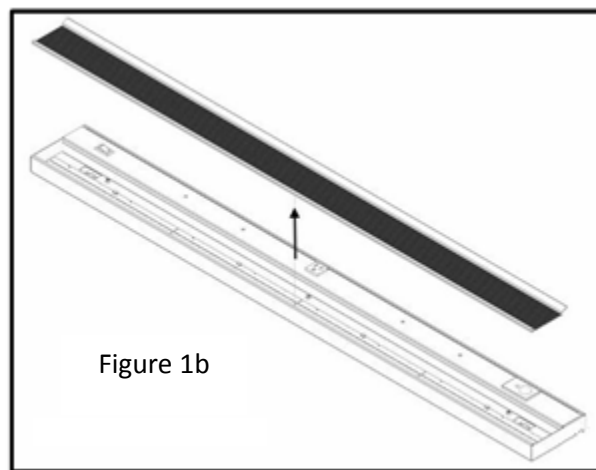
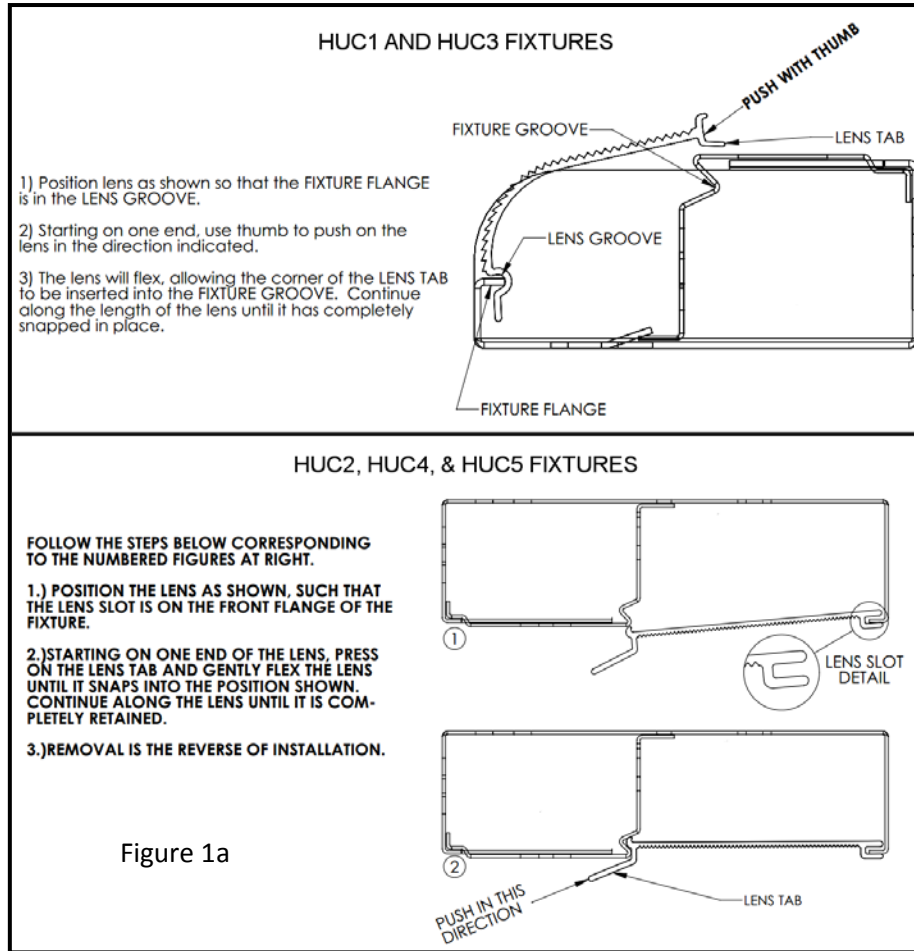

## Step 2

Remove electronics cover from fixture.  
See figure 2.

## Step 3

**Note:** It may be easier to attach the base to the mounting surface before making electrical connections, in that case perform step 5 before steps 3 and 4.

Remove knockout where line voltage electrical connection is to be made to building supply. Only knockouts on rear of fixture are to be used to supply power. See figure 3.

See below for knockout dimensions.

Connect building supply conductors to free ends of fixture supply leads (hot, neutral, and ground) using the wire nuts that are capping off the fixture leads (or other approved wiring devices).

If dimming has been specified connect appropriate dimming wires. For fluorescent fixtures consult specific dimming ballast for wiring instructions.

LED fixtures (HUC5) support 0-10V dimming systems (current sinking type dimmers) and will dim down to 10% brightness. Connect fixture pink (-) to dimmer pink and fixture purple (+) to dimmer purple.

If linking cables or connectors are being used power and dimming (HUC5 LED only) only need to be wired to the first fixture in a run. The linking connectors will pass the power and dimming (HUC5 only) signal down the chain of fixtures and all fixtures in a run will dim together.

Low voltage dimming wiring may need to run in separate conduit from line voltage wiring - **ensure all wiring is in accordance with the National Electrical Code (NEC) and any applicable local code requirements and performed by a qualified electrician.**

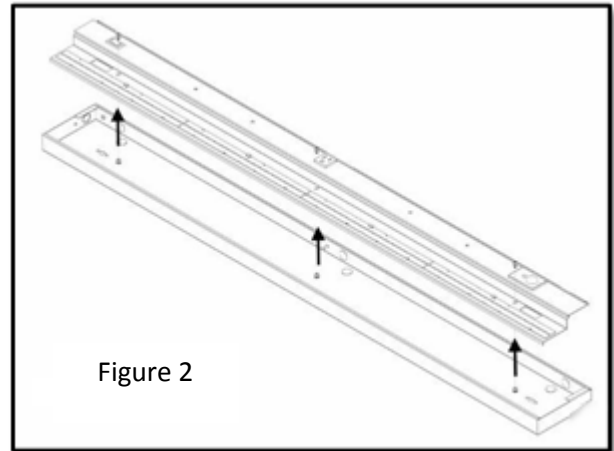

Figure 2

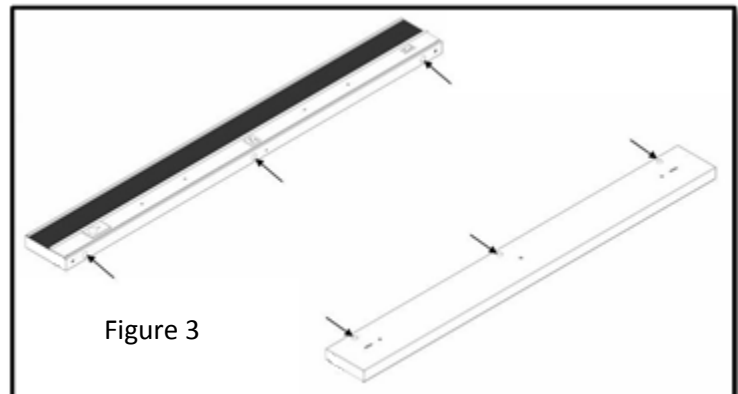
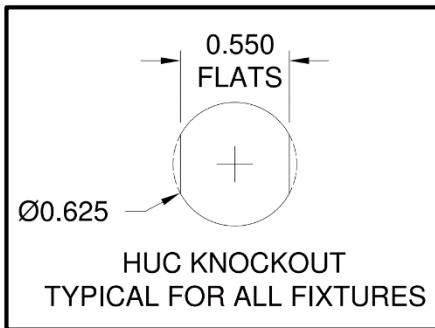

Figure 3

## Step 4

Re-install electronics cover.  
See figure 4.

## Step 5

Secure fixture to mounting surface by inserting screws (not provided) into keyhole mounting slots. See figure 5.

See below for keyhole mounting slot dimensions.

Size #8 screws (by others) recommended.

**Cabinet and shelf materials and thicknesses vary widely – therefore it is the responsibility of the contractor installing the fixture to select mounting hardware that is suitable for the surface to which the fixture is being mounted.**

Fastener heads should pass through the large center of the keyhole slot but not through the small ends. Proper screw length should be selected to avoid screw points protruding through far side of mounting surface.

## Step 6

Re-install lens. See figure 6 and figure 1a.

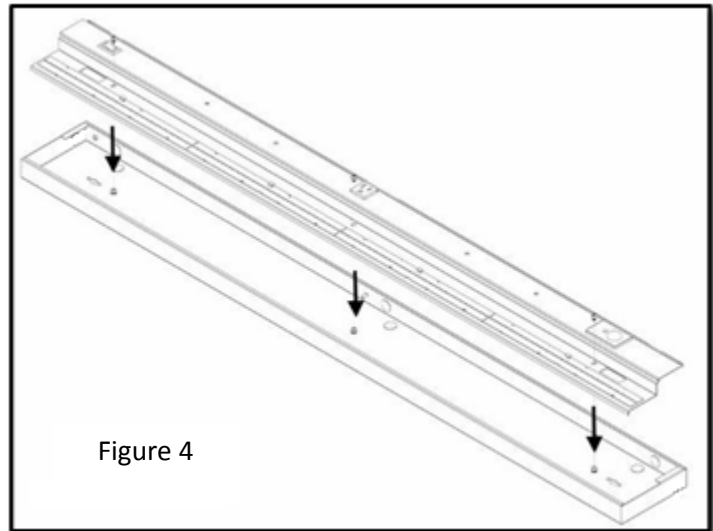

Figure 4

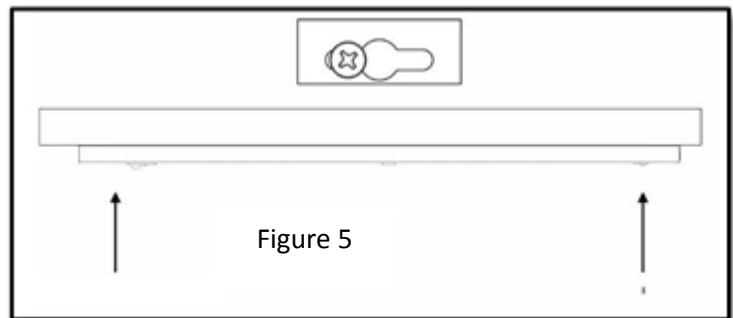

Figure 5

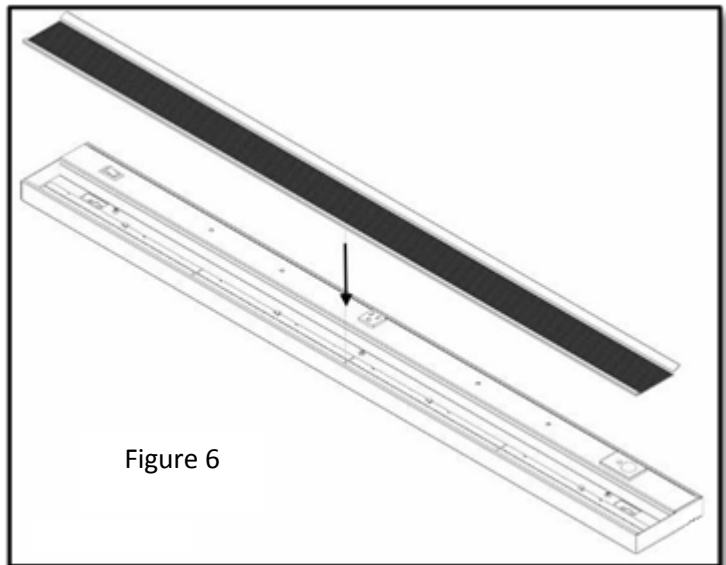
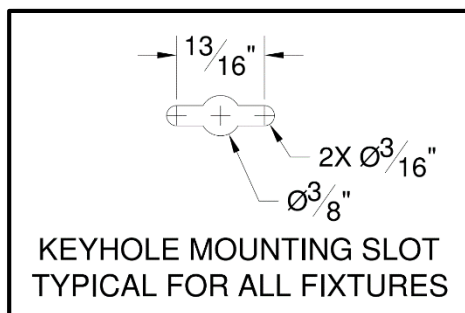

Figure 6



**NOTE:** The small button on the Occupancy Sensor is for programming settings, it is not an on-off switch.

If the fixture includes both a rocker switch and an occupancy sensor – the fixture is wired so that it will only operate if the switch is turned ON. The occupancy sensor will turn the light on and off when it senses an occupant, per the sensor settings, described below. If the switch is turned OFF, the sensor will not operate.

**OCCUPANCY SENSOR:** This fixture is equipped with a SFR 7 occupancy sensor, manufactured by Sensor Switch for Healthcare Lighting. This sensor is suitable for fluorescent or LED luminaires.

Programming instructions: Please read all 4 steps before programming. The \*starred\* values are the default.

Function table 2 = time delay function

(The length of time the sensor will keep the lights after it detects the last motion. This assumes the minimum on time has been met)

1 = 30 Sec	2 = 2.5 Minute	3 = 5 Minute	4 = 7.5 Minute	*5 = 10 Minute*
6 = 12.5 Minute	7 = 15 Minute	8 = 17.5 Minute	9 = 20 Minute	

Function table 4 = test mode and burn-in (primarily for fluorescent)

100-hr burn-in overrides the relay for the first 100 hours of operation for (fluorescent) lamp seasoning; the LED will blink continuously.

Test Mode disables the minimum on time for a 10 minute test period, and sets the time delay to 30 seconds

*1 = Normal*	2 = 100-hr burn-in	6 = Test Mode
--------------	--------------------	---------------

Function table 10 = minimum on time

Length of time required for lamps to remain on to prevent frequent on-off cycling (which shortens fluorescent lamp life). Lamps will remain on until the minimum time passes or the time delay after occupancy passes.

1 = 0 Minutes	*2 = 15 Minutes*	3 = 30 Minutes	4 = 45 Minute	5 = 60 Minutes
---------------	------------------	----------------	---------------	----------------

1. Enter a specific programming function by pressing the small button on the sensor the number of times equal to the desired function number (2 for time delay, 4 for test mode, and 10 for minimum on time)
2. The selected function's current setting will then be indicated by the number of times the small LED in the sensor flashes. (i.e. – five flashes indicates the default 10 minute time delay)
3. If the current setting is not what is desired, while the sensor is flashing the current setting, and before it repeats the sequence 3 times, interrupt the flashing by pressing the small button the number of times for the new desired setting (i.e. - press the button one time to set the time delay to 30 seconds). The sensor will flash back this new setting number as confirmation.
4. Once the new setting has flashed back 3 times, the sensor will exit the programming mode and the sensor status LED will revert back to its operating mode – flashing when occupancy is detected.  
To exit programming mode without saving, or to change to a different function, wait for the blink-back sequence to repeat 3 times, then return to step 1

**Mounting the fixtures end to end with no linking cable between fixtures (LX option)**  
If linking cables, LX6, LX12, or LX24, are to be used skip to page 12 of the instructions.

**WARNING:**

- ❖ **POWER MUST BE OFF TO ALL FIXTURES IN A RUN BEFORE CONNECTING OR DISCONNECTING LINKING CONNECTORS OF ANY TYPE.**
- ❖ **FLUORESCENT – 18 FIXTURES MAX IN A RUN.**
- ❖ **HUC5, LED - 25 FIXTURES MAX IN A RUN WHEN NO CONVENIENCE OUTLET SPECIFIED.**
- ❖ **HUC5, LED - 9 FIXTURES MAX IN A RUN WHEN CONVENIENCE OUTLET OPTION SPECIFIED.**
- ❖ **IF SPECIFIED WITH CONVENIENCE OUTLET - MAX LOAD ON ANY ONE OUTLET IS 50 WATTS.**

### Step 7

Notes: When connected the gap between fixtures will be about 0.35 inches.

Locking tabs on the linking connectors will not work with the jumper connector

- Firmly insert jumper connector into mating connector of the first fixture in the run.  
Firmly insert exposed end of coupling connector into next fixture in the run.
- Mount the rest of fixtures as described above and continue with fixture run in the same manner.

See figure 7.

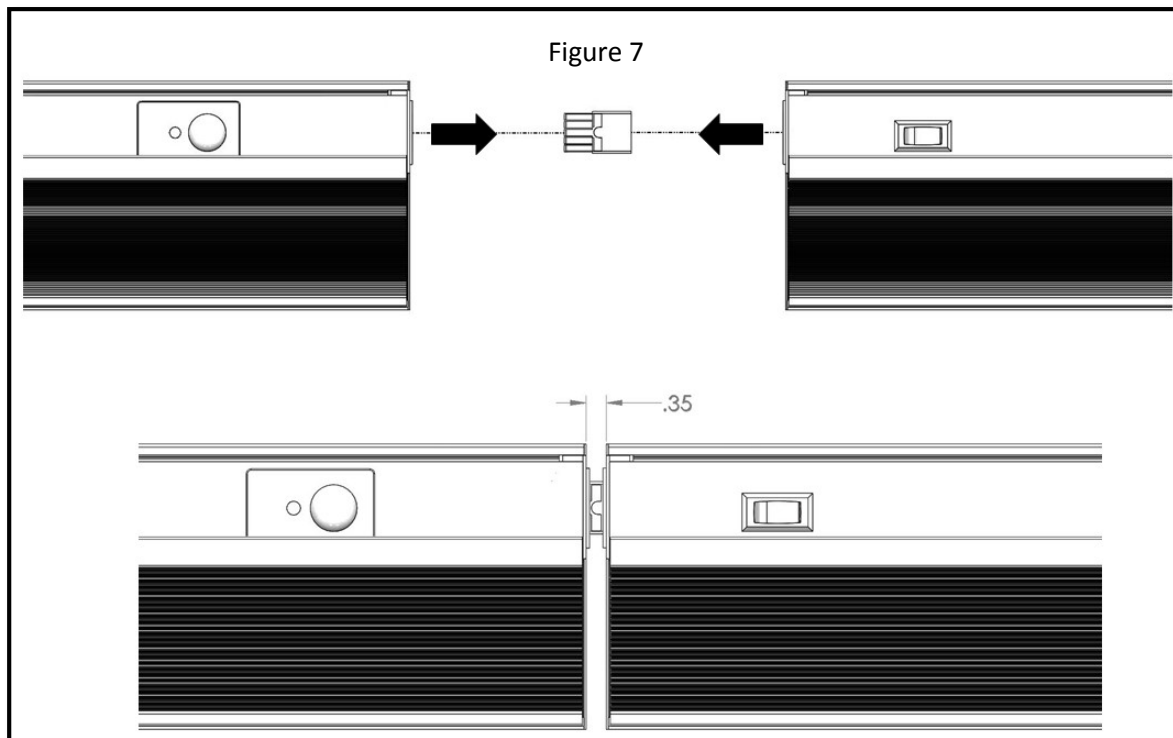

**Mounting the fixtures in a run with linking cables between fixtures (LX6, LX12, LX24 option)****WARNING:**

- ❖ **POWER MUST BE OFF TO ALL FIXTURES IN A RUN BEFORE CONNECTING OR DISCONNECTING LINKING CONNECTORS OF ANY TYPE.**
- ❖ **FLUORESCENT – 18 FIXTURES MAX IN A RUN.**
- ❖ **HUC5, LED - 25 FIXTURES MAX IN A RUN WHEN NO CONVENIENCE OUTLET SPECIFIED.**
- ❖ **HUC5, LED - 9 FIXTURES MAX IN A RUN WHEN CONVENIENCE OUTLET OPTION SPECIFIED.**
- ❖ **IF SPECIFIED WITH CONVENIENCE OUTLET - MAX LOAD ON ANY ONE OUTLET IS 50 WATTS.**

**Step 8**

- Note – once connected the linking cable locking tabs are fairly difficult to disengage. Ensure everything is correct before proceeding.
- Firmly insert one side of the linking cable into the matching connector of the first fixture. Ensure locking tabs of power connectors are properly engaged. Firmly insert and secure other side of linking cable into the next fixture in the run, again ensuring locking tabs are engaged.
- Mount the rest of fixtures as described above and continue with fixture run in the same manner.

See figure 8.

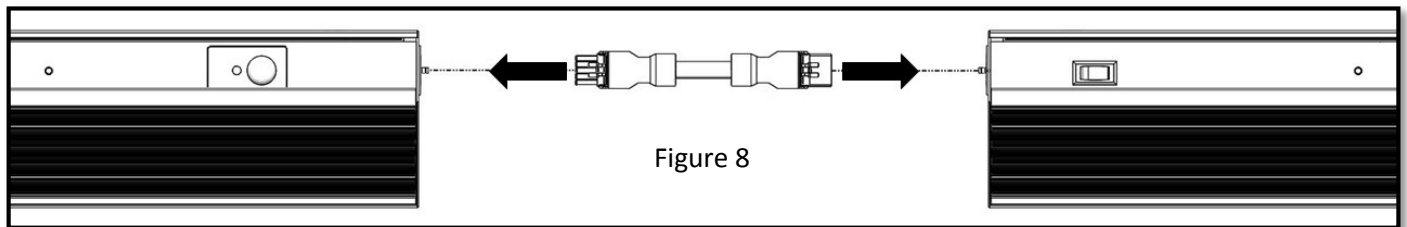

Figure 8

**Instructions for removing LX cabled connections****WARNING:**

- ❖ **POWER MUST BE OFF TO ALL FIXTURES IN A RUN BEFORE CONNECTING OR DISCONNECTING LINKING CONNECTORS OF ANY TYPE.**
- ❖ **FLUORESCENT – 18 FIXTURES MAX IN A RUN.**
- ❖ **HUC5, LED - 25 FIXTURES MAX IN A RUN WHEN NO CONVENIENCE OUTLET SPECIFIED.**
- ❖ **HUC5, LED - 9 FIXTURES MAX IN A RUN WHEN CONVENIENCE OUTLET OPTION SPECIFIED.**
- ❖ **IF SPECIFIED WITH CONVENIENCE OUTLET - MAX LOAD ON ANY ONE OUTLET IS 50 WATTS.**

**Step 1**

- Insert a small flat head screw driver under the angled head of the connector locking tab.
- Using the flat head screw driver pry the head of the locking tab away from the connector until it clears the linking cable connector.
- While still holding the locking tab away from the connector, remove the linking cable from the fixture.
- Repeat as necessary.

See figure 9

Note: locking tabs are replaceable and available from the factory.

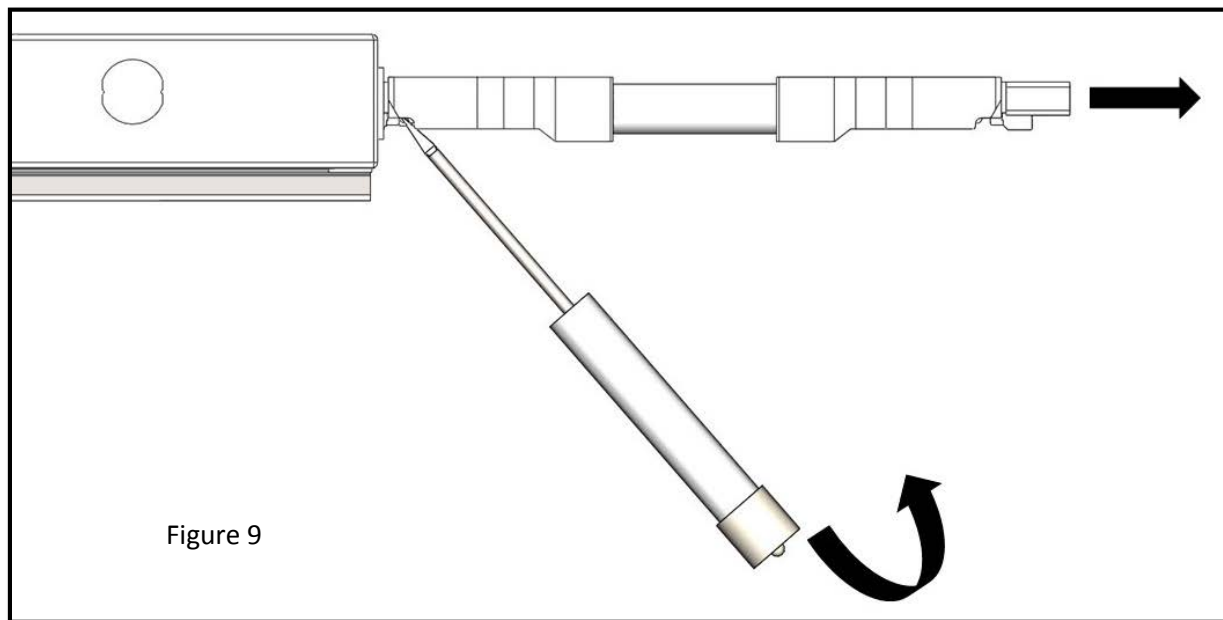

Figure 9