

## FEATURES & SPECIFICATIONS

**INTENDED USE** — Architectural deep-cast luminaire provides general illumination for rough service (vandal resistant) applications. Ideal for interior or exterior applications where safety and security are a concern. Amber LEDs available for applications requiring turtle-safe lighting. Certain airborne contaminants can diminish integrity of acrylic. Designed to complement building architecture and to endure extreme environmental conditions and physical abuse. [Click here for Acrylic Environmental Compatibility table for suitable uses.](#)

**CONSTRUCTION** — *Bezel* - One-piece, die-cast aluminum, low copper alloy (<1% copper). Encloses lens and secures to housing with stainless steel Torx® T-10 set screws (two included) or optional stainless steel tamper-resistant screws (see Options).

*Housing* - One-piece, die-cast aluminum, low copper alloy (<1% copper), with post-painted polyester powder coat finish. Four hole mounting detail for use directly over outlet box, or conduit entry through three 1/2" threaded openings on side or 3/4" threaded opening on rear surface. .012 gauge aluminum sheet metal internal bracket and board plate for thermal conduction and support.

*Gasket* - Polycarbonate: Perimeter lens gasket is one-piece silicone "O" ring, mechanically held in lens channel. Glass: Perimeter lens gasket is closed-cell silicone. Pad mounting gasket is closed-cell neoprene and seals housing to mounting surface. Gaskets help cushion impact shock.

*Finish* - Standard finish is textured polyester powder coat in white, black or bronze. Optional architectural colors available (see paint finishes).

**OPTICS** — *Polycarbonate lens* — Injection-molded lens is .125 inch thick. Designed to enrich the LED color and lumen output. Smooth exterior allows for easy cleaning, and interior pattern diffuses light for even surface illumination.

**ELECTRICAL** — Utilizes high-efficiency LEDs mounted to 1 metal core circuit board. 3500 Kelvin temperature. Driver: 2 electronic drivers wired in parallel allows total power to be reduced by half while maintaining even illumination across the board. 70% lumen maintenance at 50,000 hours. 100V through 277V, 50-60HZ operation. 6KV pulse rated. Initial surge protection standard.

**INSTALLATION** — Unit may be wall mounted.

**LISTINGS** — CSA Certified to UL and C-UL standards. NOM Certified (see Options). CSA listed for 40°C ambient and wet locations. IP65 rated.

**GOVERNMENT PROCUREMENT** — BAA — Buy America(n) Act: Product qualifies as a domestic end product under the Buy American Act as implemented in the FAR and DFARS. Product also qualifies as manufactured in the United States under DOT Buy America regulations.

BABA — Build America Buy America: Product qualifies as produced in the United States under the definitions of the Build America, Buy America Act.

Please refer to [www.acuitybrands.com/buy-american](http://www.acuitybrands.com/buy-american) for additional information.

**WARRANTY** — 5-year limited warranty. Complete warranty terms located at:

[www.acuitybrands.com/support/warranty/terms-and-conditions](http://www.acuitybrands.com/support/warranty/terms-and-conditions)

For installed Rough Service Product(s), Acuity warrants that, for the lifetime of the product(s), the polycarbonate lens and/or polycarbonate housing will withstand breakage resulting from occasional physical abuse and rough handling (the "Rough Service Warranty"), notwithstanding the vandalism exclusion set forth at [www.acuitybrands.com/support/warranty/terms-and-conditions](http://www.acuitybrands.com/support/warranty/terms-and-conditions)

**NOTE:** Actual performance may differ as a result of end-user environment and application.

All values are design or typical values, measured under laboratory conditions at 25 °C.

Specifications subject to change without notice.

Catalog Number
Notes
Type



# GATEWAY®

Architectural Rough Service Fixture

## VG03C



LED  
Oval Vertical Eyelid  
Deep Housing  
Wall Mounted

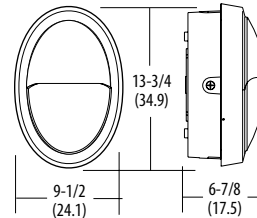

All dimensions are inches (centimeters).

### ORDERING INFORMATION

For shortest lead times, configure products using **bolded options**.

**Example: VG03C 25LED MVOLT DBLB LPI**

Series	Lumen output <sup>1</sup> /Color temperature <sup>2</sup>	Lens	Voltage	Paint finishes <sup>3</sup>	Options	Lamp
<b>VG03C</b>	<b>Lumen output<sup>1</sup></b> 25LED 25W <b>Color temperature<sup>2</sup></b> (blank) 3500K	(blank) Polycarbonate	<b>120</b> <b>277</b> <b>MVOLT</b>	<b>Standard textured finishes</b> <b>DWHG</b> White <b>DBLB</b> Black <b>DDBT</b> Dark bronze <b>DNAT</b> Natural aluminum <b>DSST</b> Sandstone	<b>Shipped installed in fixture</b> <b>DF</b> Double fuse <sup>4,5</sup> <b>SF</b> Single fuse <sup>5</sup> <b>DS</b> Dual switching <sup>6</sup> <b>MSI8</b> Wet location motion sensor <sup>5,7</sup> <b>PE</b> Photoelectric cell <sup>5,8</sup> <b>TRS</b> Tamper-resistant screws <sup>9</sup> <b>NOM</b> Meets Mexican standards <b>BAA</b> Buy America(n) Act Compliant	<b>LPI</b> Lamp included

**Accessories:** Order as separate catalog number.

- RK1 T10DRV Torx TX10 screwdriver, for use with Gateway set screws.
- RK1 T20BIT Hex-base driver bit, Torx TX20, for tamper-resistant screws with center reject pin.
- RK1 T20DRV Torx TX20 screwdriver for use with tamper-resistant screws with center reject pin.

### Notes

- Refer to table on back page.
- The CCT value provided is of lamp source and actual CCT will vary upon power levels.
- For additional colors, refer to Architectural Paint brochure.
- Must specify DS option.
- Must specify voltage. Not available with MVOLT.
- Not available with SF or PE options.
- Provided with lens for mounting up to 8'.
- Not available with DS option.
- T-20 screws with center reject pin.

# VG03C Rough Service Ceiling/Wall-Mounted Fixture, LED

---

System watts	Initial delivered lumens through polycarbonate lens*	Initial delivered lumens through glass lens*	mA	Ambient temperature °C
	3500K	3500K		
25	595	385	507	40

\* 3500K is LED CCT