

## OVERVIEW

The Universal 360° Snap Fit sensor is a compact line voltage sensor that snaps directly into a small cavity in a fixture. The sensor utilizes Passive Infrared (PIR) detection to detect motion from occupants within its 360° coverage pattern that overlaps that of most HID, T-5, T-8, or LED fixtures used in high bay or low bay applications.

## SENSOR OPERATION

The sensor detects changes in the infrared energy given off by occupants as they move within the field-of-view. When occupancy is detected, a self-contained relay switches the connected lighting load on. The sensor is line powered, switches line voltage, and requires no field calibration or sensitivity adjustments.

## LAMP MAXIMIZER®

This sensor also contains patented LampMaximizer technology that allows users to aggressively target energy savings while still protecting lamp life. A minimum on timer, factory set at 15 minutes, helps preserve lamp life by eliminating all lamp cycles shorter than lamp manufacturers' recommendations.

A standard occupancy time delay is also present that ensures lights turn off (assuming minimum on timer has elapsed) if no occupancy is detected. This timer is factory set at 10 minutes to promote energy savings, but is adjustable between 30 seconds and 30 minutes. These adjustments can be done manually, through the unit's push-button; no tools required.

## FEATURES

- Self-Contained Relay, No Power Pack Needed
- No Minimum Load Requirements
- Interchangeable Hot & Load Wires, Impossible to Wire Backwards
- Push-Button Programmable
- Adjustable Time Delays
- No Field Calibration or Sensitivity Adjustments Required
- Convenient Test Mode
- 100 hr Lamp Burn-in Timer

## Warranty

Five-year limited warranty. Complete warranty terms located at:

[www.acuitybrands.com/CustomerResources/Terms\\_and\\_conditions.aspx](http://www.acuitybrands.com/CustomerResources/Terms_and_conditions.aspx)

**Note:** Actual performance may differ as a result of end-user environment and application. Specifications subject to change without notice



*SFR 30*

*Universal 360° Sensor*



## ORDERING INFORMATION

SFR 30		Example: SFR 30 LT	
Series	Voltage	Temperature / Humidity	
SFR 30 Snap Fit Enclosure	[blank] 120/277 VAC 347 347 VAC	[blank] Standard LT Low Temp	

## COVERAGE PATTERN

### UNIVERSAL 360° LENS

- Provides excellent detection of large motion (e.g. walking) when mounted between 15 to 40 ft (4.57 to 12.19 m)
- 15 to 20 ft (4.57 to 6.10 m) radial coverage overlaps area lit by a typical high bay fixture
- Recommended for fixtures that have a 1:1 spacing to mounting height ratio or less (e.g. fixtures 30' on center or less @ a 30' mounting height).

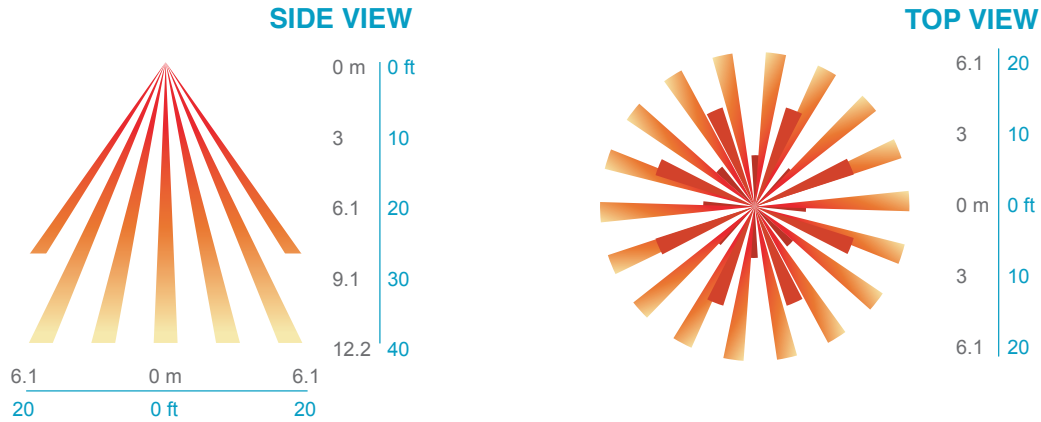

### WIRING (DO NOT WIRE HOT)

#### STANDARD WIRING

- BLACK\* - Line Input
  - BLACK\* - Load Output
  - WHITE - Neutral
- \*BLACK wires can be reversed

#### 347 VAC OPTION

Black wires are replaced w/ Red wires

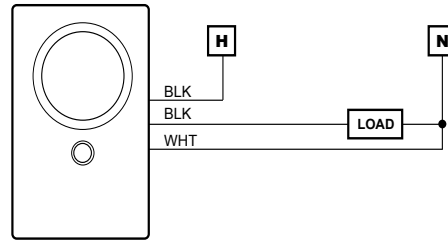

### INITIAL POWER UP

The sensor's relay is shipped in a latched closed position so the lights will come on upon initial power-up. If the lights do not immediately turn on (initial installation only) the latching relay opened during shipment and will close within 30 secs.

**Note:** If the sensor loses power, the internal relay will latch to on.

## INSTALLATION

### MOUNTING

- The snap fit enclosure is designed to fit snugly inside a 2 3/16" H x 1 5/16" W x 1" D cavity in a luminaire.

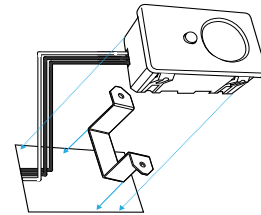
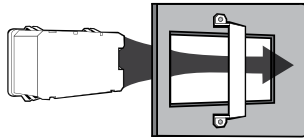
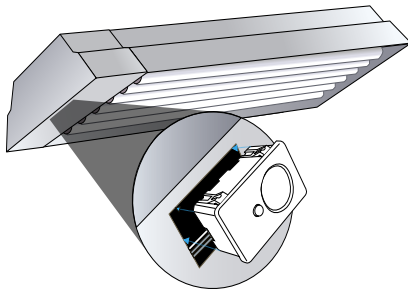

Diagrams show internal cross section of fixture with bracket included for additional sensor impact strength.

- For optimal detection, position sensor such that segments are crossed upon entrance and unable to view outside the space

### PROGRAMMING

Refer to instruction card IC1-002 for default settings and directions on programming the sensor via the push-button.

## SPECIFICATIONS

---

### Electrical

**Input Ratings** 120VAC, 6.6A, 50/60 Hz  
277VAC, 4.3A, 50/60 Hz  
347VAC, 4.3A, 50/60 Hz

**Output Ratings** 120VAC, 800W, 6.7A - Tungsten, Standard Ballast, Electronic Ballast  
277VAC, 1200W, 4.3A - Tungsten, Standard Ballast, Electronic Ballast  
347VAC, 1500W, 4.3A - Tungsten, Standard Ballast, Electronic Ballast  
120, 1/4 HP - Motor (5.8A FLA, 34.8 LRA)  
277, 1/4 HP - Motor (2.4A FLA, 14.4 LRA)  
347VAC, (0.5 FLA, 3LRA)

**Relay Type** Latching

**Standards/ Ratings** Energy Management Equipment, UL916 (E167435)

---

### Mechanical

**Dimensions** 2.25"H x 1.38"W x 0.82" D

**Mounting** Snaps into 2 3/16"H x 1 5/16"W x 1" D cavity in fixture

**Color** White

**Connection Type** Line-Voltage Leads

---

### Environmental

**Warrantied Operating Temperature** Standard: 14°F to 140°F (-10°C to 60°C)  
LT option: -4°F to 140°F (-20°C to 60°C)

**Relative Humidity** Up to 90%, Non-Condensing

**Standards/ Ratings** RoHS, Energy Management Equipment, UL916 (E167435)