

READ AND FOLLOW ALL SAFETY INSTRUCTIONS! SAVE THESE INSTRUCTIONS AND DELIVER TO OWNER AFTER INSTALLATION

- To reduce the risk of death, personal injury or property damage from fire, electric shock, falling parts, cuts/abrasions, and other hazards please read all warnings and instructions included with and on the fixture box and all fixture labels.
- Before installing, servicing, or performing routine maintenance upon this equipment, follow these general precautions.
- Installation and service of luminaires should be performed by a **qualified licensed electrician**.
- Maintenance of the luminaires should be performed by person(s) familiar with the luminaires' construction and operation and any hazards involved. Regular fixture maintenance programs are recommended.
- It will occasionally be necessary to clean the outside of the refractor/lens. Frequency of cleaning will depend on ambient dirt level and minimum light output which is acceptable to user. Refractor/lens should be washed in a solution of warm water and any mild, non-abrasive household detergent, rinsed with clean water and wiped dry. Should optical assembly become dirty on the inside, wipe refractor/lens and clean in above manner, replacing damaged gaskets as necessary.
- **DO NOT INSTALL DAMAGED PRODUCT!** This luminaire has been properly packed so that no parts should have been damaged during transit. Inspect to confirm. Any part damaged or broken during or after assembly should be replaced.
- Recycle: For information on how to recycle LED electronic products, please visit www.epa.gov.
- These instructions do not purport to cover all details or variations in equipment nor to provide every possible contingency to meet in connection with installation, operation, or maintenance. Should further information be desired or should particular problems arise which are not covered sufficiently for the purchaser's or owner's purposes, this matter should be referred to Acuity Brands Lighting, Inc.



WARNING RISK OF ELECTRIC SHOCK

- Disconnect or turn off power before installation or servicing.
- Verify that supply voltage is correct by comparing it with the luminaire label information.
- Make all electrical and grounded connections in accordance with the National Electrical Code (NEC) and any applicable local code requirements.
- All wiring connections should be capped with UL approved recognized wire connectors.



WARNING RISK OF BURN

- Allow lamp/fixture to cool before handling. Do not touch enclosure or light source.
- Do not exceed maximum wattage marked on luminaire label.
- Follow all manufacturer's warnings, recommendations and restrictions for: driver type, burning position, mounting locations/methods, replacement and recycling.



CAUTION RISK OF INJURY

- Wear gloves and safety glasses at all times when removing luminaire from carton, installing, servicing or performing maintenance.
- Avoid direct eye exposure to the light source while it is on.



CAUTION RISK OF FIRE

- Keep combustible and other materials that can burn, away from lamp/lens.
- Do not operate in close proximity to persons, combustible materials or substances affected by heat or drying.



CAUTION: RISK OF PRODUCT DAMAGE

- Never connect components under load.
- Do not mount or support these fixtures in a manner that can cut the outer jacket or damage wire insulation.
- Never connect an LED product to an unapproved dimmer pack. Contact ABL directly for any dimmers not specifically recommended for the product.
- Unless individual product specifications deem otherwise: Allow for some volume of airspace around fixture. Avoid covering LED fixtures with insulation, foam, or other material that will prevent convection or conduction cooling.
- Unless individual product specifications deem otherwise: Maximum ambient temperature is 90°C. Do not operate fixture at temperatures higher than this.
- Unless individual product specifications deem otherwise: Never mount in places where fixture will be exposed to rain, high humidity, extreme temperature changes or restricted ventilation.
- LED products are Polarity Sensitive. Ensure proper Polarity before installation.
- Electrostatic Discharge (ESD): ESD can damage LED fixtures. Personal grounding equipment must be worn during all installation or servicing of the unit.
- Do not touch individual electrical components as this can cause ESD, shorten lamp life, or alter performance.
- There are no user serviceable parts inside the unit. Do not rewire, reconfigure, or modify the unit or attempt any repairs yourself. Additionally, field replacement of the LED assembly or lamps is not allowed by UL standards at this time. In the unlikely event your unit may require service, stop using the unit immediately and contact an ABL representative.

All luminaires that contain electronic devices that generate frequencies above 9kHz from any component within the luminaire comply with one of the following Part 15 of the FCC Rules. Operation is subject to the following two conditions:

- (1) This device may not cause harmful interference
- (2) This device must accept any interference received, including interference that may cause undesired operation.

This device complies with Part 18 of the FCC Rules but may cause interference with cordless and cell phones, radios, televisions, and other electronic devices. To correct the problem move the device away from the luminaire or plug into a different outlet. This product may cause interference to radio equipment and should not be installed near maritime safety communications equipment or other critical navigation or communications equipment operating between 0.45-30MHz.

Failure to follow any of these instructions could void product warranties. For a complete listing of product Terms and Conditions, please visit www.acuitybrands.com.

OUR BRANDS

Indoor/Outdoor: Lithonia Lighting, Carandini, Holophane, RELOC

Indoor Lighting: Gotham, Mark Architectural Lighting, Peerless, Renaissance Lighting, Winona Lighting

Outdoor Lighting: American Electric Lighting, Antique Street Lamps, Hydrel, Tersen

Controls: DARK TO LIGHT, Lighting Control & Design, ROAM, Sensor Switch, Synergy

Acuity Brands Lighting, Inc. assumes no responsibility for claims arising out of improper or careless installation or handling of its products.

ABL LED General Warnings, Form No. 503.203

© 2010 Acuity Brands Lighting, Inc. All rights reserved. 12/01/10

LDN 3" Downlight

INSTALLATION INSTRUCTIONS

These installation instructions are used for installing the following luminaires and kits

Luminaire Variant	Mounting Kits (Shipped Separately)
Round - Catalog # LDN3	none
Square - Catalog # LDN3SQ	none

Identification of the downlight luminaire	Page 2
Identification of the variants	Page 3
Installation of round variant	Page 3
Notes regarding alignment of the square luminaire variant	Page 5

A) Identification of Round Downlight Luminaire Part

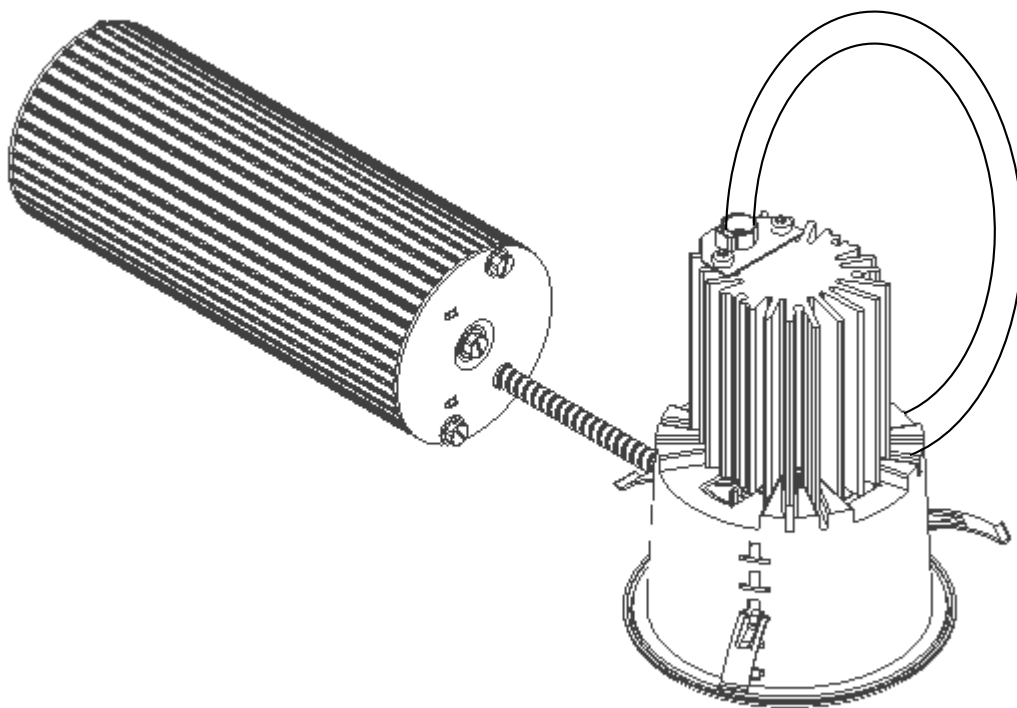

B) Identification of Luminaire Variants

Round Downlight

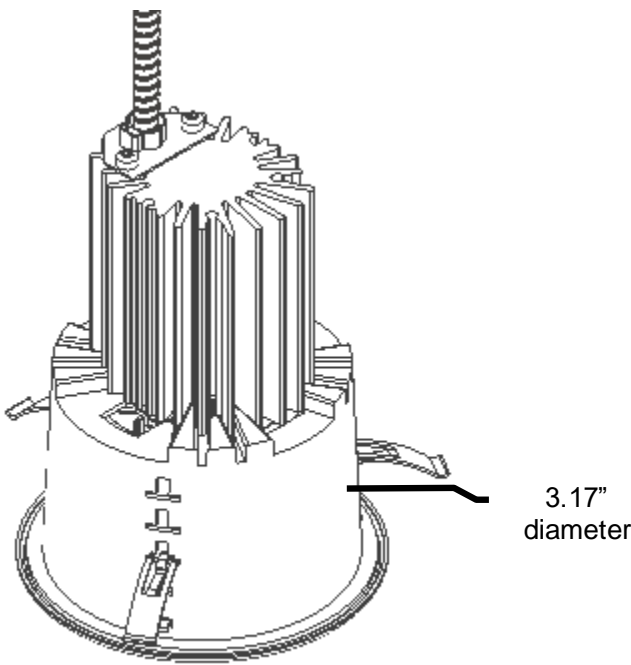

Square Downlight

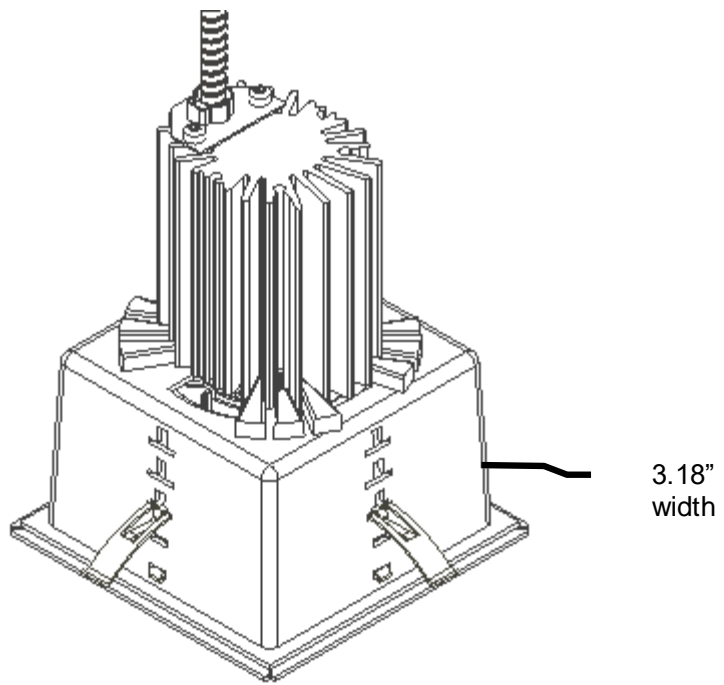

C) Downlight Installation

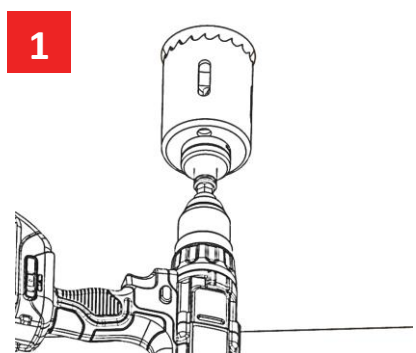

SQUARE STYLE – SKIP TO SECTION E-1.

ROUND STYLE - Drill ceiling opening using a **3-1/4"** hole saw. Pull branch circuit from ceiling. supply wire must meet applicable electrical codes and be rated for a minimum of 90°C. The driver is capable of dimming the luminaire with commercial grade 0-10V devices or residential line dimmers.

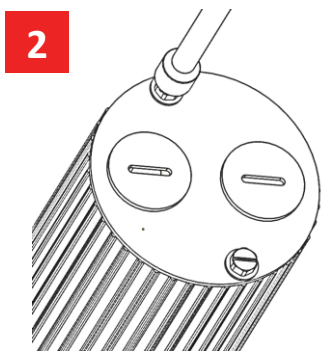

Remove the input power plate by removing the two screws on the knock-out side of the power supply enclosure.

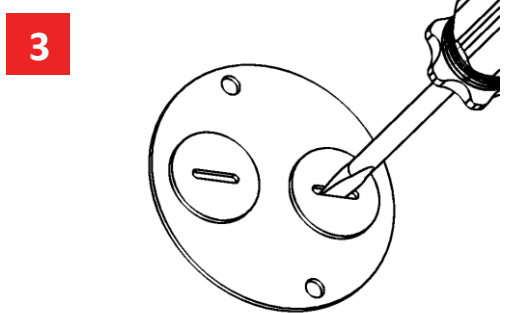

Twist out one or more knock-outs using a flat bladed screwdriver. Discard the knock-outs(s).

C) Downlight Installation - Continued

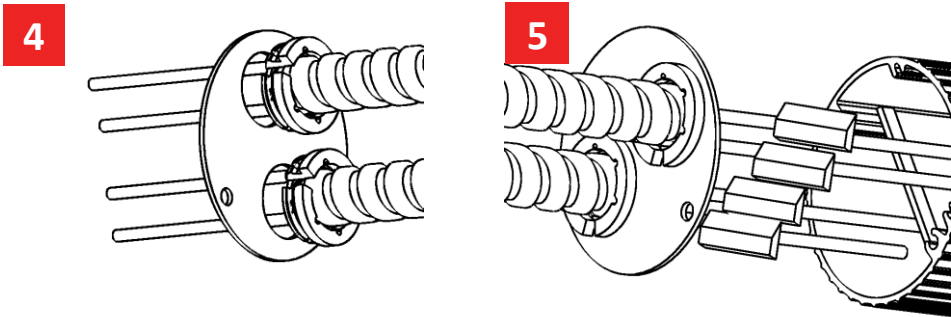

4

5

Attach the branch circuit to the cover plate with a snap in connector. If daisy chaining multiple fixtures, the required conduit fitting is Push-In Duplex (ref. McMaster Carr #7969K31, not provided)

Complete necessary splices. Fixture inputs are black, white and green. Dimming inputs are purple (+) and pink (-). If a residential dimmer is used, cap off the purple and pink.

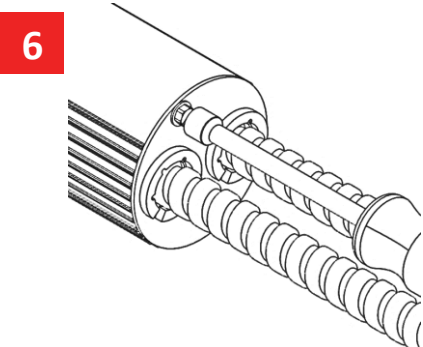

6

Reattached the cover plate with the screws that were removed in step 2. Ensure that there are no pinched wires between the power supply enclosure and this cover plate.

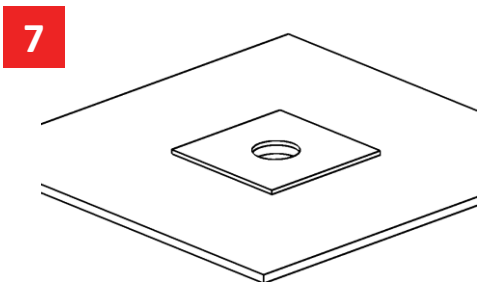

7

If ceiling is not durable, or thinner than 3/8", we recommended adding a stiffener above the ceiling, such as a square of drywall or plywood.

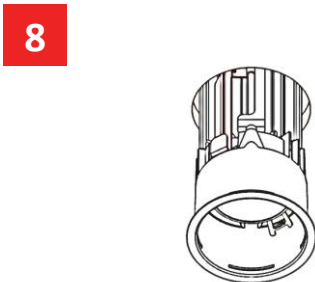

8

Insert the assembly into the ceiling. Abide by the markings on the luminaire regarding insulation contact. Remove the translucent paint plug – but DON'T throw it away. It will be reinstalled in step 11.

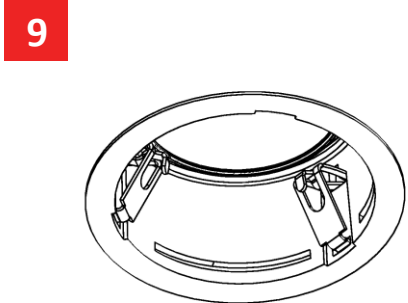

9

Insert the black spring clips into the lower collar slots for the correct ceiling thickness and, once the luminaire is flush with the ceiling, push them outward with flat bladed screwdriver until the snap into place.

D) Ceiling Hole for Square Luminaire Variant

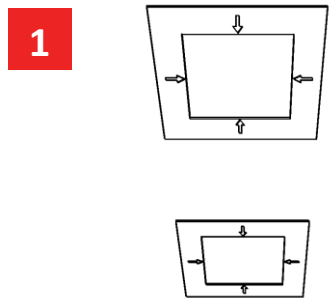

1

READ SECTION C-1 PRIOR TO CONTINUING.
Use a laser or other accurate method to ensure that your template marks are aligned.

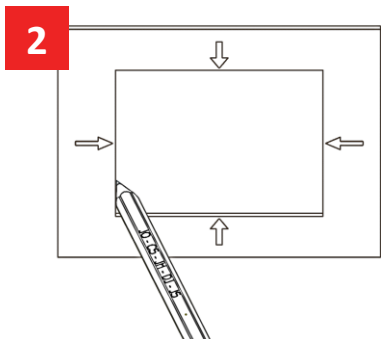

2

Using the square template, sketch the hole on the ceiling.

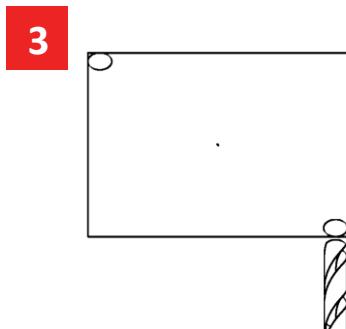

3

Drill a small hole at two corners of the sketched template. Using a keyholesaw, cut on sketched line. Return to section C-2 to complete the installation.