



TRAC-LITES

ROUND BACK CYLINDERS SERIES

R500, R501 and R502



Project: _____

Fixture Type: _____

Location: _____

Contact/Phone: _____

PRODUCT DESCRIPTION

Construction Drawn steel housing with polycarbonate stem.

Lampholder Medium base porcelain socket with nickel plated copper screw shell.

Aiming 90° vertical aiming capability and 358° rotation.

Adapter Copper alloy contacts provide precise spring action • True, positive electrical ground • On/off switch included • Patented embossed polarity arrows on bottom of adapter • Spring-loaded locking latch with embossed polarity arrows secures trac light to trac • Compatible with both Trac-Lites and Trac-Master Trac • “Pull-up” contact to up position for use on Trac-Master two-circuit trac.

Government Procurement

BAA – Buy America(n) Act: Product qualifies as a domestic end product under the Buy American Act as implemented in the FAR and DFARS. Product also qualifies as manufactured in the United States under DOT Buy America regulations.

BABA – Build America Buy America: Product qualifies as produced in the United States under the definitions of the Build America, Buy America Act.

Please refer to www.acuitybrands.com/buy-american for additional information.

Labels UL/CUL listed.

Product specifications subject to change without notice.



Line Voltage R20/PAR20

Catalog Number	Baffle	Finish	Lamp
R500 WH	None	White	50W R20/PAR20
R500 BL	None	Black	50W R20/PAR20

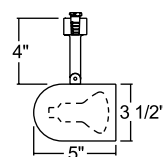

Line Voltage R20/PAR20

Catalog Number	Baffle	Finish	Lamp
R501 BLB WH	Black	White	50W R20/PAR20
R501 BLB BL	Black	Black	50W R20/PAR20
R501 BLB PB	Black	Polished Brass	50W R20/PAR20
R501 WHB WH	White	White	50W R20/PAR20

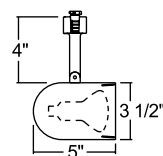

Line Voltage BR30/PAR30L

Catalog Number	Baffle	Finish	Lamp
R502 BLB WH	Black	White	65W BR30/75W PAR30L
R502 BLB BL	Black	Black	65W BR30/75W PAR30L
R502 BLB BZ	Black	Painted Bronze	65W BR30/75W PAR30L
R502 WHB WH	White	White	65W BR30/75W PAR30L

