



Project: \_\_\_\_\_

Fixture Type: \_\_\_\_\_

Location: \_\_\_\_\_

Contact/Phone: \_\_\_\_\_

# 4" IC 600 LUMEN LED DOWNLIGHT NEW CONSTRUCTION

IC 1 LED (G4 06LM) RECESSED HOUSING

LENSED TRIMS



## PRODUCT DESCRIPTION

Dedicated LED, Air-Loc® sealed new construction housing with integral light engine • Double wall, shallow housing construction allows for fit in 2 x 6 construction • Can be completely covered with insulation • Fully sealed housing stops infiltration and exfiltration of air, reducing heating and air cooling costs without the use of additional gaskets • LED housing is designed to provide 50,000 hours of life and is compatible with many standard Juno trims • 5 year limited warranty on LED components.

## ENVIRONMENTALLY FRIENDLY, ENERGY EFFICIENT

- No harmful ultraviolet or infrared wavelengths
- No lead or mercury, RoHS compliant
- Comparable light output to 65W incandescent

## PRODUCT SPECIFICATIONS

**LED Light Engine** LED array attached to high purity aluminum, thermally conductive inner housing provides superior heat transfer to ensure long life of the LED • Replaceable light engine mounts directly to inner housing assembly and incorporates the latest generation, high lumen output LED array • LEDs are binned within a 3-step MacAdam Ellipse exceeding ENERGY STAR® requirements for superior fixture to fixture color uniformity • 2700K, 3000K, 3500K, or 4000K color temperatures available • 90 CRI minimum.

**Optical System** Two field interchangeable optics available in medium flood (45° beam angle) and wide flood (65° beam angle) • Computer-optimized reflector design with high reflectance finish coupled with a high transmission diffusing lens conceals the LEDs and produces uniform aperture luminance.

**Aesthetic Trim Selections** Compatible with wide selection of existing Juno trims • Shadow free, knife edge design blends seamlessly into ceiling. • Trims are wet location approved for covered ceiling applications.

**LED Driver** Choice of dedicated 120 volt (120) driver or universal voltage (MVOLT) drivers that accommodate input voltages from 120-277 volts AC at 50/60Hz • Power factor > 0.9 at 120V input • 120 volt only driver is dimmable with the use of most incandescent, magnetic low voltage and electronic low voltage wall box dimmers • Universal voltage drivers are dimmable with the use of most 0-10V wall box dimmers • For a list of compatible dimmers, see [JUNOICLED-DIM](#) • Mounted inside housing for easy access from below ceiling.

**Life** Rated for 50,000 hours at 70% lumen maintenance.

**Labels** ENERGY STAR® Certified when used with select trims • Can be used to comply with 2019 Title 24, Part 6, JA8 high efficacy LED light source requirements with select trims • UL listed for U.S. and Canada through-branch wiring, wet locations (covered ceilings) • Union made • UL and cUL • CP option is compatible with spray foam insulation with an R-value of 3.2 per inch or less.

**Testing** All reports are based on published industry procedures; field performance may differ from laboratory performance.

Specifications subject to change without notice.

## HOUSING FEATURES

**Housing** Designed for use in IC (insulated ceiling) or non-IC construction • Aluminum housing sealed for Air-Loc® compliance • Housing is vertically adjustable to accommodate up to a 1 1/2" ceiling thickness.

**Junction Box** Pre-wired junction box provided with (6) 1/2" and (1) 3/4" knockouts, (4) knockouts for 12/2 or 14/2 NM cable and ground wire • UL listed and cUL listed for through-branch wiring, maximum 6 #12 branch circuit conductors • Junction box provided with removable access plates • Knockouts equipped with pryout slots • Quick connect electrical connectors supplied as standard for fast, secure installation.

**Mounting Frame** 22-gauge die-formed galvanized steel mounting frame • Rough-in section (junction box, mounting frame, housing and bar hangers) fully assembled for ease of installation.

**Real Nail 3 Bar Hangers** Telescoping Real Nail® 3 system permits quick placement of housing anywhere within 24" O.C. joists or suspended ceilings • Includes removable nail for repositioning of fixture in wood joist construction • Integral T-bar notch and clip for suspended ceilings • Design covered under US Patent D552,969.



## DIMENSIONS

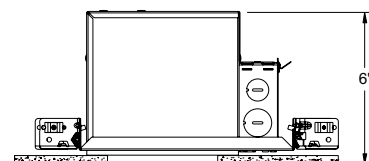
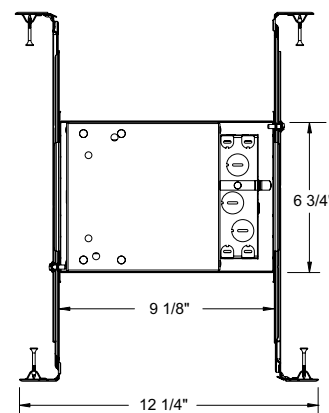

4 1/2" CEILING CUTOUT

# 4" IC 600 LUMEN LED DOWNLIGHT NEW CONSTRUCTION

IC1LED (G4 06LM) RECESSED HOUSING  
LENSED TRIMS

## ELECTRICAL DATA

### Dedicated 120V Only Driver Option (120 FRPC)

120V	
Input Power	8.6W (+/-5%)
Input Current	0.07A
Frequency	50/60Hz
EMI/RFI	FCC Title 47 CFR, Part 15, Class B (residential)
Minimum starting temp	-25°C

## ELECTRICAL DATA

### Universal Voltage

MVOLT EZ10 and EZ1		MVOLT ZT10 and ZT1	
120V	277V	120V	277V
Input Power	8.3W (+/-5%)	8.9W (+/-5%)	8.3W (+/-5%)
Input Current	0.07A	0.03A	0.07A
Frequency	50/60Hz	50/60Hz	50/60Hz
EMI/RFI	FCC Title 47 CFR, Part 15, Class B (residential)	FCC Title 47 CFR, Part 15, Class B (residential)	FCC Title 47 CFR, Part 15, Class B (residential)
Minimum starting temp	-20°C	-20°C	-20°C

## ORDERING INFORMATION

Housing and trim can be ordered together or separate, but will always ship separately.

Example: IC1LED G4 06LM 27K 90CRI 120 FRPC

Series	Generation	Lumens	Color Temperature	CRI	Distribution
IC1LED 4" LED IC New Construction Downlight	G4 Generation 4	06LM 600 Nominal Lumens	27K 2700K 30K 3000K 35K 3500K 40K 4000K	90CRI 90+ CRI	(blank) Medium Flood (45°) WFL Wide Flood (65°)

Voltage/Driver	Territory
120 FRPC 120V Forward/Reverse Phase Cut, 5% dim	CP Chicago Plenum
MVOLT ZT10 Multi-Volt (120-277), 0-10V, 10% dim	
MVOLT ZT1 Multi-Volt (120-277), 0-10V, 1% dim	
MVOLT EZ10 Multi-Volt (120-277), eldoLED 0-10V, 10% dim	
MVOLT EZ1 Multi-Volt (120-277), eldoLED 0-10V, 1% dim	



A+ Capable options indicated by this color background

## Trim/Description



12 WBRZ<sup>1</sup>

4" Frosted Lens with Clear Center Trim - Perimeter Frosted Lens, Bronze Trim Ring



12 WSC<sup>1</sup>

4" Frosted Lens with Clear Center Trim - Perimeter Frosted Lens, Satin Chrome Trim Ring



12 WWH<sup>1</sup>

4" Frosted Lens with Clear Center Trim - White, White Trim Ring

Trim Size: 5" O.D.

Note: In Canada when insulation is present, Type IC fixtures must be used.

UL Listed for use in wet location.

<sup>1</sup> Multi-Volt: 124 @ 30K, 35K and 40K only

# 4" IC 600 LUMEN LED DOWNLIGHT NEW CONSTRUCTION

IC 1 LED (G4 06LM) RECESSED HOUSING  
LENSED TRIMS

## PHOTOMETRICS

### PHOTOMETRIC REPORT

Test Report #: PT08111601R

Catalog No: IC1LED G4 06LM 35K

90CRI T20 with 12 WWH Trim

Luminaire Spacing Criterion: 0.58

Luminaire LPW: 59

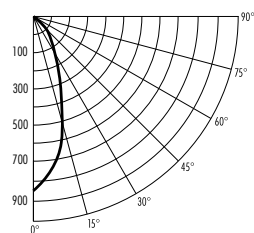

### CANDLEPOWER DISTRIBUTION (Candelas)

Degrees Vertical	0°
0	850
5	782
15	500
25	251
35	114
45	57
55	32
65	20
75	11
85	2
90	0

Multiplier: 27K - 0.89

30K - 0.94

40K - 1.03

### AVERAGE INITIAL FOOTCANDLES

Multiple Units (Square Array, 60'x60' room)

Ceiling 80% Wall 50% Floor 20%

Spacing	RCR1	RCR3	RCR5
4.0'	35	30	26
5.0'	22	19	16
6.0'	15	13	11
7.0'	13	11	9
8.0'	10	8	7
9.0'	8	6	6
10.0'	6	5	4

### ZONAL LUMEN SUMMARY

Zone	Lumens	%Lamp	%Fixture
0 - 30°	328	N/A	64.3
0 - 40°	402	N/A	78.8
0 - 60°	476	N/A	93.4
0 - 90°	510	N/A	100.0

### INITIAL FOOTCANDLES (One Unit, 8.6W, 35.5° Beam)

Distance to Illuminated Plane (Feet)	Footcandles Beam Center	Beam Diameter
4	53.1	2.6'
6	23.6	3.8'
8	13.3	5.1'
10	8.5	6.4'

### LUMINANCE (Average cd/m²)

Degrees	Average Luminance
45	12863
55	8870
65	7660
75	6552
85	3538

Fixtures tested to IES recommended standard for solid state lighting per LM-79-08. Photometric performance on a single unit represents a baseline of performance for the fixture. Results may vary in the field.