



Project: _____

Fixture Type: _____

Location: _____

Contact/Phone: _____

4" IC 600 LUMEN LED DOWNLIGHT NEW CONSTRUCTION

IC 1 LED (G4 06LM) RECESSED HOUSING

WALL WASH TRIMS



PRODUCT DESCRIPTION

Dedicated LED, Air-Loc® sealed new construction housing with integral light engine • Double wall, shallow housing construction allows for fit in 2 x 6 construction • Can be completely covered with insulation • Fully sealed housing stops infiltration and exfiltration of air, reducing heating and air cooling costs without the use of additional gaskets • LED housing is designed to provide 50,000 hours of life and is compatible with many standard Juno trims • 5 year limited warranty on LED components.

ENVIRONMENTALLY FRIENDLY, ENERGY EFFICIENT

- No harmful ultraviolet or infrared wavelengths
- No lead or mercury, RoHS compliant
- Comparable light output to 65W incandescent

PRODUCT SPECIFICATIONS

LED Light Engine LED array attached to high purity aluminum, thermally conductive inner housing provides superior heat transfer to ensure long life of the LED • Replaceable light engine mounts directly to inner housing assembly and incorporates the latest generation, high lumen output LED array • LEDs are binned within a 3-step MacAdam Ellipse exceeding ENERGY STAR® requirements for superior fixture to fixture color uniformity • 2700K, 3000K, 3500K, or 4000K color temperatures available • 90 CRI minimum.

Optical System Angle-cut aluminum reflector and specular clear kicker reflector directs light toward wall for uniform illumination on vertical surfaces while concealing LED optic assembly and minimizing glare • LEDs are concealed by high transmission diffusing lens.

Aesthetic Trim Selections Recessed lensed wall wash trim • Shadow free, knife edge design blends seamlessly into ceiling • Reflector finishes include clear, haze, wheat haze and white painted.

LED Driver Choice of dedicated 120 volt (120) driver or universal voltage (MVOLT) drivers that accommodate input voltages from 120-277 volts AC at 50/60Hz • Power factor > 0.9 at 120V input • 120 volt only driver is dimmable with the use of most incandescent, magnetic low voltage and electronic low voltage wall box dimmers • Universal voltage drivers are dimmable with the use of most 0-10V wall box dimmers • For a list of compatible dimmers, see [JUNOICLED-DIM](#) • Mounted inside housing for easy access from below ceiling.

Life Rated for 50,000 hours at 70% lumen maintenance.

Labels ENERGY STAR® Certified when used with select trims • Can be used to comply with 2019 Title 24, Part 6, JA8 high efficacy LED light source requirements with select trims • UL listed for U.S. and Canada through-branch wiring, damp locations • Union made • UL and cUL • CP option is compatible with spray foam insulation with an R-value of 3.2 per inch or less.

Testing All reports are based on published industry procedures; field performance may differ from laboratory performance.

Specifications subject to change without notice.

HOUSING FEATURES

Housing Designed for use in IC (insulated ceiling) or non-IC construction • Aluminum housing sealed for Air-Loc® compliance • Housing is vertically adjustable to accommodate up to a 1 1/2" ceiling thickness.

Junction Box Pre-wired junction box provided with (6) 1/2" and (1) 3/4" knockouts, (4) knockouts for 12/2 or 14/2 NM cable and ground wire • UL listed and cUL listed for through-branch wiring, maximum 6 #12 branch circuit conductors • Junction box provided with removable access plates • Knockouts equipped with pryout slots • Quick connect electrical connectors supplied as standard for fast, secure installation.

Mounting Frame 22-gauge die-formed galvanized steel mounting frame • Rough-in section (junction box, mounting frame, housing and bar hangers) fully assembled for ease of installation.

Real Nail 3 Bar Hangers Patented (US Patent D552,969) Real Nail® 3 bar hangers: telescoping system permits quick placement of housing anywhere within 24" O.C. joists or suspended ceilings • Includes removable nail for repositioning of fixture in wood joist construction • Integral T-bar notch and clip for suspended ceilings.

* Nominal input wattage @ 120-volt operation with dedicated 120-volt driver under stable operating conditions.

DIMENSIONS

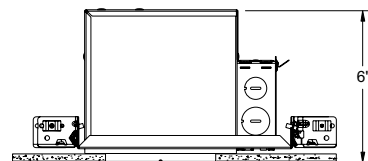
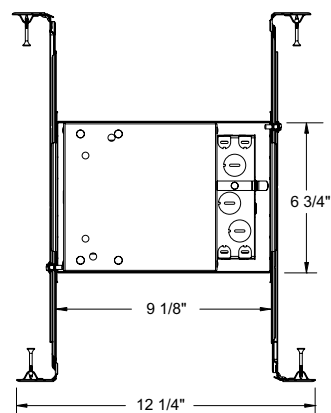

4 1/2" CEILING CUTOUT

4" IC 600 LUMEN LED DOWNLIGHT NEW CONSTRUCTION

IC1LED (G4 06LM) RECESSED HOUSING WALL WASH TRIMS

ELECTRICAL DATA

Dedicated 120V Only Driver Option (120 FRPC)

120V	
Input Power	8.6W (+/-5%)
Input Current	0.07A
Frequency	50/60Hz
EMI/RFI	FCC Title 47 CFR, Part 15, Class B (residential)
Minimum starting temp	-25°C

ELECTRICAL DATA

Universal Voltage

	MVOLT EZ10 and EZ1		MVOLT ZT10 and ZT1	
	120V	277V	120V	277V
Input Power	8.3W (+/-5%)	8.9W (+/-5%)	8.3W (+/-5%)	8.9W (+/-5%)
Input Current	0.07A	0.03A	0.07A	0.03A
Frequency	50/60Hz	50/60Hz	50/60Hz	50/60Hz
EMI/RFI	FCC Title 47 CFR, Part 15, Class B (residential)	FCC Title 47 CFR, Part 15, Class B (residential)	FCC Title 47 CFR, Part 15, Class B (residential)	FCC Title 47 CFR, Part 15, Class B (residential)
Minimum starting temp	-20°C	-20°C	-20°C	-20°C

ORDERING INFORMATION

Housing and trim can be ordered together or separate, but will always ship separately.

Example: IC1LED G4 06LM 27K 90CRI 120 FRPC

Series	Generation	Lumens	Color Temperature	CRI	Voltage/Driver	Territory
IC1LED 4" LED IC New Construction Downlight	G4 Generation 4	06LM 600 Nominal Lumens	27K 2700K	90CRI 90+ CRI	120 FRPC 120V Forward/Reverse Phase Cut, 5% dim	CP Chicago Plenum
			30K 3000K		MVOLT ZT10 Multi-Volt (120-277), 0-10V, 10% dim	
			35K 3500K		MVOLT ZT1 Multi-Volt (120-277), 0-10V, 1% dim	
			40K 4000K		MVOLT EZ10 Multi-Volt (120-277), eLdoLED 0-10V, 10% dim	
					MVOLT EZ1 Multi-Volt (120-277), eLdoLED 0-10V, 1% dim	



A+ Capable options indicated by this color background

Trim/Description



39 BBL ¹	4" Lensed Wall Wash Cone Trim - Black, Black Trim Ring
39 CWH ¹	4" Lensed Wall Wash Cone Trim - Clear Alzak®, White Trim Ring
39 HZWH ¹	4" Lensed Wall Wash Cone Trim - Haze, White Trim Ring
39 WHZWH ¹	4" Lensed Wall Wash Cone Trim - Wheat Haze, White Trim Ring
39 WWH ¹	4" Lensed Wall Wash Cone Trim - White, White Trim Ring

Trim Size: 5" O.D.

Alzak is a registered trademark of Alcoa Corp.

Note: In Canada when insulation is present, Type IC fixtures must be used.

¹Multi-Volt: ENERGY STAR® and T24 @ 30K, 35K, and 40K

4" IC 600 LUMEN LED DOWNLIGHT NEW CONSTRUCTION

IC1LED (G4 06LM) RECESSED HOUSING WALL WASH TRIMS

PHOTOMETRICS

PHOTOMETRIC REPORT

Test Report #: PT10142305
Catalog No: IC1LED G4 06LM 35K
90CRI 120 with 39 CWH Trim

Luminaire Spacing Criterion: 0.70

Luminaire LPW: 71

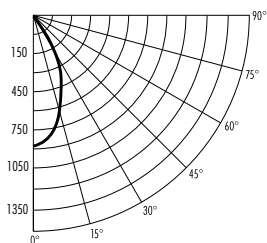

CANDLEPOWER DISTRIBUTION (Candelas)

Degrees Vertical	Candelas
0	851
5	836
15	629
25	332
35	116
45	47
55	27
65	15
75	6
85	0
90	0

Multiplier: 27K - 0.89
30K - 0.94
40K - 1.03

ZONAL LUMEN SUMMARY

Zone	Lumens	%Lamp	%Fixture
0-30°	415	N/A	68.3
0-40°	522	N/A	85.7
0-60°	598	N/A	98.2
0-90°	608	N/A	100.0

LUMINANCE (Average cd/m²)

Degrees	Average Luminance
45	12458
55	8743
65	6755
75	4354
85	0

FOOTCANDLES ON WALL FROM MULTIPLE FIXTURES

Fixture Distance to Wall		2'			3'								
Fixture Centers (spacing)		2'	3'	4'	3'	4'	5'						
DISTANCE FROM CEILING	1'	4	4	4	3	3	3	2	2	2	2	2	2
	2'	8	8	8	6	5	6	4	4	4	3	3	3
	3'	11	11	11	8	7	8	5	5	5	4	4	4
	4'	14	14	14	10	9	10	6	6	6	5	4	5
	5'	14	14	14	10	10	10	7	7	7	5	5	5
	6'	14	14	14	10	10	10	8	8	8	6	6	6
	7'	12	12	12	9	9	9	8	8	8	6	6	6
	8'	11	11	11	8	8	8	8	8	8	6	6	6
	9'	9	9	9	7	7	7	7	7	7	5	5	5

Fixtures tested to IES recommended standard for solid state lighting per LM-79-08. Photometric performance on a single unit represents a baseline of performance for the fixture. Results may vary in the field.