

## FEATURES & SPECIFICATIONS

**INTENDED USE** — Typical applications include corridors, lobbies, conference rooms and private offices.

**CONSTRUCTION** — Durable square metal trims

Galvanized steel mounting/plaster frame; galvanized steel junction box with bottom-hinged access covers and spring latches.

Vertically adjustable mounting brackets with commercial bar hangers provide 3-3/4" total adjustment. C-channel T-bar fastener options available.

Two combination 1/2"-3/4" and four 1/2" knockouts for straight-through conduit runs. Capacity: 8 (4 in, 4 out). No. 12 AWG conductors, rated for 90°C.

Accommodates 12"-24" joist spacing

Passive cooling thermal management; light engine and drivers are accessible from above or below ceiling

Max ceiling thickness 1-1/2"

**OPTICS** — LEDs are binned to a 3-step MacAdam Ellipse; 80 CRI minimum.

Diffusing lens covers optical chamber

General illumination 1.0 S/MH

55° cutoff to source and source image

Self-flanged anodized reflectors in specular, semi-specular, or matte diffuse finishes.

**UGR** — UGR is zero for fixtures aimed at nadir with a cut-off equal to or less than 60deg, per CIE 117-1996 Discomfort Glare in Interior Lighting.

**ELECTRICAL** — 1120V TRIAC or ELV dimming and Multi-volt 0-10V dimming available.

0-10V dimming drivers mounted to junction box, 10% or 1% minimum dimming level

0-10V dimming fixture requires two (2) additional low-voltage wires to be pulled

**LUMEN MAINTENANCE** — 70% lumen maintenance at 50,000 hours

**LISTINGS** — Certified to US and Canadian safety standards. Damp location standard (wet location, covered ceiling optional). Drivers are RoHS compliant.

**GOVERNMENT PROCUREMENT** — BAA — Product with the BAA option qualifies as a domestic end product under the Buy American Act as implemented in the FAR and DFARS. Product with the BAA option also qualifies as manufactured in the United States under DOT Buy America regulations.

BABA — Build America Buy America: Product with the BAA option also qualifies as produced in the United States under the definitions of the Build America, Buy America Act.

Please refer to [www.acuitybrands.com/buy-american](http://www.acuitybrands.com/buy-american) for additional information.

**WARRANTY** — 5-year limited warranty. This is the only warranty provided and no other statements in this specification sheet create any warranty of any kind. All other express and implied warranties are disclaimed.

Complete warranty terms located at: [www.acuitybrands.com/support/warranty/terms-and-conditions](http://www.acuitybrands.com/support/warranty/terms-and-conditions)

**Note:** Actual performance may differ as a result of end-user environment and application.

All values are design or typical values, measured under laboratory conditions at 25 °C.

Specifications subject to change without notice.

## PERFORMANCE DATA

| LDN8SQ 3500K AR LS 80CRI |                  |         |     |
|--------------------------|------------------|---------|-----|
| Nominal Lumens           | Delivered Lumens | Wattage | LPW |
| 5000                     | 4844             | 59.5    | 81  |
| 6000                     | 5724             | 69.4    | 82  |
| 8000                     | 8022             | 98.7    | 81  |
| 10,000                   | 9631             | 116.5   | 83  |
| 12,000                   | 11267            | 149.7   | 75  |
| 15,000                   | 13861            | 174.6   | 79  |
| 20,000                   | 18731            | 253.4   | 74  |

### Notes

- Tested in accordance with IESNA LM-79-08.
- Tested to current IES and NEMA standards under stabilized laboratory conditions.
- CRI: 80 typical.



|                |
|----------------|
| Catalog Number |
| Notes          |
| Type           |

# LDN8SQ STATIC WHITE

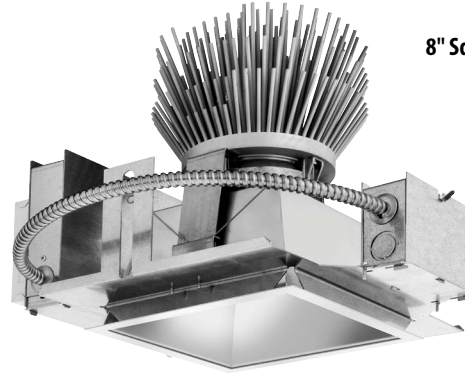

**8" Square Open and Wallwash LED  
Non-IC  
New Construction  
Downlight**

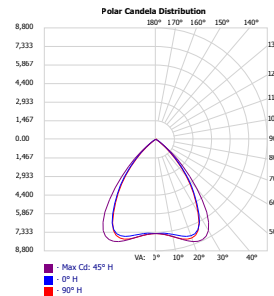

Open

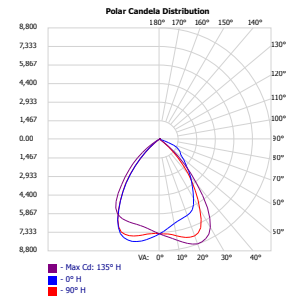

Wallwash

## DIMENSIONS

### LDN8SQ 5K-6K

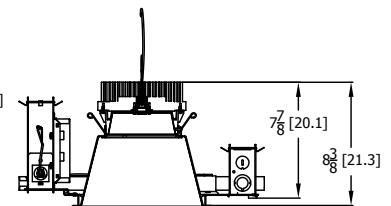
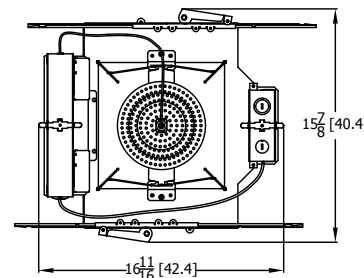

Aperture: 8-3/4 (22.2)  
Ceiling Opening: 8-7/8 (22.5)  
Overlap Trim: 9-1/2 (24.1)

See page 4 for other fixture dimensions

ORDERING INFORMATION

Lead times will vary depending on options selected. Consult with your sales representative.

Example: LDN8SQ 35/50 L08 AR LSS MVOLT EZ1

| LDN8SQ |           |                   |       |              |              |            |           |            |                     |             |                         |                |                            |         |            |
|--------|-----------|-------------------|-------|--------------|--------------|------------|-----------|------------|---------------------|-------------|-------------------------|----------------|----------------------------|---------|------------|
| Series |           | Color temperature |       | Lumens       |              | Trim Style |           | Trim Color |                     | Trim Finish |                         | Flange Color ‡ |                            | Voltage |            |
| LDN8SQ | 8" Square | 27/               | 2700K | 50           | 5000 lumens  | LS8        | Downlight | AR         | Clear               | LSS         | Semi-specular           | TRW            | White painted flange       | MVOLT   | Multi-volt |
|        |           | 30/               | 3000K | 60           | 6000 lumens  | LSW8       | Wallwash  | WR ‡       | White               | LD          | Matte diffuse           | TRBL           | Black painted flange       | 120     | 120V       |
|        |           | 35/               | 3500K | 80           | 8000 lumens  |            |           | BR ‡       | Black               | LS          | Specular                | FCPC           | Custom painted flange only | 277     | 277V       |
|        |           | 40/               | 4000K | 100          | 10000 lumens |            |           | TCPC ‡     | Custom painted trim | FRALTB      | RAL painted flange only |                |                            | 347 ‡   | 347V       |
|        |           |                   |       | 120          | 12000 lumens |            |           | TRALTB ‡   | RAL painted trim    |             |                         |                |                            |         |            |
|        |           |                   |       | 150          | 15000 lumens |            |           |            |                     |             |                         |                |                            |         |            |
|        |           |                   | 200   | 20000 lumens |              |            |           |            |                     |             |                         |                |                            |         |            |

| Driver  | Emergency ‡ |  | Control Input ‡ |  | Options  |
|---|-------------|--|-----------------|--|--|
| GZ10 0-10V driver dims to 10%   | (blank)     | No Emergency Needed  | (blank)         | No Control Input Needed  | HAO ‡ High ambient option (40°C)   |
| GZ1 0-10V driver dims to 1%   | EL          | Battery pack (10W constant power), non-T20 compliant, integral test switch                 | JOT             | Wireless room control with "Just One Touch" pairing  | CP ‡ Chicago Plenum  |
| EZ1 0-10V eldoLED driver with smooth and flicker-free deep dimming performance down to 1% | ELR         | Battery pack (10W constant power), non-T20 compliant, remote test switch                   | NPP16D          | nLight® network power/relay pack with 0-10V dimming for non-eldoLED drivers (GZ10, GZ1).   | RRL_____RELOC®-ready luminaire connectors enable a simple and consistent factory installed option across all ABL luminaire brands. Refer to RRL for complete nomenclature. Available only in RRLA, RRLB, RRLAE, and RRLC12S. |
|   | ELSD        | Self-diagnostic battery pack (10W constant power), non-T20 compliant, integral test switch | NPP16DER        | nLight® network power/relay pack with 0-10V dimming for non-eldoLED drivers (GZ10, GZ1). ER controls fixtures on emergency circuit.        | BAA Buy America(n) Act and/or Build America Buy America Qualified  |
|   | ELRSD       | Self-diagnostic battery pack (10W constant power), non-T20 compliant, remote test switch   | NPS80EZ         | nLight® dimming pack controls 0-10V eldoLED drivers (EZ1).   |  |
|   | E10WCP      | Battery pack (10W constant power), T20 compliant, integral test switch                     | NPS80EZER       | nLight® dimming pack controls 0-10V eldoLED drivers (EZ1). ER controls fixtures on emergency circuit.                                      |  |
|   | E10WCPR     | Battery pack (10W constant power), T20 compliant, remote test switch                       | N80             | nLight™ Lumen Compensation   |  |
|   | E10WRSTAR   | Emergency battery pack, 10W with remote test switch and Iota STAR technology               | NLTAIR2         | nLight® Air enabled  |  |
|   |             |  | NLTAIRER2       | nLight® AIR Dimming Pack Wireless Controls. Controls fixtures on emergency circuit, not available with battery pack options                | SF ‡ Single fuse   |
|   |             |  | NLTAIREM2       | nLight® AIR Dimming Pack Wireless Controls. UL924 Emergency Operation, via power interrupt detection. Available with battery pack options. |  |

| ‡ Option Value Ordering Restrictions |  |
|--------------------------------------|--|
| Option value                         | Restriction  |
| LDN8                                 | Marked Spacing for 8000 lumens and above.  |
| WR, BR                               | Not available with finishes.   |
| 347V                                 | 347V is 3' x 3' x 6" overhead marked spacing. 347V only available with EZ1 driver options. Supplied with step-down transformer. Not available with emergency options.  |
| SF                                   | Voltage-specific 120, 277V.  |
| TRW, TRBL                            | Only available with AR finish.   |
| NPP16D, NPP16DER, NPS80EZ, NPS80EZER | specify voltage. ER for use with generator supply EM power. Will require an emergency hot feed and normal hot feed. See UL 924 Sequence of Operation table.  |
| N80                                  | Fixture begins at 80% light level. Must be specified with NPS80EZ or NPS80EZ ER. Only available with EZ1 drivers.  |
| NLTAIR2, NLTAIRER2                   | Not available with CP, NPS80EZ, NPS80EZER, NPP16D, NPP16DER or N80 options. Not recommended for metal ceiling installations.   |
| Reloc® Options                       | Refer to RRL specification sheet on acuitybrands.com for further details.  |
| RRLAE                                | Commercial fixtures should disconnect the TSPL before unplugging the RRL so it does not go into discharge mode.  |
| RRLC12S                              | RRLC12S option is to be used with the OnePass OCU, OCS, OD, OFC and OD for 0-24V integrated single-circuit or 0-10V low voltage controls applications. Not available with integral dimming sensors.  |
| E10WRSTAR                            | Not available with wet location, EC1, EC6, QDS, CP, 347V, NPS80EZ ER, NLTAIRER2, NLTAIREM2, ALO3 & ALO4 w/DALI, OR 2000-4500 lumens w/JOT. Top access installation or 17.5" plenum clearance required for roomside installation. Not available with integral test switch |
| TRALTB, FRALTB                       | RALTB for pricing only. Replace with applicable RAL number and finish when ready to order. See the RAL BROCHURE for available color options.   |
| TCP, FCPC                            | CPC options for pricing only. Custom color chip needs to be sent in to your Customer Resolution specialist before order can be processed. Click HERE for more details  |

Emergency Battery Pack Options - Field Installable

| Battery Model Number                | Wattage | Runtime (Minutes) | Lumen Output* @ 120 Lumens/Watt | Other  |
|-------------------------------------|---------|-------------------|---------------------------------|--|
| <a href="#">ILB CP07 2H A</a>       | 7W      | 120               | 840                             | Storm Shelter / 2 Hour Runtime               |
| <a href="#">ILB CP10 A</a>          | 10W     | 90                | 1200                            |  |
| <a href="#">ILBLP CP10 HE SD A+</a> | 10W     | 90                | 1200                            | Title 20, Self Diagnostic                    |
| <a href="#">ILBLP CP15 HE SD A+</a> | 15W     | 90                | 1800                            | Title 20, Self Diagnostic                    |
| <a href="#">ILB CP20 HE A</a>       | 20W     | 90                | 2400                            | Title 20                                     |
| <a href="#">ILB CP20 HE SD A</a>    | 20W     | 90                | 2400                            | Title 20, Self Diagnostic                    |
| <a href="#">ILBHI CP10 HE SD A+</a> | 10W     | 90                | 1200                            | 347-480V AC Input, Title 20, Self Diagnostic |
| <a href="#">ILBHI CP15 HE SD A+</a> | 15W     | 90                | 1800                            | 347-480V AC Input, Title 20, Self Diagnostic |

All the above are UL Listed products that are certified for field install external/remote to the fixture.  
\*Minimum delivered lumen output to assist in product selection for increased fixture mounting height.  
The CP10 delivered emergency illumination outperforms legacy 1400 lumen fluorescent emergency ballast.  
Please contact us at [techsupport@iotaengineering.com](mailto:techsupport@iotaengineering.com) for any Emergency Battery related questions.

## PHOTOMETRY

## Distribution Curve

## Distribution Data

## Output Data

Illuminance Data at 30" Above Floor for  
a Single Luminaire

**LDN85Q 35/50 LS8AR LS**, input watts: 59.5, delivered lumens: 4705.9, LM/W = 79.09, spacing criterion at 0 = 1.26, test no. ISF32878P61.

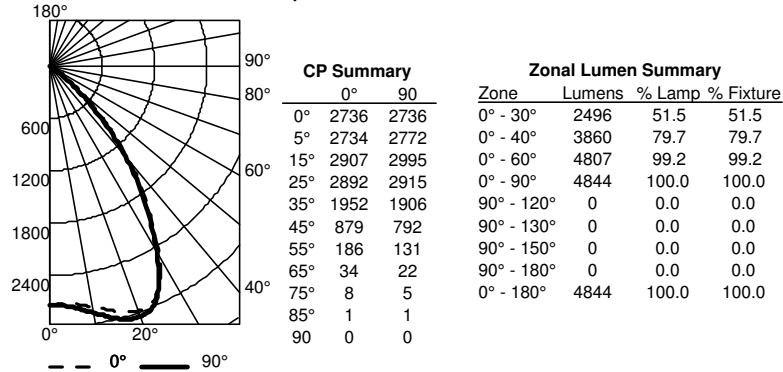

**LDN85Q 35/100 LS8AR LS**, input watts: 116.5, delivered lumens: 9631.3, LM/W = 82.67, spacing criterion at 0 = 1.26, test no. 32878P31.

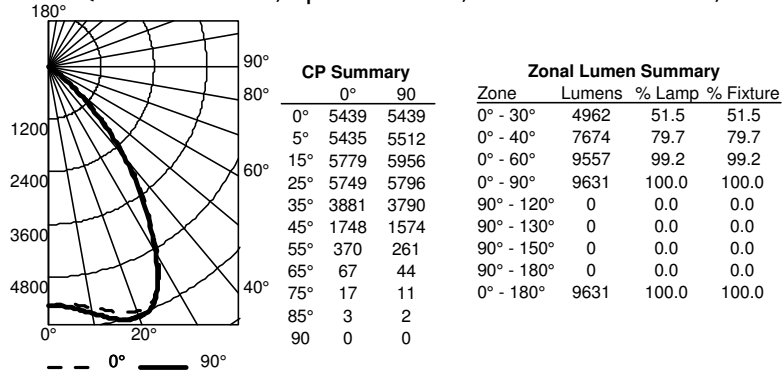

**LDN85Q 35/200 LS8AR LS**, input watts: 253.4, delivered lumens: 18731, LM/W = 73.91, spacing criterion at 0 = 1.26, test no. 32878P22.

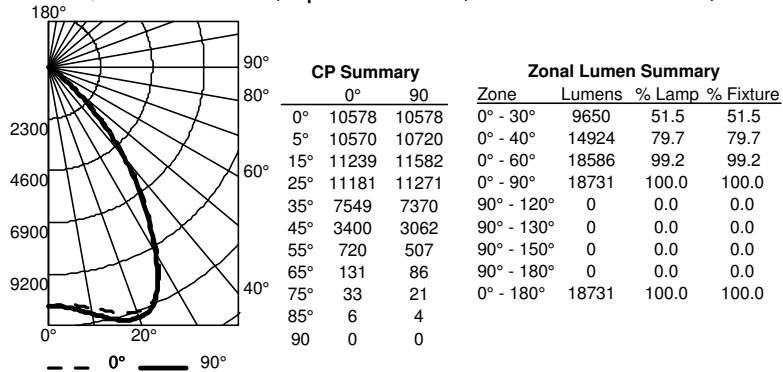

## HOW TO ESTIMATE DELIVERED LUMENS IN EMERGENCY MODE

Use the formula below to estimate the delivered lumens in emergency mode

**Delivered Lumens = 1.25 x P x LPW**

P = Output power of emergency driver. P = 10W for PS1055CP

LPW = Lumen per watt rating of the luminaire. This information is available on the ABL luminaire spec sheet.

The LPW rating is also available at [Designlight Consortium](https://www.designlightconsortium.com).

## Notes

- Tested in accordance with IESNA LM-79-08.
- Tested to current IES and NEMA standards under stabilized laboratory conditions.
- Actual performance may differ as a result of end-user environment and application.
- Actual wattage may differ by +/- 10% when operating between 120-277V +/- 10%.
- CRI: 80 typical.

## LUMEN OUTPUT MULTIPLIERS - FINISH

|                     |      |
|---------------------|------|
| Specular (LS)       | 1.0  |
| Semi-specular (LSS) | 0.95 |
| Matte diffuse (LD)  | 0.85 |
| White               | 0.87 |
| Black               | 0.73 |

## LUMEN OUTPUT MULTIPLIERS - CRI

|    |       |
|----|-------|
| 80 | 1.0   |
| 90 | 0.874 |

## LUMEN OUTPUT MULTIPLIERS - CCT

|       | 2700K | 3000K | 3500K | 4000K |
|-------|-------|-------|-------|-------|
| 80CRI | 0.950 | 0.966 | 1.000 | 1.101 |

DIMENSIONAL DRAWINGS

LDN8SQ 5K-6K

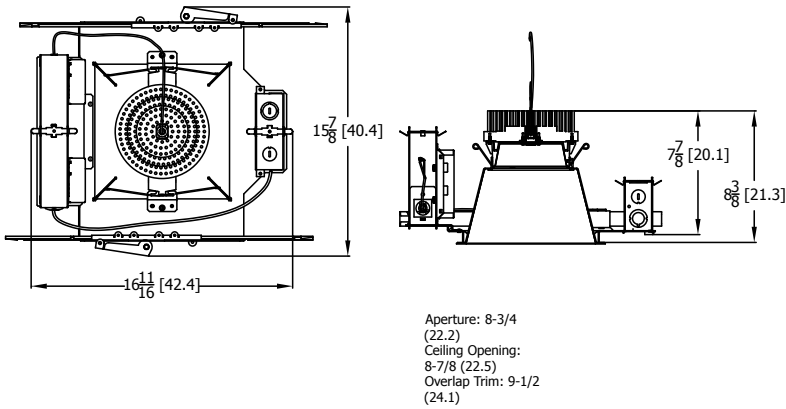

LDN8SQ 8K-12K

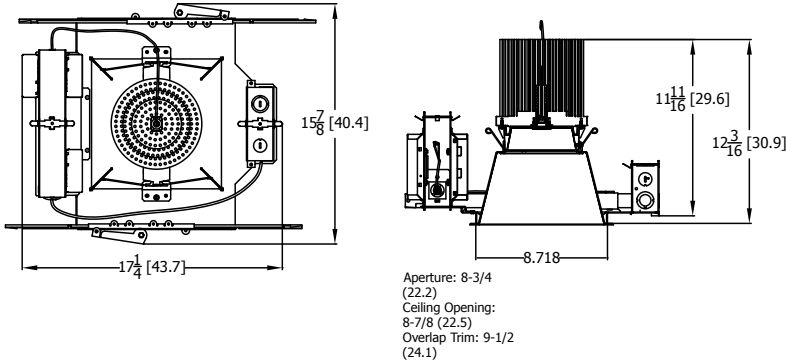

LDN8SQ 15K-20K

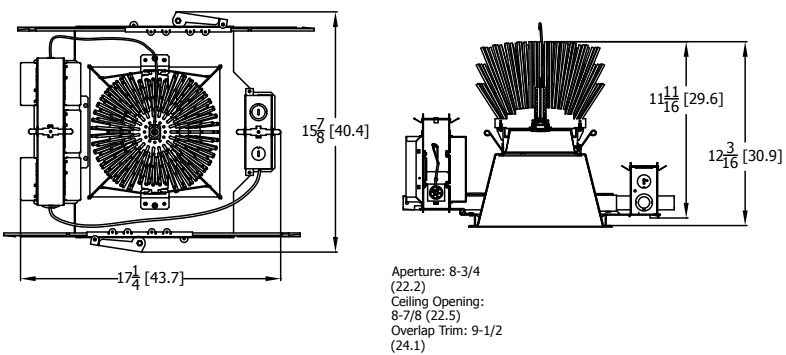

ADDITIONAL DATA

| COMPATIBLE 0-10V WALL-MOUNT DIMMERS |   |                         |
|-------------------------------------|---|-------------------------|
| MANUFACTURER                        | PART NO.  | POWER BOOSTER AVAILABLE |
| Lutron®                             | Diva® DDTV  |                         |
|                                     | Diva® DVSCTV  |                         |
|                                     | Nova T® NTFTV   |                         |
|                                     | Nova® NFTV  |                         |
| Leviton®                            | AWSMT-7DW   | CN100                   |
|                                     | AWSMG-7DW   | PE300                   |
|                                     | AMRMG-7DW   |                         |
|                                     | Leviton Centura Fluorescent Control System                                    |                         |
|                                     | IllumaTech® IP7 Series  |                         |
| Synergy®                            | ISD BC  | RDMFC                   |
|                                     | SLD LPCS  |                         |
|                                     | Digital Equinox (DEQ BC)  |                         |
| Douglas Lighting Controls           | WPC-5721  |                         |
| Entertainment Technology            | Tap Glide TG600FAM120 (120V)  |                         |
|                                     | Tap Glide Heatsink TGH1500FAM120 (120V)                                       |                         |
|                                     | Oasis 0A2000FAMU  |                         |
| Honeywell                           | EL7315A1019   | EL7305A1010 (optional)  |
|                                     | EL7315A1009   |                         |
| HUNT Dimming                        | Preset slide: PS-010-IV and PS-010-WH   |                         |
|                                     | Preset slide: PS-010-3W-IV and PS-010-3W-WH                                   |                         |
|                                     | Preset slide, controls FD-010: PS-IFC-010-IV and PS-IFC-010-WH-120/277V       |                         |
|                                     | Preset slide, controls FD-010: PS-IFC-010-3W-IV and PS-IFC-010-3W-WH-120/277V |                         |
|                                     | Remote mounted unit: FD-010   |                         |
| Lehigh Electronic Products          | Solitaire   | PBX                     |
| PDM Electrical Products             | WPC-5721  |                         |
| Starfield Controls                  | TR61 with DALI interface port   | RT03 DALInet Router     |
| WattStopper®                        | LS-4 used with LCD-101 and LCD-103  |                         |

LDN85Q

EXAMPLE

Group Fixture Control\*

\*Application diagram applies for fixtures with eldoLED drivers only.

- nPS 80 EZ Dimming/Control Pack (qty: 2 required)
- nPODM 2P DX Dual On/Off/Dim Push-Button WallPod
- nCM ADCX Daylight Sensor with Automatic Dimming Control
- nCM PDT 9 Dual Technology Occupancy Sensor

**Description:** This design provides a dual on/off/dim wall station that enables manual control of the fixtures in Row A and Row B separately. Additionally, a daylight harvesting sensor is provided so the lights in Row B can be configured to dim automatically when daylight is available. An occupancy sensor turns off all lights when the space is vacant.

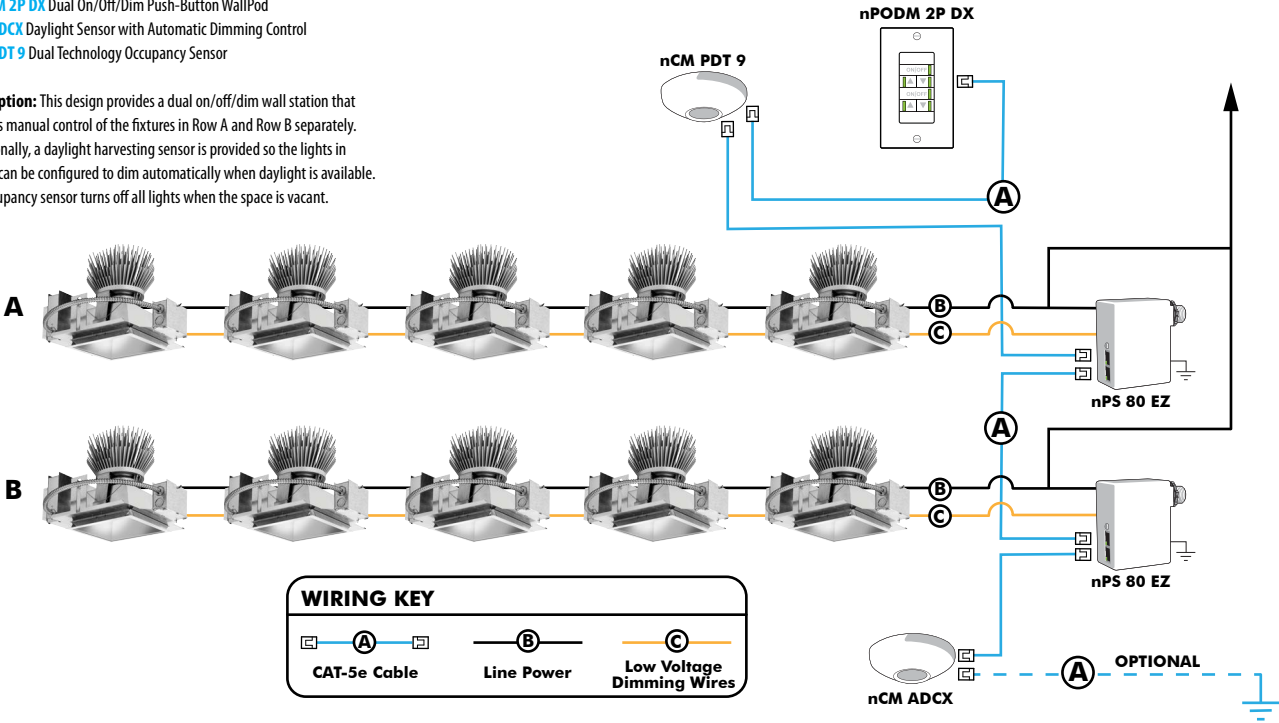

Choose Wall Controls

nLight offers multiple styles of wall controls - each with varying features and user experience.



**Push-Button Wallpod**  
Traditional tactile buttons and LED user feedback



**Graphic Wallpod**  
Full color touch screen provides a sophisticated look and feel

| nLight® Wired Controls Accessories:   |                  |  |                             |
|---|------------------|--|-----------------------------|
| Order as separate catalog number. Visit <a href="http://www.acuitybrands.com/products/controls/nlight">www.acuitybrands.com/products/controls/nlight</a> for complete listing of nLight controls. |                  |  |                             |
| WallPod Stations  | Model number     | Occupancy sensors                          | Model Number                |
| On/Off  | nPODM (Color)    | Small motion 360°, ceiling (PIR/dual Tech) | nCM 9 / nCM PDT 9           |
| On/Off & Raise/Lower  | nPOD DX (Color)  | Large motion 360°, ceiling (PIR/dual tech) | nCM 10 / nCM PDT 10         |
| Graphic Touchscreen   | nPOD GFX (Color) | Wide View (PIR/dual tech)                  | nWV 16 / nWV PDT 16         |
| Photocell controls  | Model Number     | Wall Switch w/ Raise/Lower (PIR/dual tech) | nWSX LV DX / nWSX PDT LV DX |
| Dimming   | nCM ADCX         | Cat-5 cables (plenum rated)                | Model Number                |
|   |                  | 10', CAT5 10FT                             | CAT5 10FT J1                |
|   |                  | 15', CAT5 15FT                             | CAT5 15FT J1                |

| nLight® AIR Control Accessories:   |                           |
|--|---------------------------|
| Order as separate catalog number. Visit <a href="http://www.acuitybrands.com/products/controls/nlightair">www.acuitybrands.com/products/controls/nlightair</a> . |                           |
| Wall switches  | Model number              |
| On/Off single pole   | rPODB [color]             |
| On/Off two pole  | rPODB 2P [color]          |
| On/Off & raise/lower single pole   | rPODB DX [color]          |
| On/Off & raise/lower two pole  | rPODB 2P DX [color]       |
| On/Off & raise/lower single pole   | rPODBZ DX WH <sup>1</sup> |

Notes

1 Can only be ordered with the RES7Z zone control sensor version.

UL924 Sequence of Operation

The below information applies to all nLight AIR devices with an EM option.

- EM devices will remain at their high-end trim and ignore wireless lighting control commands, unless a normal-power-sensed (NPS) broadcast is received at least every 8 seconds.
- Using the CLAIRITY+ mobile app, EM devices must be associated with a group that includes a normal power sensing device to receive NPS broadcasts.
- Only non-emergency rPP20, rLSXR, rSBOR, rSDGR, and nLight AIR luminaires with version 3.4 or later firmware can provide normal power sensing for EM devices. See specification sheets for control devices and luminaires for more information on options that support normal power sensing.

nLight AIR

nLight AIR is the ideal solution for retrofit or new construction spaces where adding communication is cost prohibitive. The integrated nLight AIR rPP20 Power Pack is part of each Lithonia LDN Luminaire. These individually addressable controls offer the ultimate in flexibility during initial setup and for space repurposing.



Simple as 1,2,3

1. Install the nLight® AIR fixtures with embedded smart sensor
2. Install the wireless battery-powered wall switch
3. With CLAIRITY app, pair the fixtures with the wall switch and if desired, customize the sensor settings for the desired outcome



nLight AIR rPODB 2P DX      Mobile Device